



Coordinates are to be Ordnance Survey Datum OSGB36. All levels are in metres and relate to the Tunnel Datum which is 100 metres below Ordnance Datum Newlyn.

**Notes:**

- 1. All dimensions and levels are approximate.

**Rev 1:**

- 1. Permanent vessel mooring access ramp revised. Key plan amended. Drawing status amended.

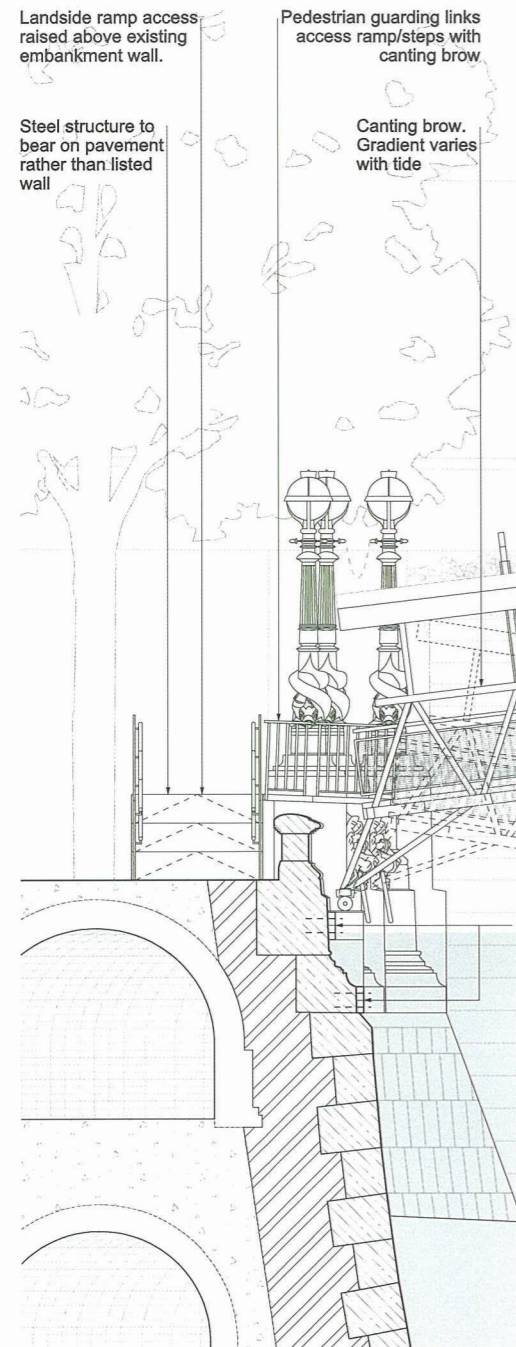

**Detail section**  
(in both temporary and permanent cases)  
Scale 1:50  
See proposed landscape plan sheet 2 of 2 for location details

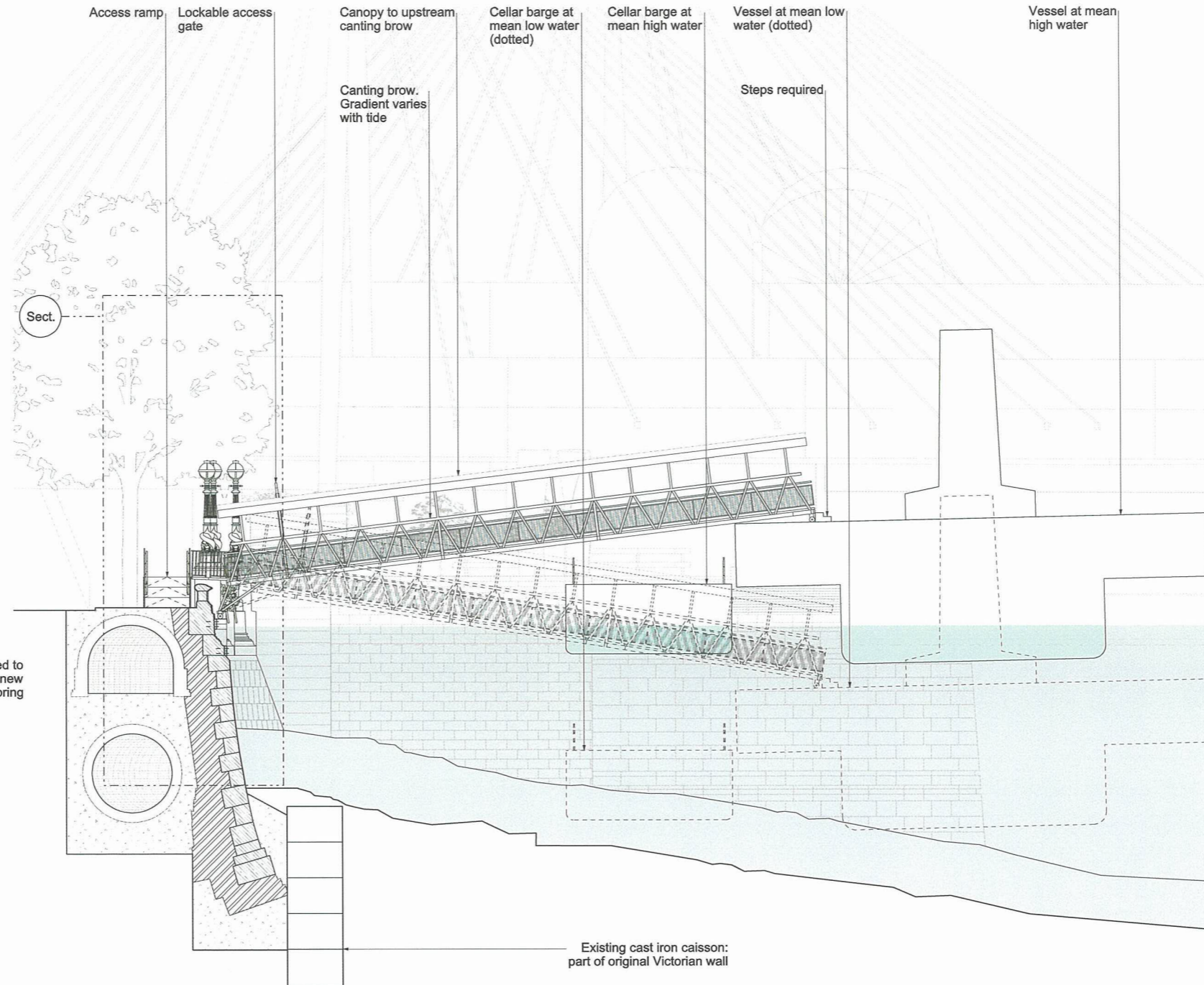

**Proposed South elevation at high tide**  
Scale 1:100

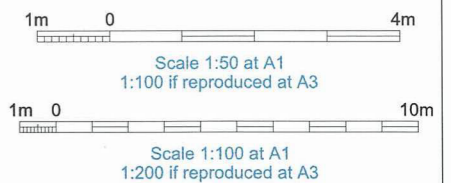

**ILLUSTRATIVE**  
Save for the detail of fixing to the listed wall which is for approval

We, Lindsay Speed and Sarah Fairbrother, are authorised by the Secretaries of State for Communities and Local Government and Environment, Food and Rural Affairs, to hereby certify that this plan is a true copy of a plan referred to in Article 61 (1) (d) and schedule 2 part 4 of the Thames Water Utilities Limited (Thames Tideway Tunnel) Order 2014.



24 September 2014

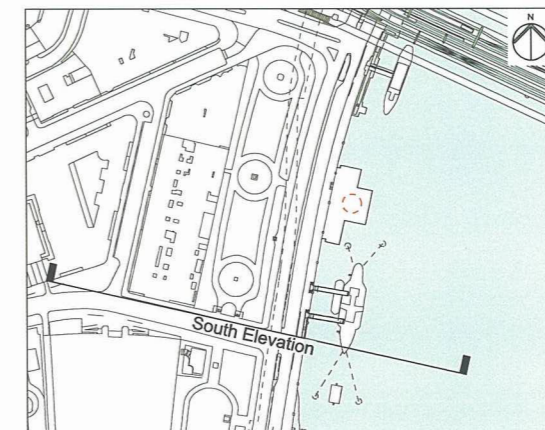

**Location**  
Victoria Embankment Foreshore  
City of Westminster

**Document Information**  
Application for Development Consent  
Proposed  
Mooring access details  
Book of plans - section 18  
DCO-PP-16X-VCTEF-180027 - Rev 1  
September 2013

