



# MetroWest+

## Portishead Branch Line (MetroWest Phase 1)

TR040011

Applicant: North Somerset District Council

9.10 ExA.WQ1.D2.V1 – Appendix DE.1.6-1 to Applicant's responses to the Examining Authority's Written Questions ExQ1

Author: Womble Bond Dickinson (UK) LLP

Version: 1

Date: November 2020



DO NOT SCALE. This drawing is to be read in conjunction with all relevant Architects, Engineers and Specialist Manufacturer's drawings and specifications. If in doubt please consult the Engineer.

This map is reproduced from Ordnance Survey material by Halrow on behalf of North Somerset Council with the permission of the Controller of Her Majesty's Stationery Office. © Crown copyright. Unauthorised reproduction infringes Crown copyright and may lead to prosecution or civil proceedings. Licence Number: 100023397

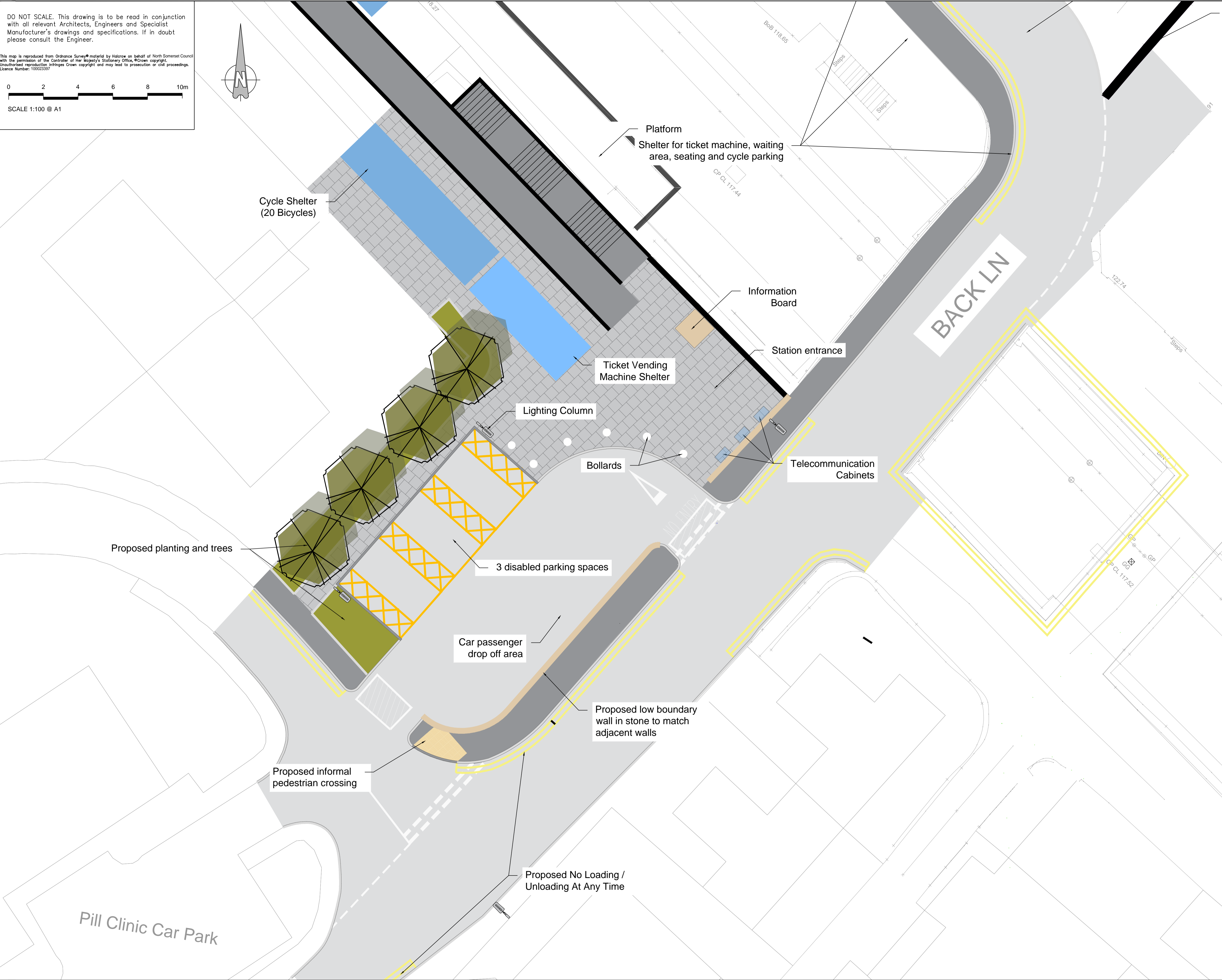

NOTES:

- All dimensions are in metres unless noted otherwise.

KEY:

- Carriageway surfacing
- Proposed vegetation
- Proposed Paving
- New footpath surface
- Proposed trees
- Kerb
- Drop Kerb

Rev	By	Chkd	Apprd	Date	Description



**CH2M HILL**  
1 The Square Temple Quay Bristol BS1 6DG  
Tel +44 (0)117 910 2580 Fax +44 (0)117 910 2581  
www.ch2m.com



Project: **PORTISHEAD BRANCH LINE (METROWEST PHASE 1)**

Drawing: **PILL STATION CAR PARK AND PSP LAYOUT, LANDSCAPING LIGHTING AND ACCESS PLAN DE.1.6**

Drawn by: ECP Date: 07/07/2016  
Checked by: ADL Date: 13/07/2016  
Approved by: ADL Date: 13/07/2016

Drawing No. **467470.BQ.04.20-SK250** Revision **M**

Drawing Scale: 1:100 @ A1 or 1:200 @ A3

Drawing file path & name: C:\Users\w66723\Desktop\Metro West\2010.11.02\to check\Pin\_467470.BQ.04.20.2016 to 2016 Rev M DE.1.6.dwg