

**LEGEND**

	Site Boundary
	Residential Receptor
	Grade II Listed Building
	Veteran Tree
	A1173
	Other Road
	Public Right of Way
	Watercourse
	Long Strip Tree Preservation Order
	Local Wildlife Site
	Special Area of Conservation
	Special Protection Area
	Site of Special Scientific Interest
	Ramsar
	Residential Area

**NOTES**

© Natural England copyright. Contains Ordnance Survey data © Crown copyright and database right 2023.  
 © Historic England 2023. Contains Ordnance Survey data © Crown copyright and database right 2023. The Historic England GIS Data contained in this material was obtained on 04/09/2023. The most publicly available up to date Historic England GIS Data can be obtained from HistoricEngland.org.uk.  
 Contains Ordnance Survey Data © Crown Copyright and database right 2023. Reproduced from Ordnance Survey digital map data © Crown copyright 2024. All rights reserved. Licence number 0100031673.

**ISSUE PURPOSE**  
Environmental Statement (Further Change Application)

**PROJECT NUMBER**  
60673509

**DEVELOPMENT CONSENT ORDER NO**  
TR030008

**FIGURE TITLE**  
Site and Surrounding Environment Key Plan

**FIGURE NUMBER**  
Figure 2.1

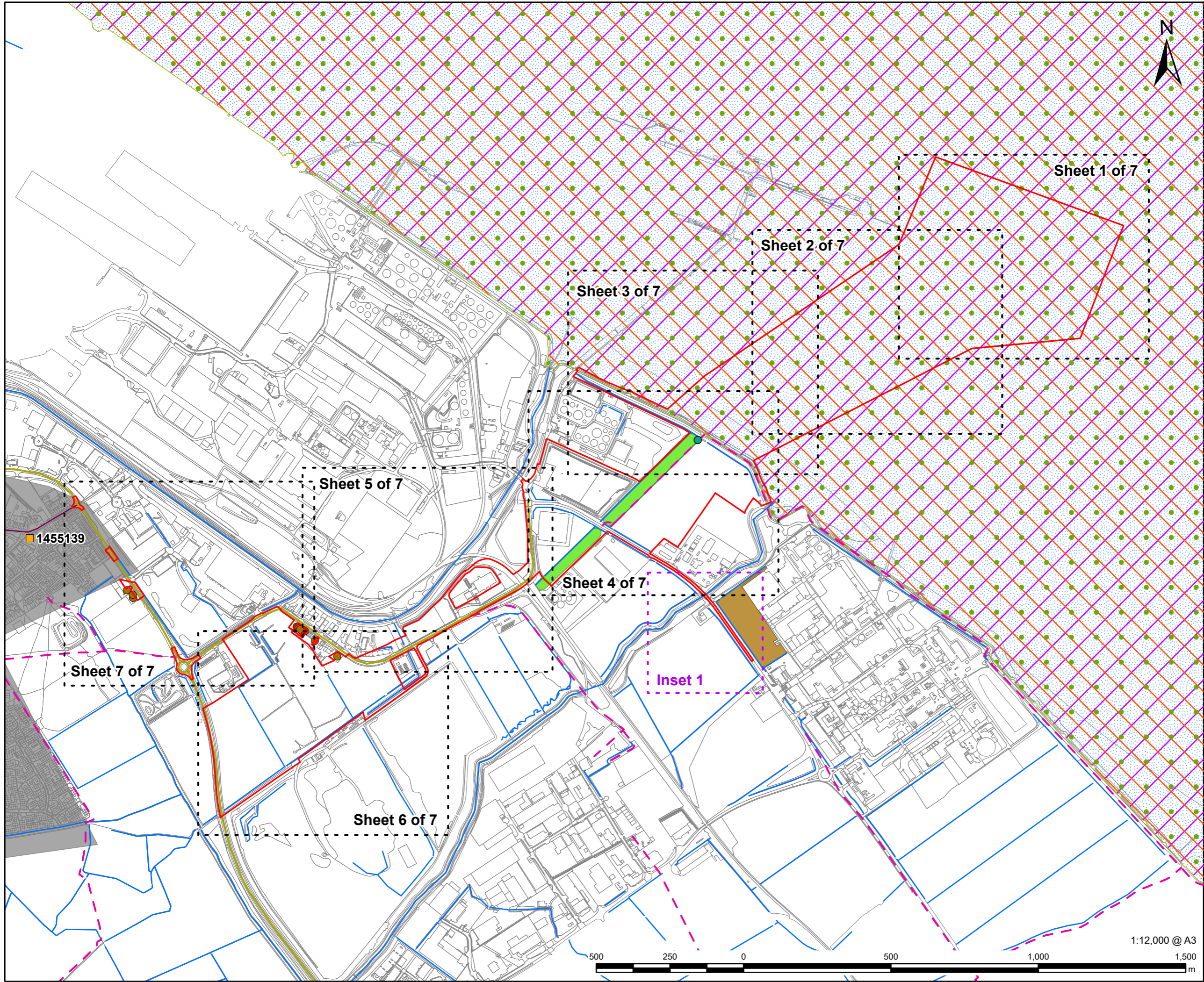

This drawing has been prepared for the use of AECOM's client. It may not be used, modified, reproduced or relied upon by third parties, except as agreed by AECOM or as required by law. AECOM accepts no responsibility, and denies any liability whatsoever, to any party that uses or relies on this drawing without AECOM's express written consent. Do not scale this document. All measurements must be obtained from the stated dimensions.



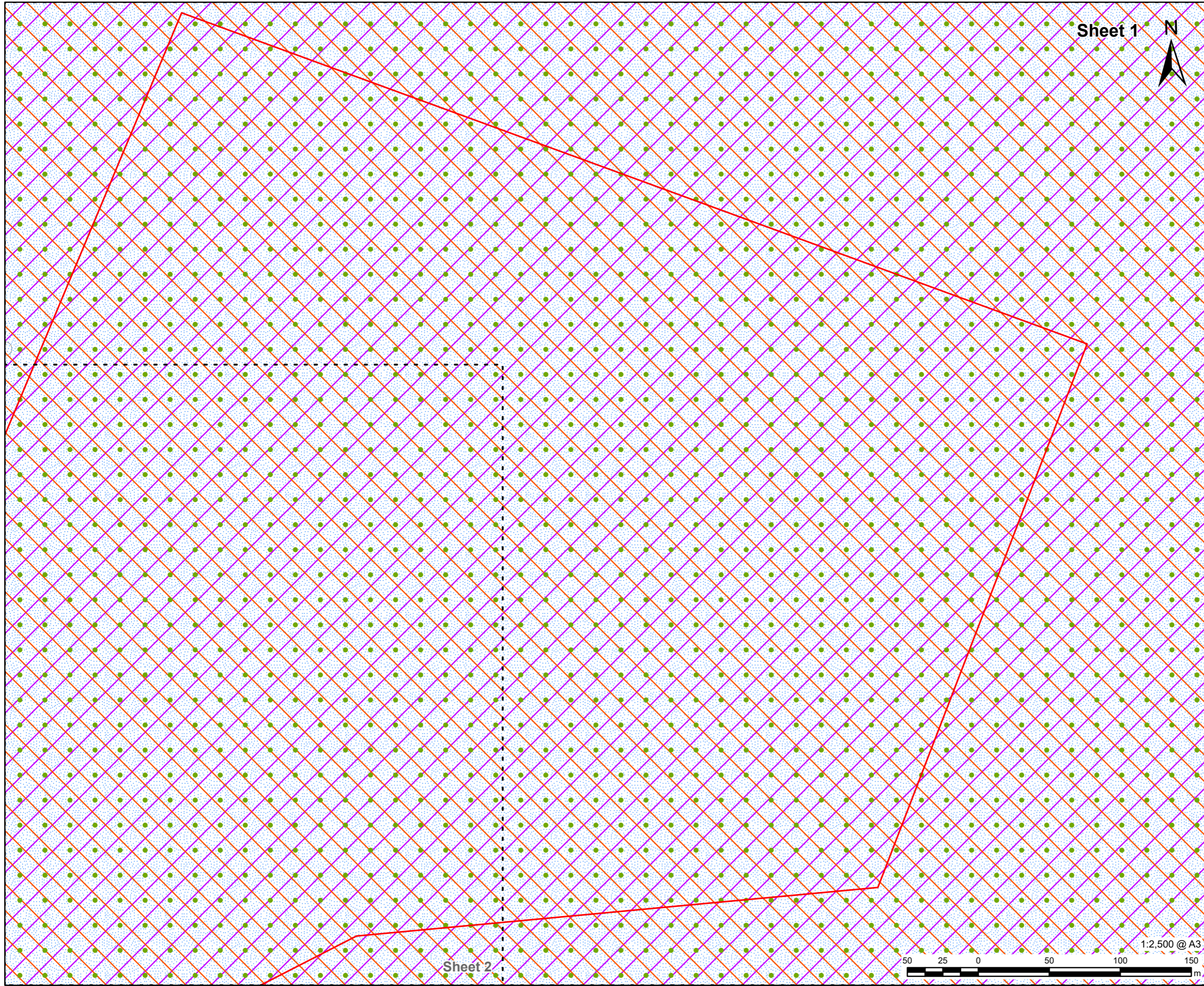

Sheet 1



# AECOM

**PROJECT**  
Immingham Green Energy Terminal

**CLIENT**  
Associated British Ports  
Air Products (BR) Limited

**CONSULTANT**  
AECOM Limited  
5th Floor  
2 City Walk  
Leeds, LS11 9AR  
www.aecom.com

- LEGEND**
- Site Boundary
  - Watercourse
  - Special Area of Conservation
  - Special Protection Area
  - Site of Special Scientific Interest
  - Ramsar

**NOTES**

© Natural England copyright. Contains Ordnance Survey data © Crown copyright and database right 2023.  
 © Historic England 2023. Contains Ordnance Survey data © Crown copyright and database right 2023. The Historic England GIS Data contained in this material was obtained on 04/09/2023. The most publicly available up to date Historic England GIS Data can be obtained from HistoricEngland.org.uk.  
 Contains Ordnance Survey Data © Crown Copyright and database right 2023. Reproduced from Ordnance Survey digital map data © Crown copyright 2024. All rights reserved. Licence number 0100031673.

**ISSUE PURPOSE**  
Environmental Statement (Further Change Application)

**PROJECT NUMBER**  
60673509

**DEVELOPMENT CONSENT ORDER NO**  
TR030008

**FIGURE TITLE**  
Site and Surrounding Environment  
Sheet 1 of 7

**FIGURE NUMBER**  
Figure 2.1

Sheet 2

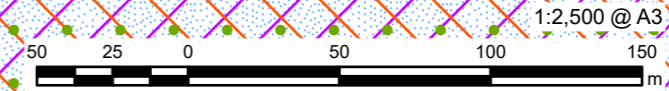

This drawing has been prepared for the use of AECOM's client. It may not be used, modified, reproduced or relied upon by third parties, except as agreed by AECOM or as required by law. AECOM accepts no responsibility, and denies any liability whatsoever, to any party that uses or relies on this drawing without AECOM's express written consent. Do not scale this document. All measurements must be obtained from the stated dimensions.



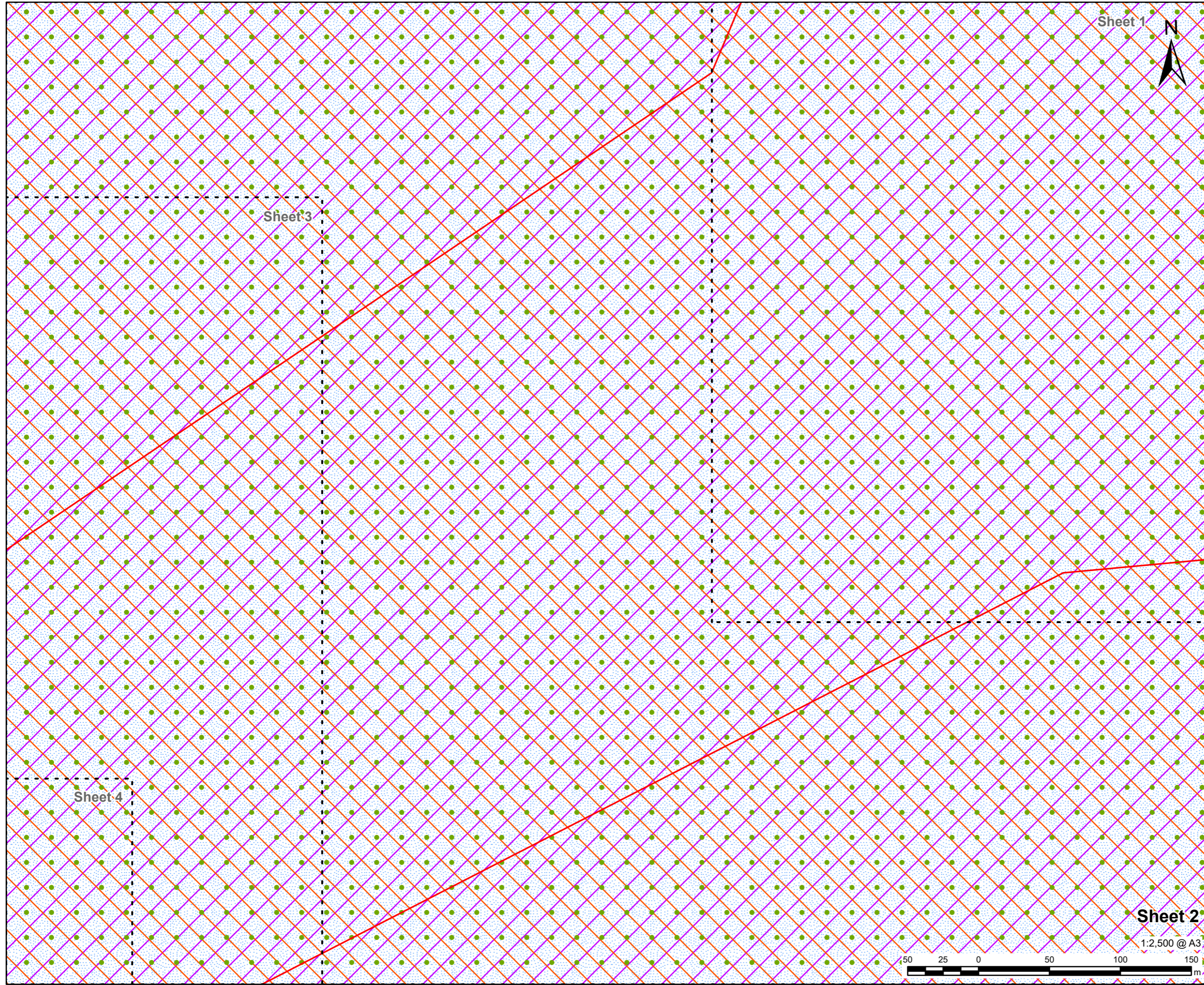



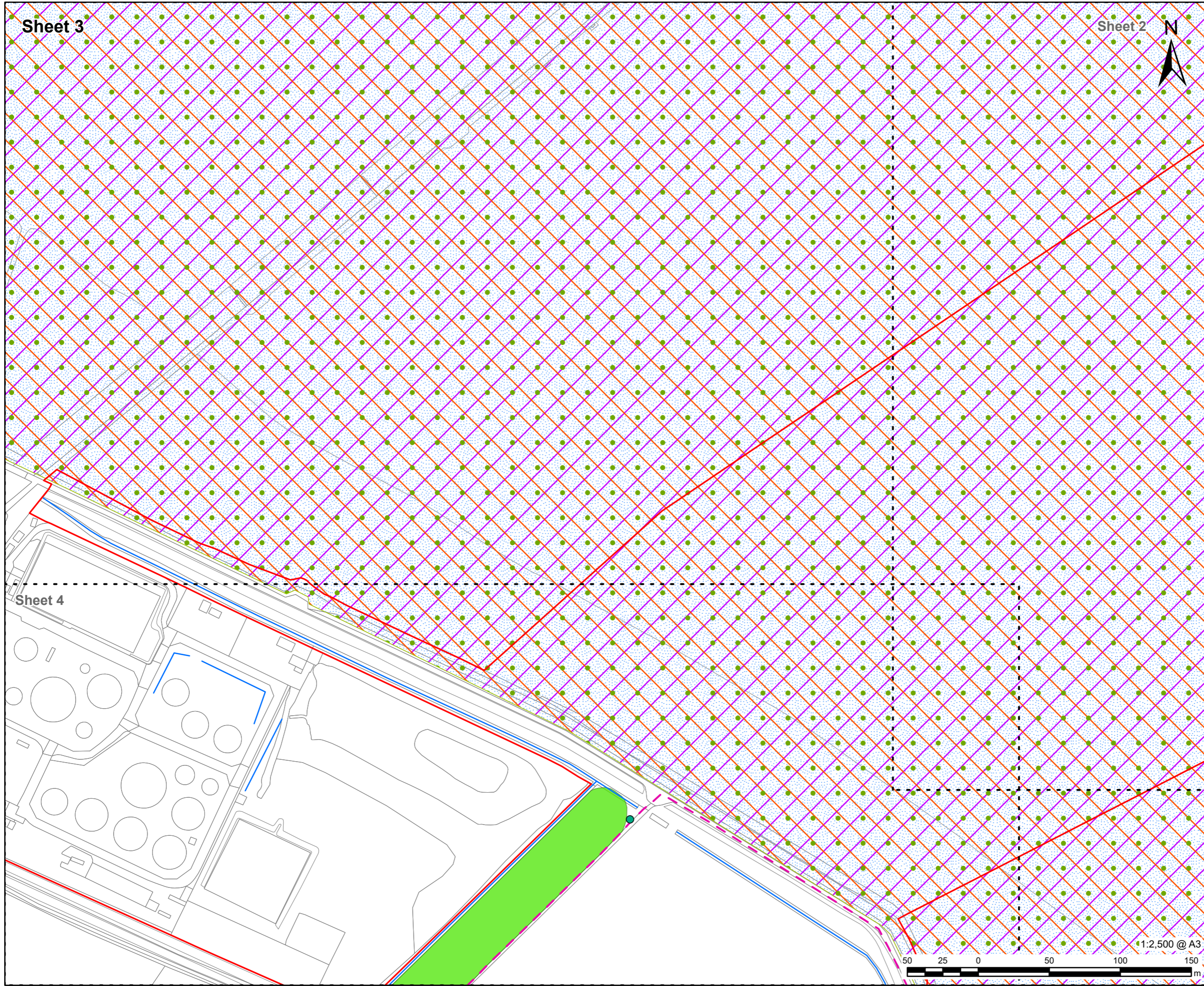

**AECOM**

**PROJECT**  
Immingham Green Energy Terminal

**CLIENT**  
Associated British Ports  
Air Products (BR) Limited

**CONSULTANT**  
AECOM Limited  
5th Floor  
2 City Walk  
Leeds, LS11 9AR  
www.aecom.com

**LEGEND**

- Site Boundary
- Veteran Tree
- Public Right of Way
- Watercourse
- Long Strip Tree Preservation Order
- Special Area of Conservation
- Special Protection Area
- Site of Special Scientific Interest
- Ramsar

**NOTES**

© Natural England copyright. Contains Ordnance Survey data © Crown copyright and database right 2023.  
 © Historic England 2023. Contains Ordnance Survey data © Crown copyright and database right 2023. The Historic England GIS Data contained in this material was obtained on 04/09/2023. The most publicly available up to date Historic England GIS Data can be obtained from HistoricEngland.org.uk.  
 Contains Ordnance Survey Data © Crown Copyright and database right 2023. Reproduced from Ordnance Survey digital map data © Crown copyright 2024. All rights reserved. Licence number 0100031673.

**ISSUE PURPOSE**  
Environmental Statement (Further Change Application)

**PROJECT NUMBER**  
60673509

**DEVELOPMENT CONSENT ORDER NO**  
TR030008

**FIGURE TITLE**  
Site and Surrounding Environment  
Sheet 3 of 7

**FIGURE NUMBER**  
Figure 2.1

1:2,500 @ A3

50 25 0 50 100 150 m

This drawing has been prepared for the use of AECOM's client. It may not be used, modified, reproduced or relied upon by third parties, except as agreed by AECOM or as required by law. AECOM accepts no responsibility, and denies any liability whatsoever, to any party that uses or relies on this drawing without AECOM's express written consent. Do not scale this document. All measurements must be obtained from the stated dimensions.



**PROJECT**

Immingham Green Energy Terminal

**CLIENT**

Associated British Ports  
Air Products (BR) Limited

**CONSULTANT**

AECOM Limited  
5th Floor  
2 City Walk  
Leeds, LS11 9AR  
www.aecom.com

**LEGEND**

- Site Boundary
- Veteran Tree
- A1173
- Public Right of Way
- Watercourse
- Long Strip Tree Preservation Order
- Local Wildlife Site
- Special Area of Conservation
- Special Protection Area
- Site of Special Scientific Interest
- Ramsar

**NOTES**

© Natural England copyright. Contains Ordnance Survey data © Crown copyright and database right 2023.  
© Historic England 2023. Contains Ordnance Survey data © Crown copyright and database right 2023. The Historic England GIS Data contained in this material was obtained on 04/09/2023. The most publicly available up to date Historic England GIS Data can be obtained from HistoricEngland.org.uk.  
Contains Ordnance Survey Data © Crown Copyright and database right 2023. Reproduced from Ordnance Survey digital map data © Crown copyright 2024. All rights reserved. Licence number 0100031673.

**ISSUE PURPOSE**

Environmental Statement (Further Change Application)

**PROJECT NUMBER**

60673509

**DEVELOPMENT CONSENT ORDER NO**

TR030008

**FIGURE TITLE**

Site and Surrounding Environment  
Sheet 4 of 7

**FIGURE NUMBER**

Figure 2.1

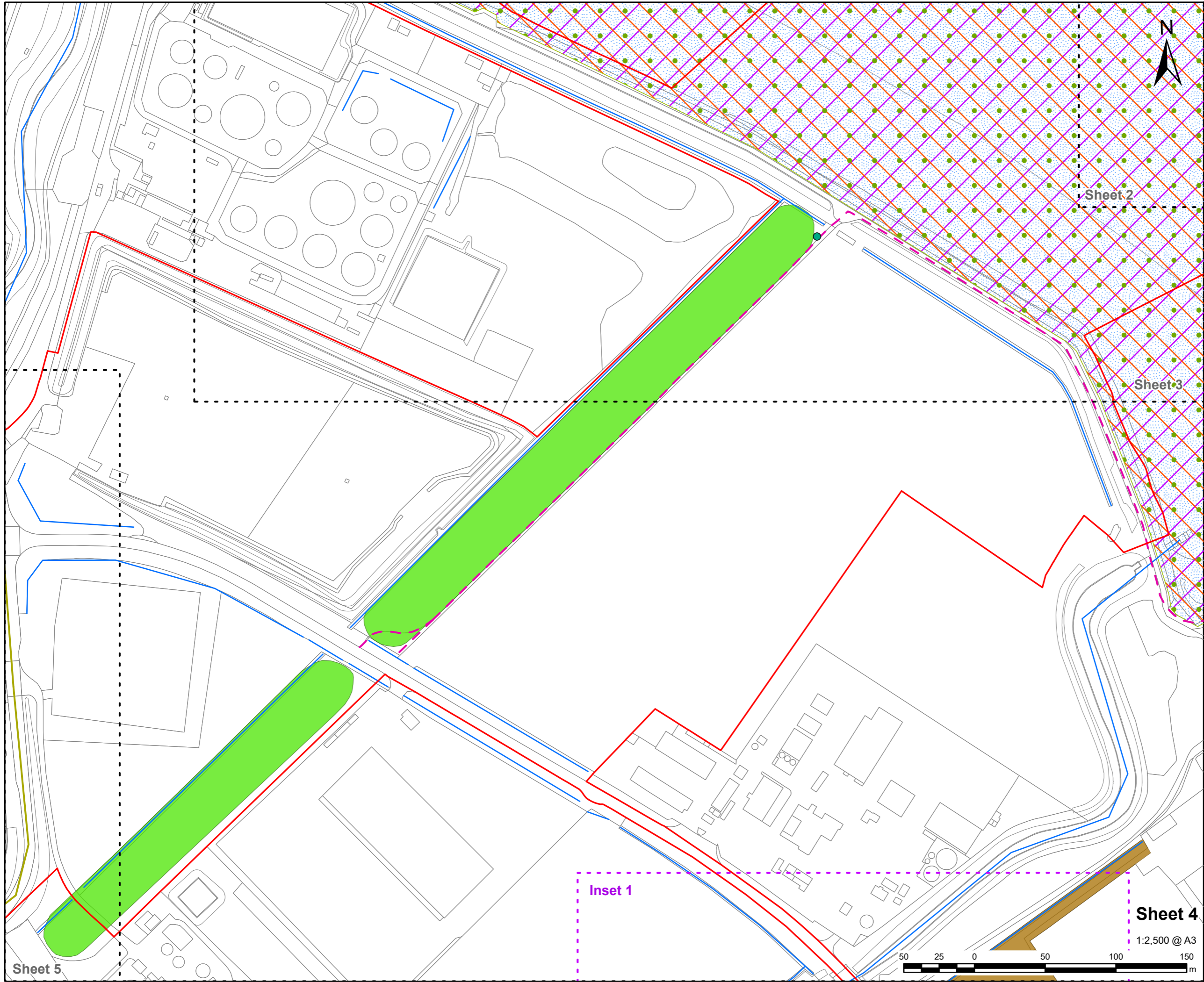

This drawing has been prepared for the use of AECOM's client. It may not be used, modified, reproduced or relied upon by third parties, except as agreed by AECOM or as required by law. AECOM accepts no responsibility, and denies any liability whatsoever, to any party that uses or relies on this drawing without AECOM's express written consent. Do not scale this document. All measurements must be obtained from the stated dimensions.



Sheet 5

Sheet 7

Sheet 6

Sheet 4



# AECOM

**PROJECT**  
Immingham Green Energy Terminal

**CLIENT**  
Associated British Ports  
Air Products (BR) Limited

**CONSULTANT**  
AECOM Limited  
5th Floor  
2 City Walk  
Leeds, LS11 9AR  
www.aecom.com

- LEGEND**
- Site Boundary
  - Residential Receptor
  - A1173
  - Public Right of Way
  - Watercourse
  - Long Strip Tree Preservation Order

**NOTES**

© Natural England copyright. Contains Ordnance Survey data © Crown copyright and database right 2023.  
 © Historic England 2023. Contains Ordnance Survey data © Crown copyright and database right 2023. The Historic England GIS Data contained in this material was obtained on 04/09/2023. The most publicly available up to date Historic England GIS Data can be obtained from HistoricEngland.org.uk.  
 Contains Ordnance Survey Data © Crown Copyright and database right 2023. Reproduced from Ordnance Survey digital map data © Crown copyright 2024. All rights reserved. Licence number 0100031673.

**ISSUE PURPOSE**  
Environmental Statement (Further Change Application)

**PROJECT NUMBER**  
60673509

**DEVELOPMENT CONSENT ORDER NO**  
TR030008

**FIGURE TITLE**  
Site and Surrounding Environment  
Sheet 5 of 7

**FIGURE NUMBER**  
Figure 2.1

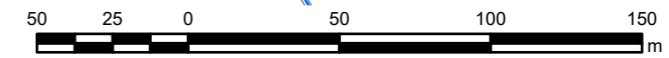

This drawing has been prepared for the use of AECOM's client. It may not be used, modified, reproduced or relied upon by third parties, except as agreed by AECOM or as required by law. AECOM accepts no responsibility, and denies any liability whatsoever, to any party that uses or relies on this drawing without AECOM's express written consent. Do not scale this document. All measurements must be obtained from the stated dimensions.



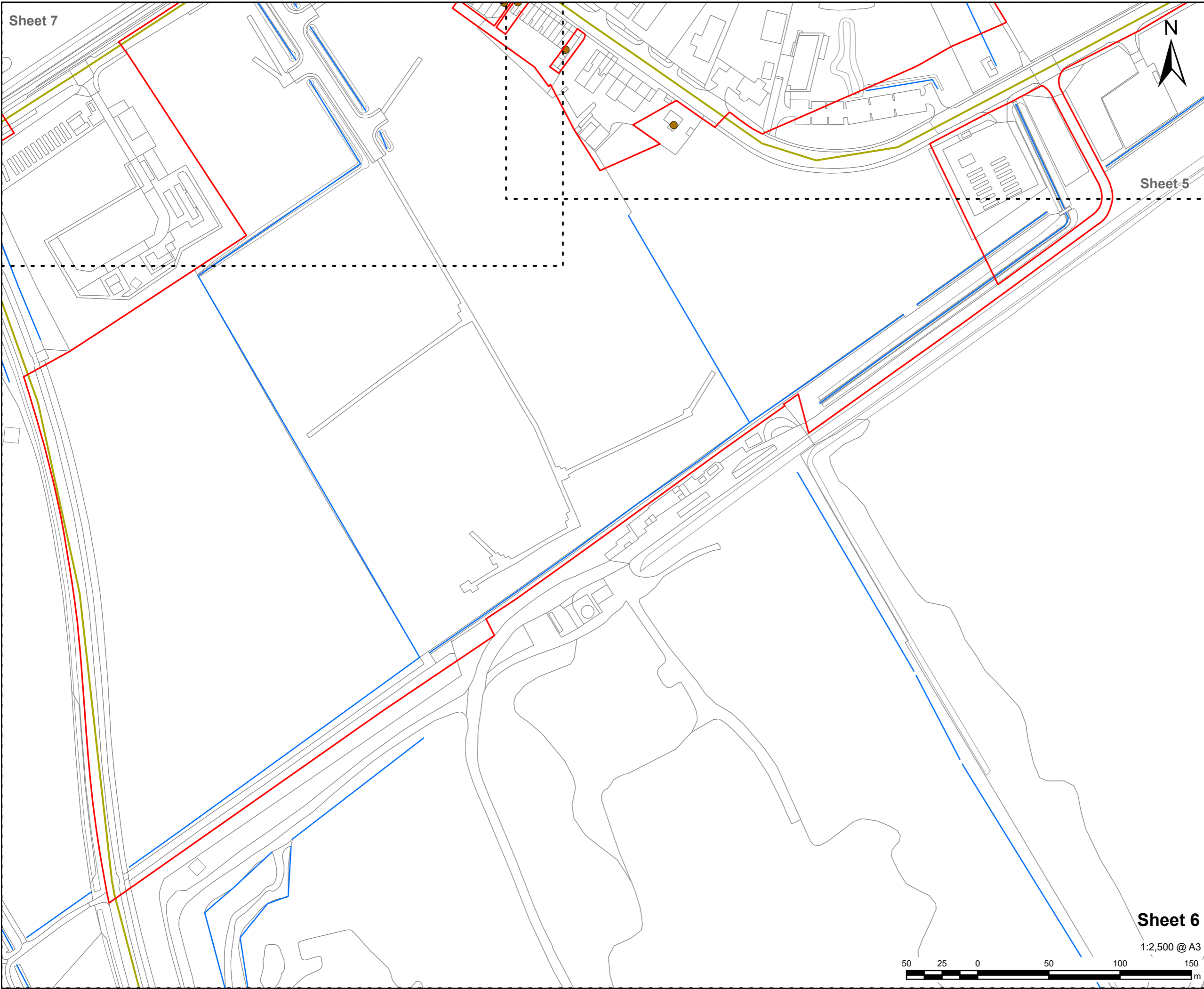

Sheet 7

Sheet 5

Sheet 6

1:2,500 @ A3

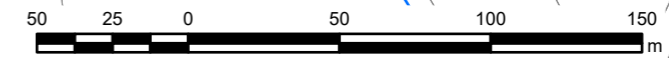

# AECOM

**PROJECT**  
 Immingham Green Energy Terminal

**CLIENT**  
 Associated British Ports  
 Air Products (BR) Limited

**CONSULTANT**  
 AECOM Limited  
 5th Floor  
 2 City Walk  
 Leeds, LS11 9AR  
 www.aecom.com

**LEGEND**

- Site Boundary
- Residential Receptor
- A1173
- Watercourse

**NOTES**

© Natural England copyright. Contains Ordnance Survey data © Crown copyright and database right 2023.  
 © Historic England 2023. Contains Ordnance Survey data © Crown copyright and database right 2023. The Historic England GIS Data contained in this material was obtained on 04/09/2023. The most publicly available up to date Historic England GIS Data can be obtained from HistoricEngland.org.uk.  
 Contains Ordnance Survey Data © Crown Copyright and database right 2023. Reproduced from Ordnance Survey digital map data © Crown copyright 2024. All rights reserved. Licence number 0100031673.

**ISSUE PURPOSE**  
 Environmental Statement (Further Change Application)

**PROJECT NUMBER**  
 60673509

**DEVELOPMENT CONSENT ORDER NO**  
 TR030008

**FIGURE TITLE**  
 Site and Surrounding Environment  
 Sheet 6 of 7

**FIGURE NUMBER**  
 Figure 2.1

This drawing has been prepared for the use of AECOM's client. It may not be used, modified, reproduced or relied upon by third parties, except as agreed by AECOM or as required by law. AECOM accepts no responsibility, and denies any liability whatsoever, to any party that uses or relies on this drawing without AECOM's express written consent. Do not scale this document. All measurements must be obtained from the stated dimensions.



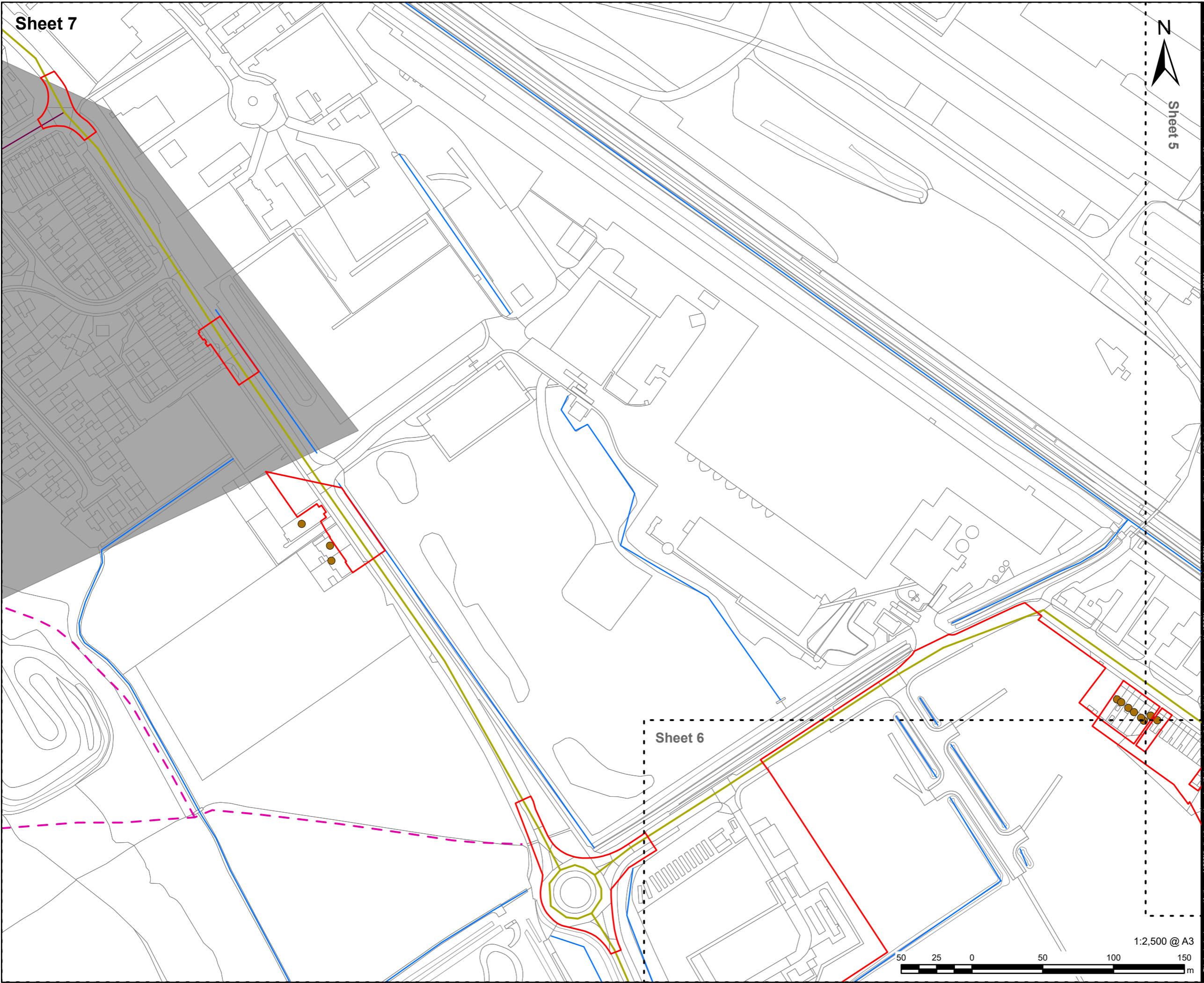

**AECOM**

**PROJECT**  
Immingham Green Energy Terminal

**CLIENT**  
Associated British Ports  
Air Products (BR) Limited

**CONSULTANT**  
AECOM Limited  
5th Floor  
2 City Walk  
Leeds, LS11 9AR  
www.aecom.com

**LEGEND**

- Site Boundary
- Residential Receptor
- A1173
- Other Road
- Public Right of Way
- Watercourse
- Residential Area

**NOTES**

© Natural England copyright. Contains Ordnance Survey data © Crown copyright and database right 2023.  
 © Historic England 2023. Contains Ordnance Survey data © Crown copyright and database right 2023. The Historic England GIS Data contained in this material was obtained on 04/09/2023. The most publicly available up to date Historic England GIS Data can be obtained from HistoricEngland.org.uk.  
 Contains Ordnance Survey Data © Crown Copyright and database right 2023. Reproduced from Ordnance Survey digital map data © Crown copyright 2024. All rights reserved. Licence number 0100031673.

**ISSUE PURPOSE**  
Environmental Statement (Further Change Application)

**PROJECT NUMBER**  
60673509

**DEVELOPMENT CONSENT ORDER NO**  
TR030008

**FIGURE TITLE**  
Site and Surrounding Environment  
Sheet 7 of 7

**FIGURE NUMBER**  
Figure 2.1

This drawing has been prepared for the use of AECOM's client. It may not be used, modified, reproduced or relied upon by third parties, except as agreed by AECOM or as required by law. AECOM accepts no responsibility, and denies any liability whatsoever, to any party that uses or relies on this drawing without AECOM's express written consent. Do not scale this document. All measurements must be obtained from the stated dimensions.



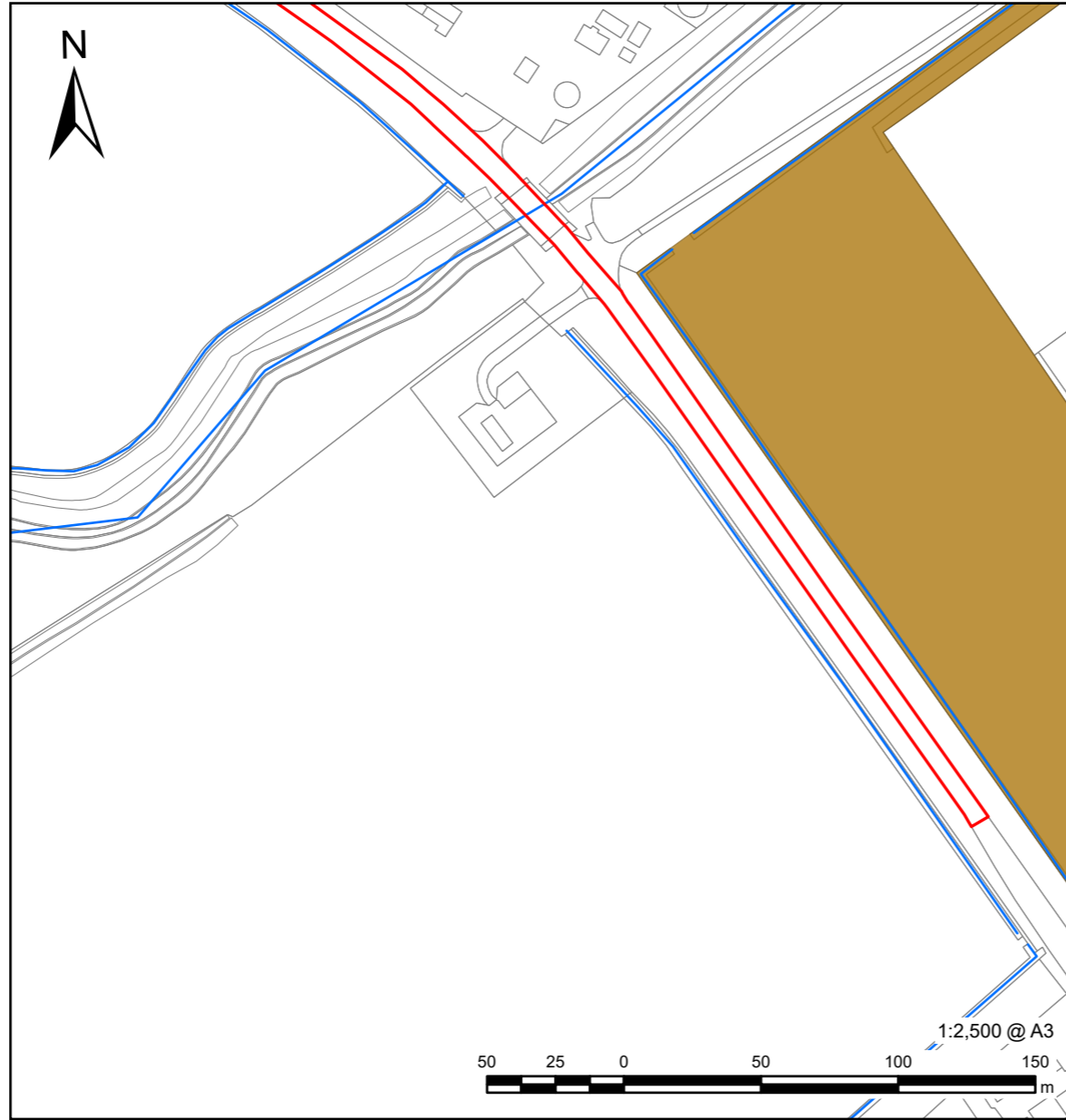

**PROJECT**

Immingham Green Energy Terminal

**CLIENT**

Associated British Ports  
Air Products (BR) Limited

**CONSULTANT**

AECOM Limited  
5th Floor  
2 City Walk  
Leeds, LS11 9AR  
www.aecom.com

**LEGEND**

- Site Boundary
- Watercourse
- Local Wildlife Site

**NOTES**

© Natural England copyright. Contains Ordnance Survey data © Crown copyright and database right 2023.  
 © Historic England 2023. Contains Ordnance Survey data © Crown copyright and database right 2023. The Historic England GIS Data contained in this material was obtained on 04/09/2023. The most publicly available up to date Historic England GIS Data can be obtained from [HistoricEngland.org.uk](http://HistoricEngland.org.uk).  
 Contains Ordnance Survey Data © Crown Copyright and database right 2023. Reproduced from Ordnance Survey digital map data © Crown copyright 2024. All rights reserved. Licence number 0100031673.

**ISSUE PURPOSE**

Environmental Statement (Further Change Application)

**PROJECT NUMBER**

60673509

**DEVELOPMENT CONSENT ORDER NO**

TR030008

**FIGURE TITLE**

Site and Surrounding Environment Inset 1

**FIGURE NUMBER**

Figure 2.1

This drawing has been prepared for the use of AECOM's client. It may not be used, modified, reproduced or relied upon by third parties, except as agreed by AECOM or as required by law. AECOM accepts no responsibility, and denies any liability whatsoever, to any party that uses or relies on this drawing without AECOM's express written consent. Do not scale this document. All measurements must be obtained from the stated dimensions.