

Revision: 1 Drawn: EB Checked: DF Approved: BP Date: 2023-09-13  
 Filename: L:\Legacy\UKMCR1\F002-V1\Proposals\1512\Immingham GET GIS\02\_Maps\Environmental Statement\GET\_ES\_CH23\_Fig23-1\_Socio\_Economic\_Receptors\_Site\_Boundary\_20230913\_EB.aprx

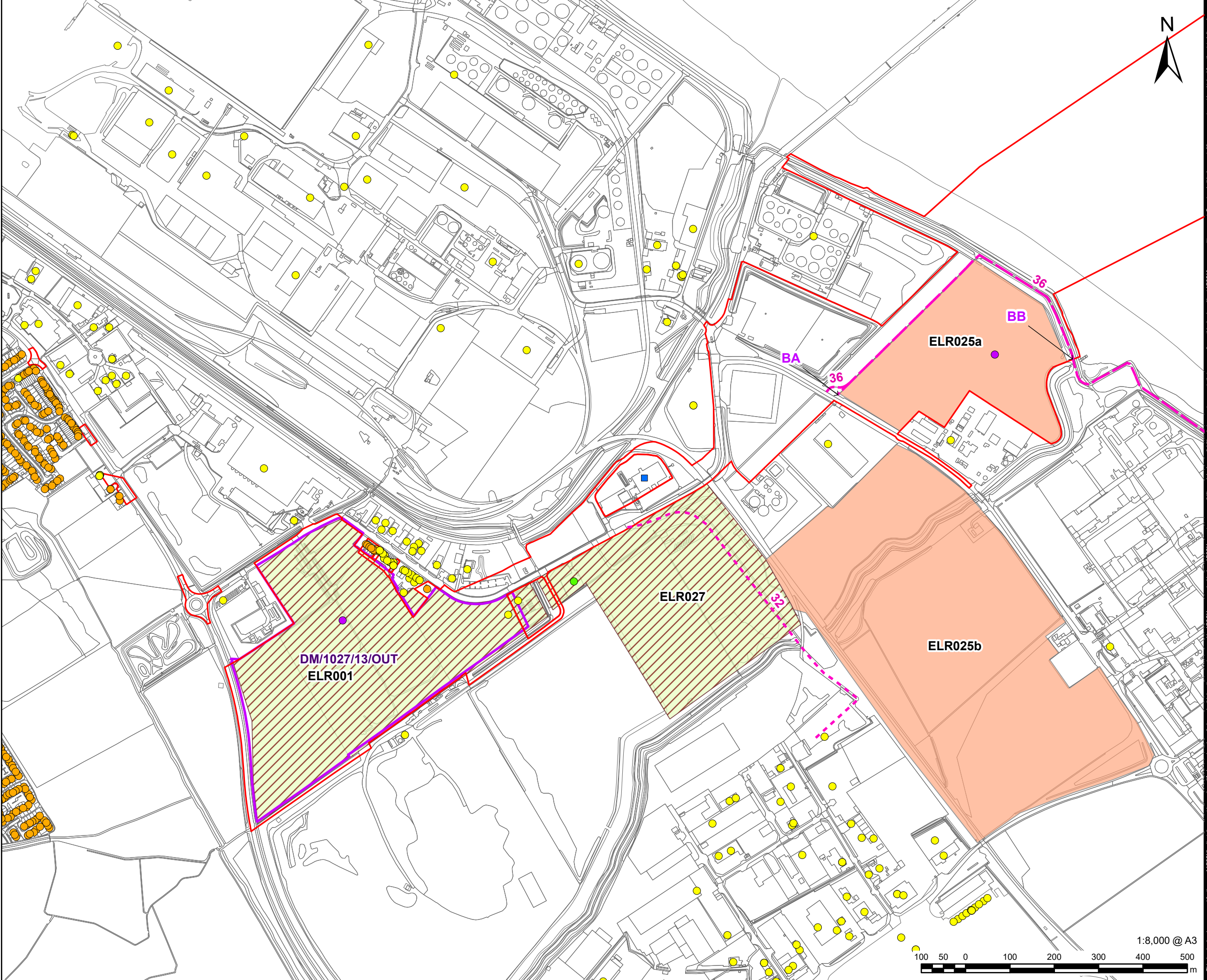

# AECOM

**PROJECT**  
 Immingham Green Energy Terminal

**CLIENT**  
 Associated British Ports  
 Air Products (BR) Limited

**CONSULTANT**  
 AECOM Limited  
 5th Floor  
 2 City Walk  
 Leeds, LS11 9AR  
 www.aecom.com

- LEGEND**
- Site Boundary
  - Private Assets**
    - Residential Properties
    - Business Premises
    - Community Facilities
    - Agricultural Land
    - Border Control Post
  - Public Rights of Way**
    - Public Footpath
    - Bridleway
    - Planning Permission
  - Employment Area**
    - Employment - Proposed Allocation
    - Employment - Retained for Long Term Business Use
    - Enterprise Zone

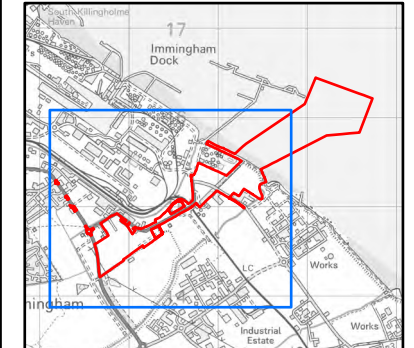

**NOTES**  
 Reproduced from Ordnance Survey digital map data © Crown copyright 2022. All rights reserved. Licence number 0100031673.

**ISSUE PURPOSE**  
 Environmental Statement

**PROJECT NUMBER**  
 60673509

**DEVELOPMENT CONSENT ORDER NO**  
 TR030008

**FIGURE TITLE**  
 Socio-Economic Receptors within the Site Boundary

**FIGURE NUMBER**  
 Figure 23.1