

April 2023

# London Luton Airport Expansion

Planning Inspectorate Scheme Ref: TR020001

Volume 4 Plans and Sections  
**4.04 Work Plans (Part 4 of 6)**

Application Document Ref: TR020001/APP/4.04  
APFP Regulation: 5(2)(j)

**The Planning Act 2008**

**The Infrastructure Planning (Applications: Prescribed Forms and Procedure) Regulations 2009**

**London Luton Airport Expansion Development Consent Order 202x**

---

**4.04 WORK PLANS (Part 4 of 6)**

---

<b>Regulation number:</b>	Regulation 5(2)(j)
<b>Planning Inspectorate Scheme Reference:</b>	TR020001
<b>Document Reference:</b>	TR020001/APP/4.04
<b>Author:</b>	Luton Rising

<b>Version</b>	<b>Date</b>	<b>Status of Version</b>
Issue 1	February 2023	Application issue
Revision 1	April 2023	Additional submissions (amended following section 51 advice)

# Contents

---

	Page
<b>1 Work Plans</b>	<b>2</b>
1.1 Purpose of this document	2
1.2 Scope and format of the Work Plans	2
1.3 Work Plans Drawings list	3

# 1 WORK PLANS

## 1.1 Purpose of this document

- 1.1.1 Luton Rising (a trading name of London Luton Airport Limited), owners of London Luton Airport (the Applicant) has submitted an application under section 37 of the Planning Act 2008 for an order to grant development consent for the expansion of London Luton Airport (the Proposed Development).
- 1.1.2 This document is part of a suite of documents which forms part of the application for development consent. A full description of all the application documents is provided in the Introduction to the Application) [TR020001/APP/1.03] which also forms part of the suite of application documents.
- 1.1.3 This document is included in the application to comply with Regulation 5(2)(j) and Regulation 5(4) of the Infrastructure Planning (Applications: Prescribed Forms and Procedures) Regulations 2009 (“the 2009 Regulations”), which requires:
- a. 5(2)(j) ‘a works plan showing, in relation to existing features -
    - i. The proposed location or (for a linear scheme) the proposed route and alignment of the development and works; and
    - ii. The limits within which the development and works may be carried out and any limits of deviation provided for in the draft order’
- 1.1.4 Regulation 5(4) requires that ‘Where a plan comprises three or more separate sheets a key plan must be provided showing the relationship between the different sheets’. There are 10 sheets required to cover the development area which the Applicant has called tiles.
- 1.1.5 The application has referred to both tiles and sheets. Tiles are used to show the 10 geographical areas to cover the development area and sheets are used to show the number of drawings required to show the works.
- 1.1.6 Accordingly, a key plan is submitted as part of the application to identify the location of the Proposed Development in its wider geographical context.
- 1.1.7 As this document is part of the application documentation, it should be read alongside, and is informed by, the other application documents. In particular, the plans should be read alongside Schedule 1 of the draft Order [TR020001/APP/2.01], the Land Plans [TR020001/APP/4.03] and the Scheme Layout Plans [TR020001/APP/4.02].

## 1.2 Scope and format of the Work Plans

- 1.2.1 The purpose of the Work Plans is to illustrate the location and extent of the works for which development consent is sought as described in Schedule 1 of the draft Order [TR020001/APP/2.01]. The Applicant has sought to describe the works in Schedule 1 applying, whenever necessary, separate sub-work numbers to provide clarity. The works are grouped together as one of 6 work types with an alpha-numeric reference corresponding to the Work Plans. For example, works with a Work No.1 number relate to sitewide major works to enable development, Work No.2 numbers relate to airfield works, works with a Work No.3 number relate to terminal and associated works, Work No.4 numbers relate to airport support facilities, Work No.5 numbers relate to landscaping works and Work No.6 numbers relate to highway works.
- 1.2.2 Some works have been further sub-divided and categorised by reference to a (01), (02) etc. suffix. This has been done to identify works which either relate to the same physical location and which are proposed to be delivered at different stages of the development (e.g. Work No.3b(01) and Work No 3b(02)), or are similar in nature to other works and have been grouped together.
- 1.2.3 The Work Plans present each subset of works (i.e. the works within each of the 6 work categories) separately. This is to aid legibility of the plans given the complicated nature of the Proposed Development which involved multiple works being constructed in the same location at different stages of the Proposed Development.
- 1.2.4 For each of the 6 work types, a key plan has been included to show the interaction between all of the works in that series. This has been provided so that all of the works can be seen on one page. The key plan highlights the tiles which show the works that are required within each subset. Within the notes column is a list of the tiles used and their associated sheets.
- 1.2.5 Each sub-work number has then been shown on a separate sheet so that its location and extent is clear to see. In some cases, where the works are not overlapping in location, sub-works have been grouped together on one sheet to show their location. For ease of reference, the following table sets out which sub-works are on which sheet:

### 1.3 Work Plans Drawings list

Work Plan Name	Drawing Number	Work No.
Work Plans Schedule	LLADCO-3C-CAP-WHS-WRK-DR-AR-0001	
Work Plans Sitewide Major Works to Enable Development Scheme Layout Overview - Key Plan - All Tiles - Sheet 1 of 4	LLADCO-3C-CAP-WHS-WRK-DR-AR-0100	Overview
Work Plans Sitewide Major Works to Enable Development Scheme Layout Overview - Tile 05 (1 of 2) - Sheet 2 of 4	LLADCO-3C-CAP-WHS-WRK-DR-AR-0150	1a
Work Plans Sitewide Major Works to Enable Development Scheme Layout Overview - Tile 05 (2 of 2) - Sheet 3 of 4	LLADCO-3C-CAP-WHS-WRK-DR-AR-0151	1b
Work Plans Sitewide Major Works to Enable Development Scheme Layout Overview - Tile 06 (1 of 1) - Sheet 4 of 4	LLADCO-3C-CAP-WHS-WRK-DR-AR-0160	1a
Work Plans Airfield Works Scheme Layout Overview - Key Plan - All Tiles - Sheet 1 of 10	LLADCO-3C-CAP-WHS-WRK-DR-AR-0200	Overview
Work Plans Airfield Works Scheme Layout Tile 01 (1 of 2) - Sheet 2 of 10	LLADCO-3C-CAP-WHS-WRK-DR-AR-0210	2b(01), 2b(02)
Work Plans Airfield Works Scheme Layout Tile 01 (2 of 2) - Sheet 3 of 10	LLADCO-3C-CAP-WHS-WRK-DR-AR-0211	2h(01), 2c(04)
Work Plans Airfield Works Scheme Layout Tile 02 (1 of 1) - Sheet 4 of 10	LLADCO-3C-CAP-WHS-WRK-DR-AR-0220	2c(03)
Work Plans Airfield Works Scheme Layout Tile 04 (1 of 3) - Sheet 5 of 10	LLADCO-3C-CAP-WHS-WRK-DR-AR-0240	2a(02), 2b(01), 2b(03), 2b(04), 2c(04), 2d, 2h(02),
Work Plans Airfield Works Scheme Layout Tile 04 (2 of 3) - Sheet 6 of 10	LLADCO-3C-CAP-WHS-WRK-DR-AR-0241	2a (01), 2c(01), 2c(02)
Work Plans Airfield Works Scheme Layout Tile 04 (3 of 3) - Sheet 7 of 10	LLADCO-3C-CAP-WHS-WRK-DR-AR-0242	2e, 2f, 2h(01)
Work Plans Airfield Works Scheme Layout Tile 05 (1 of 3) - Sheet 8 of 10	LLADCO-3C-CAP-WHS-WRK-DR-AR-0250	2b(03), 2b(04), 2c(03), 2c(04), 2h (02)
Work Plans Airfield Works Scheme Layout Tile 05 (2 of 3) - Sheet 9 of 10	LLADCO-3C-CAP-WHS-WRK-DR-AR-0251	2a(01), 2c(01), 2c(02)
Work Plans Airfield Works Scheme Layout Tile 05 (3 of 3) - Sheet 10 of 10	LLADCO-3C-CAP-WHS-WRK-DR-AR-0252	2e, 2f, 2g, 2h(01)
Work Plans Terminal and Associated Works Scheme Layout Overview - Key Plan - All Tiles - Sheet 1 of 4	LLADCO-3C-CAP-WHS-WRK-DR-AR-0300	Overview
Work Plans Terminal and Associated Works Scheme Layout Tile 05 (1 of 3) - Sheet 2 of 4	LLADCO-3C-CAP-WHS-WRK-DR-AR-0350	3a(01), 3a(02), 3a(03), 3a(04), 3a(05), 3b(01), 3e(02), 3i
Work Plans Terminal and Associated Works Scheme Layout Tile 05 (2 of 3) - Sheet 3 of 4	LLADCO-3C-CAP-WHS-WRK-DR-AR-0351	3c(01), 3c(02), 3e(01), 3f, 3h
Work Plans Terminal and Associated Works Scheme Layout Tile 05 (3 of 3) - Sheet 4 of 4	LLADCO-3C-CAP-WHS-WRK-DR-AR-0352	3b(02), 3d, 3g
Work Plans Airport Support Facilities Scheme Layout Overview - Key Plan - All Tiles - Sheet 1 of 10	LLADCO-3C-CAP-WHS-WRK-DR-AR-0400	Overview
Work Plans Airport Support Facilities Scheme Layout Tile 01 (1 of 2) - Sheet 2 of 10	LLADCO-3C-CAP-WHS-WRK-DR-AR-0410	4c(01), 4g, 4i
Work Plans Airport Support Facilities Scheme Layout Tile 01 (2 of 2) - Sheet 3 of 10	LLADCO-3C-CAP-WHS-WRK-DR-AR-0411	4h

Work Plan Name	Drawing Number	Work No.
Work Plans Airport Support Facilities Scheme Layout Tile 02 (1 of 2) - Sheet 4 of 10	LLADCO-3C-CAP-WHS-WRK-DR-AR-0420	4c(01), 4i, 4j, 4s, 4t(01-06), 4u
Work Plans Airport Support Facilities Scheme Layout Tile 02 (2 of 2) - Sheet 5 of 10	LLADCO-3C-CAP-WHS-WRK-DR-AR-0421	4b, 4o(01), 4w
Work Plans Airport Support Facilities Scheme Layout Tile 04 (1 of 1) - Sheet 6 of 10	LLADCO-3C-CAP-WHS-WRK-DR-AR-0440	4c(01), 4j
Work Plans Airport Support Facilities Scheme Layout Tile 05 (1 of 3) - Sheet 7 of 10	LLADCO-3C-CAP-WHS-WRK-DR-AR-0450	4c(01), 4d, 4f, 4j, 4k(01), 4l(01), 4m(01), 4n, 4o(02), 4t(02, 04, 05)
Work Plans Airport Support Facilities Scheme Layout Tile 05 (2 of 3) - Sheet 8 of 10	LLADCO-3C-CAP-WHS-WRK-DR-AR-0451	4k(02), 4l(02), 4m(02), 4o(01), 4p(01), 4q(01), 4x
Work Plans Airport Support Facilities Scheme Layout Tile 05 (3 of 3) - Sheet 9 of 10	LLADCO-3C-CAP-WHS-WRK-DR-AR-0452	4a, 4e, 4q(02), 4r, 4v, 4w
Work Plans Airport Support Facilities Scheme Layout Tile 06 (1 of 1) - Sheet 10 of 10	LLADCO-3C-CAP-WHS-WRK-DR-AR-0460	4c(01), 4c(02), 4d, 4p(01), 4p(02)
Work Plans Landscaping and Mitigation Scheme Layout Overview - Key Plan - All Tiles - Sheet 1 of 14	LLADCO-3C-CAP-WHS-WRK-DR-AR-0500	Overview
Work Plans Landscaping and Mitigation Scheme Layout Tile 01 (1 of 1) - Sheet 2 of 14	LLADCO-3C-CAP-WHS-WRK-DR-AR-0510	5a
Work Plans Landscaping and Mitigation Scheme Layout Tile 02 (1 of 1) - Sheet 3 of 14	LLADCO-3C-CAP-WHS-WRK-DR-AR-0520	5a
Work Plans Landscaping and Mitigation Scheme Layout Tile 03 (1 of 3) - Sheet 4 of 14	LLADCO-3C-CAP-WHS-WRK-DR-AR-0530	5b(01), 5b(02)
Work Plans Landscaping and Mitigation Scheme Layout Tile 03 (2 of 3) - Sheet 5 of 14	LLADCO-3C-CAP-WHS-WRK-DR-AR-0531	5c(02), 5e
Work Plans Landscaping and Mitigation Scheme Layout Tile 03 (3 of 3) - Sheet 6 of 14	LLADCO-3C-CAP-WHS-WRK-DR-AR-0532	5c(01)
Work Plans Landscaping and Mitigation Scheme Layout Tile 04 (1 of 1) - Sheet 7 of 14	LLADCO-3C-CAP-WHS-WRK-DR-AR-0540	5c(02), 5b(04), 5e
Work Plans Landscaping and Mitigation Scheme Layout Tile 05 (1 of 3) - Sheet 8 of 14	LLADCO-3C-CAP-WHS-WRK-DR-AR-0550	5b(01), 5b(02)
Work Plans Landscaping and Mitigation Scheme Layout Tile 05 (2 of 3) - Sheet 9 of 14	LLADCO-3C-CAP-WHS-WRK-DR-AR-0551	5c(02)
Work Plans Landscaping and Mitigation Scheme Layout Tile 05 (3 of 3) - Sheet 10 of 14	LLADCO-3C-CAP-WHS-WRK-DR-AR-0552	5b(03), 5b(04), 5b(06), 5b(07), 5c(01)
Work Plans Landscaping and Mitigation Scheme Layout Tile 06 (1 of 2) - Sheet 11 of 14	LLADCO-3C-CAP-WHS-WRK-DR-AR-0560	5b(02), 5c(02), 5d(01), 5d(02)
Work Plans Landscaping and Mitigation Scheme Layout Tile 06 (2 of 2) - Sheet 12 of 14	LLADCO-3C-CAP-WHS-WRK-DR-AR-0561	5b(04-06), 5e
Work Plans Landscaping and Mitigation Scheme Layout Tile 07 (1 of 2) - Sheet 13 of 14	LLADCO-3C-CAP-WHS-WRK-DR-AR-0570	5b(02), 5d(01)
Work Plans Landscaping and Mitigation Scheme Layout Tile 07 (2 of 2) - Sheet 14 of 14	LLADCO-3C-CAP-WHS-WRK-DR-AR-0571	5b(03-07), 5e
Work Plans Airport Access Roads and Offsite Highway Works Scheme Layout Overview – Key Plan - All Tiles - Sheet 1 of 14	LLADCO-3C-CAP-WHS-WRK-DR-AR-0600	Overview
Work Plans Airport Access Roads and Offsite Highway Works Scheme Layout Tile 01 (1 of 2) - Sheet 2 of 14	LLADCO-3C-CAP-WHS-WRK-DR-AR-0610	6a(02), 6e(c), 6e(b)
Work Plans Airport Access Roads and Offsite Highway Works Scheme Layout Tile 01 (2 of 2) - Sheet 3 of 14	LLADCO-3C-CAP-WHS-WRK-DR-AR-0611	6a(01)

Work Plan Name	Drawing Number	Work No.
Work Plans Airport Access Roads and Offsite Highway Works Scheme Layout Tile 02 (1 of 2) - Sheet 4 of 14	LLADCO-3C-CAP-WHS-WRK-DR-AR-0620	6a(02), 6c(01), 6e(d), 6e(q), 6e(r)
Work Plans Airport Access Roads and Offsite Highway Works Scheme Layout Tile 02 (2 of 2) - Sheet 5 of 14	LLADCO-3C-CAP-WHS-WRK-DR-AR-0621	6a(01), 6a(03), 6b(01), 6c(01), 6e(f)
Work Plans Airport Access Roads and Offsite Highway Works Scheme Layout Tile 03 (1 of 2) - Sheet 6 of 14	LLADCO-3C-CAP-WHS-WRK-DR-AR-0630	6a(02), 6b(02), 6e(d), 6e(e), 6e(j), 6e(q)
Work Plans Airport Access Roads and Offsite Highway Works Scheme Layout Tile 03 (2 of 2) - Sheet 7 of 14	LLADCO-3C-CAP-WHS-WRK-DR-AR-0631	6b(01), 6b(03), 6e(f)
Work Plans Airport Access Roads and Offsite Highway Works Scheme Layout Tile 05 (1 of 2) - Sheet 8 of 14	LLADCO-3C-CAP-WHS-WRK-DR-AR-0650	6a(02), 6b(02), 6c(01)
Work Plans Airport Access Roads and Offsite Highway Works Scheme Layout Tile 05 (2 of 2) - Sheet 9 of 14	LLADCO-3C-CAP-WHS-WRK-DR-AR-0651	6b(01), 6b(03), 6c(02), 6c(03), 6e(f)
Work Plans Airport Access Roads and Offsite Highway Works Scheme Layout Tile 06 (1 of 1) - Sheet 10 of 14	LLADCO-3C-CAP-WHS-WRK-DR-AR-0660	6b(02), 6b(03), 6d
Work Plans Airport Access Roads and Offsite Highway Works Scheme Layout Tile 08 (1 of 3) - Sheet 11 of 14	LLADCO-3C-CAP-WHS-WRK-DR-AR-0680	6e(g), 6e(h), 6e(n)
Work Plans Airport Access Roads and Offsite Highway Works Scheme Layout Tile 08 (2 of 3) - Sheet 12 of 14	LLADCO-3C-CAP-WHS-WRK-DR-AR-0681	6e(o)
Work Plans Airport Access Roads and Offsite Highway Works Scheme Layout Tile 08 (3 of 3) - Sheet 13 of 14	LLADCO-3C-CAP-WHS-WRK-DR-AR-0682	6e(p)
Work Plans Airport Access Roads and Offsite Highway Works Scheme Layout Tiles 09 and 10 (1 of 1) - Sheet 14 of 14	LLADCO-3C-CAP-WHS-WRK-DR-AR-0690	6e(a), 6e(i), 6e(k), 6e(l), 6e(m)

This drawing may contain mapping by permission of Ordnance Survey on behalf of HMSSO © Crown Copyright and database rights 2022 Ordnance Survey 0100031673  
 All structure positions are indicative. The proposed works will be subject to detailed design development. The changes will be within limits of deviation specified in the Development Consent Order.

**NOTES**

1. These plans should be read in conjunction with Schedule 1 (Authorised development) of the Development Consent Order (TR020001/APP/2.01), Scheme Layout Plans (4.02), the Land Plans (4.03), Crown Land Plans (4.14), General Arrangement Drawings (4.09), and the Airport Access Road and Luton DART Long Section Drawings (4.11).
2. The layout of the works shown on the Work Plans is illustrative only. Exact details concerning configuration and dimensions will be determined and designed at the design stage in line with provisions of the Development Consent Order. Any changes will be limited to being within the constraints included in the Development Consent Order, including the requirements in Schedule 2 (Requirements).

**KEY**

- Order Limits
- - - Local Authority Boundary
- Former Eaton Green Landfill Boundary
- Sitewide Major Works to Enable Development
- Airfield Works
- Terminal and Associated Works
- Airport Support Facilities
- Landscaping and Mitigation
- Airport Access Roads and Offsite Highway Works

Tiles shown on sheet 0400 in yellow contain applicable work areas for Airport Support Facilities. Tiles shown in grey do not contain work areas and are omitted.

The following tiles correspond to the following sheets:

All Tiles / Keyplan	- 0400
Tile 1	- 0410 and 0411
Tile 2	- 0420 and 0421
Tile 3	- Omitted
Tile 4	- 0440
Tile 5	- 0450, 0451 and 0452
Tile 6	- 0460
Tile 7	- Omitted
Tile 8	- Omitted
Tile 9	- Omitted
Tile 10	- Omitted

There are a total of 10 sheets for the Airport Support Facilities Work Plans.

Additional submissions (amended following section 51 advice)	LC	GRM / GU	04/23	P02
DCO Submission	LC	GRM / GU	27/02/23	P01

Revision History				
Drawn	Checked	Approved	Date	Rev.

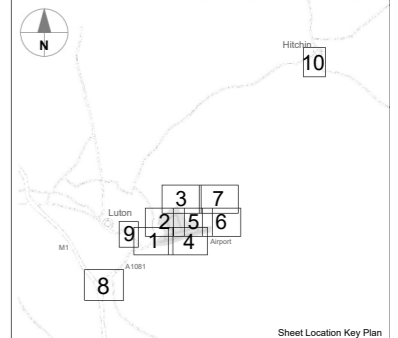

**London Luton Airport Expansion Development Consent Order**

Drawing Title  
**Work Plans  
 Airport Support Facilities  
 Scheme Layout  
 Key Plan - All Tiles - Sheet 1 of 10**

Purpose of Issue	Additional submissions (amended following section 51 advice)	Suitability	S6
Drawn	Checked	Approved	Date
LC	GRM	GU	04/23
DCO Application Ref.	APFP Regulation	DCO Document Ref.	Scale
TR020001	5(2)(j)	TR020001/APP/4.04	NTS
Drawing Number	Project - Phase - Originator - Asset/Zone - Sub Asset - Type - Discp. - Number	Revision	Size
LLADCO-3C-CAP-WHS-WRK-DR-AR-0400		P02	A1

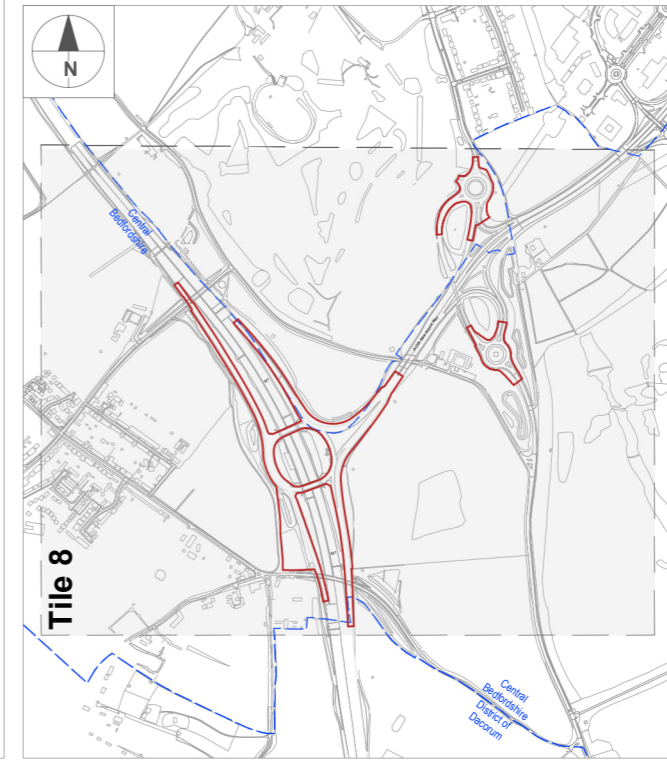
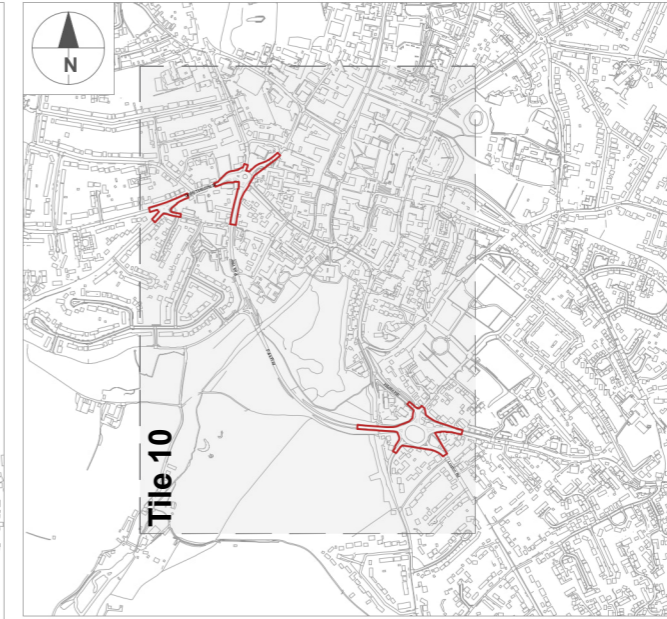
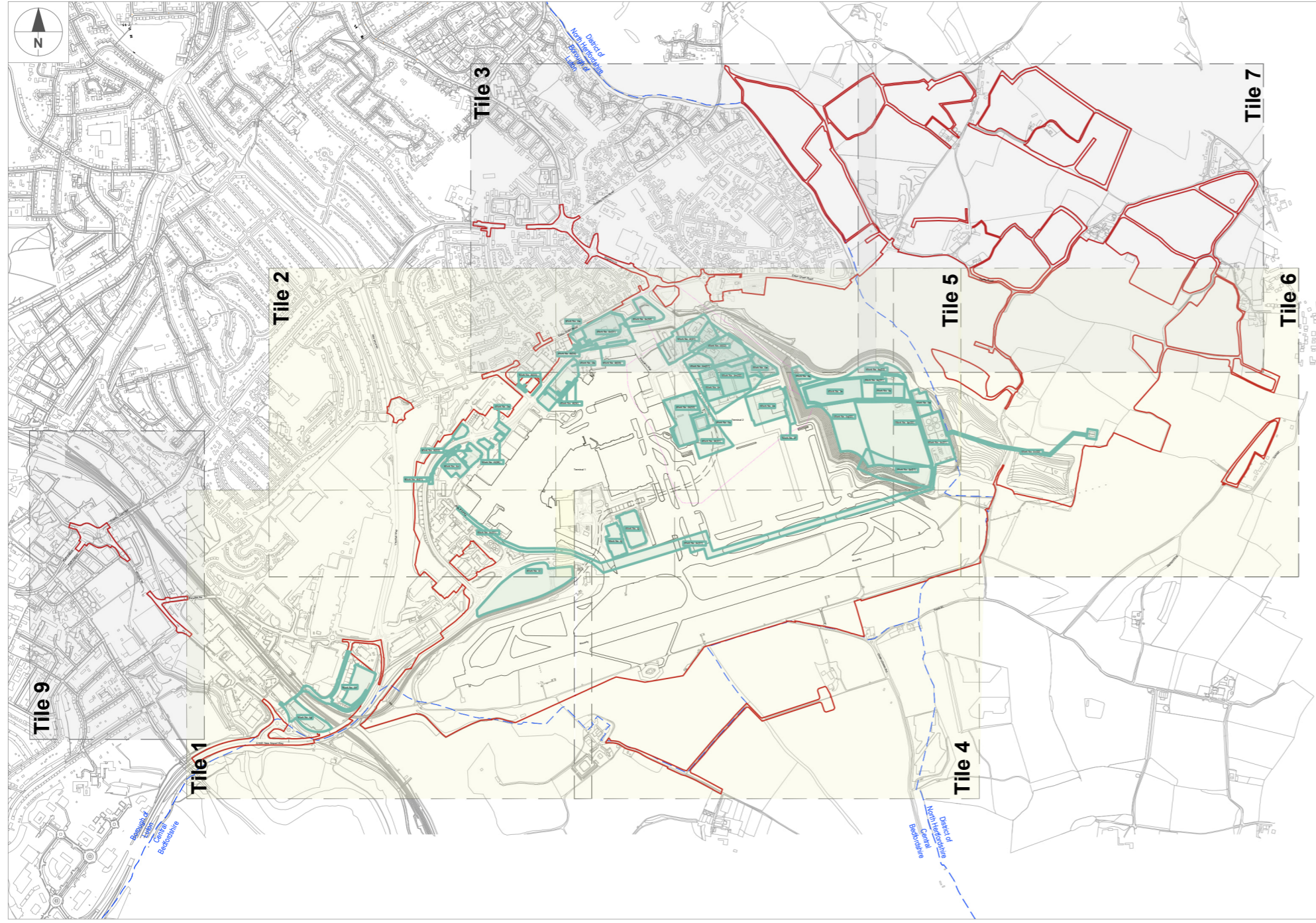



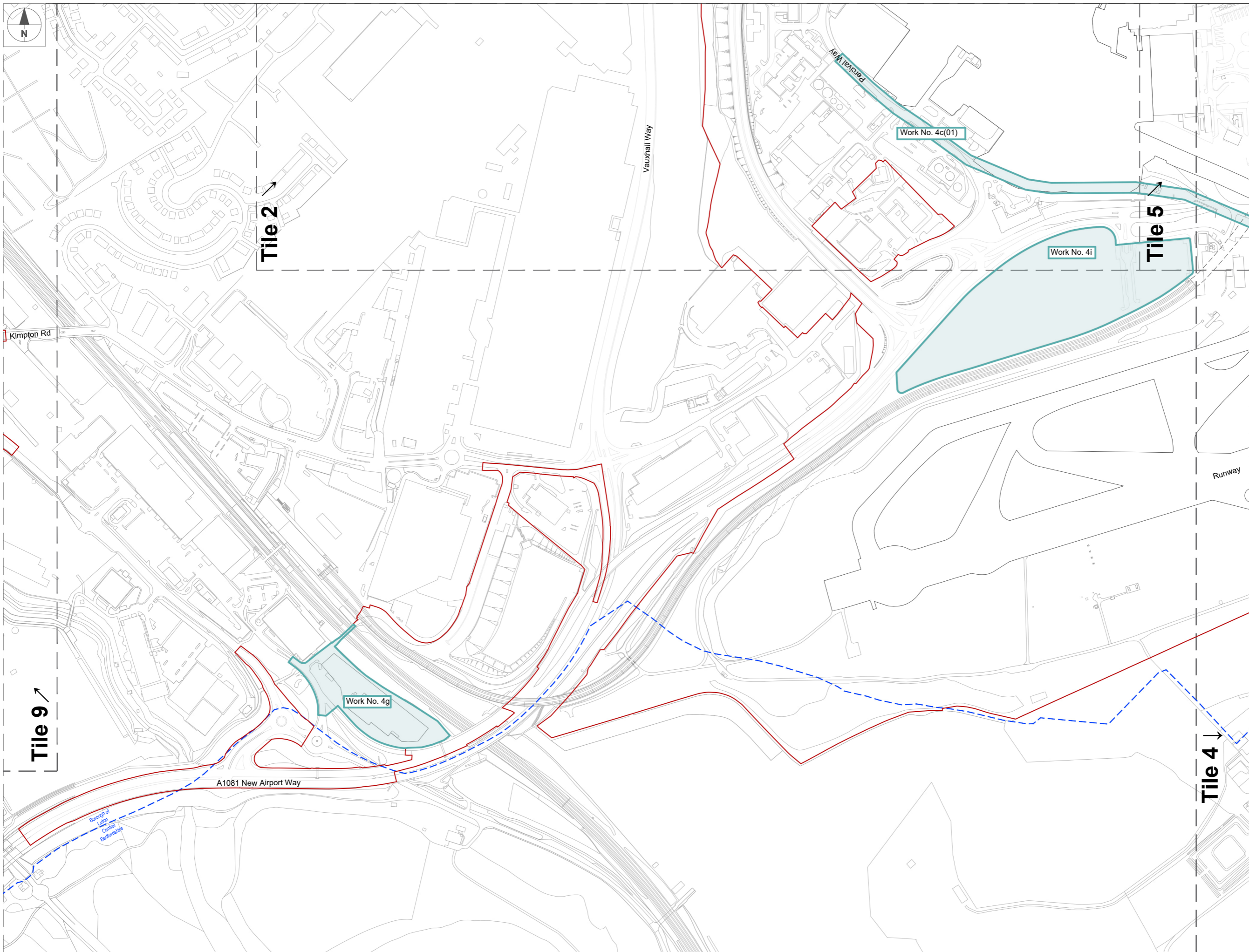

This drawing may contain mapping by permission of Ordnance Survey on behalf of HMSO © Crown Copyright and database rights 2022 Ordnance Survey 0100031673  
 All structure positions are indicative. The proposed works will be subject to detailed design development. The changes will be within limits of deviation specified in the Development Consent Order.

- NOTES**
- These plans should be read in conjunction with Schedule 1 (Authorised development) of the Development Consent Order (TR020001/APP/2.01), Scheme Layout Plans (4.02), the Land Plans (4.03), Crown Land Plans (4.14), General Arrangement Drawings (4.09), and the Airport Access Road and Luton DART Long Section Drawings (4.11).
  - The layout of the works shown on the Work Plans is illustrative only. Exact details concerning configuration and dimensions will be determined and designed at the design stage in line with provisions of the Development Consent Order. Any changes will be limited to being within the constraints included in the Development Consent Order, including the requirements in Schedule 2 (Requirements).

- KEY**
- Order Limits
  - Local Authority Boundary
  - Former Eaton Green Landfill Boundary
  - Sitewide Major Works to Enable Development
  - Airfield Works
  - Terminal and Associated Works
  - Airport Support Facilities
  - Landscaping and Mitigation
  - Airport Access Roads and Offsite Highway Works

Tiles shown on sheet 0400 in yellow contain applicable work areas for Airport Support Facilities. Tiles shown in grey do not contain work areas and are omitted.

The following tiles correspond to the following sheets:

All Tiles / Keyplan	- 0400
Tile 1	- 0410 and 0411
Tile 2	- 0420 and 0421
Tile 3	- Omitted
Tile 4	- 0440
Tile 5	- 0450, 0451 and 0452
Tile 6	- 0460
Tile 7	- Omitted
Tile 8	- Omitted
Tile 9	- Omitted
Tile 10	- Omitted

There are a total of 10 sheets for the Airport Support Facilities Work Plans.

Additional submissions (amended following section 51 advice)				
DCO Submission	LC	GRM / GU	04/23	P02

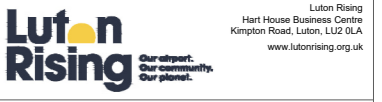
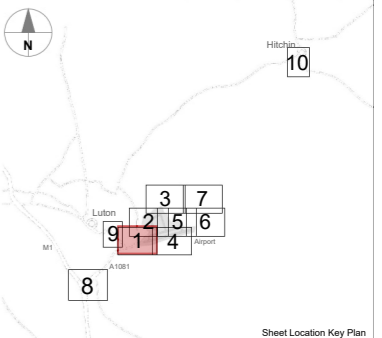

**London Luton Airport Expansion Development Consent Order**

Drawing Title  
**Work Plans  
 Airport Support Facilities  
 Scheme Layout  
 Tile 01 (1 of 2) - Sheet 2 of 10**

Purpose of Issue				Sustainability	
Additional submissions (amended following section 51 advice)				S6	
Drawn	Checked	Approved	Date	Scale	Size
LC	GRM	GU	04/23	1:2500	A1
DCO Application Ref. TR020001		APFP Regulation 5(2)(j)		DCO Document Ref. TR020001/APP/4.04	
Drawing Number LLADCO-3C-CAP-WHS-WRK-DR-AR-0410					Revision P02
Project - Phase - Originator - Asset/Zone - Sub Asset - Type - Discp. - Number					

Work Plans 04 - Airport Support Facilities - Tile 01  
 Scale 1:2500 @ A1



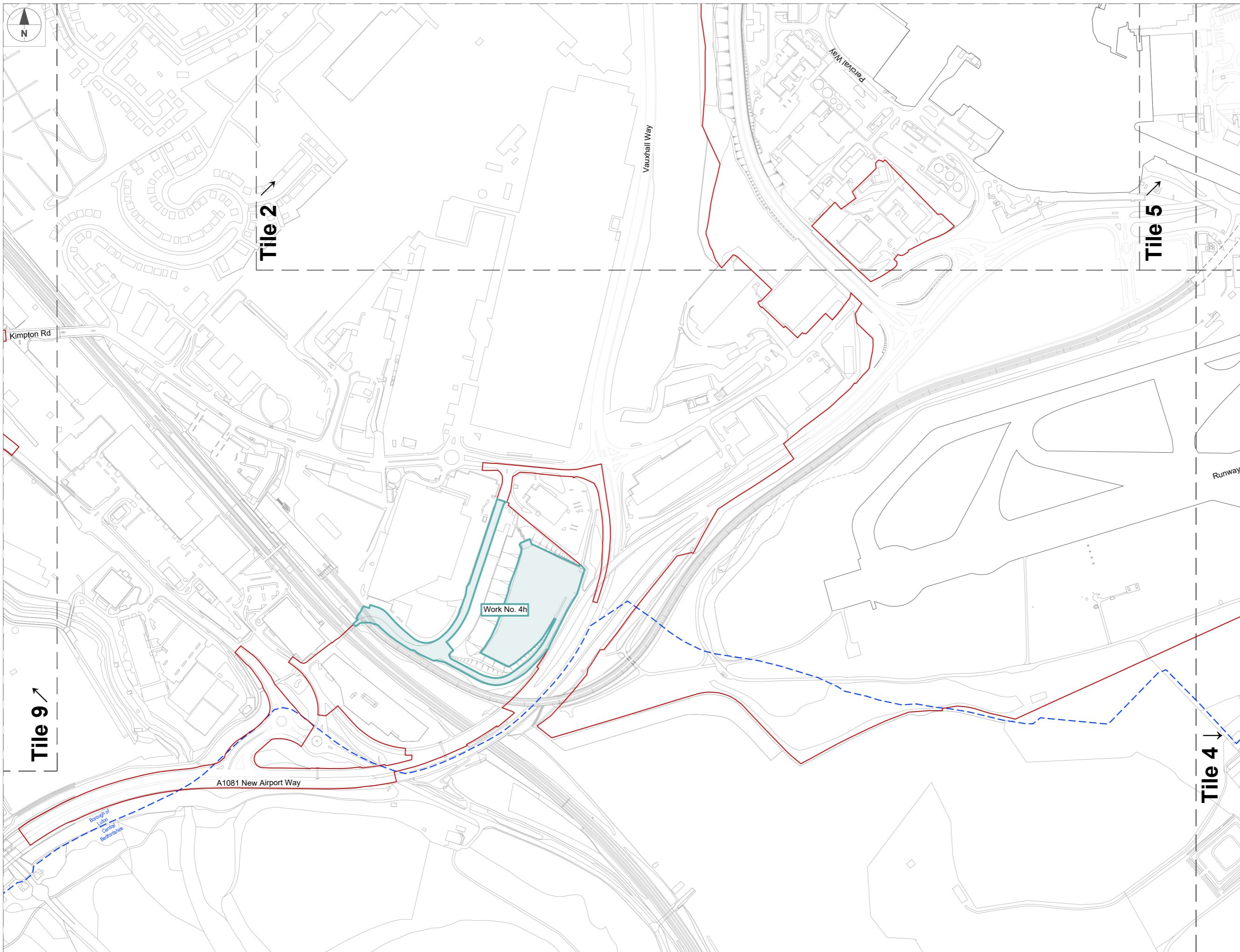

This drawing may contain mapping by permission of Ordnance Survey on behalf of HMSO © Crown Copyright and database rights 2022 Ordnance Survey 0100031673  
 All structure positions are indicative. The proposed works will be subject to detailed design development. The changes will be within limits of deviation specified in the Development Consent Order.

- NOTES**
- These plans should be read in conjunction with Schedule 1 (Authorised development) of the Development Consent Order (TR020001/APP/2.01), Scheme Layout Plans (4.02), the Land Plans (4.03), Crown Land Plans (4.14), General Arrangement Drawings (4.09), and the Airport Access Road and Luton DART Long Section Drawings (4.11).
  - The layout of the works shown on the Work Plans is illustrative only. Exact details concerning configuration and dimensions will be determined and designed at the design stage in line with provisions of the Development Consent Order. Any changes will be limited to being within the constraints included in the Development Consent Order, including the requirements in Schedule 2 (Requirements).

- KEY**
- Order Limits
  - - - Local Authority Boundary
  - Former Eaton Green Landfill Boundary
  - Site-wide Major Works to Enable Development
  - Airfield Works
  - Terminal and Associated Works
  - Airport Support Facilities
  - Landscaping and Mitigation
  - Airport Access Roads and Offsite Highway Works

Tiles shown on sheet 0400 in yellow contain applicable work areas for Airport Support Facilities. Tiles shown in grey do not contain work areas and are omitted.

The following tiles correspond to the following sheets:

All Tiles / Keyplan	Sheet
Tile 1	- 0410 and 0411
Tile 2	- 0420 and 0421
Tile 3	- Omitted
Tile 4	- 0440
Tile 5	- 0450, 0451 and 0452
Tile 6	- 0460
Tile 7	- Omitted
Tile 8	- Omitted
Tile 9	- Omitted
Tile 10	- Omitted

There are a total of 10 sheets for the Airport Support Facilities Work Plans.

Additional submissions (amended following section 51 advice)				
DCO Submission	LC	GRM / GU	Date	Rev.
	LC	GRM / GU	27/02/23	P01

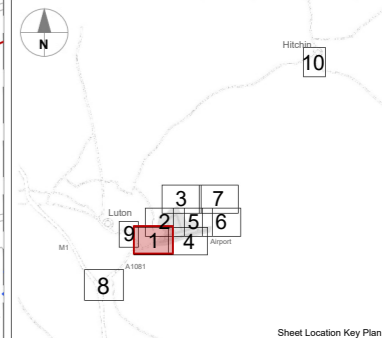

**Luton Rising**  
 Luton Rising  
 Hert House Business Centre  
 Kimpton Road, Luton, LU2 0LA  
 www.lutonrising.org.uk

**London Luton Airport Expansion Development Consent Order**

Drawing Title  
**Work Plans  
 Airport Support Facilities  
 Scheme Layout  
 Tile 01 (2 of 2) - Sheet 3 of 10**

Purpose of issue				Suitability	
Additional submissions (amended following section 51 advice)					
Drawn	Checked	Approved	Date	Scale	Size
LC	GRM	GU	04/23	1:2500	A1
DCO Application Ref.		APFP Regulation		DCO Document Ref.	
TR020001		5(2)(j)		TR020001/APP/4.04	
Drawing Number					Revision
LLADCO-3C-CAP-WHS-WRK-DR-AR-0411					P02
Project - Phase - Originator - AssetZone - Sub Asset - Type - Disp. - Number					

Work Plans 04 - Airport Support Facilities - Tile 01  
 Scale 1:2500 @ A1



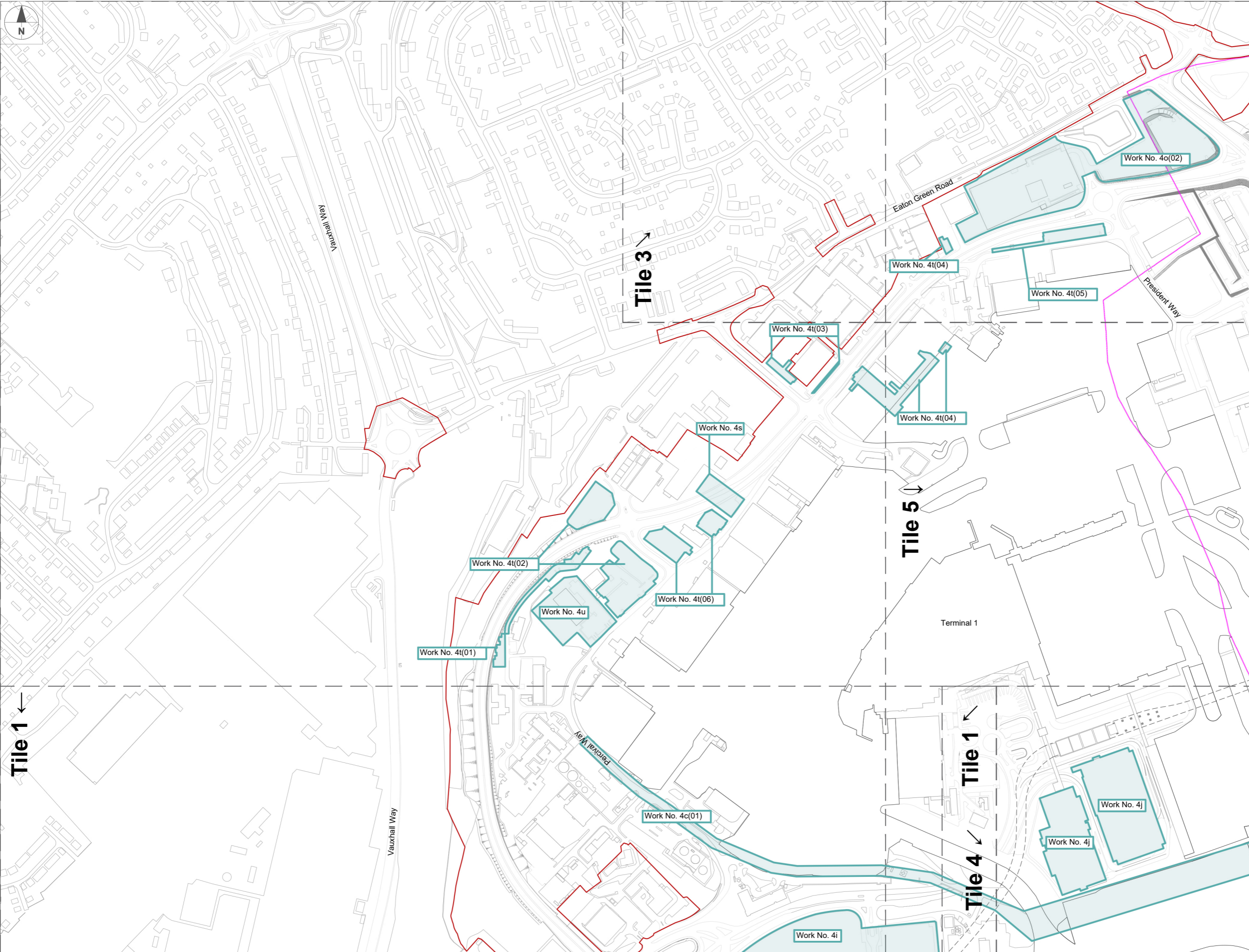

This drawing may contain mapping by permission of Ordnance Survey on behalf of HMSO © Crown Copyright and database rights 2022. Ordnance Survey 0100031673. All structure positions are indicative. The proposed works will be subject to detailed design development. The changes will be within limits of deviation specified in the Development Consent Order.

- NOTES**
- These plans should be read in conjunction with Schedule 1 (Authorised development) of the Development Consent Order (TR020001/APP/2.01), Scheme Layout Plans (4.02), the Land Plans (4.03), Crown Land Plans (4.14), General Arrangement Drawings (4.09), and the Airport Access Road and Luton DART Long Section Drawings (4.11).
  - The layout of the works shown on the Work Plans is illustrative only. Exact details concerning configuration and dimensions will be determined and designed at the design stage in line with provisions of the Development Consent Order. Any changes will be limited to being within the constraints included in the Development Consent Order, including the requirements in Schedule 2 (Requirements).

- KEY**
- Order Limits
  - Local Authority Boundary
  - Former Eaton Green Landfill Boundary
  - Sitewide Major Works to Enable Development
  - Airfield Works
  - Terminal and Associated Works
  - Airport Support Facilities
  - Landscaping and Mitigation
  - Airport Access Roads and Offsite Highway Works

Tiles shown on sheet 0400 in yellow contain applicable work areas for Airport Support Facilities. Tiles shown in grey do not contain work areas and are omitted.

The following tiles correspond to the following sheets:

All Tiles / Keyplan	- 0400
Tile 1	- 0410 and 0411
Tile 2	- 0420 and 0421
Tile 3	- Omitted
Tile 4	- 0440
Tile 5	- 0450, 0451 and 0452
Tile 6	- 0460
Tile 7	- Omitted
Tile 8	- Omitted
Tile 9	- Omitted
Tile 10	- Omitted

There are a total of 10 sheets for the Airport Support Facilities Work Plans.

Revision History	Drawn	Checked	Approved	Date	Rev.
Additional submissions (amended following section 51 advice)	LC	GRM / GU		04/23	P02
DCO Submission	LC	GRM / GU		27/02/23	P01

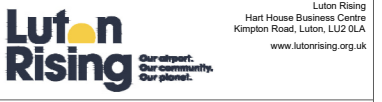
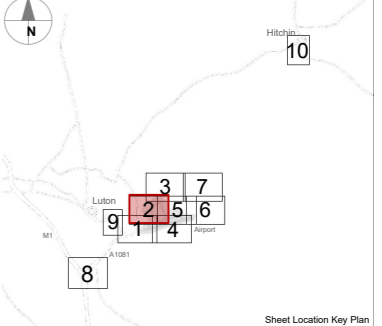

**London Luton Airport Expansion Development Consent Order**

Drawing Title  
**Work Plans  
 Airport Support Facilities  
 Scheme Layout  
 Tile 02 (1 of 2) - Sheet 4 of 10**

Drawn	Checked	Approved	Date	Scale	Size
LC	GRM	GU	04/23	1:2500	A1

Purpose of issue  
 Additional submissions (amended following section 51 advice)  
 S6  
 Drawing Number  
**LLADCO-3C-CAP-WHS-WRK-DR-AR-0420**  
 Project - Phase - Originator - Asset/Zone - Sub Asset - Type - Disp. - Number  
 P02



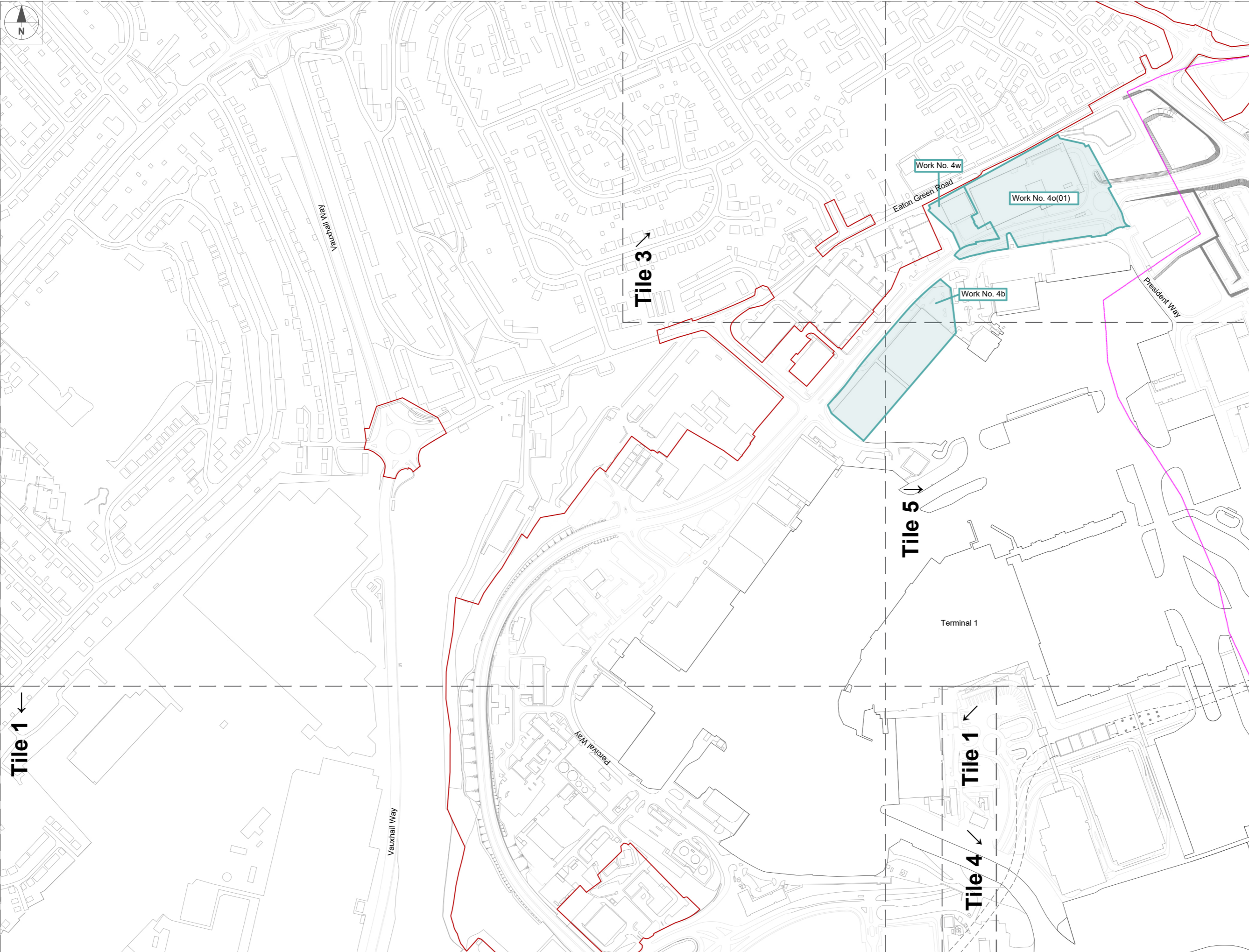

This drawing may contain mapping by permission of Ordnance Survey on behalf of HMSO © Crown Copyright and database rights 2022 Ordnance Survey 0100031673  
 All structure positions are indicative. The proposed works will be subject to detailed design development. The changes will be within limits of deviation specified in the Development Consent Order.

- NOTES**
- These plans should be read in conjunction with Schedule 1 (Authorised development) of the Development Consent Order (TR020001/APP/2.01), Scheme Layout Plans (4.02), the Land Plans (4.03), Crown Land Plans (4.14), General Arrangement Drawings (4.09), and the Airport Access Road and Luton DART Long Section Drawings (4.11).
  - The layout of the works shown on the Work Plans is illustrative only. Exact details concerning configuration and dimensions will be determined and designed at the design stage in line with provisions of the Development Consent Order. Any changes will be limited to being within the constraints included in the Development Consent Order, including the requirements in Schedule 2 (Requirements).

- KEY**
- Order Limits
  - Local Authority Boundary
  - Former Eaton Green Landfill Boundary
  - Site-wide Major Works to Enable Development
  - Airfield Works
  - Terminal and Associated Works
  - Airport Support Facilities
  - Landscaping and Mitigation
  - Airport Access Roads and Offsite Highway Works

Tiles shown on sheet 0400 in yellow contain applicable work areas for Airport Support Facilities. Tiles shown in grey do not contain work areas and are omitted.

The following tiles correspond to the following sheets:

All Tiles / Keyplan	- 0400
Tile 1	- 0410 and 0411
Tile 2	- 0420 and 0421
Tile 3	- Omitted
Tile 4	- 0440
Tile 5	- 0450, 0451 and 0452
Tile 6	- 0460
Tile 7	- Omitted
Tile 8	- Omitted
Tile 9	- Omitted
Tile 10	- Omitted

There are a total of 10 sheets for the Airport Support Facilities Work Plans.

Additional submissions (amended following section 51 advice)				
DCO Submission	LC	GRM / GU	04/23	P02
	LC	GRM / GU	27/02/23	P01

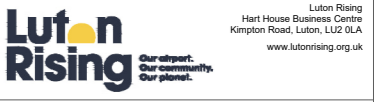
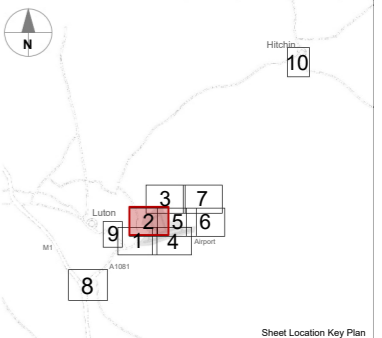

**London Luton Airport Expansion Development Consent Order**

Drawing Title  
**Work Plans  
 Airport Support Facilities  
 Scheme Layout  
 Tile 02 (2 of 2) - Sheet 5 of 10**

Purpose of Issue				Additional submissions (amended following section 51 advice)		Suitability	
Drawn	Checked	Approved	Date	Scale	Size		
LC	GRM	GU	04/23	1:2500	A1		
DCO Application Ref.		APFP Regulation		DCO Document Ref.			
TR020001		5(2)(j)		TR020001/APP/4.04			
Drawing Number						Revision	
LLADCO-3C-CAP-WHS-WRK-DR-AR-0421						P02	
Project - Phase - Originator - AssetZone - Sub Asset - Type - Disp. - Number							

Work Plans 04 - Airport Support Facilities - Tile 02  
 Scale 1:2500 @ A1



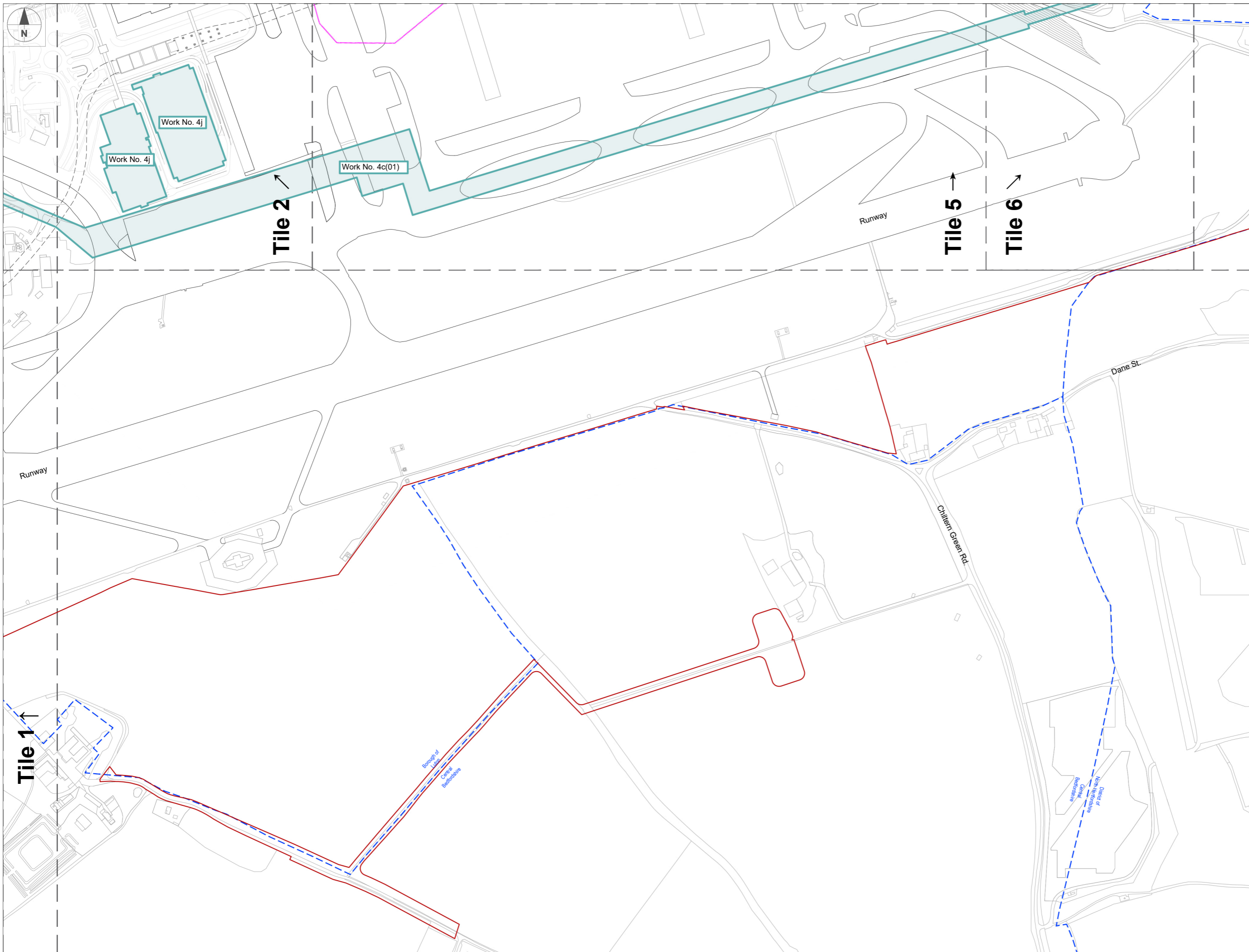

This drawing may contain mapping by permission of Ordnance Survey on behalf of HMSO © Crown Copyright and database rights 2022. Ordnance Survey 0100031673. All structure positions are indicative. The proposed works will be subject to detailed design development. The changes will be within limits of deviation specified in the Development Consent Order.

- NOTES**
- These plans should be read in conjunction with Schedule 1 (Authorised development) of the Development Consent Order (TR020001/APP/2.01), Scheme Layout Plans (4.02), the Land Plans (4.03), Crown Land Plans (4.14), General Arrangement Drawings (4.09), and the Airport Access Road and Luton DART Long Section Drawings (4.11).
  - The layout of the works shown on the Work Plans is illustrative only. Exact details concerning configuration and dimensions will be determined and designed at the design stage in line with provisions of the Development Consent Order. Any changes will be limited to being within the constraints included in the Development Consent Order, including the requirements in Schedule 2 (Requirements).

- KEY**
- Order Limits
  - Local Authority Boundary
  - Former Eaton Green Landfill Boundary
  - Site-wide Major Works to Enable Development
  - Airfield Works
  - Terminal and Associated Works
  - Airport Support Facilities
  - Landscaping and Mitigation
  - Airport Access Roads and Offsite Highway Works

Tiles shown on sheet 0400 in yellow contain applicable work areas for Airport Support Facilities. Tiles shown in grey do not contain work areas and are omitted.

The following tiles correspond to the following sheets:

All Tiles / Keyplan	- 0400
Tile 1	- 0410 and 0411
Tile 2	- 0420 and 0421
Tile 3	- Omitted
Tile 4	- 0440
Tile 5	- 0450, 0451 and 0452
Tile 6	- 0460
Tile 7	- Omitted
Tile 8	- Omitted
Tile 9	- Omitted
Tile 10	- Omitted

There are a total of 10 sheets for the Airport Support Facilities Work Plans.

Additional submissions (amended following section 51 advice)	LC	GRM / GU	04/23	P02
DCO Submission	LC	GRM / GU	27/02/23	P01

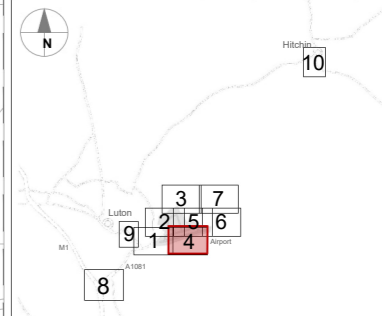

**London Luton Airport Expansion Development Consent Order**

Drawing Title  
**Work Plans  
 Airport Support Facilities  
 Scheme Layout  
 Tile 04 (1 of 1) - Sheet 6 of 10**

Purpose of issue	Suitability
Additional submissions (amended following section 51 advice)	S6
Drawn	Scale
Checked	04/23
Approved	1:2500
GU	Date
LC	04/23
DCO Application Ref.	DCO Document Ref.
TR020001	TR020001/APP/4.04

Drawing Number	P02
LLADCO-3C-CAP-WHS-WRK-DR-AR-0440	
Project - Phase - Originator - Asset/Zone - Sub Asset - Type - Disp. - Number	

Work Plans 04 - Airport Support Facilities - Tile 04  
 Scale 1:2500 @ A1



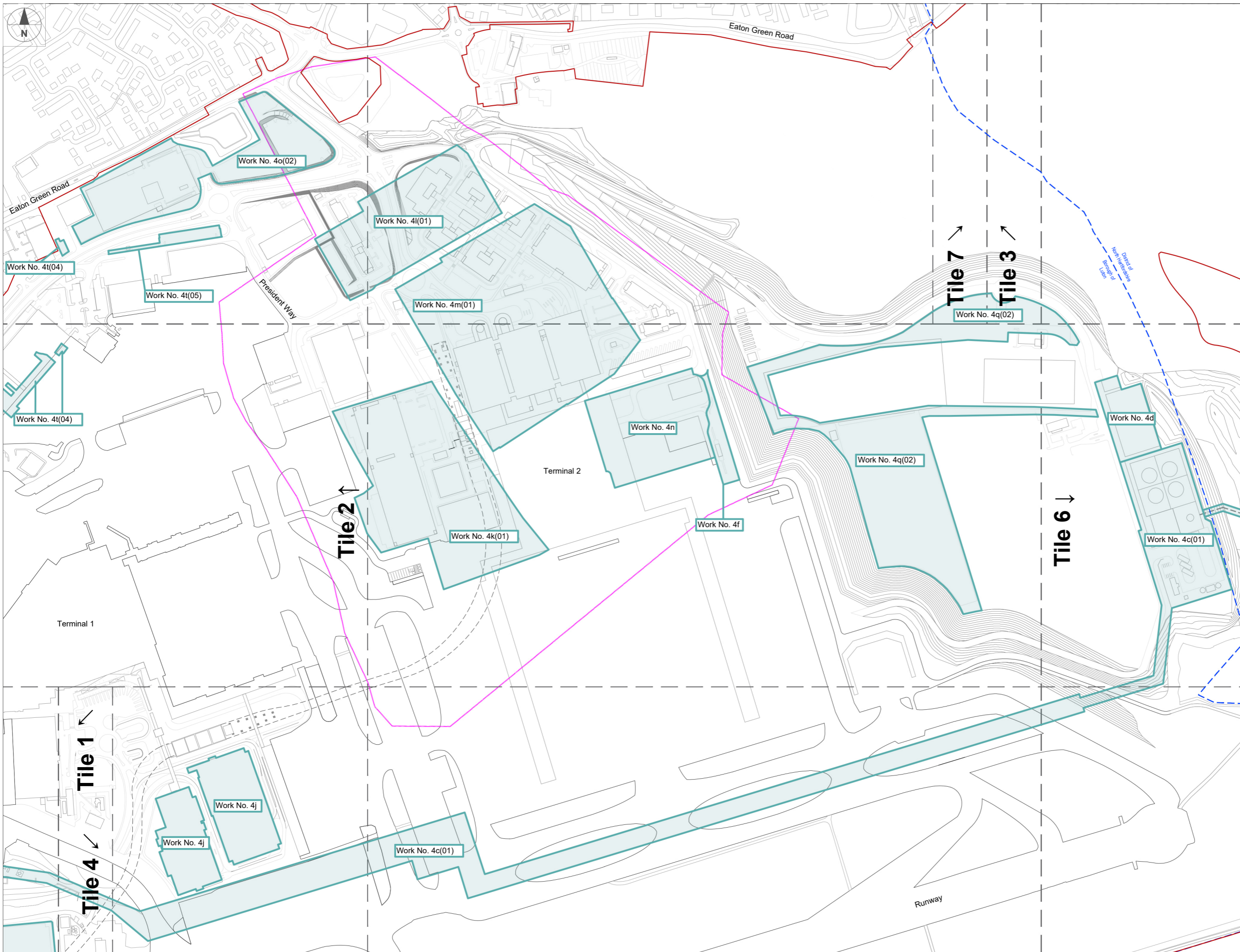

This drawing may contain mapping by permission of Ordnance Survey on behalf of HMSO © Crown Copyright and database rights 2022. Ordnance Survey 0100031673  
 All structure positions are indicative. The proposed works will be subject to detailed design development. The changes will be within limits of deviation specified in the Development Consent Order.

- NOTES**
- These plans should be read in conjunction with Schedule 1 (Authorised development) of the Development Consent Order (TR020001/APP/2.01), Scheme Layout Plans (4.02), the Land Plans (4.03), Crown Land Plans (4.14), General Arrangement Drawings (4.09), and the Airport Access Road and Luton DART Long Section Drawings (4.11).
  - The layout of the works shown on the Work Plans is illustrative only. Exact details concerning configuration and dimensions will be determined and designed at the design stage in line with provisions of the Development Consent Order. Any changes will be limited to being within the constraints included in the Development Consent Order, including the requirements in Schedule 2 (Requirements).

- KEY**
- Order Limits
  - - - Local Authority Boundary
  - Former Eaton Green Landfill Boundary
  - Sitewide Major Works to Enable Development
  - Airfield Works
  - Terminal and Associated Works
  - Airport Support Facilities
  - Landscaping and Mitigation
  - Airport Access Roads and Offsite Highway Works

Tiles shown on sheet 0400 in yellow contain applicable work areas for Airport Support Facilities. Tiles shown in grey do not contain work areas and are omitted.

The following tiles correspond to the following sheets:

All Tiles / Keyplan	Sheet
Tile 1	- 0400 and 0411
Tile 2	- 0420 and 0421
Tile 3	- Omitted
Tile 4	- 0440
Tile 5	- 0450, 0451 and 0452
Tile 6	- 0460
Tile 7	- Omitted
Tile 8	- Omitted
Tile 9	- Omitted
Tile 10	- Omitted

There are a total of 10 sheets for the Airport Support Facilities Work Plans.

Revision History	Drawn	Checked	Approved	Date	Rev.
Additional submissions (amended following section 51 advice)	LC	GRM / GU		04/23	P02
DCO Submission	LC	GRM / GU		27/02/23	P01

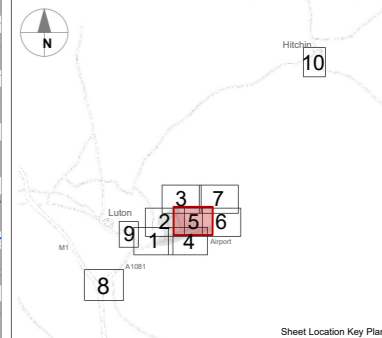

**London Luton Airport Expansion Development Consent Order**

Drawing Title  
**Work Plans  
 Airport Support Facilities  
 Scheme Layout  
 Tile 05 (1 of 3) - Sheet 7 of 10**

Purpose of issue				Suitability	
Additional submissions (amended following section 51 advice)				S6	
Drawn	Checked	Approved	Date	Scale	Size
LC	GRM	GU	04/23	1:2500	A1
DCO Application Ref.	APFP Regulation	DCO Document Ref.			
TR020001	5(2)(j)	TR020001/APP/4.04			

Drawing Number  
**LLADCO-3C-CAP-WHS-WRK-DR-AR-0450**  
 Project - Phase - Originator - Asset/Zone - Sub Asset - Type - Disp. - Number  
 P02

Work Plans 04 - Airport Support Facilities - Tile 05  
 Scale 1:2500 @ A1



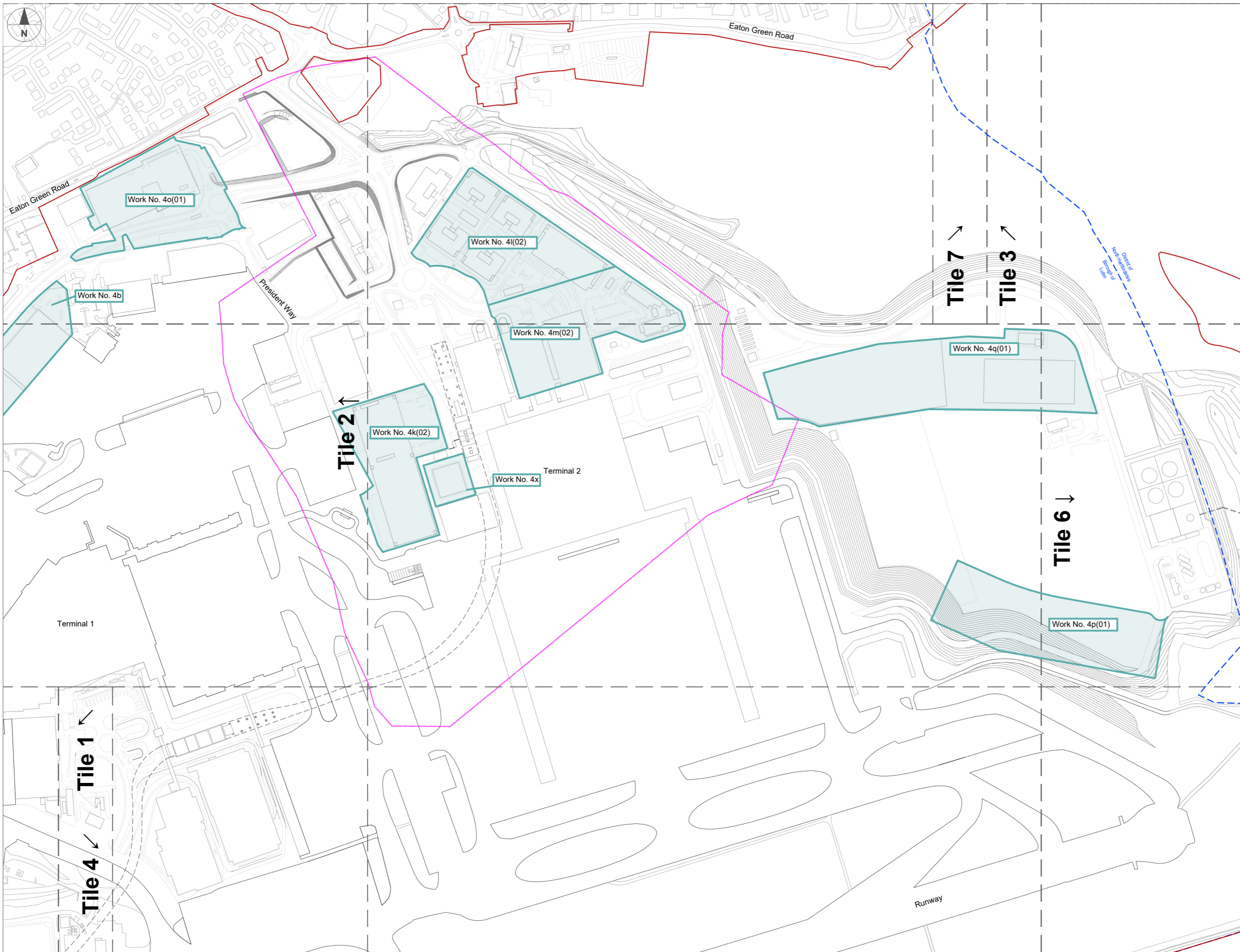

This drawing may contain mapping by permission of Ordnance Survey on behalf of HMSO © Crown Copyright and database rights 2022. Ordnance Survey 0100031673. All structure positions are indicative. The proposed works will be subject to detailed design development. The changes will be within limits of deviation specified in the Development Consent Order.

- NOTES**
- These plans should be read in conjunction with Schedule 1 (Authorised development) of the Development Consent Order (TR020001/APP/2.01), Scheme Layout Plans (4.02), the Land Plans (4.03), Crown Land Plans (4.14), General Arrangement Drawings (4.09), and the Airport Access Road and Luton DART Long Section Drawings (4.11).
  - The layout of the works shown on the Work Plans is illustrative only. Exact details concerning configuration and dimensions will be determined and designed at the design stage in line with provisions of the Development Consent Order. Any changes will be limited to being within the constraints included in the Development Consent Order, including the requirements in Schedule 2 (Requirements).

- KEY**
- Order Limits
  - - - Local Authority Boundary
  - Former Eaton Green Landfill Boundary
  - Sitewide Major Works to Enable Development
  - Airfield Works
  - Terminal and Associated Works
  - Airport Support Facilities
  - Landscaping and Mitigation
  - Airport Access Roads and Offsite Highway Works

Tiles shown on sheet 0400 in yellow contain applicable work areas for Airport Support Facilities. Tiles shown in grey do not contain work areas and are omitted.

The following tiles correspond to the following sheets:

All Tiles / Keyplan	- 0400
Tile 1	- 0410 and 0411
Tile 2	- 0420 and 0421
Tile 3	- Omitted
Tile 4	- 0440
Tile 5	- 0450, 0451 and 0452
Tile 6	- 0460
Tile 7	- Omitted
Tile 8	- Omitted
Tile 9	- Omitted
Tile 10	- Omitted

There are a total of 10 sheets for the Airport Support Facilities Work Plans.

Additional submissions (amended following section 51 advice)	LC	GRM / GU	04/23	P02
DCO Submission	LC	GRM / GU	27/02/23	P01

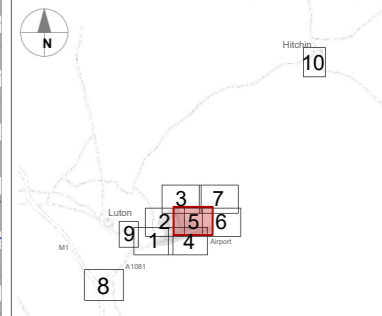

**Luton Rising** Luton Rising  
Hart House Business Centre  
Kington Road, Luton, LU2 0LA  
www.lutonrising.org.uk

**London Luton Airport Expansion Development Consent Order**

Drawing Title  
**Work Plans  
Airport Support Facilities  
Scheme Layout  
Tile 05 (2 of 3) - Sheet 8 of 10**

Purpose of issue	Additional submissions (amended following section 51 advice)	Suitability
Drawn	Checked	Approved
LC	GRM	GU
DCO Application Ref.	APFP Regulation	DCO Document Ref.
TR020001	5(2)(j)	TR020001/APP/4.04

Drawing Number  
**LLADCO-3C-CAP-WHS-WRK-DR-AR-0451**

Work Plans 04 - Airport Support Facilities - Tile 05  
Scale 1:2500 @ A1



Revision  
**P02**

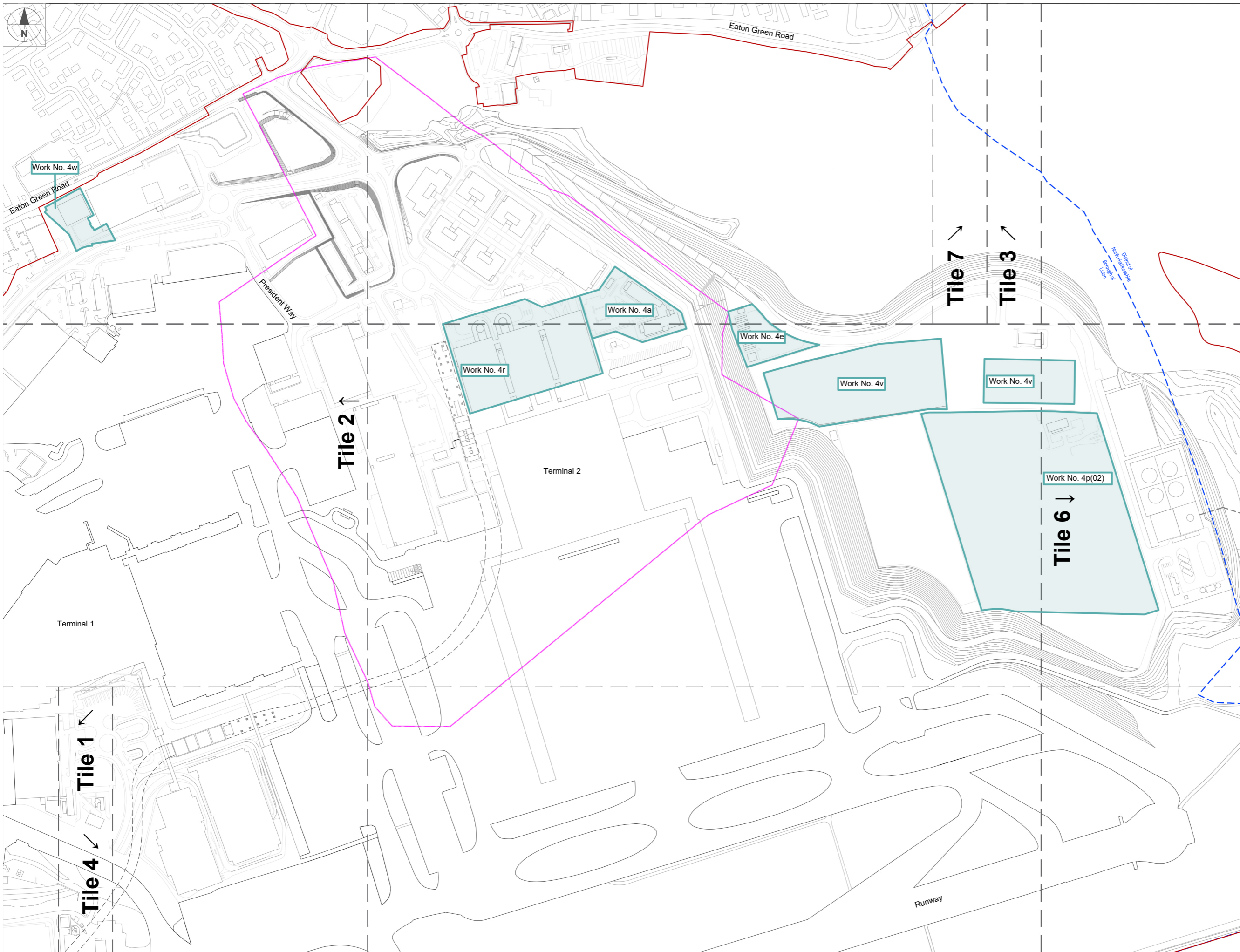

This drawing may contain mapping by permission of Ordnance Survey on behalf of HMSO © Crown Copyright and database rights 2022. Ordnance Survey 0100031673. All structure positions are indicative. The proposed works will be subject to detailed design development. The changes will be within limits of deviation specified in the Development Consent Order.

- NOTES**
- These plans should be read in conjunction with Schedule 1 (Authorised development) of the Development Consent Order (TR020001/APP/2.01), Scheme Layout Plans (4.02), the Land Plans (4.03), Crown Land Plans (4.14), General Arrangement Drawings (4.09), and the Airport Access Road and Luton DART Long Section Drawings (4.11).
  - The layout of the works shown on the Work Plans is illustrative only. Exact details concerning configuration and dimensions will be determined and designed at the design stage in line with provisions of the Development Consent Order. Any changes will be limited to being within the constraints included in the Development Consent Order, including the requirements in Schedule 2 (Requirements).

- KEY**
- Order Limits
  - Local Authority Boundary
  - Former Eaton Green Landfill Boundary
  - Sitewide Major Works to Enable Development
  - Airfield Works
  - Terminal and Associated Works
  - Airport Support Facilities
  - Landscaping and Mitigation
  - Airport Access Roads and Offsite Highway Works

Tiles shown on sheet 0400 in yellow contain applicable work areas for Airport Support Facilities. Tiles shown in grey do not contain work areas and are omitted.

The following tiles correspond to the following sheets:

All Tiles / Keyplan	- 0400
Tile 1	- 0410 and 0411
Tile 2	- 0420 and 0421
Tile 3	- Omitted
Tile 4	- 0440
Tile 5	- 0450, 0451 and 0452
Tile 6	- 0460
Tile 7	- Omitted
Tile 8	- Omitted
Tile 9	- Omitted
Tile 10	- Omitted

There are a total of 10 sheets for the Airport Support Facilities Work Plans.

Additional submissions (amended following section 51 advice)	LC	GRM / GU	04/23	P02
DCO Submission	LC	GRM / GU	27/02/23	P01

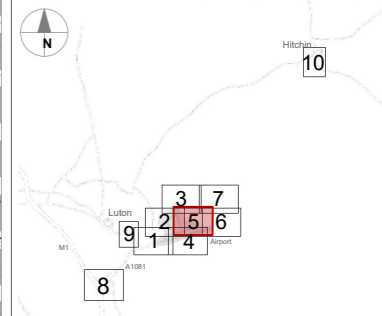

**London Luton Airport Expansion Development Consent Order**

Drawing Title  
**Work Plans  
 Airport Support Facilities  
 Scheme Layout  
 Tile 05 (3 of 3) - Sheet 9 of 10**

Purpose of issue	Additional submissions (amended following section 51 advice)	Suitability
Drawn	Checked	Approved
LC	GRM	GU
DCO Application Ref.	APFP Regulation	DCO Document Ref.
TR020001	5(2)(j)	TR020001/APP/4.04
Drawing Number	LLADCO-3C-CAP-WHS-WRK-DR-AR-0452	
Project - Phase - Originator - Asset/Zone - Sub Asset - Type - Disp. - Number	P02	

Work Plans 04 - Airport Support Facilities - Tile 05  
 Scale 1:2500 @ A1





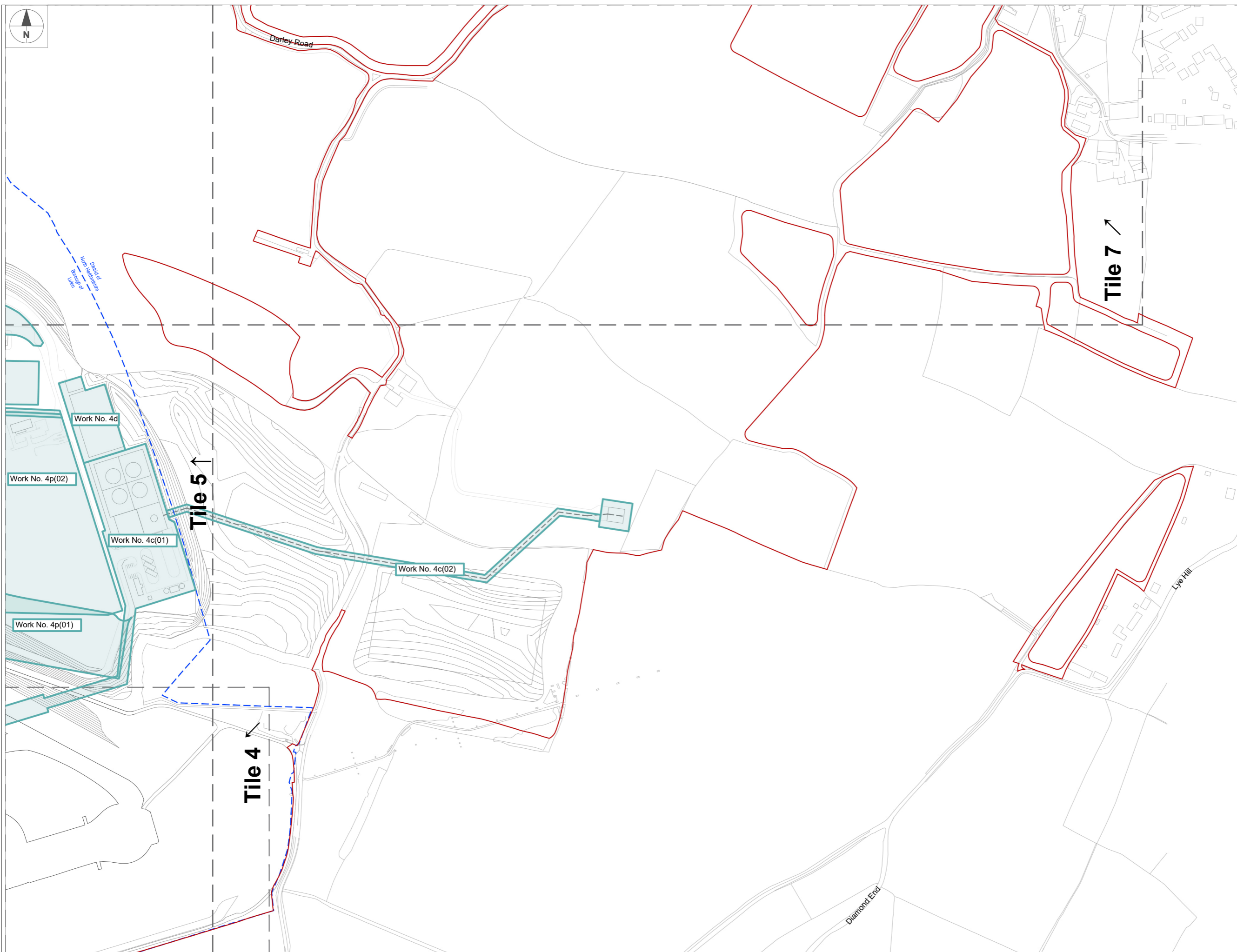

This drawing may contain mapping by permission of Ordnance Survey on behalf of HMSO © Crown Copyright and database rights 2022 Ordnance Survey 0100031673  
All structure positions are indicative. The proposed works will be subject to detailed design development. The changes will be within limits of deviation specified in the Development Consent Order.

**NOTES**

1. These plans should be read in conjunction with Schedule 1 (Authorised development) of the Development Consent Order (TR020001/APP/2.01), Scheme Layout Plans (4.02), the Land Plans (4.03), Crown Land Plans (4.14), General Arrangement Drawings (4.09), and the Airport Access Road and Luton DART Long Section Drawings (4.11).
2. The layout of the works shown on the Work Plans is illustrative only. Exact details concerning configuration and dimensions will be determined and designed at the design stage in line with provisions of the Development Consent Order. Any changes will be limited to being within the constraints included in the Development Consent Order, including the requirements in Schedule 2 (Requirements).

**KEY**

- Order Limits
- Local Authority Boundary
- Former Eaton Green Landfill Boundary
- Sitewide Major Works to Enable Development
- Airfield Works
- Terminal and Associated Works
- Airport Support Facilities
- Landscaping and Mitigation
- Airport Access Roads and Offsite Highway Works

Tiles shown on sheet 0400 in yellow contain applicable work areas for Airport Support Facilities. Tiles shown in grey do not contain work areas and are omitted.

The following tiles correspond to the following sheets:

All Tiles / Keyplan	- 0400
Tile 1	- 0410 and 0411
Tile 2	- 0420 and 0421
Tile 3	- Omitted
Tile 4	- 0440
Tile 5	- 0450, 0451 and 0452
Tile 6	- 0460
Tile 7	- Omitted
Tile 8	- Omitted
Tile 9	- Omitted
Tile 10	- Omitted

There are a total of 10 sheets for the Airport Support Facilities Work Plans.

Additional submissions (amended following section 51 advice)	LC	GRM / GU	04/23	P02
DCO Submission	LC	GRM / GU	27/02/23	P01

Revision History				
Drawn	Checked	Approved	Date	Rev.

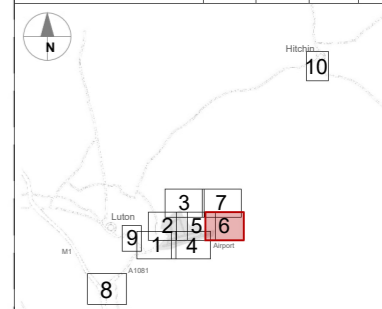

Sheet Location Key Plan

Luton Rising  
Hart House Business Centre  
Kimpton Road, Luton, LU2 0LA  
www.lutonrising.org.uk

**London Luton Airport Expansion Development Consent Order**

Drawing Title

**Work Plans  
Airport Support Facilities  
Scheme Layout  
Tile 06 (1 of 1) - Sheet 10 of 10**

Purpose of issue	Suitability
Additional submissions (amended following section 51 advice)	S6

Drawn	Checked	Approved	Date	Scale	Size
LC	GRM	GU	04/23	1:2500	A1

DCO Application Ref.	APFP Regulation	DCO Document Ref.
TR020001	5(2)(j)	TR020001/APP/4.04

Drawing Number	P02
LLADCO-3C-CAP-WHS-WRK-DR-AR-0460	

Project - Phase - Originator - Asset/Zone - Sub Asset - Type - Disp. - Number

Work Plans 04 - Airport Support Facilities - Tile 06  
Scale 1:2500 @ A1

