

M5 Junction 10 Improvements Scheme

Streets, Rights of Way and Access Plans – Part 2 TR010063 – APP 2.5

Regulation 5 (2) (k)

Planning Act 2008

Infrastructure Planning (Applications: Prescribed Forms and Procedure) Regulations 2009

Volume 2

December 2023



Gloucestershire
COUNTY COUNCIL

THIS PAGE IS LEFT INTENTIONALLY BLANK

**Infrastructure Planning
Planning Act 2008**

**The Infrastructure Planning
(Applications: Prescribed Forms and
Procedure) Regulations 2009**

**M5 Junction 10 Improvements Scheme
Development Consent Order 202[X]**

2.5 Streets, Rights of Way and Access Plans – Part 2

Regulation Number:	Regulation 5 (2) (k)
Planning Inspectorate Scheme Reference	TR010063
Application Document Reference	TR010063 – APP 2.5
Author:	M5 Junction 10 Improvements Scheme Project Team

Version	Date	Status of Version
Rev 0	December 2023	DCO Application

1. Schedule of Plans included in the application

1.1. List of drawings in Part 1

Document title	Document number	Version
Streets, Rights of Way and Access Plans Regulation 5(2)(k) Key Plan	TR010063 – APP 2.5	C01
Streets, Rights of Way and Access Plans Regulation 5(2)(o) Sheet 1 of 16	TR010063 – APP 2.5	C01
Streets, Rights of Way and Access Plans Regulation 5(2)(o) Sheet 2 of 16	TR010063 – APP 2.5	C01
Streets, Rights of Way and Access Plans Regulation 5(2)(o) Sheet 3 of 16	TR010063 – APP 2.5	C01
Streets, Rights of Way and Access Plans Regulation 5(2)(o) Sheet 4 of 16	TR010063 – APP 2.5	C01
Streets, Rights of Way and Access Plans Regulation 5(2)(o) Sheet 5 of 16	TR010063 – APP 2.5	C01
Streets, Rights of Way and Access Plans Regulation 5(2)(o) Sheet 6 of 16	TR010063 – APP 2.5	C01
Streets, Rights of Way and Access Plans Regulation 5(2)(o) Sheet 7 of 16	TR010063 – APP 2.5	C01
Streets, Rights of Way and Access Plans Regulation 5(2)(o) Sheet 8 of 16	TR010063 – APP 2.5	C01
Streets, Rights of Way and Access Plans Regulation 5(2)(o) Sheet 9 of 16	TR010063 – APP 2.5	C01
Streets, Rights of Way and Access Plans Regulation 5(2)(o) Sheet 10 of 16	TR010063 – APP 2.5	C01

1.2. List of drawings in Part 2

Document title	Document number	Version
Streets, Rights of Way and Access Plans Regulation 5(2)(o) Sheet 11 of 16	TR010063 – APP 2.5	C01
Streets, Rights of Way and Access Plans Regulation 5(2)(o) Sheet 12 of 16	TR010063 – APP 2.5	C01
Streets, Rights of Way and Access Plans Regulation 5(2)(o) Sheet 13 of 16	TR010063 – APP 2.5	C01
Streets, Rights of Way and Access Plans Regulation 5(2)(o) Sheet 14 of 16	TR010063 – APP 2.5	C01
Streets, Rights of Way and Access Plans Regulation 5(2)(o) Sheet 15 of 16	TR010063 – APP 2.5	C01
Streets, Rights of Way and Access Plans Regulation 5(2)(o) Sheet 16 of 16	TR010063 – APP 2.5	C01

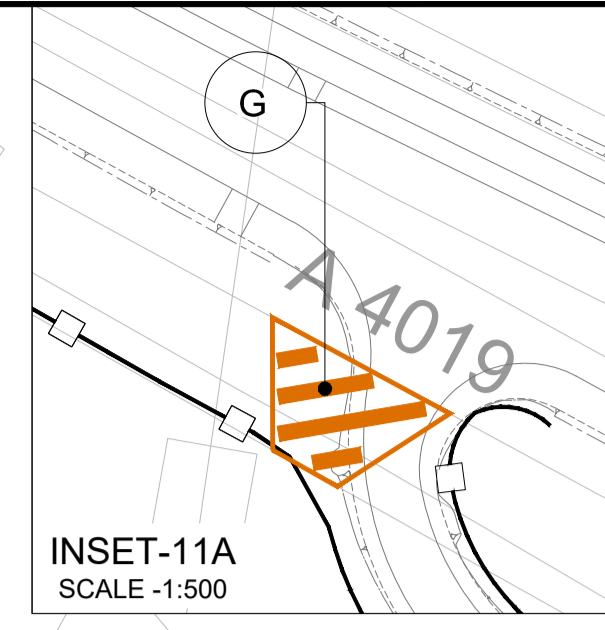
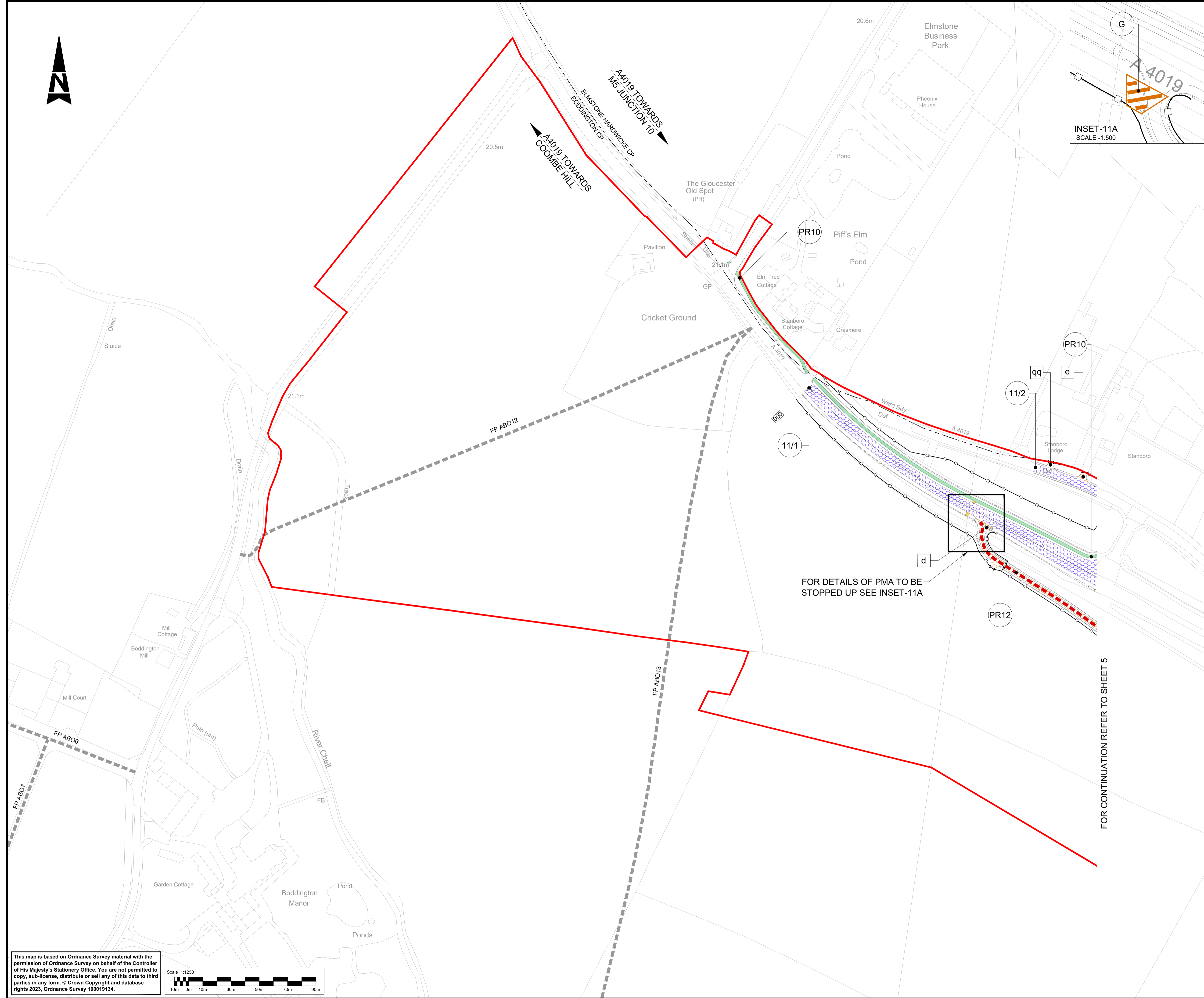

- NOTES:**
- THE STREETS, RIGHTS OF WAY AND ACCESS PLANS SHOULD BE READ IN CONJUNCTION WITH THE DEVELOPMENT CONSENT ORDER AND OTHER APPLICATION PLANS.
- KEY:**
- DEVELOPMENT CONSENT ORDER (DCO) LIMITS
 - THE SCHEME (SHOWN FOR ILLUSTRATIVE PURPOSES ONLY)
 - EXISTING ORDNANCE SURVEY DATA
 - NEW, ALTERED OR IMPROVED HIGHWAY - MOTORWAY
 - NEW, ALTERED OR IMPROVED HIGHWAY - SIDE ROADS
 - NEW / ALTERED PRIVATE MEANS OF ACCESS
 - NEW OR ALTERED FOOTWAY
 - NEW CYCLE TRACK
 - NEW NON SEGREGATED FOOTWAY / CYCLE TRACK
 - EXISTING HIGHWAYS TO BE STOPPED UP
 - PRIVATE MEANS OF ACCESS TO BE STOPPED UP
 - FP XXX EXISTING PUBLIC RIGHT OF WAY (PROW)
 - EXISTING PUBLIC RIGHT OF WAY TO BE STOPPED UP
 - NEW / SUBSTITUTED FOOTPATH
 - NEW / SUBSTITUTED BRIDLEWAY
 - PROPOSED FENCE LINE
 - REFERENCE LABEL FOR NEW PUBLIC RIGHT OF WAY, FOOTWAY, CYCLE TRACK, OR COMBINED FOOTWAY AND CYCLE TRACK
 - REFERENCE LABEL FOR EXISTING PRIVATE MEANS OF ACCESS TO BE STOPPED UP
 - REFERENCE LABEL FOR NEW/SUBSTITUTED PRIVATE MEANS OF ACCESS
 - REFERENCE LABEL FOR START/END POINT OF HIGHWAY / RIGHT OF WAY TO BE DIVERTED, CREATED, STOPPED UP OR EXTINGUISHED
 - PROPOSED GATE
 - PARISH BOUNDARY
 - MAINLINE CHAINAGE
 - NEW MAINTENANCE BAY

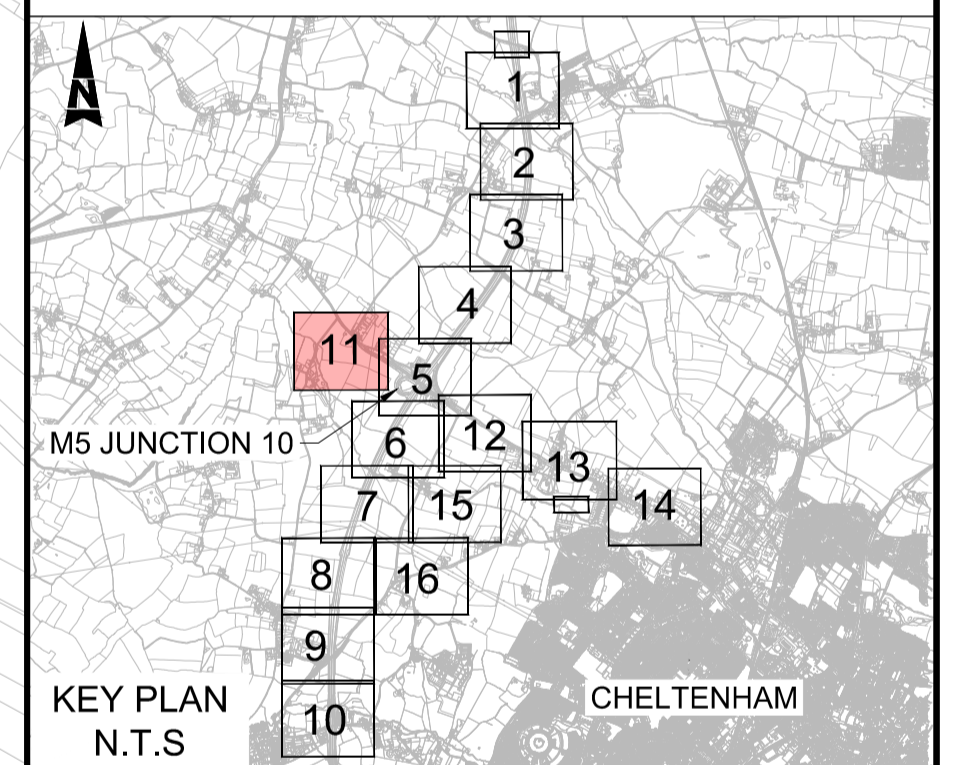

Description						
Status	Revision	Drawn	Checked	Reviewed	Authorised	Issue Date
Description						
Status	Revision	Drawn	Checked	Reviewed	Authorised	Issue Date
Description						
Status	Revision	Drawn	Checked	Reviewed	Authorised	Issue Date
Description						
FIRST SUBMISSION						
Status	Revision	Drawn	Checked	Reviewed	Authorised	Issue Date
A1	C01	NKRP	CJ	HC	BM	18/10/23
Drawing Suitability						Status
APPROVED - PUBLISHED						A1
Project Title						
M5 Junction 10 Improvements Scheme						
Drawing Title						
STREETS, RIGHTS OF WAY AND ACCESS PLANS REGULATION 5(2)(k) SHEET 11 OF 16						
Drawing Number						
TR010063/APP/2.5						
Original Size:	A1	Scale:	1:1250	Project Ref. No.:	5197035	Sheet: 11 of 16 Rev: C01

This map is based on Ordnance Survey material with the permission of Ordnance Survey on behalf of the Controller of His Majesty's Stationery Office. You are not permitted to copy, sub-license, distribute or sell any of this data to third parties in any form. © Crown Copyright and database rights 2023, Ordnance Survey 100019134.

Scale 1:1250

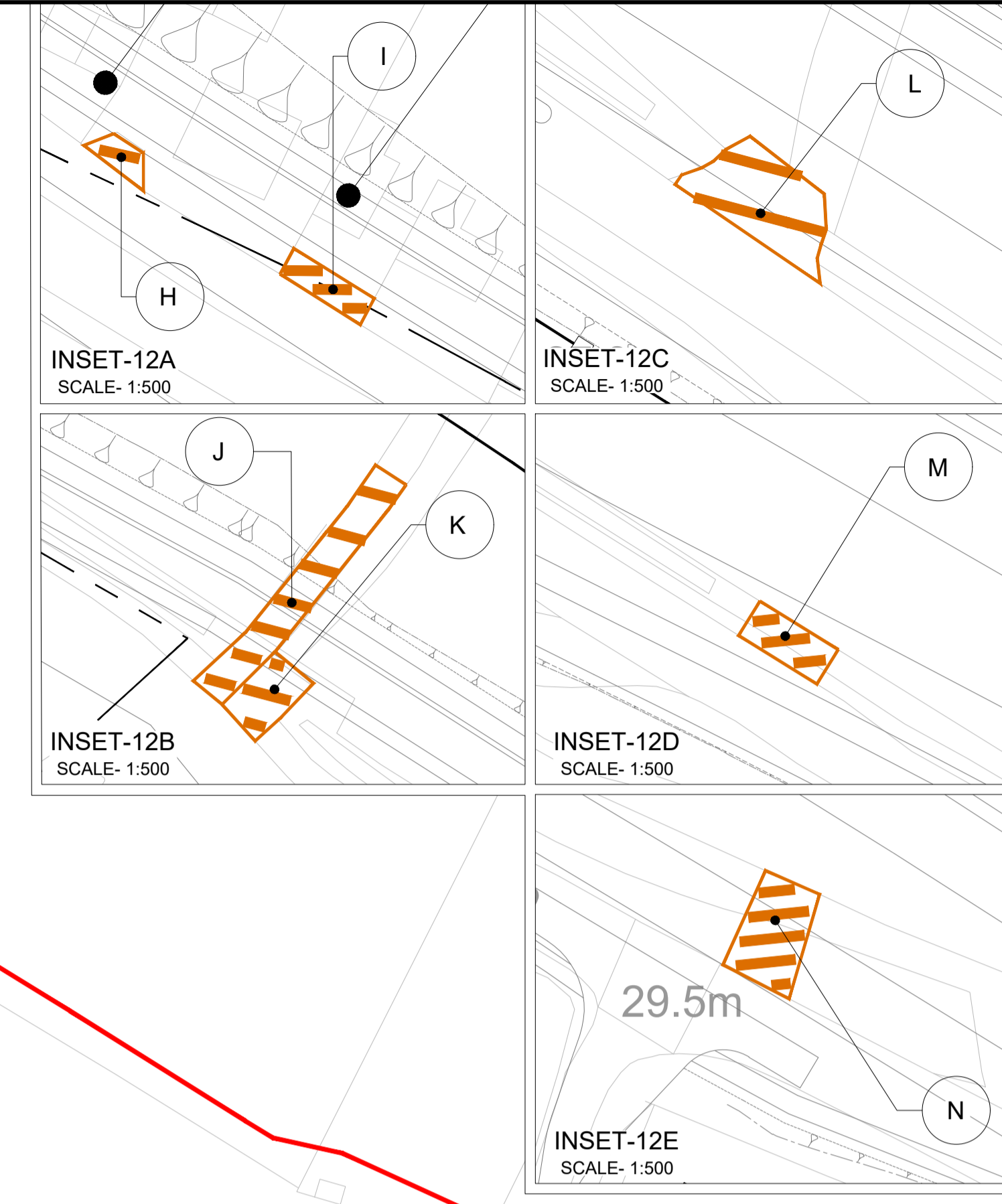
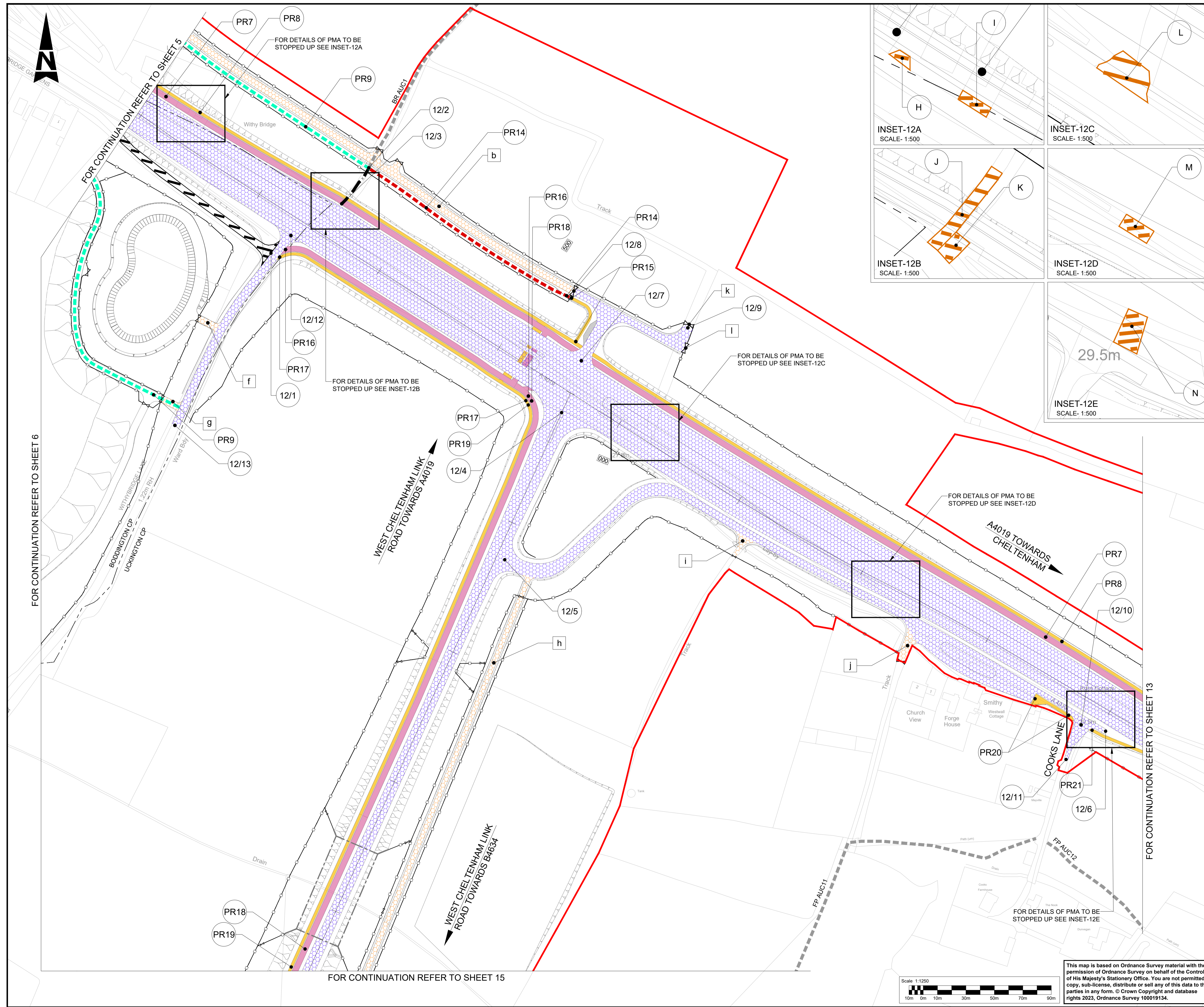

- NOTES:**
- THE STREETS, RIGHTS OF WAY AND ACCESS PLANS SHOULD BE READ IN CONJUNCTION WITH THE DEVELOPMENT CONSENT ORDER AND OTHER APPLICATION PLANS.
- KEY:**
- DEVELOPMENT CONSENT ORDER (DCO) LIMITS
 - THE SCHEME (SHOWN FOR ILLUSTRATIVE PURPOSES ONLY)
 - EXISTING ORDNANCE SURVEY DATA
 - NEW, ALTERED OR IMPROVED HIGHWAY - MOTORWAY
 - NEW, ALTERED OR IMPROVED HIGHWAY - SIDE ROADS
 - NEW / ALTERED PRIVATE MEANS OF ACCESS
 - NEW OR ALTERED FOOTWAY
 - NEW CYCLE TRACK
 - NEW NON SEGREGATED FOOTWAY / CYCLE TRACK
 - EXISTING HIGHWAYS TO BE STOPPED UP
 - PRIVATE MEANS OF ACCESS TO BE STOPPED UP
 - FP XXX EXISTING PUBLIC RIGHT OF WAY (PROW)
 - X EXISTING PUBLIC RIGHT OF WAY TO BE STOPPED UP
 - NEW / SUBSTITUTED FOOTPATH
 - NEW / SUBSTITUTED BRIDLEWAY
 - PROPOSED FENCE LINE
 - PR REFERENCE LABEL FOR NEW PUBLIC RIGHT OF WAY, FOOTWAY, CYCLE TRACK, OR COMBINED FOOTWAY AND CYCLE TRACK
 - A REFERENCE LABEL FOR EXISTING PRIVATE MEANS OF ACCESS TO BE STOPPED UP
 - B REFERENCE LABEL FOR NEW/SUBSTITUTED PRIVATE MEANS OF ACCESS
 - 4H REFERENCE LABEL FOR START/END POINT OF HIGHWAY / RIGHT OF WAY TO BE DIVERTED, CREATED, STOPPED UP OR EXTINGUISHED
 - PROPOSED GATE
 - PARISH BOUNDARY
 - MAINLINE CHAINAGE
 - NEW MAINTENANCE BAY

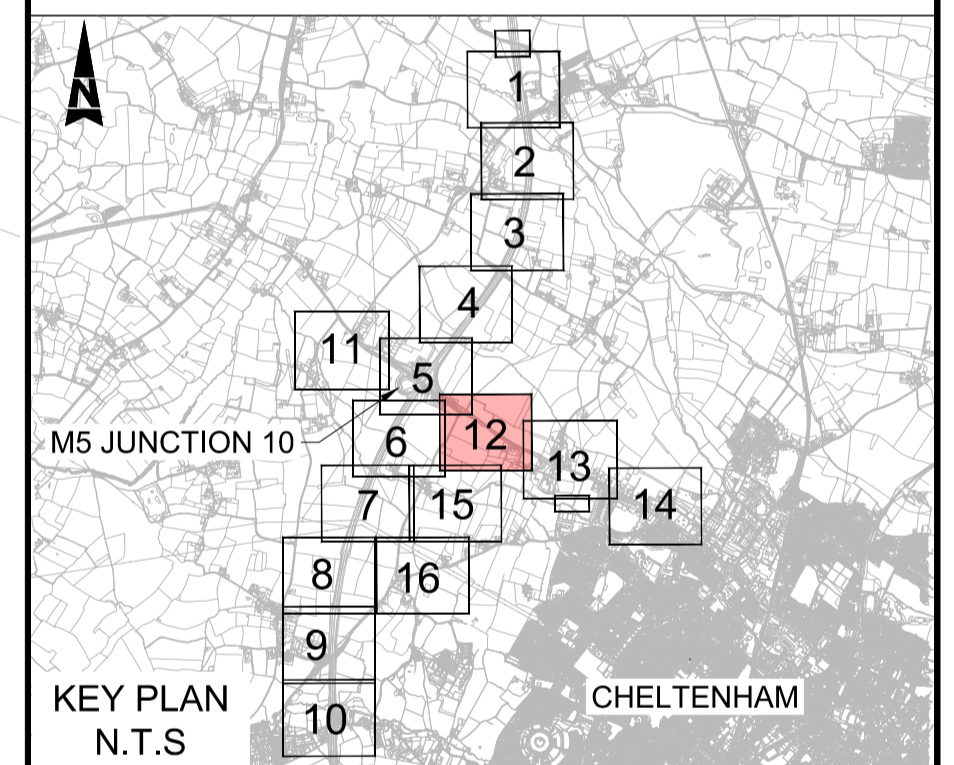

Description	Status	Revision	Drawn	Checked	Reviewed	Authorised	Issue Date

FIRST SUBMISSION							Status
Status	Revision	Drawn	Checked	Reviewed	Authorised	Issue Date	
A1	C01	NKRP	CJ	HC	BM	18/10/23	A1

Project Title
M5 Junction 10 Improvements Scheme

Drawing Title
**STREETS, RIGHTS OF WAY AND ACCESS PLANS
REGULATION 5(2)(k)
SHEET 12 OF 16**

Drawing Number
TR010063/APP/2.5

Original Size: **A1** Scale: 1:1250 Project Ref. No: 5197035 Sheet: 12 of 16 Rev: **C01**

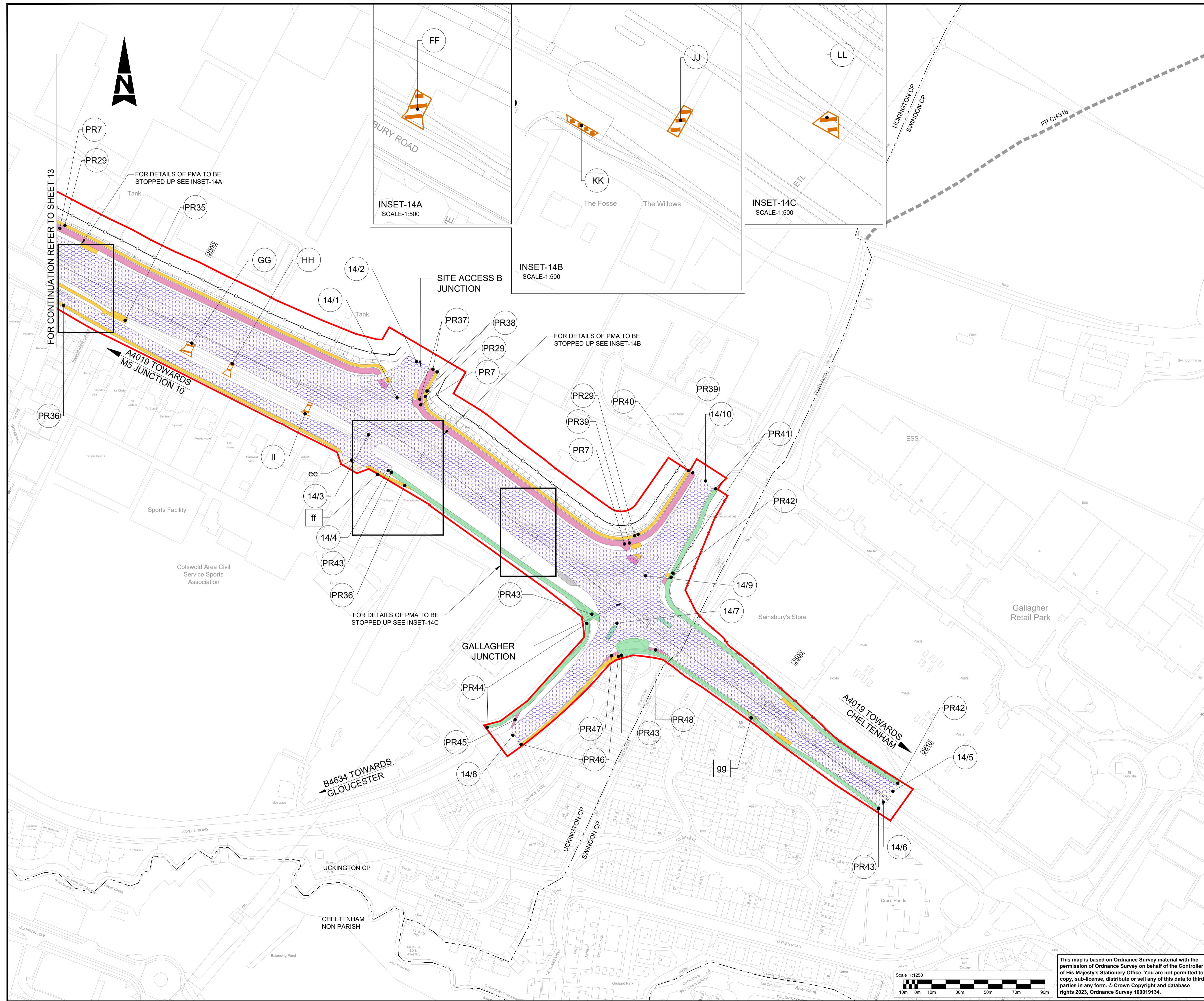

- NOTES:**
- THE STREETS, RIGHTS OF WAY AND ACCESS PLANS SHOULD BE READ IN CONJUNCTION WITH THE DEVELOPMENT CONSENT ORDER AND OTHER APPLICATION PLANS.
- KEY:**
- DEVELOPMENT CONSENT ORDER (DCO) LIMITS
 - THE SCHEME (SHOWN FOR ILLUSTRATIVE PURPOSES ONLY)
 - EXISTING ORDNANCE SURVEY DATA
 - NEW, ALTERED OR IMPROVED HIGHWAY - MOTORWAY
 - NEW, ALTERED OR IMPROVED HIGHWAY - SIDE ROADS
 - NEW / ALTERED PRIVATE MEANS OF ACCESS
 - NEW OR ALTERED FOOTWAY
 - NEW CYCLE TRACK
 - NEW NON SEGREGATED FOOTWAY / CYCLE TRACK
 - EXISTING HIGHWAYS TO BE STOPPED UP
 - PRIVATE MEANS OF ACCESS TO BE STOPPED UP
 - EXISTING PUBLIC RIGHT OF WAY (PROW)
 - EXISTING PUBLIC RIGHT OF WAY TO BE STOPPED UP
 - NEW / SUBSTITUTED FOOTPATH
 - NEW / SUBSTITUTED BRIDLEWAY
 - PROPOSED FENCE LINE
 - REFERENCE LABEL FOR NEW PUBLIC RIGHT OF WAY, FOOTWAY, CYCLE TRACK, OR COMBINED FOOTWAY AND CYCLE TRACK
 - REFERENCE LABEL FOR EXISTING PRIVATE MEANS OF ACCESS TO BE STOPPED UP
 - REFERENCE LABEL FOR NEW/SUBSTITUTED PRIVATE MEANS OF ACCESS
 - REFERENCE LABEL FOR START/END POINT OF HIGHWAY / RIGHT OF WAY TO BE DIVERTED, CREATED, STOPPED UP OR EXTINGUISHED
 - PROPOSED GATE
 - PARISH BOUNDARY
 - MAINLINE CHAINAGE
 - NEW MAINTENANCE BAY

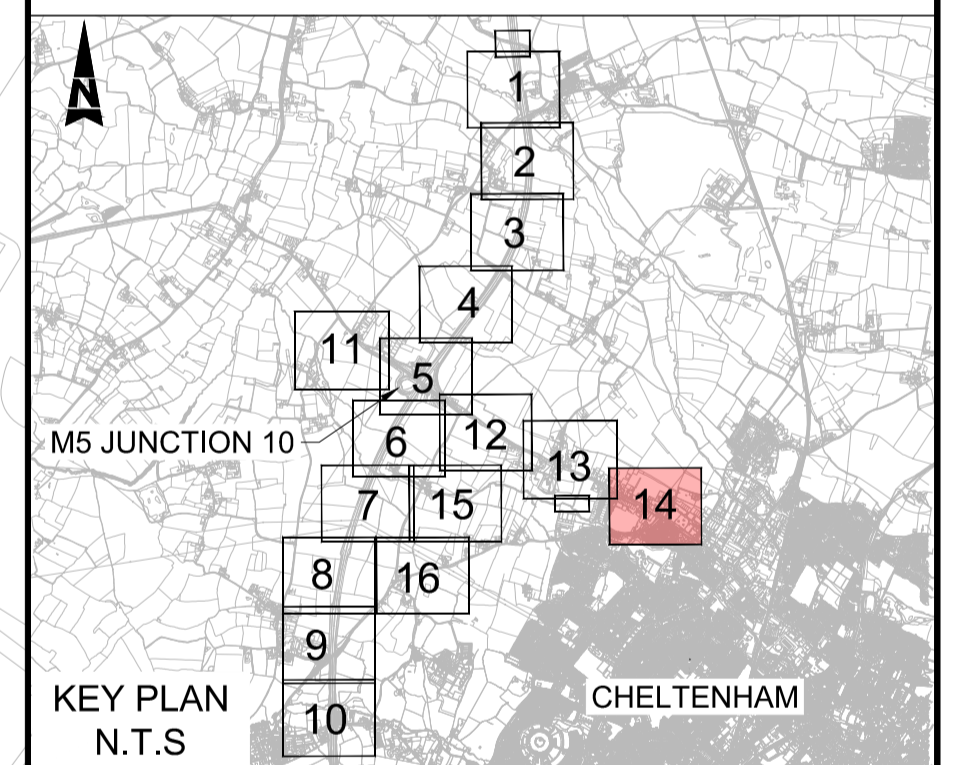

Description	Status	Revision	Drawn	Checked	Reviewed	Authorised	Issue Date	
Description	Status	Revision	Drawn	Checked	Reviewed	Authorised	Issue Date	
Description	Status	Revision	Drawn	Checked	Reviewed	Authorised	Issue Date	
Description	Status	Revision	Drawn	Checked	Reviewed	Authorised	Issue Date	
Description	Status	Revision	Drawn	Checked	Reviewed	Authorised	Issue Date	
FIRST SUBMISSION	A1	C01	NKRP	CJ	HC	BM	18/10/23	
Drawing Suitability	APPROVED - PUBLISHED						Status	A1

Project Title
M5 Junction 10 Improvements Scheme

Drawing Title
**STREETS, RIGHTS OF WAY AND ACCESS PLANS
REGULATION 5(2)(k)
SHEET 14 OF 16**

Drawing Number
TR010063/APP/2.5

Original Size: **A1** Scale: 1:1250 Project Ref. No: 5197035 Sheet: 14 of 16 Rev: **C01**

This map is based on Ordnance Survey material with the permission of Ordnance Survey on behalf of the Controller of His Majesty's Stationery Office. You are not permitted to copy, sub-license, distribute or sell any of this data to third parties in any form. © Crown Copyright and database rights 2023, Ordnance Survey 100019134.

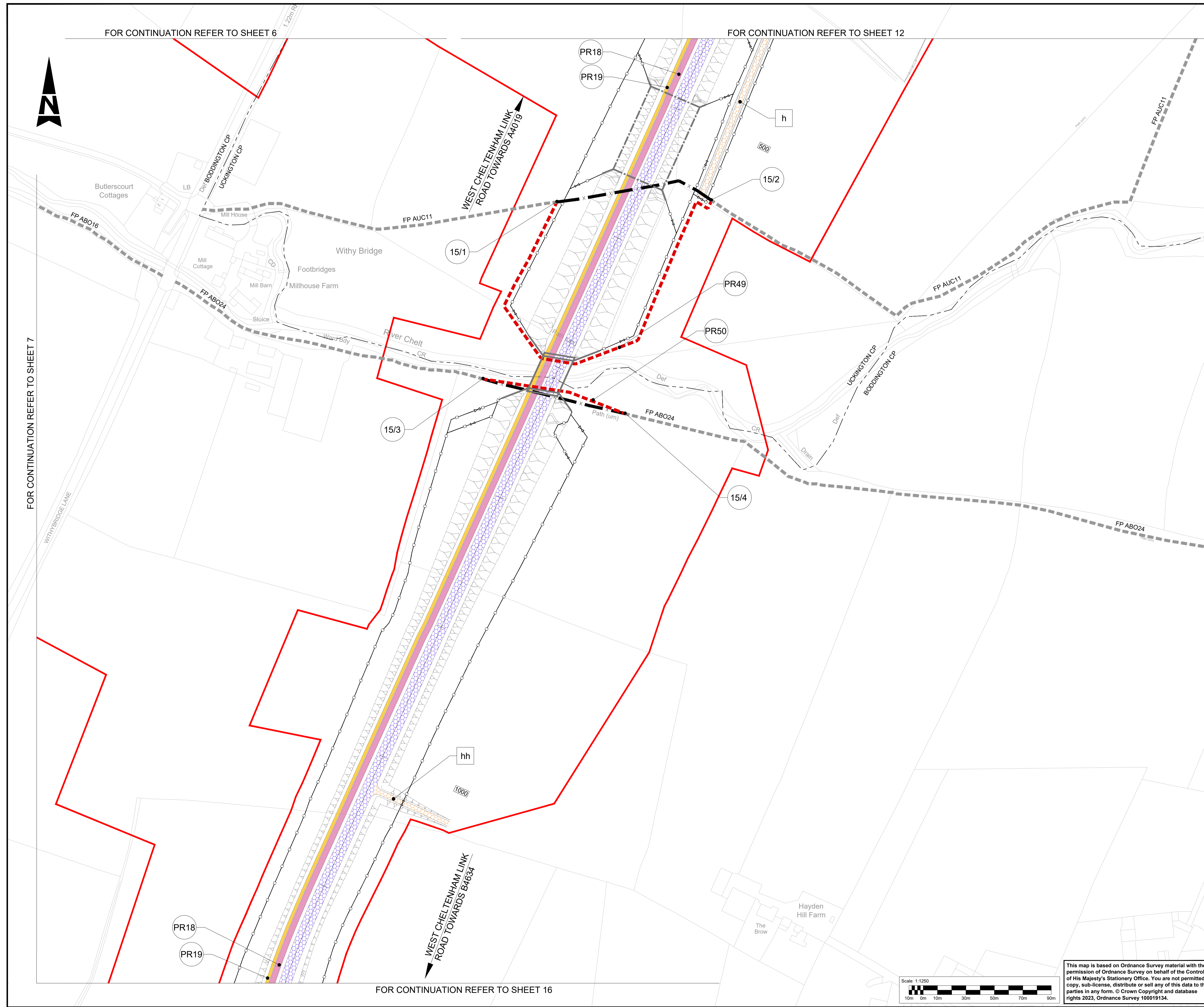

- NOTES:**
- THE STREETS, RIGHTS OF WAY AND ACCESS PLANS SHOULD BE READ IN CONJUNCTION WITH THE DEVELOPMENT CONSENT ORDER AND OTHER APPLICATION PLANS.
- KEY:**
- DEVELOPMENT CONSENT ORDER (DCO) LIMITS
 - THE SCHEME (SHOWN FOR ILLUSTRATIVE PURPOSES ONLY)
 - EXISTING ORDNANCE SURVEY DATA
 - NEW, ALTERED OR IMPROVED HIGHWAY - MOTORWAY
 - NEW, ALTERED OR IMPROVED HIGHWAY - SIDE ROADS
 - NEW / ALTERED PRIVATE MEANS OF ACCESS
 - NEW OR ALTERED FOOTWAY
 - NEW CYCLE TRACK
 - NEW NON SEGREGATED FOOTWAY / CYCLE TRACK
 - EXISTING HIGHWAYS TO BE STOPPED UP
 - PRIVATE MEANS OF ACCESS TO BE STOPPED UP
 - FP XXX - EXISTING PUBLIC RIGHT OF WAY (PROW)
 - X - EXISTING PUBLIC RIGHT OF WAY TO BE STOPPED UP
 - - - NEW / SUBSTITUTED FOOTPATH
 - - - NEW / SUBSTITUTED BRIDLEWAY
 - PROPOSED FENCE LINE
 - PR - REFERENCE LABEL FOR NEW PUBLIC RIGHT OF WAY, FOOTWAY, CYCLE TRACK, OR COMBINED FOOTWAY AND CYCLE TRACK
 - A - REFERENCE LABEL FOR EXISTING PRIVATE MEANS OF ACCESS TO BE STOPPED UP
 - a - REFERENCE LABEL FOR NEW/SUBSTITUTED PRIVATE MEANS OF ACCESS
 - h - REFERENCE LABEL FOR START/END POINT OF HIGHWAY / RIGHT OF WAY TO BE DIVERTED, CREATED, STOPPED UP OR EXTINGUISHED
 - PROPOSED GATE
 - PARISH BOUNDARY
 - MAINLINE CHAINAGE
 - NEW MAINTENANCE BAY

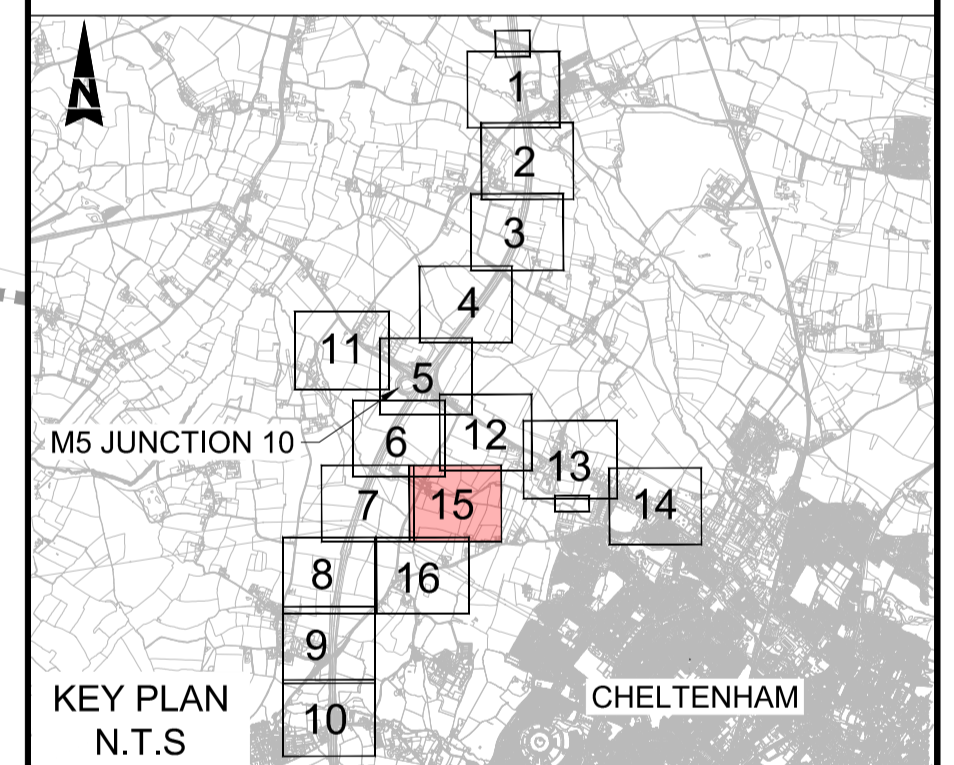

Description	Status	Revision	Drawn	Checked	Reviewed	Authorised	Issue Date
Description							
Description							
Description							
Description							
FIRST SUBMISSION							
Status	A1	Revision	C01	Drawn	NKRP	Checked	CJ
		Reviewed	HC	Authorised	BM	Issue Date	18/10/23
Drawing Suitability							Status
APPROVED - PUBLISHED							A1

Project Title
M5 Junction 10 Improvements Scheme

Drawing Title
STREETS, RIGHTS OF WAY AND ACCESS PLANS REGULATION 5(2)(k) SHEET 15 OF 16

Drawing Number
TR010063/APP/2.5

Original Size: **A1** Scale: 1:1250 Project Ref. No.: 5197035 Sheet: 15 of 16 Rev: **C01**

This map is based on Ordnance Survey material with the permission of Ordnance Survey on behalf of the Controller of His Majesty's Stationery Office. You are not permitted to copy, sub-license, distribute or sell any of this data to third parties in any form. © Crown Copyright and database rights 2023, Ordnance Survey 100019134.

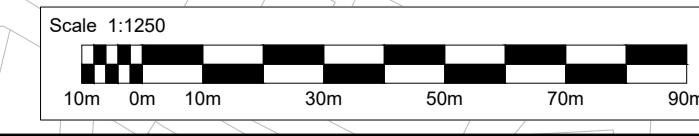

FOR CONTINUATION REFER TO SHEET 7

FOR CONTINUATION REFER TO SHEET 15

- NOTES:**
- THE STREETS, RIGHTS OF WAY AND ACCESS PLANS SHOULD BE READ IN CONJUNCTION WITH THE DEVELOPMENT CONSENT ORDER AND OTHER APPLICATION PLANS.
- KEY:**
- DEVELOPMENT CONSENT ORDER (DCO) LIMITS
 - THE SCHEME (SHOWN FOR ILLUSTRATIVE PURPOSES ONLY)
 - EXISTING ORDNANCE SURVEY DATA
 - NEW, ALTERED OR IMPROVED HIGHWAY - MOTORWAY
 - NEW, ALTERED OR IMPROVED HIGHWAY - SIDE ROADS
 - NEW / ALTERED PRIVATE MEANS OF ACCESS
 - NEW OR ALTERED FOOTWAY
 - NEW CYCLE TRACK
 - NEW NON SEGREGATED FOOTWAY / CYCLE TRACK
 - EXISTING HIGHWAYS TO BE STOPPED UP
 - PRIVATE MEANS OF ACCESS TO BE STOPPED UP
 - EXISTING PUBLIC RIGHT OF WAY (PROW)
 - EXISTING PUBLIC RIGHT OF WAY TO BE STOPPED UP
 - NEW / SUBSTITUTED FOOTPATH
 - NEW / SUBSTITUTED BRIDLEWAY
 - PROPOSED FENCE LINE
 - REFERENCE LABEL FOR NEW PUBLIC RIGHT OF WAY, FOOTWAY, CYCLE TRACK, OR COMBINED FOOTWAY AND CYCLE TRACK
 - REFERENCE LABEL FOR EXISTING PRIVATE MEANS OF ACCESS TO BE STOPPED UP
 - REFERENCE LABEL FOR NEW/SUBSTITUTED PRIVATE MEANS OF ACCESS
 - REFERENCE LABEL FOR START/END POINT OF HIGHWAY / RIGHT OF WAY TO BE DIVERTED, CREATED, STOPPED UP OR EXTINGUISHED
 - PROPOSED GATE
 - PARISH BOUNDARY
 - MAINLINE CHAINAGE
 - NEW MAINTENANCE BAY

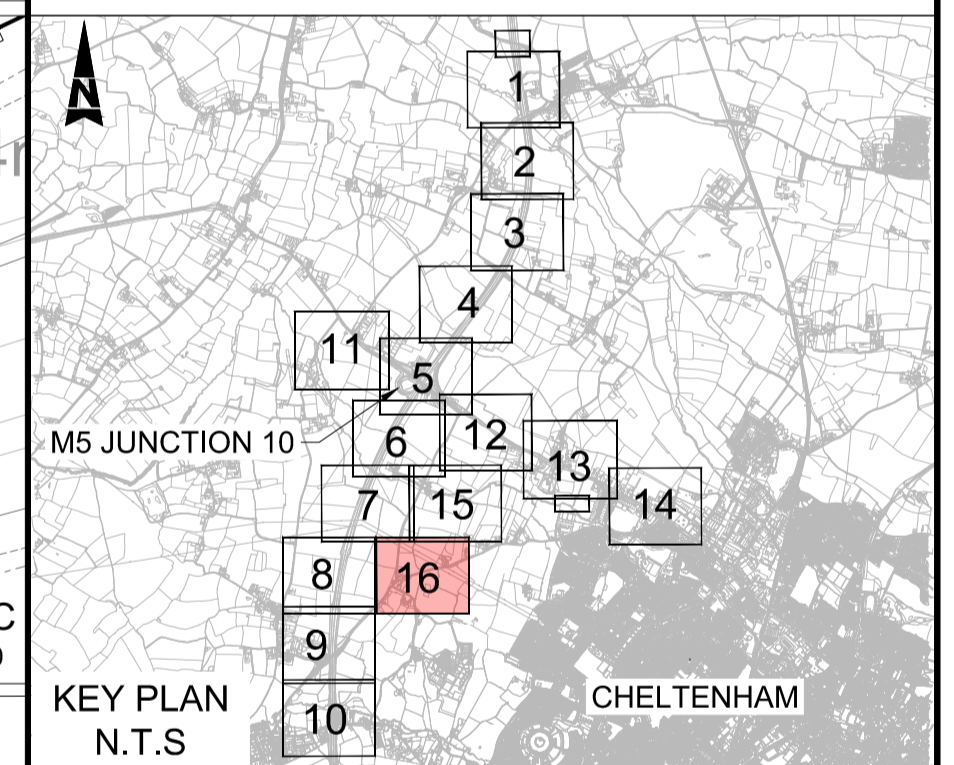
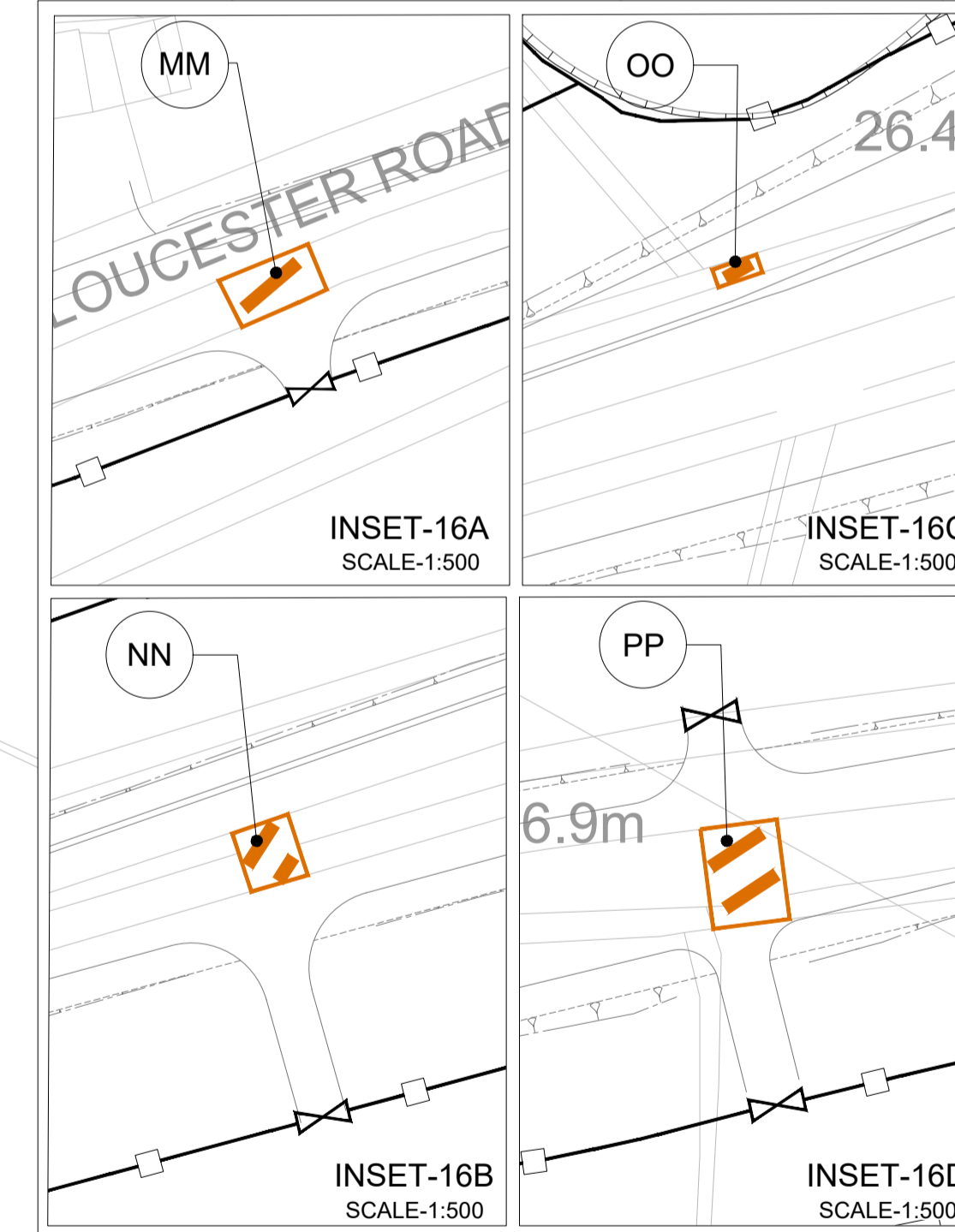
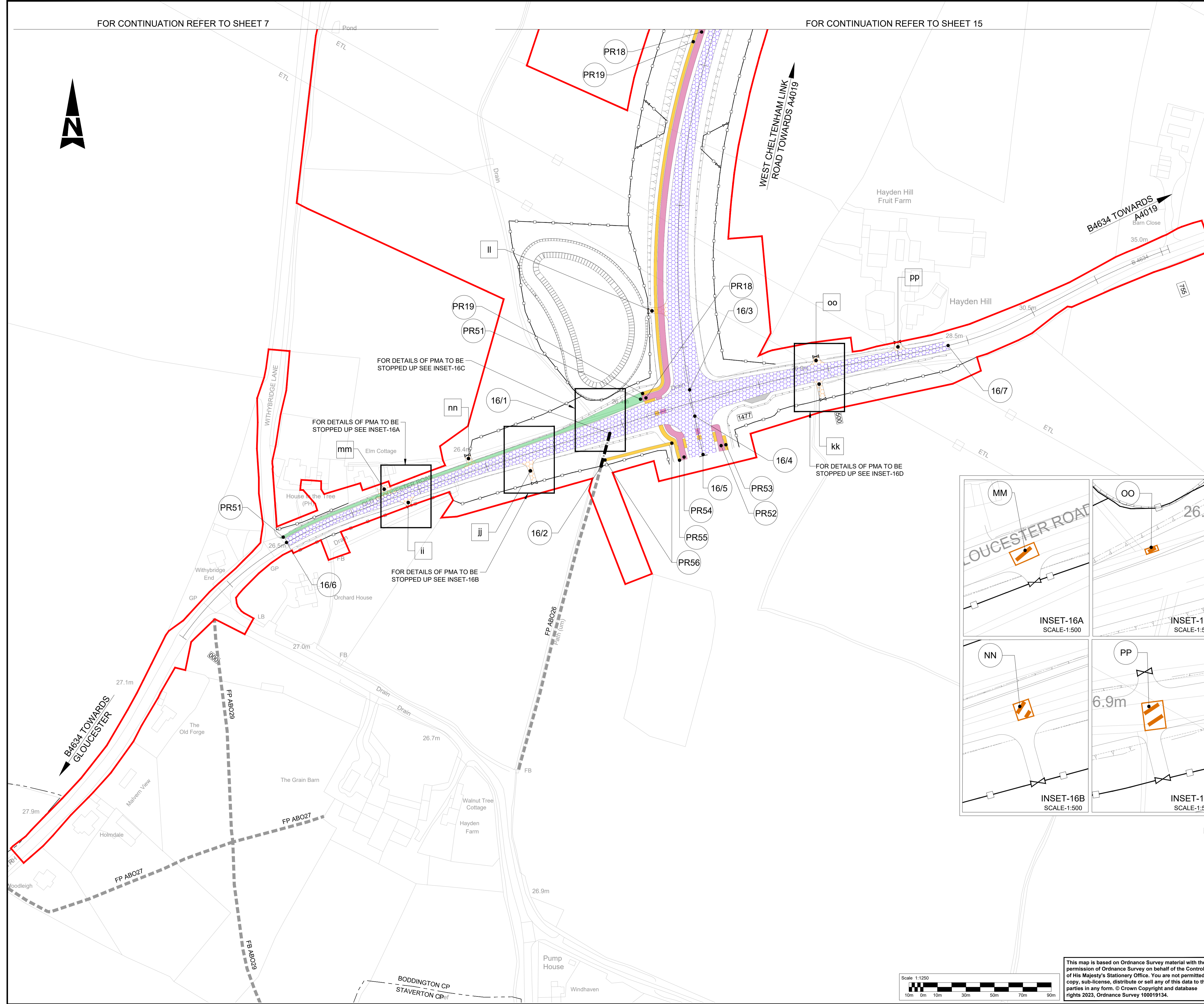

Description	Status	Revision	Drawn	Checked	Reviewed	Authorised	Issue Date

Description	Status	Revision	Drawn	Checked	Reviewed	Authorised	Issue Date
FIRST SUBMISSION	A1	C01	NKRP	CJ	HC	BM	18/10/23

APPROVED - PUBLISHED A1

Project Title
M5 Junction 10 Improvements Scheme

Drawing Title
**STREETS, RIGHTS OF WAY AND ACCESS PLANS
REGULATION 5(2)(k)
SHEET 16 OF 16**

Drawing Number
TR010063/APP/2.5

Original Size: **A1** Scale: **1:1250** Project Ref. No: **5197035** Sheet: **16 of 16** Rev: **C01**

This map is based on Ordnance Survey material with the permission of Ordnance Survey on behalf of the Controller of His Majesty's Stationery Office. You are not permitted to copy, sub-license, distribute or sell any of this data to third parties in any form. © Crown Copyright and database rights 2023, Ordnance Survey 100019134.

ATKINS

Member of the SNC-Lavalin Group

5th Floor, Block 5
Shire Hall
Bearland
Gloucester
GL1 2TH