

M5 Junction 10 Improvements Scheme

Biodiversity Sites and Features Plan - Part 2 TR010063 - APP 2.11

Regulation 5 (2) (I)

Planning Act 2008

Infrastructure Planning (Applications: Prescribed Forms and Procedure) Regulations 2009



Volume 2

December 2023



Gloucestershire
COUNTY COUNCIL

THIS PAGE IS LEFT INTENTIONALLY BLANK

**Infrastructure Planning
Planning Act 2008**

**The Infrastructure Planning
(Applications: Prescribed Forms and
Procedure) Regulations 2009**

**M5 Junction 10 Improvements Scheme
Development Consent Order 202[x]**

Biodiversity Sites and Features Plan - Part 2

Regulation Number:	Regulation 5 (2) (l)
Planning Inspectorate Scheme Reference	TR010063
Application Document Reference	TR010063 – APP 2.11
Author:	M5 Junction 10 Improvement Scheme Project Team

Version	Date	Status of Version
Rev 0	December 2023	DCO Application

1. Schedule of Plans included in the application

1.1. List of drawings in Part 1

Document Title	Document Number	Revision
Biodiversity Sites and Features Plan – Key Plan	TR010063 – APP 2.11	C01
Biodiversity Sites and Features Plan – Site Plan	TR010063 – APP 2.11	C01
Biodiversity Sites and Features Plan – Sheet 1 of 16	TR010063 – APP 2.11	C01
Biodiversity Sites and Features Plan – Sheet 2 of 16	TR010063 – APP 2.11	C01
Biodiversity Sites and Features Plan – Sheet 3 of 16	TR010063 – APP 2.11	C01
Biodiversity Sites and Features Plan –Sheet 4 of 16	TR010063 – APP 2.11	C01
Biodiversity Sites and Features Plan – Sheet 5 of 16	TR010063 – APP 2.11	C01
Biodiversity Sites and Features Plan – Sheet 6 of 16	TR010063 – APP 2.11	C01
Biodiversity Sites and Features Plan – Sheet 7 of 16	TR010063 – APP 2.11	C01
Biodiversity Sites and Features Plan – Sheet 8 of 16	TR010063 – APP 2.11	C01
Biodiversity Sites and Features Plan – Sheet 9 of 16	TR010063 – APP 2.11	C01
Biodiversity Sites and Features Plan – Sheet 10 of 16	TR010063 – APP 2.11	C01

1.2. List of drawings in Part 2

Document Title	Document Number	Revision
Biodiversity Sites and Features Plan – Sheet 11 of 16	TR010063 – APP 2.11	C01
Biodiversity Sites and Features Plan – Sheet 12 of 16	TR010063 – APP 2.11	C01
Biodiversity Sites and Features Plan – Sheet 13 of 16	TR010063 – APP 2.11	C01
Biodiversity Sites and Features Plan – Sheet 14 of 16	TR010063 – APP 2.11	C01
Biodiversity Sites and Features Plan – Sheet 15 of 16	TR010063 – APP 2.11	C01
Biodiversity Sites and Features Plan – Sheet 16 of 16	TR010063 – APP 2.11	C01

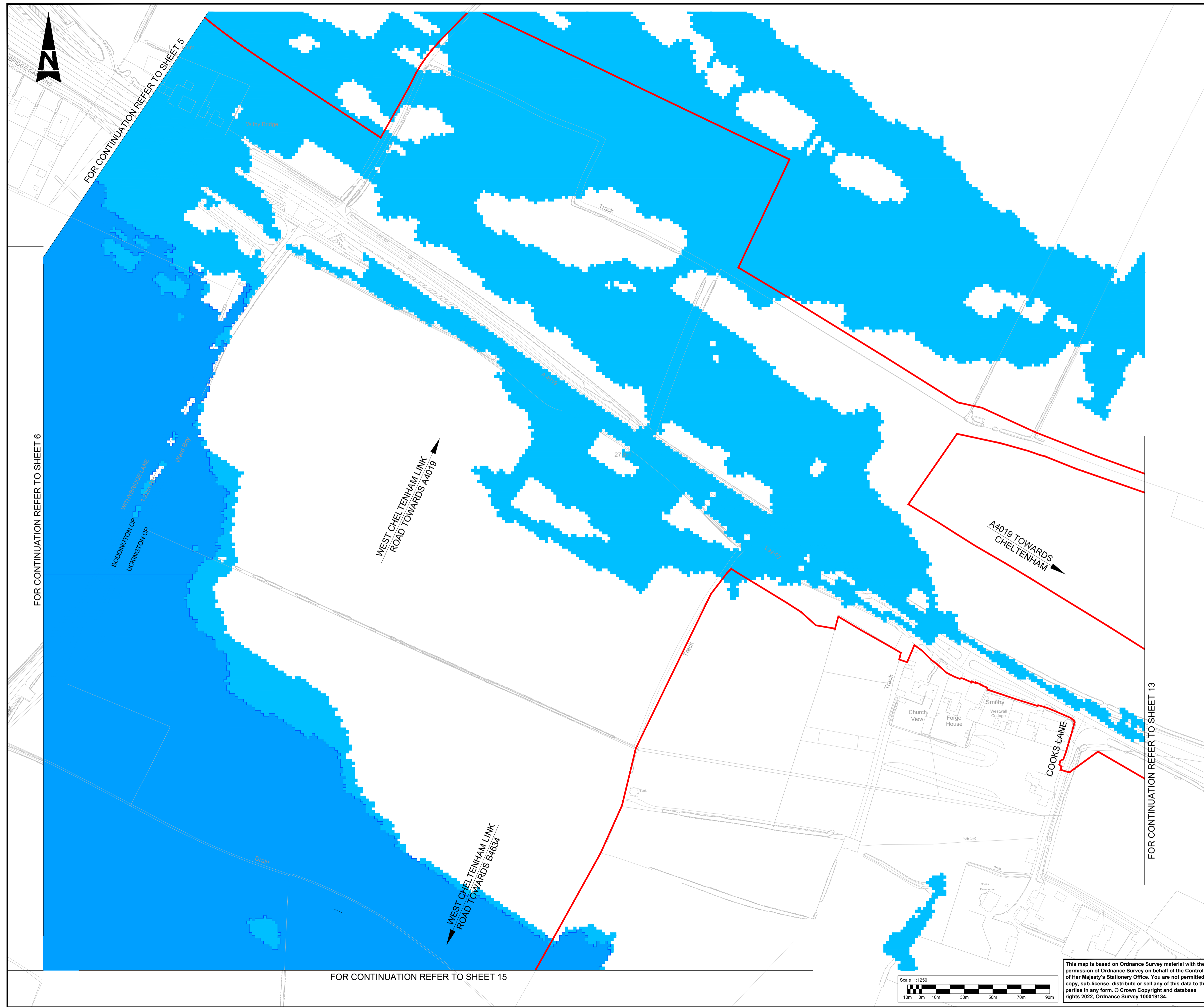

- NOTES:**
- ALL DIMENSIONS ARE IN METRES UNLESS OTHERWISE STATED.
 - THE WORKS PLANS SHOULD BE READ IN CONJUNCTION WITH THE DEVELOPMENT CONSENT ORDER.
 - THERE ARE NO SITES WITHIN THE MAP AREA THAT ARE DESIGNATED AS SACS, SPAS, SSSIS, RAMSAR SITES, NNRS, AND LNRS.

- KEY**
- DEVELOPMENT CONSENT ORDER (DCO) BOUNDARY
 - WFD SURFACE WATERBODIES
 - 1 IN 1000 YEARS BASELINE FLOODPLAIN
 - 1 IN 100 YEARS BASELINE FLOODPLAIN

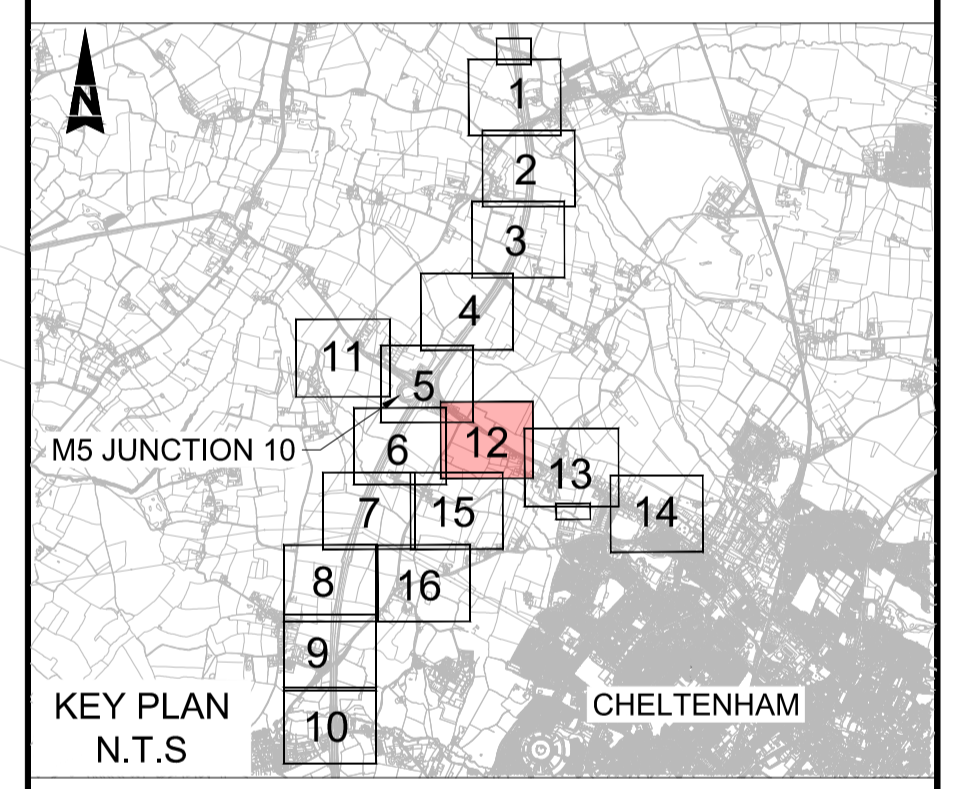

Description						
Status	Revision	Drawn	Checked	Reviewed	Authorised	Issue Date
Description						
Status	Revision	Drawn	Checked	Reviewed	Authorised	Issue Date
Description						
Status	Revision	Drawn	Checked	Reviewed	Authorised	Issue Date
Description						
Status	Revision	Drawn	Checked	Reviewed	Authorised	Issue Date
Description						
Status	Revision	Drawn	Checked	Reviewed	Authorised	Issue Date
A1	C01	AC	SS	CDC	BM	17 10/23
Drawing Suitability						Status
APPROVED - PUBLISHED						A1

Project Title		
M5 Junction 10 Improvements Scheme		
Drawing Title		
BIODIVERSITY SITES AND FEATURES PLAN		
SHEET 12 OF 16		
Drawing Number		
GCCM5J10	ATK	EBD
ZZ	DR	LS 000013
Original Size: A1	Scale: AS SHOWN	Project Ref. No: 5197035
Sheet: 12 of 16	Rev: C01	

This map is based on Ordnance Survey material with the permission of Ordnance Survey on behalf of the Controller of Her Majesty's Stationery Office. You are not permitted to copy, sub-license, distribute or sell any of this data to third parties in any form. © Crown Copyright and database rights 2022, Ordnance Survey 100019134.

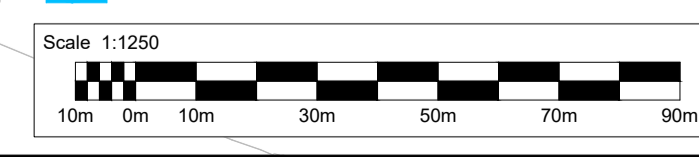

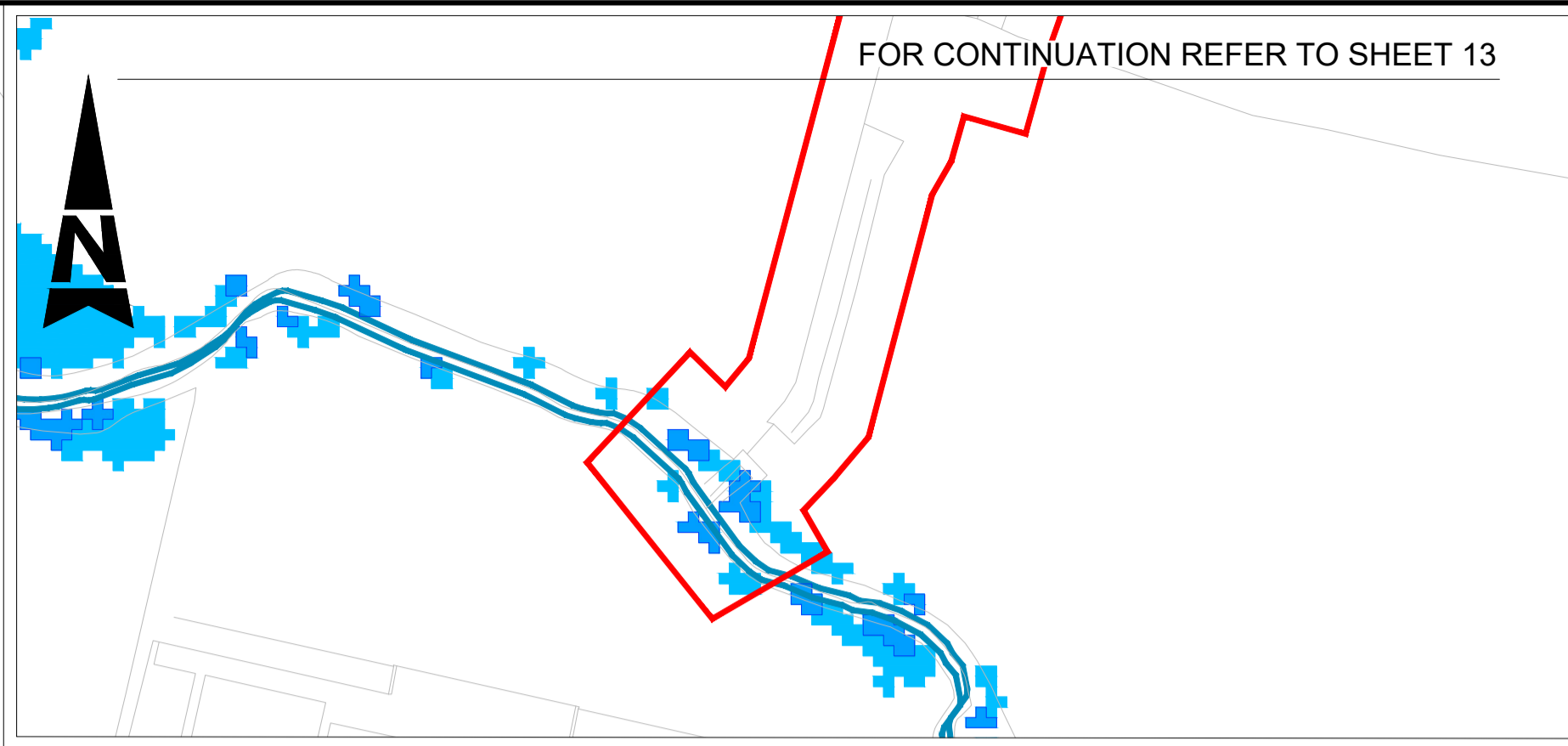
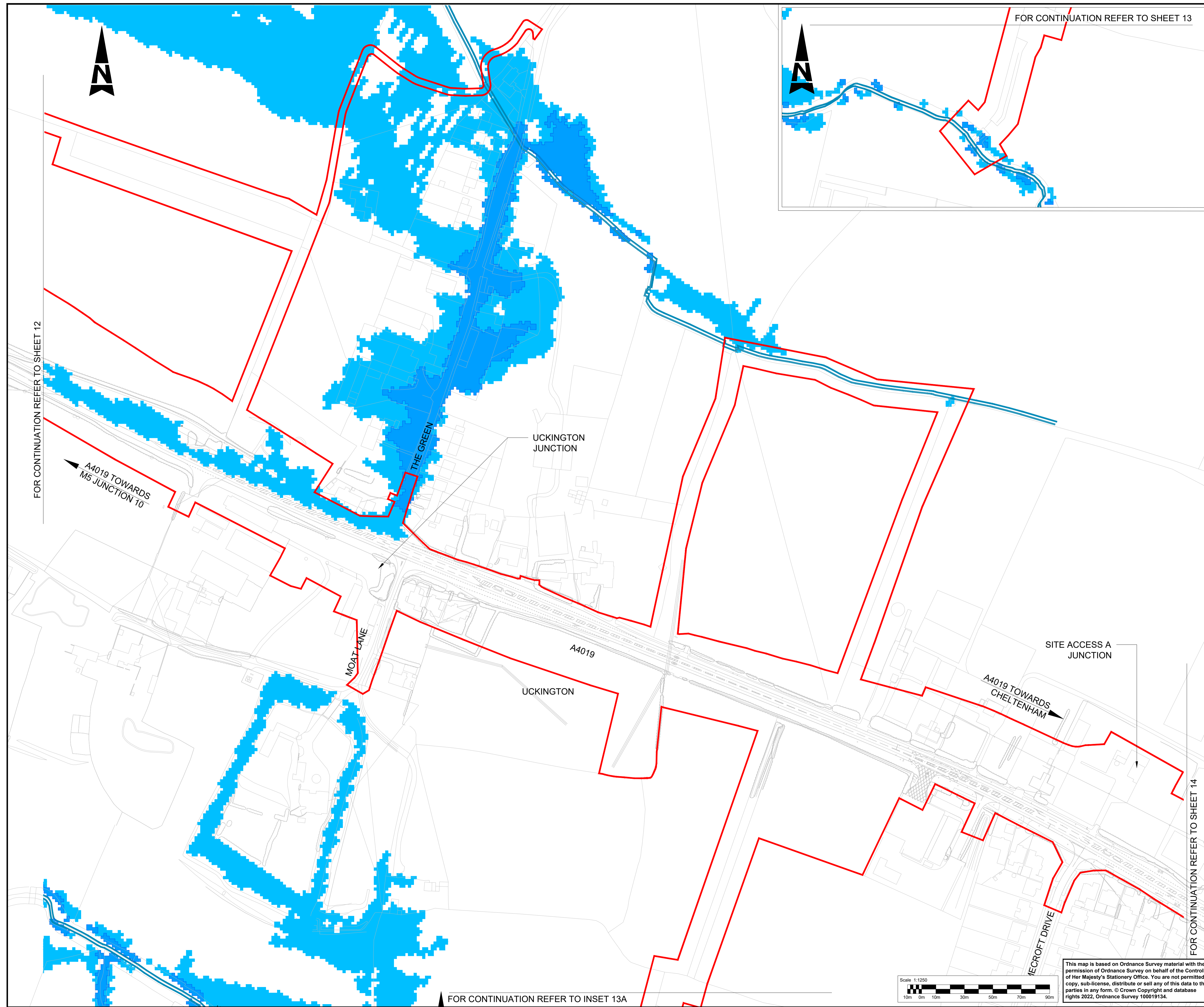

- NOTES:**
1. ALL DIMENSIONS ARE IN METRES UNLESS OTHERWISE STATED.
 2. THE WORKS PLANS SHOULD BE READ IN CONJUNCTION WITH THE DEVELOPMENT CONSENT ORDER.
 3. THERE ARE NO SITES WITHIN THE MAP AREA THAT ARE DESIGNATED AS SACS, SPAS, SSSIS, RAMSAR SITES, NNRS, AND LNRS.
- KEY**
- DEVELOPMENT CONSENT ORDER (DCO) BOUNDARY
 - WFD SURFACE WATERBODIES
 - 1 IN 1000 YEARS BASELINE FLOODPLAIN
 - 1 IN 100 YEARS BASELINE FLOODPLAIN

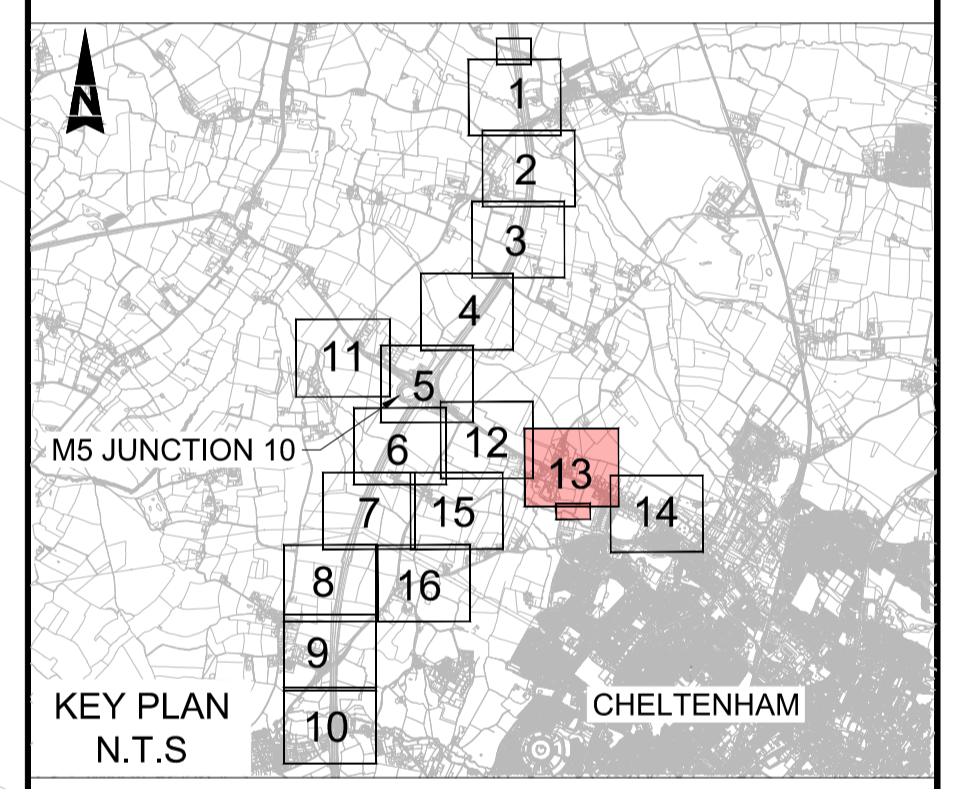

Description						
Status	Revision	Drawn	Checked	Reviewed	Authorised	Issue Date
Description						
Status	Revision	Drawn	Checked	Reviewed	Authorised	Issue Date
Description						
Status	Revision	Drawn	Checked	Reviewed	Authorised	Issue Date
Description						
Status	Revision	Drawn	Checked	Reviewed	Authorised	Issue Date
A1	C01	AC	SS	CDC	BM	17/10/23
Drawing Suitability						Status
APPROVED - PUBLISHED						A1
Project Title						
M5 Junction 10 Improvements Scheme						
Drawing Title						
BIODIVERSITY SITES AND FEATURES PLAN						
SHEET 13 OF 16						
Drawing Number						
GCCM5J10	ATK	EBD	ZZ	DR	LS	000014
Original Size: A1	Scale: AS SHOWN	Project Ref. No: 5197035	Sheet: 14 of 16	Rev: C01		



This map is based on Ordnance Survey material with the permission of Ordnance Survey on behalf of the Controller of Her Majesty's Stationery Office. You are not permitted to copy, sub-license, distribute or sell any of this data to third parties in any form. © Crown Copyright and database rights 2022, Ordnance Survey 100019134.

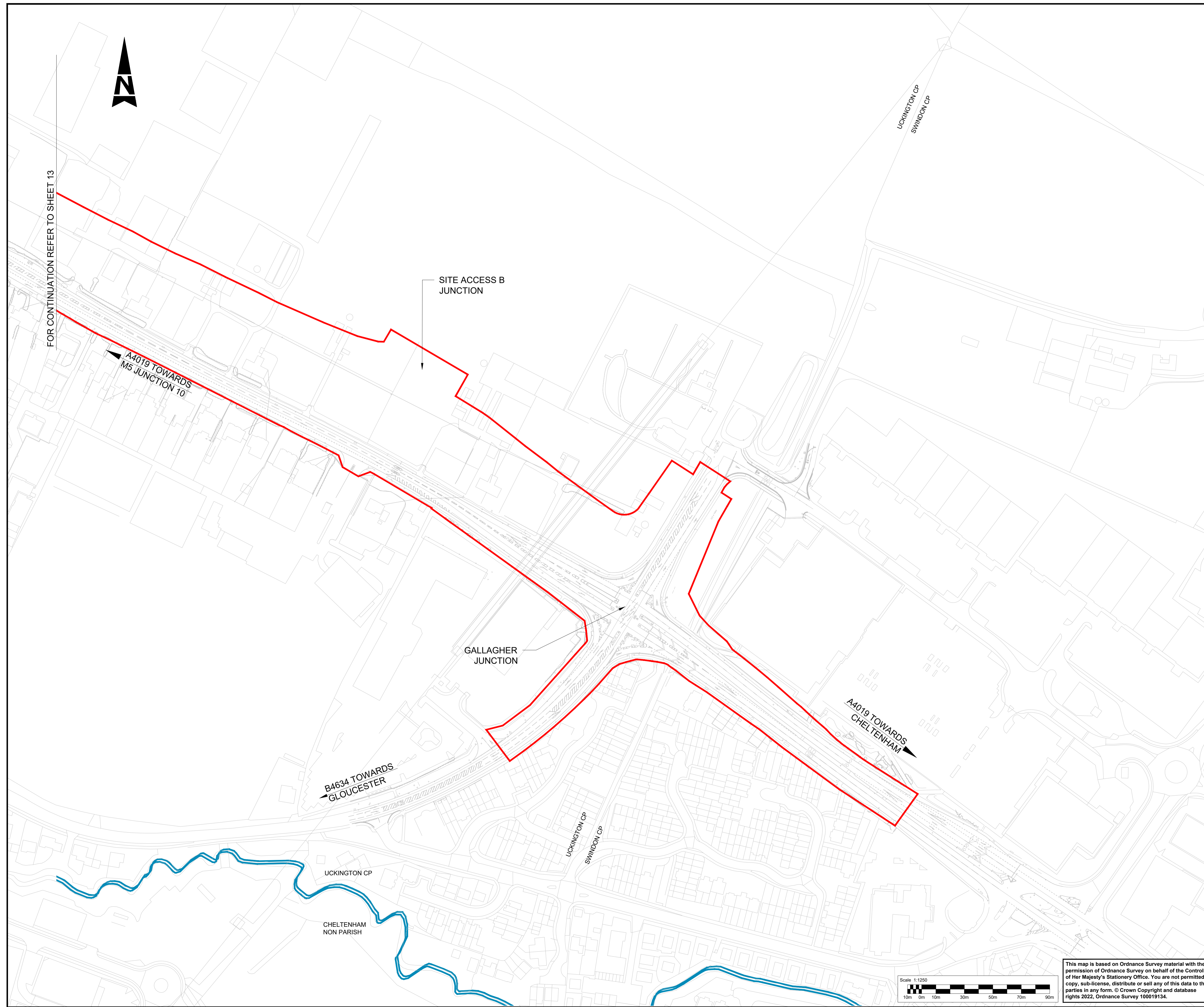

- NOTES:**
1. ALL DIMENSIONS ARE IN METRES UNLESS OTHERWISE STATED.
 2. THE WORKS PLANS SHOULD BE READ IN CONJUNCTION WITH THE DEVELOPMENT CONSENT ORDER.
 3. THERE ARE NO SITES WITHIN THE MAP AREA THAT ARE DESIGNATED AS SACS, SPAS, SSSIS, RAMSAR SITES, NNRS, AND LNRS.

- KEY**
- DEVELOPMENT CONSENT ORDER (DCO) BOUNDARY
 - WFD SURFACE WATERBODIES
 - 1 IN 1000 YEARS BASELINE FLOODPLAIN
 - 1 IN 100 YEARS BASELINE FLOODPLAIN

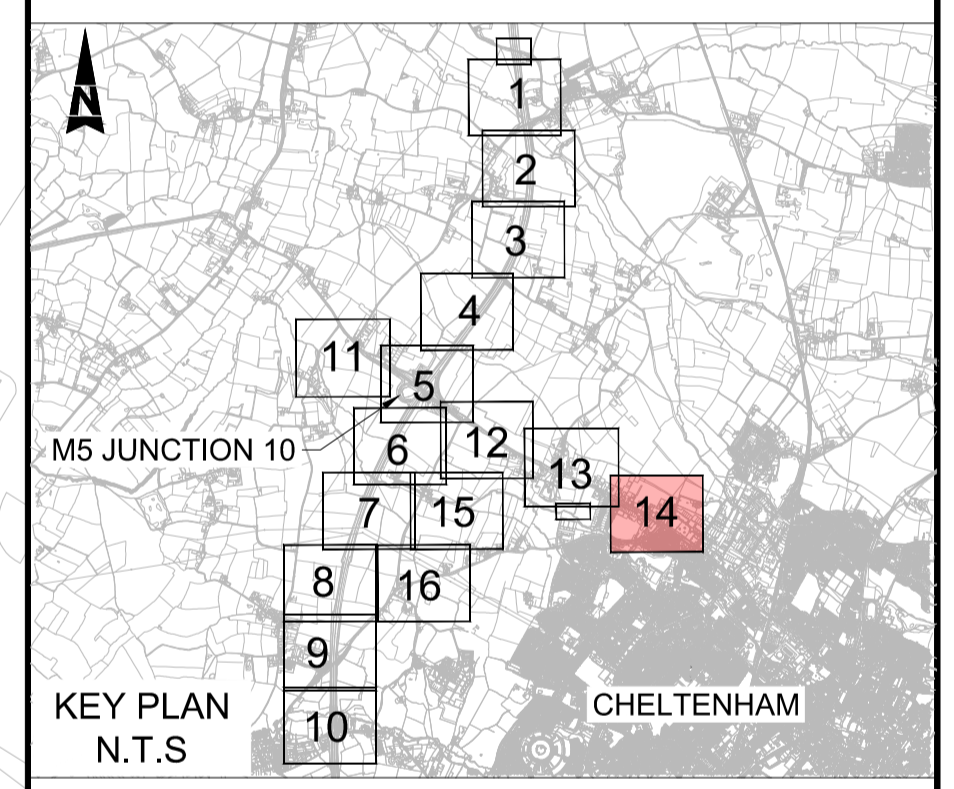

Description						
Status	Revision	Drawn	Checked	Reviewed	Authorised	Issue Date
Description						
Status	Revision	Drawn	Checked	Reviewed	Authorised	Issue Date
Description						
Status	Revision	Drawn	Checked	Reviewed	Authorised	Issue Date
Description						
Status	Revision	Drawn	Checked	Reviewed	Authorised	Issue Date
Description						
Status	Revision	Drawn	Checked	Reviewed	Authorised	Issue Date
A1	C01	AC	SS	CDC	BM	17/10/23
Drawing Suitability						Status
APPROVED - PUBLISHED						A1

Project Title		
M5 Junction 10 Improvements Scheme		
Drawing Title		
BIODIVERSITY SITES AND FEATURES PLAN		
SHEET 14 OF 16		
Drawing Number		
GCCM5J10	ATK	EBD
ZZ	DR	LS 000015
Original Size: A1	Scale: AS SHOWN	Project Ref. No. 5197035
Sheet: 14 of 16	Rev: C01	

This map is based on Ordnance Survey material with the permission of Ordnance Survey on behalf of the Controller of Her Majesty's Stationery Office. You are not permitted to copy, sub-license, distribute or sell any of this data to third parties in any form. © Crown Copyright and database rights 2022, Ordnance Survey 100019134.

ATKINS

Member of the SNC-Lavalin Group

5th Floor, Block 5
Shire Hall
Bearland
Gloucester
GL1 2TH