

A428 Black Cat to Caxton Gibbet improvements

TR010044

Volume 2

2.11 Crown Land Plans

Planning Act 2008

Regulation 5(2)(n)

Infrastructure Planning (Examination Procedure) Rules 2010

04 November 2021

Infrastructure Planning

Planning Act 2008

**The Infrastructure Planning
(Examination Procedure) Rules 2010****A428 Black Cat to Caxton Gibbet
improvements
Development Consent Order 202[]**

Crown Land Plans

Regulation Reference:	Regulation 5(2)(n)
Planning Inspectorate Scheme Reference	TR010044
Application Document Reference	TR010044/APP/2.11
Author	A428 Black Cat to Caxton Gibbet improvements Project Team, National Highways

Version	Date	Status of Version
Rev 1	26 February 2021	DCO Application
Rev 2	4 November 2021	DCO Examination

Table of contents

Chapter	Pages
1 Introduction	1
1.1 General	1
2 Schedule of plans included in this application document	2
Appendix A Crown land plans	3

1 Introduction

1.1 General

- 1.1.1 National Highways (the Applicant) has submitted an application under Section 37 of the Planning Act 2008 (PA 2008) for an order to grant development consent for the A428 Black Cat to Caxton Gibbet improvements (the Scheme).
- 1.1.2 These Crown Land Plans (these Plans) have been prepared to accompany the application for a Development Consent Order (DCO), made by the Applicant to the Secretary of State for Transport (SoS) via the Planning Inspectorate (the Inspectorate).
- 1.1.3 The Application is seeking powers to construct a new 10 mile (16km) dual 2-lane carriageway from Black Cat roundabout to Caxton Gibbet roundabout, to be known as the A421, and in addition approximately 1.8 miles (3km) of tie-in works. A detailed description of the Scheme can be found in **Chapter 2** of the Environmental Statement [TR01044/APP/6.1].
- 1.1.4 These Plans comprise part of the suite of Application documentation and are included in the Application in compliance with Regulation 5(2)(n) of the Infrastructure Planning (Applications: Prescribed Forms and Procedure) Regulations 2009 (the 2009 Regulations), which requires:
- '5(2)(n) where applicable, a plan with any accompanying information identifying any Crown land.'*
- 1.1.5 These Plans are also being submitted under Regulation 5(4) of the 2009 Regulations which states:
- "Where a plan comprises three or more separate sheets a key plan must be provided showing the relationship between the different sheets."*
- 1.1.6 As these Plans are part of the Application documentation, they should be read alongside and are informed by the other Application documents. In particular, these Plans should be read alongside the draft DCO [TR010044/APP/3.1], the Land Plans [TR01044/APP/2.2], the Book of Reference [TR010044/APP/4.3] and the Statement of Reasons [TR010044/APP/4.1].

2 Schedule of plans included in this application document

Drawing Number	Drawing Title	Revision
HE551495-ARD-LSI-GEN_SW_Z_ZZ-DR-DC-2110	Crown Land Plans Regulation 5(2)(n) Key Plan	P06
HE551495-ARD-LSI-ZN1_SW_Z_ZZ-DR-DC-2111	Crown Land Plans Regulation 5(2)(n) Sheet 1	P07
HE551495-ARD-LSI-ZN1_SW_Z_ZZ-DR-DC-2112	Crown Land Plans Regulation 5(2)(n) Sheet 2	P07
HE551495-ARD-LSI-ZN1_SW_Z_ZZ-DR-DC-2113	Crown Land Plans Regulation 5(2)(n) Sheet 3	P07
HE551495-ARD-LSI-ZN2_SW_Z_ZZ-DR-DC-2114	Crown Land Plans Regulation 5(2)(n) Sheet 4	P07
HE551495-ARD-LSI-ZN2_SW_Z_ZZ-DR-DC-2115	Crown Land Plans Regulation 5(2)(n) Sheet 5	P07
HE551495-ARD-LSI-ZN2_SW_Z_ZZ-DR-DC-2116	Crown Land Plans Regulation 5(2)(n) Sheet 6	P07
HE551495-ARD-LSI-ZN2_SW_Z_ZZ-DR-DC-2117	Crown Land Plans Regulation 5(2)(n) Sheet 7	P07
HE551495-ARD-LSI-ZN3_SW_Z_ZZ-DR-DC-2118	Crown Land Plans Regulation 5(2)(n) Sheet 8	P07
HE551495-ARD-LSI-ZN3_SW_Z_ZZ-DR-DC-2119	Crown Land Plans Regulation 5(2)(n) Sheet 9	P07
HE551495-ARD-LSI-ZN3_SW_Z_ZZ-DR-DC-2120	Crown Land Plans Regulation 5(2)(n) Sheet 10	P07
HE551495-ARD-LSI-ZN4_SW_Z_ZZ-DR-DC-2121	Crown Land Plans Regulation 5(2)(n) Sheet 11	P07
HE551495-ARD-LSI-ZN4_SW_Z_ZZ-DR-DC-2122	Crown Land Plans Regulation 5(2)(n) Sheet 12	P07
HE551495-ARD-LSI-ZN4_SW_Z_ZZ-DR-DC-2123	Crown Land Plans Regulation 5(2)(n) Sheet 13	P07
HE551495-ARD-LSI-ZN5_SW_Z_ZZ-DR-DC-2124	Crown Land Plans Regulation 5(2)(n) Sheet 14	P07
HE551495-ARD-LSI-ZN5_SW_Z_ZZ-DR-DC-2125	Crown Land Plans Regulation 5(2)(n) Sheet 15	P07
HE551495-ARD-LSI-ZN5_SW_Z_ZZ-DR-DC-2126	Crown Land Plans Regulation 5(2)(n) Sheet 16	P07

Appendix A Crown land plans

CROWN FREEHOLD	1/3a, 1/3b, 1/3c, 1/4a, 1/4b, 1/5a, 1/6a, 1/6b, 1/6c, 1/6d & 1/24a
CROWN RIGHTS ONLY	1/1m, 1/1n, 1/8e, 1/8g, 1/8o, 1/8r, 1/9b, 1/10a, 1/10b, 1/10c, 1/10e, 1/10f, 1/10g, 1/10h, 1/10k, 1/19a, 1/32a, 1/32b, 1/32c, 1/43c, 1/43d, 1/43f & 1/54a

CUT LINE SEE SHEET 2

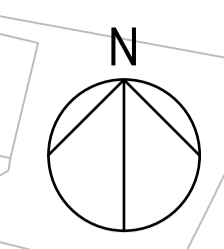

- NOTES
- ALL DIMENSIONS ARE IN METRES UNLESS STATED OTHERWISE.
 - DO NOT SCALE FROM THIS DRAWING, USE ONLY PRINTED DIMENSIONS.
 - ALL EASEMENTS, SERVITUDES AND PRIVATE RIGHTS ARE PROPOSED TO BE EXTINGUISHED ON LAND THAT IS TO BE ACQUIRED UNLESS STATED OTHERWISE IN THE BOOK OF REFERENCE.
 - THIS DRAWING IS TO BE READ IN CONJUNCTION WITH ALL OTHER PLANS AND DOCUMENTATION, IN PARTICULAR THE WORK PLANS [TR010044/APP/2.3] AND THE BOOK OF REFERENCE [TR010044/APP/4.3].

- LEGEND
- ORDER LIMITS
 - EXCLUSION FROM ORDER LIMITS
 - ADMINISTRATIVE BOUNDARY
 - PARCEL NUMBERS
 - CROWN LAND - KNOWN OR PRESUMED LAND INTEREST OF THE SECRETARY OF STATE FOR TRANSPORT - PERMANENT ACQUISITION
 - CROWN LAND - KNOWN OR PRESUMED LAND INTEREST OF THE SECRETARY OF STATE FOR ENVIRONMENT, FOOD AND RURAL AFFAIRS - PERMANENT ACQUISITION
 - CROWN LAND - KNOWN OR PRESUMED LAND INTEREST OF BONA VACANTIA - PERMANENT ACQUISITION
 - CROWN LAND - KNOWN OR PRESUMED LAND INTEREST OF THE SECRETARY OF STATE FOR TRANSPORT - TEMPORARY POSSESSION AND ACQUISITION OF NEW RIGHTS
 - CROWN LAND - KNOWN OR PRESUMED LAND INTEREST OF THE SECRETARY OF STATE FOR ENVIRONMENT, FOOD AND RURAL AFFAIRS - TEMPORARY POSSESSION AND ACQUISITION OF NEW RIGHTS
 - CROWN LAND - KNOWN OR PRESUMED LAND INTEREST OF BONA VACANTIA - TEMPORARY POSSESSION AND ACQUISITION OF NEW RIGHTS
 - CROWN LAND - KNOWN OR PRESUMED LAND INTEREST OF THE SECRETARY OF STATE FOR TRANSPORT - TEMPORARY POSSESSION
 - CROWN LAND - KNOWN OR PRESUMED LAND INTEREST OF THE SECRETARY OF STATE FOR ENVIRONMENT, FOOD AND RURAL AFFAIRS - TEMPORARY POSSESSION
 - CROWN LAND - KNOWN OR PRESUMED LAND INTEREST OF BONA VACANTIA - TEMPORARY POSSESSION

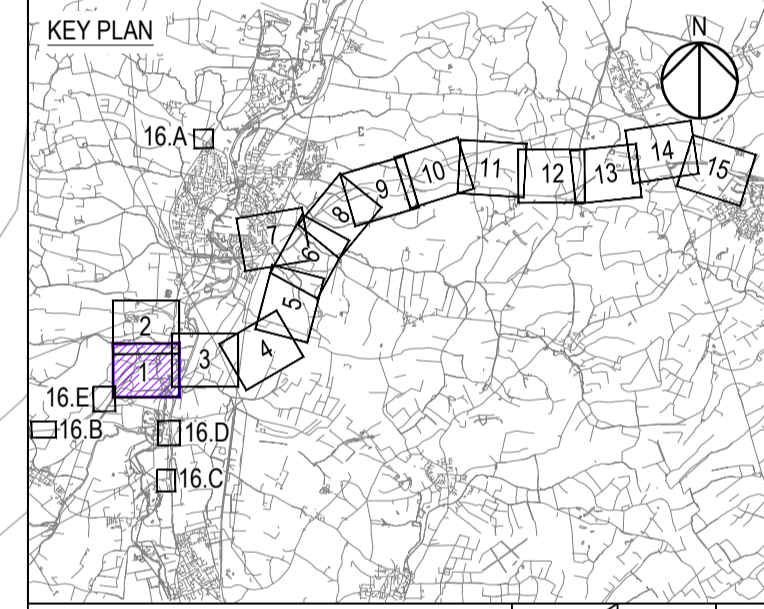

Final for DCO Examination	GJ	AP	04/11/21	P07
Revision Details	By	Check	Date	Suffix

Purpose of issue
DCO Examination

Client
National Highways
Woodlands
Manton Industrial Estate
Bedford
MK41 7LW

Working on behalf of
national highways

Development Consent Order Number
TR010044

Project Title
A428 BLACK CAT TO CAXTON GIBBET IMPROVEMENTS

Drawing Title
CROWN LAND PLANS REGULATION 5(2)(n) SHEET 1

Designed AECOM	Drawn GJ	Checked AP	Approved PG	Date 04/11/21
Internal Project No. 60541541	Scale @ A1 1:2500		Suitability D9	Zone ZN1

THIS DOCUMENT HAS BEEN PREPARED PURSUANT TO AND SUBJECT TO THE TERMS OF AECOM'S APPOINTMENT BY ITS CLIENT. AECOM ACCEPTS NO LIABILITY FOR ANY USE OF THIS DOCUMENT OTHER THAN BY ITS ORIGINAL CLIENT OR FOLLOWING AECOM'S EXPRESS AGREEMENT TO SUCH USE, AND ONLY FOR THE PURPOSES FOR WHICH IT WAS PREPARED AND PROVIDED.

Drawing Number HE551495	National Highways PIN -ARD	1 Originator -LSI	1 Volume -DC-2111	Rev P07
Location ZN1_SW_Z_ZZ -DR-DC-2111				I Type 1 Route 1 Number

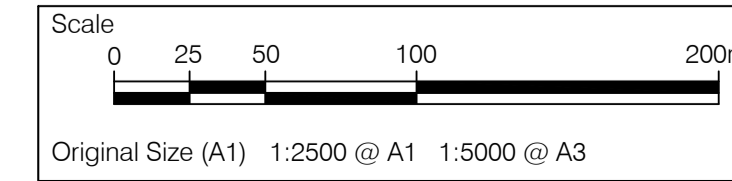
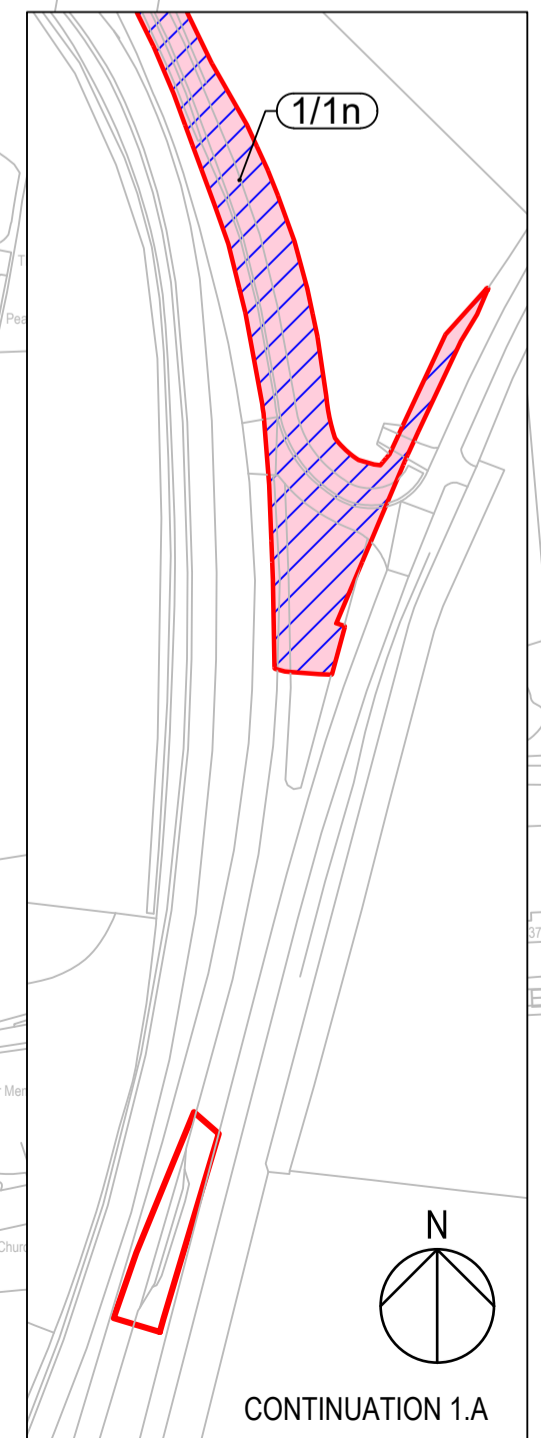
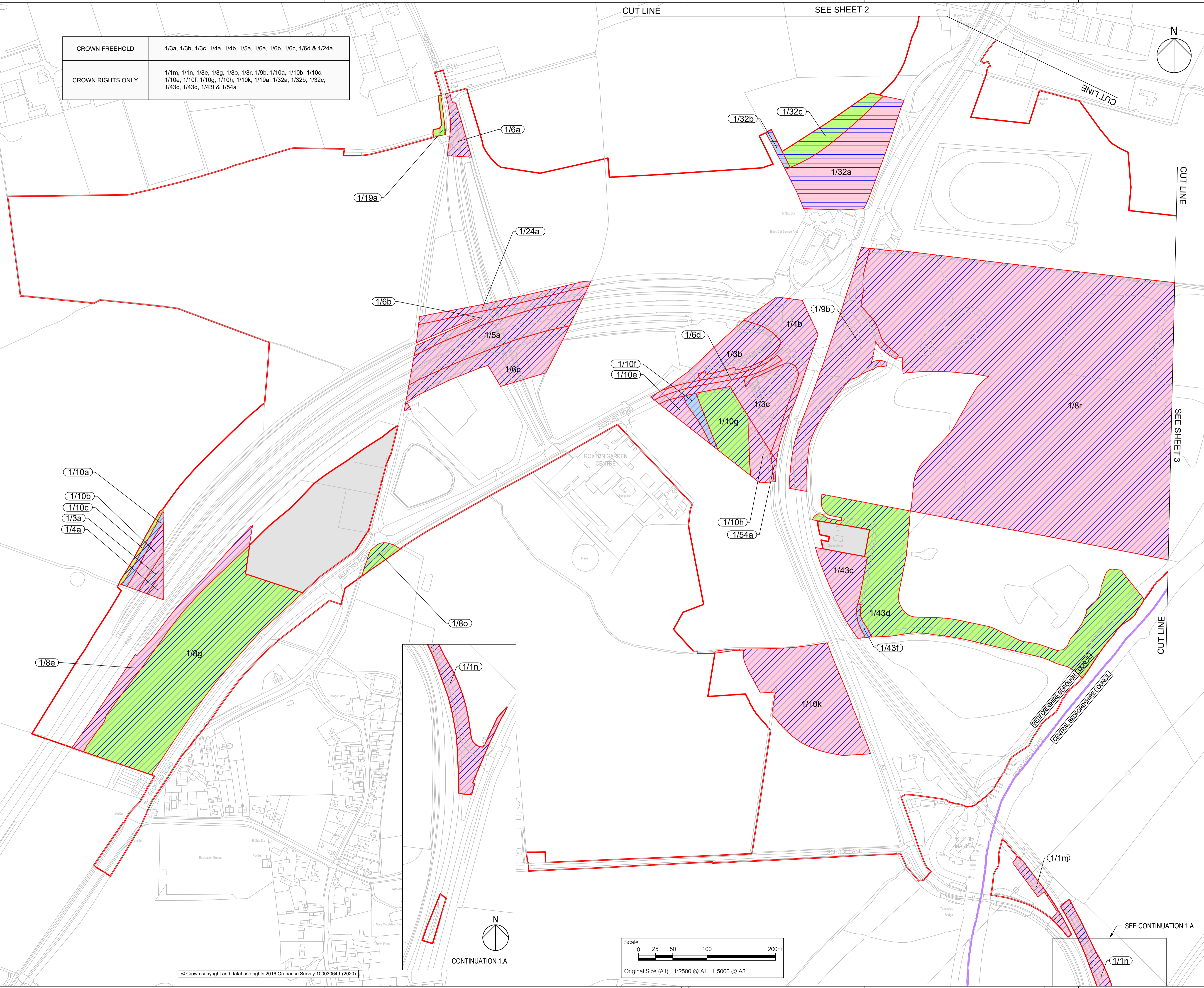

Plot Code: 15 October 2021 10:29:00
 File Name: N:\GIS\TEMP\A428\A428_CROWN LAND PLANS_HE13_04112021

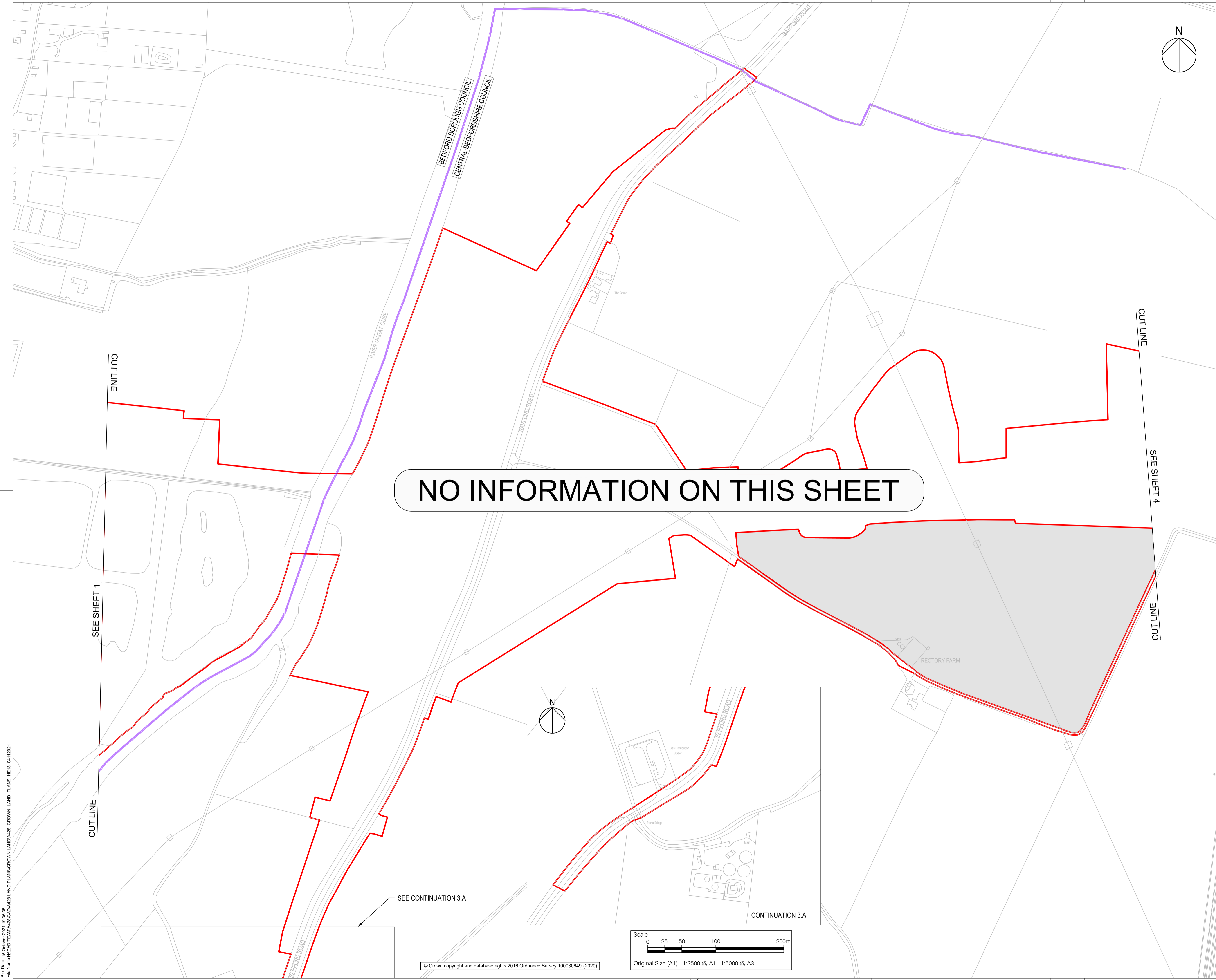

NO INFORMATION ON THIS SHEET

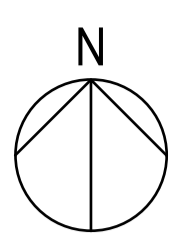

- NOTES**
1. ALL DIMENSIONS ARE IN METRES UNLESS STATED OTHERWISE.
 2. DO NOT SCALE FROM THIS DRAWING, USE ONLY PRINTED DIMENSIONS.
 3. ALL EASEMENTS, SERVITUDES AND PRIVATE RIGHTS ARE PROPOSED TO BE EXTINGUISHED ON LAND THAT IS TO BE ACQUIRED UNLESS STATED OTHERWISE IN THE BOOK OF REFERENCE.
 4. THIS DRAWING IS TO BE READ IN CONJUNCTION WITH ALL OTHER PLANS AND DOCUMENTATION, IN PARTICULAR THE WORK PLANS [TR010044/APP/2.3] AND THE BOOK OF REFERENCE [TR010044/APP/4.3].

LEGEND

- ORDER LIMITS
- EXCLUSION FROM ORDER LIMITS
- ADMINISTRATIVE BOUNDARY

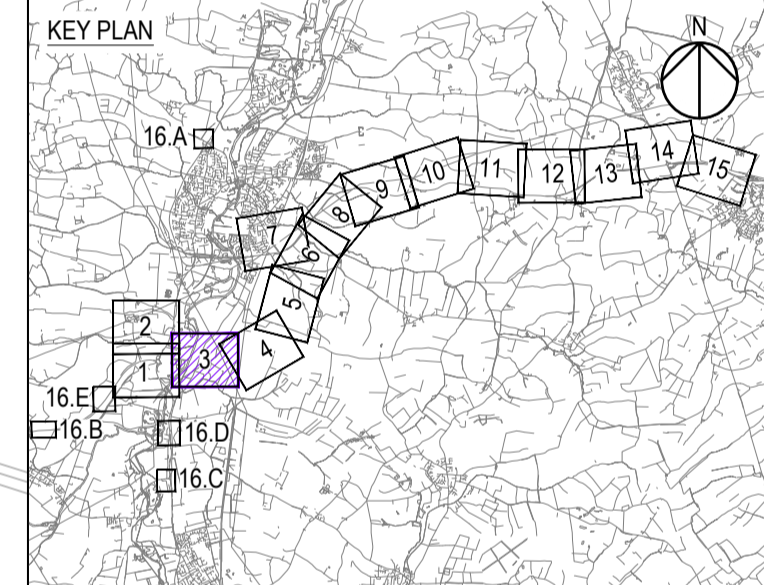

Final for DCO Examination	GJ	04/11/21	P07
Revision Details	By	Date	Suffix
	Check		

Purpose of issue
DCO Examination

Client
National Highways
Woodlands
Manton Lane
Manton Industrial Estate
Bedford
MK41 7LW



Development Consent Order Number
TR010044

Project Title
A428 BLACK CAT TO CAXTON GIBBET IMPROVEMENTS

Drawing Title
CROWN LAND PLANS REGULATION 5(2)(n) SHEET 3

Designed AECOM	Drawn GJ	Checked AP	Approved PG	Date 04/11/21
Internal Project No. 60541541			Suitability D9	
Scale @ A1 1:2500			Zone ZN1	

THIS DOCUMENT HAS BEEN PREPARED PURSUANT TO AND SUBJECT TO THE TERMS OF AECOM'S APPOINTMENT BY ITS CLIENT. AECOM ACCEPTS NO LIABILITY FOR ANY USE OF THIS DOCUMENT OTHER THAN BY ITS ORIGINAL CLIENT OR FOLLOWING AECOM'S EXPRESS AGREEMENT TO SUCH USE, AND ONLY FOR THE PURPOSES FOR WHICH IT WAS PREPARED AND PROVIDED.

Drawing Number HE551495	National Highways PIN -ARD	1 Originator -LSI	1 Volume -	Rev P07
Location ZN1_SW_Z_ZZ -DR-DC-2113				I Type 1

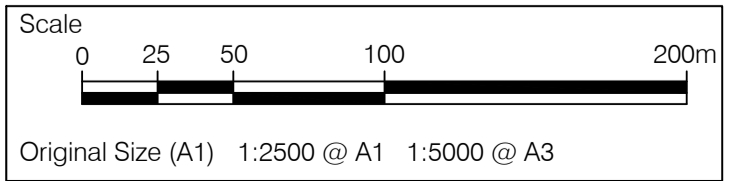
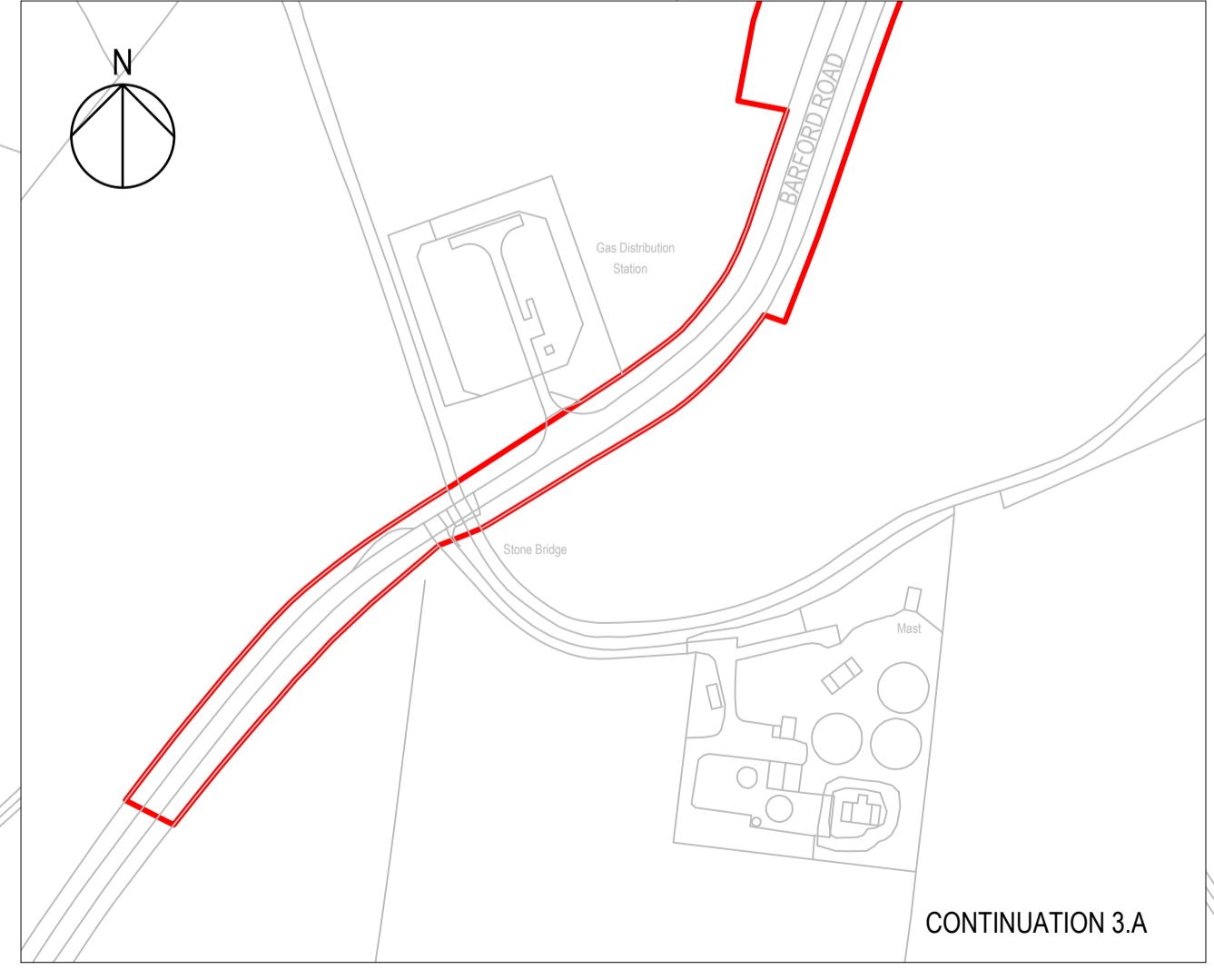

© Crown copyright and database rights 2016 Ordnance Survey 100030649 (2020)

Plot Date: 15 October 2021 10:09:35
 File Name: N:\GIS\TEMP\20210928\LAND PLANS\CROWN LAND\LAND PLANS_HE13_04112021

- NOTES**
1. ALL DIMENSIONS ARE IN METRES UNLESS STATED OTHERWISE.
 2. DO NOT SCALE FROM THIS DRAWING, USE ONLY PRINTED DIMENSIONS.
 3. ALL EASEMENTS, SERVITUDES AND PRIVATE RIGHTS ARE PROPOSED TO BE EXTINGUISHED ON LAND THAT IS TO BE ACQUIRED UNLESS STATED OTHERWISE IN THE BOOK OF REFERENCE.
 4. THIS DRAWING IS TO BE READ IN CONJUNCTION WITH ALL OTHER PLANS AND DOCUMENTATION, IN PARTICULAR THE WORK PLANS [TR010044/APP/2.3] AND THE BOOK OF REFERENCE [TR010044/APP/4.3].

LEGEND

- ORDER LIMITS
- EXCLUSION FROM ORDER LIMITS
- ADMINISTRATIVE BOUNDARY

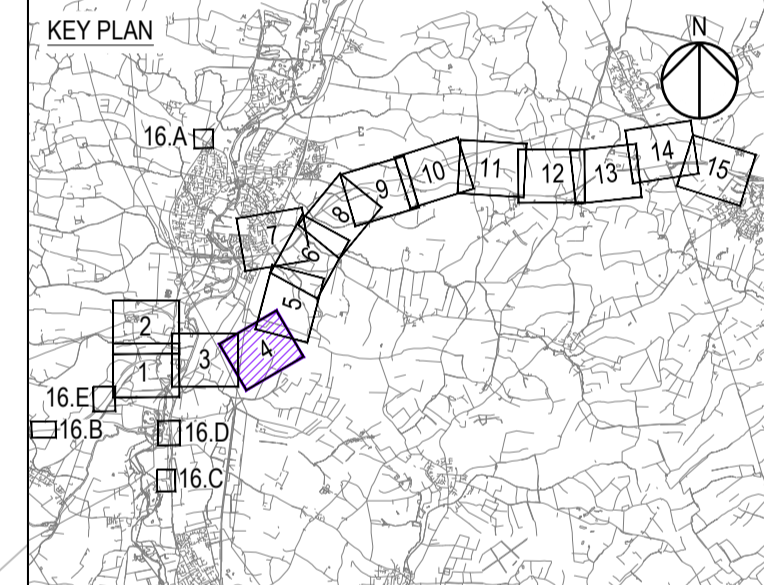

Revision Details		By	Check	Date	Suffix
Final for DCO Examination		GJ	AP	04/11/21	P07

Purpose of issue
DCO Examination

Client
National Highways
Woodlands
Manton Lane
Manton Industrial Estate
Bedford
MK41 7LW

Working on behalf of
national highways

Development Consent Order Number
TR010044

Project Title
A428 BLACK CAT TO CAXTON GIBBET IMPROVEMENTS

Drawing Title
CROWN LAND PLANS REGULATION 5(2)(n) SHEET 4

Designed	Drawn	Checked	Approved	Date
AECOM	GJ	AP	PG	04/11/21

Internal Project No. 60541541
Scale @ A1 1:2500
Scale @ A3 1:5000

Suitability D9
Zone ZN2

THIS DOCUMENT HAS BEEN PREPARED PURSUANT TO AND SUBJECT TO THE TERMS OF AECOM'S APPOINTMENT BY ITS CLIENT. AECOM ACCEPTS NO LIABILITY FOR ANY USE OF THIS DOCUMENT OTHER THAN BY ITS ORIGINAL CLIENT OR FOLLOWING AECOM'S EXPRESS AGREEMENT TO SUCH USE, AND ONLY FOR THE PURPOSES FOR WHICH IT WAS PREPARED AND PROVIDED.

Drawing Number	National Highways PIN	1 Originator	1 Volume	Rev
HE551495	-ARD	-LSI	-	P07

Location: ZN2_SW_Z_ZZ -DR-DC-2114
I Type: 1 Role: 1 Number

NO INFORMATION ON THIS SHEET

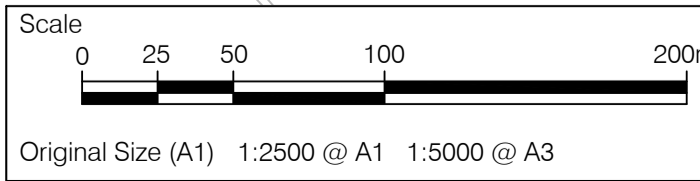

Plot Date: 15 October 2021 10:09:17
 File Name: R:\GIS\TEMP\A2500\A2500_CROWN LAND PLANS_REGULATION_5(2)(n)_SHEET_4.dwg



- NOTES**
1. ALL DIMENSIONS ARE IN METRES UNLESS STATED OTHERWISE.
 2. DO NOT SCALE FROM THIS DRAWING, USE ONLY PRINTED DIMENSIONS.
 3. ALL EASEMENTS, SERVITUDES AND PRIVATE RIGHTS ARE PROPOSED TO BE EXTINGUISHED ON LAND THAT IS TO BE ACQUIRED UNLESS STATED OTHERWISE IN THE BOOK OF REFERENCE.
 4. THIS DRAWING IS TO BE READ IN CONJUNCTION WITH ALL OTHER PLANS AND DOCUMENTATION, IN PARTICULAR THE WORK PLANS [TR010044/APP/2.3] AND THE BOOK OF REFERENCE [TR010044/APP/4.3].

LEGEND

- ORDER LIMITS
- EXCLUSION FROM ORDER LIMITS
- ADMINISTRATIVE BOUNDARY

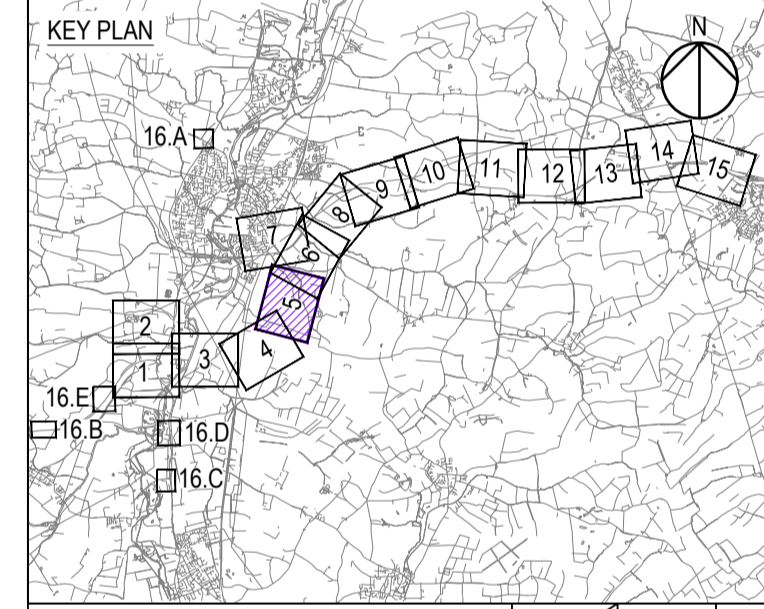

NO INFORMATION ON THIS SHEET

Final for DCO Examination	GJ	AP	04/11/21	P07
Revision Details	By	Check	Date	Suffix

Purpose of issue
DCO Examination

Client
National Highways
Woodlands
Manton Lane
Manton Industrial Estate
Bedford
MK41 7LW

Working on behalf of
national highways

Development Consent Order Number
TR010044

Project Title
A428 BLACK CAT TO CAXTON GIBBET IMPROVEMENTS

Drawing Title
CROWN LAND PLANS REGULATION 5(2)(n) SHEET 5

Designed AECOM	Drawn GJ	Checked AP	Approved PG	Date 04/11/21
Internal Project No. 60541541			Suitability D9	
Scale @ A1 1:2500			Zone ZN2	

THIS DOCUMENT HAS BEEN PREPARED PURSUANT TO AND SUBJECT TO THE TERMS OF AECOM'S APPOINTMENT BY ITS CLIENT. AECOM ACCEPTS NO LIABILITY FOR ANY USE OF THIS DOCUMENT OTHER THAN BY ITS ORIGINAL CLIENT OR FOLLOWING AECOM'S EXPRESS AGREEMENT TO SUCH USE, AND ONLY FOR THE PURPOSES FOR WHICH IT WAS PREPARED AND PROVIDED.

Drawing Number HE551495	National Highways PIN -ARD	1 Originator -LSI	1 Volume -	Rev P07
Location ZN2_SW_Z_ZZ -DR-DC-2115				I Type 1

Plot Date: 15 October 2021 10:42:49
File Name: N:\GIS\TEMP\A428_CROWN_LAND_PLANS_HE13_04112021

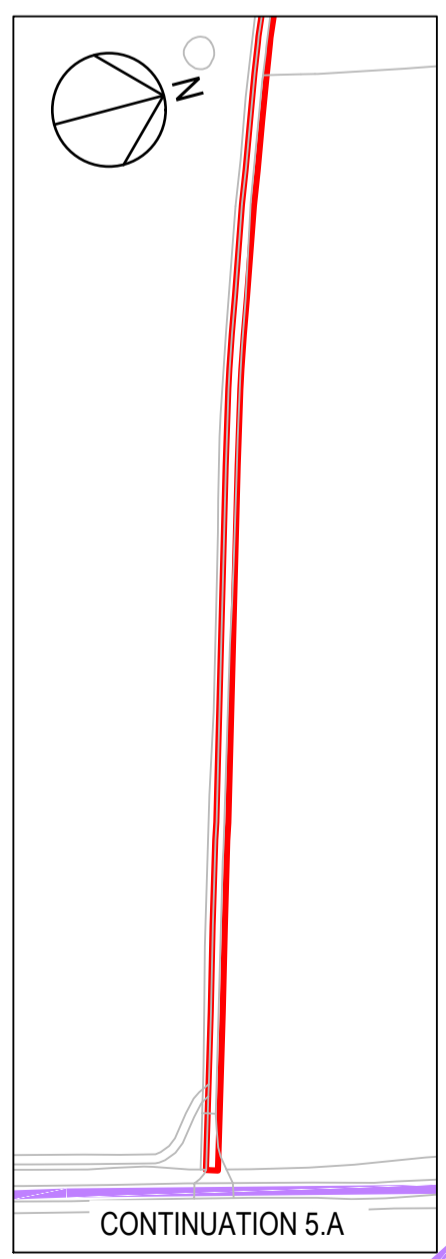
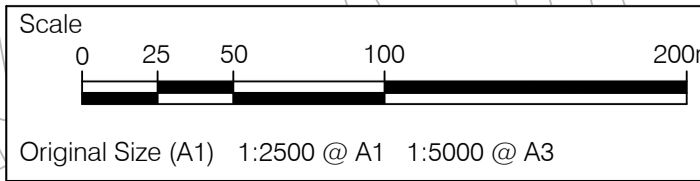

SEE CONTINUATION 5.A

SEE SHEET 4

SEE SHEET 6

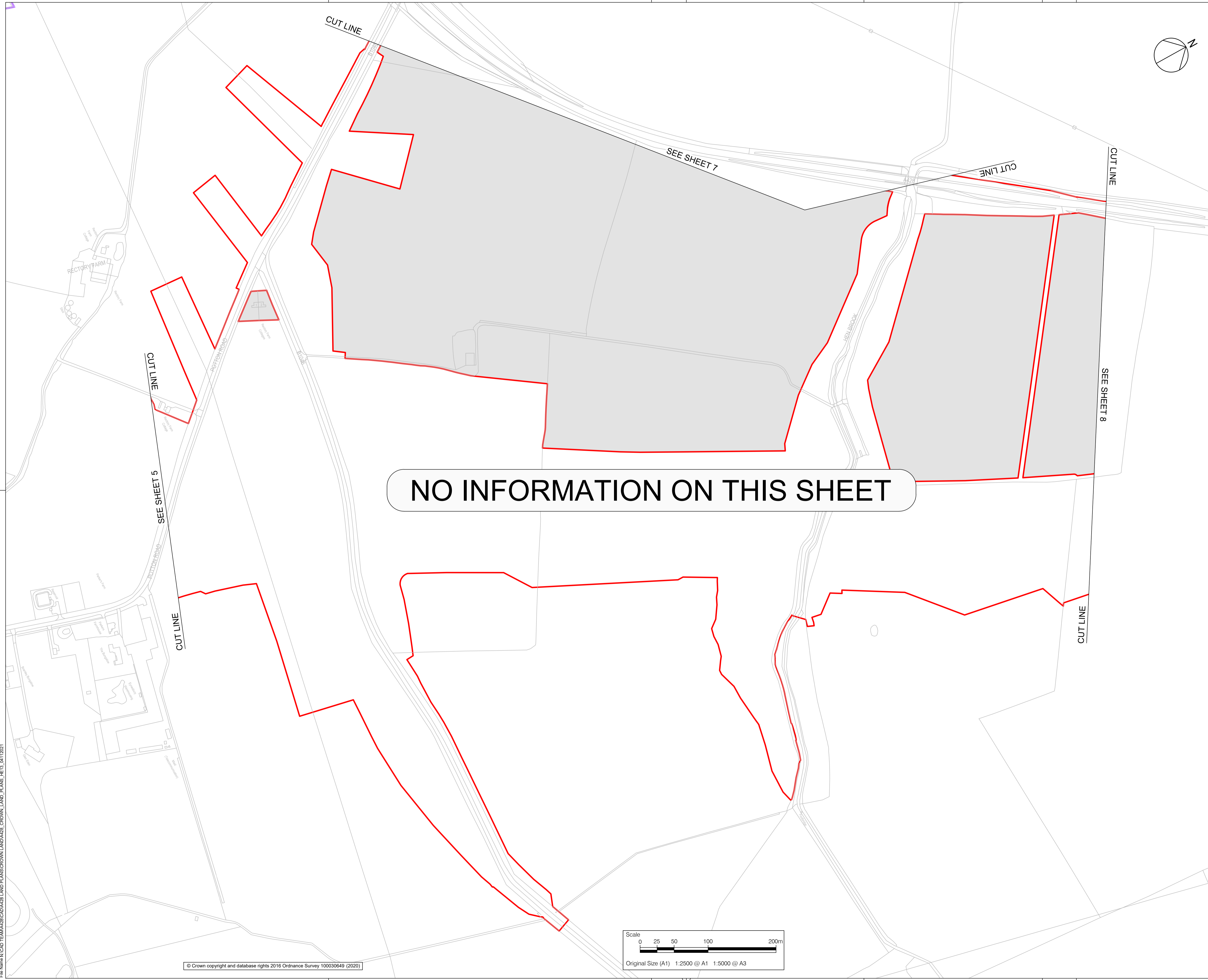

NO INFORMATION ON THIS SHEET

- NOTES**
1. ALL DIMENSIONS ARE IN METRES UNLESS STATED OTHERWISE.
 2. DO NOT SCALE FROM THIS DRAWING, USE ONLY PRINTED DIMENSIONS.
 3. ALL EASEMENTS, SERVITUDES AND PRIVATE RIGHTS ARE PROPOSED TO BE EXTINGUISHED ON LAND THAT IS TO BE ACQUIRED UNLESS STATED OTHERWISE IN THE BOOK OF REFERENCE.
 4. THIS DRAWING IS TO BE READ IN CONJUNCTION WITH ALL OTHER PLANS AND DOCUMENTATION, IN PARTICULAR THE WORK PLANS [TR010044/APP/2.3] AND THE BOOK OF REFERENCE [TR010044/APP/4.3].

LEGEND

- ORDER LIMITS
- EXCLUSION FROM ORDER LIMITS
- ADMINISTRATIVE BOUNDARY

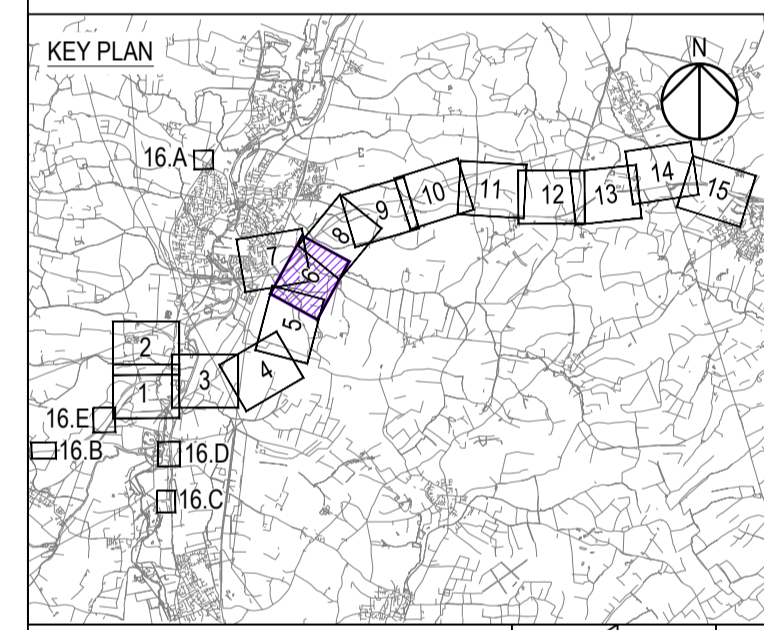

Final for DCO Examination	GJ	AP	04/11/21	P07
Revision Details	By	Check	Date	Suffix

Purpose of issue
DCO Examination

Client
National Highways
Woodlands
Manton Lane
Manton Industrial Estate
Bedford
MK41 7LW

Working on behalf of
national highways

Development Consent Order Number
TR010044

Project Title
A428 BLACK CAT TO CAXTON GIBBET IMPROVEMENTS

Drawing Title
CROWN LAND PLANS REGULATION 5(2)(n) SHEET 6

Designed AECOM	Drawn GJ	Checked AP	Approved PG	Date 04/11/21
Internal Project No. 60541541			Suitability D9	
Scale @ A1 1:2500			Zone ZN2	

THIS DOCUMENT HAS BEEN PREPARED PURSUANT TO AND SUBJECT TO THE TERMS OF AECOM'S APPOINTMENT BY ITS CLIENT. AECOM ACCEPTS NO LIABILITY FOR ANY USE OF THIS DOCUMENT OTHER THAN BY ITS ORIGINAL CLIENT OR FOLLOWING AECOM'S EXPRESS AGREEMENT TO SUCH USE, AND ONLY FOR THE PURPOSES FOR WHICH IT WAS PREPARED AND PROVIDED.

Drawing Number National Highways PIN HE551495	1 Originator -ARD	1 Volume -LSI	Rev P07
Location ZN2_SW_Z_ZZ -DR-DC-2116			1 Type 1 Role 1 Number

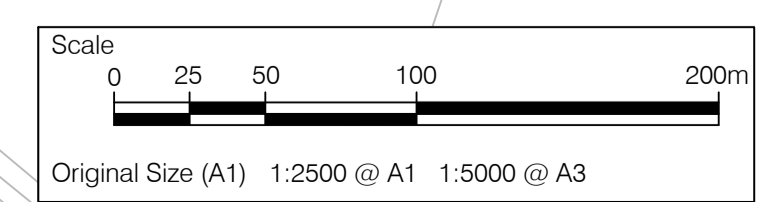

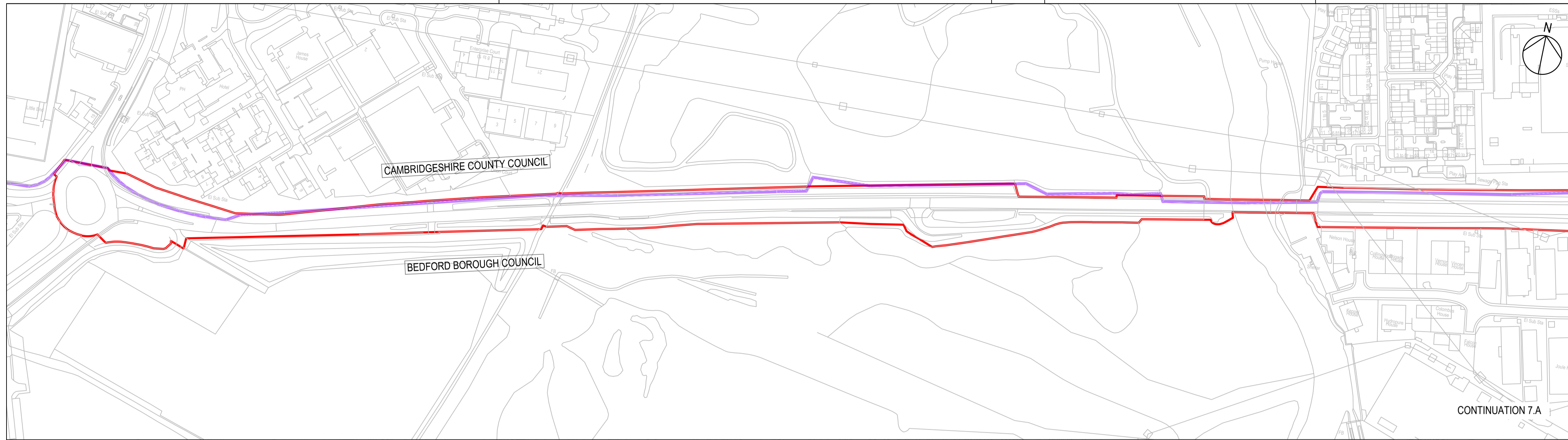

CONTINUATION 7.A

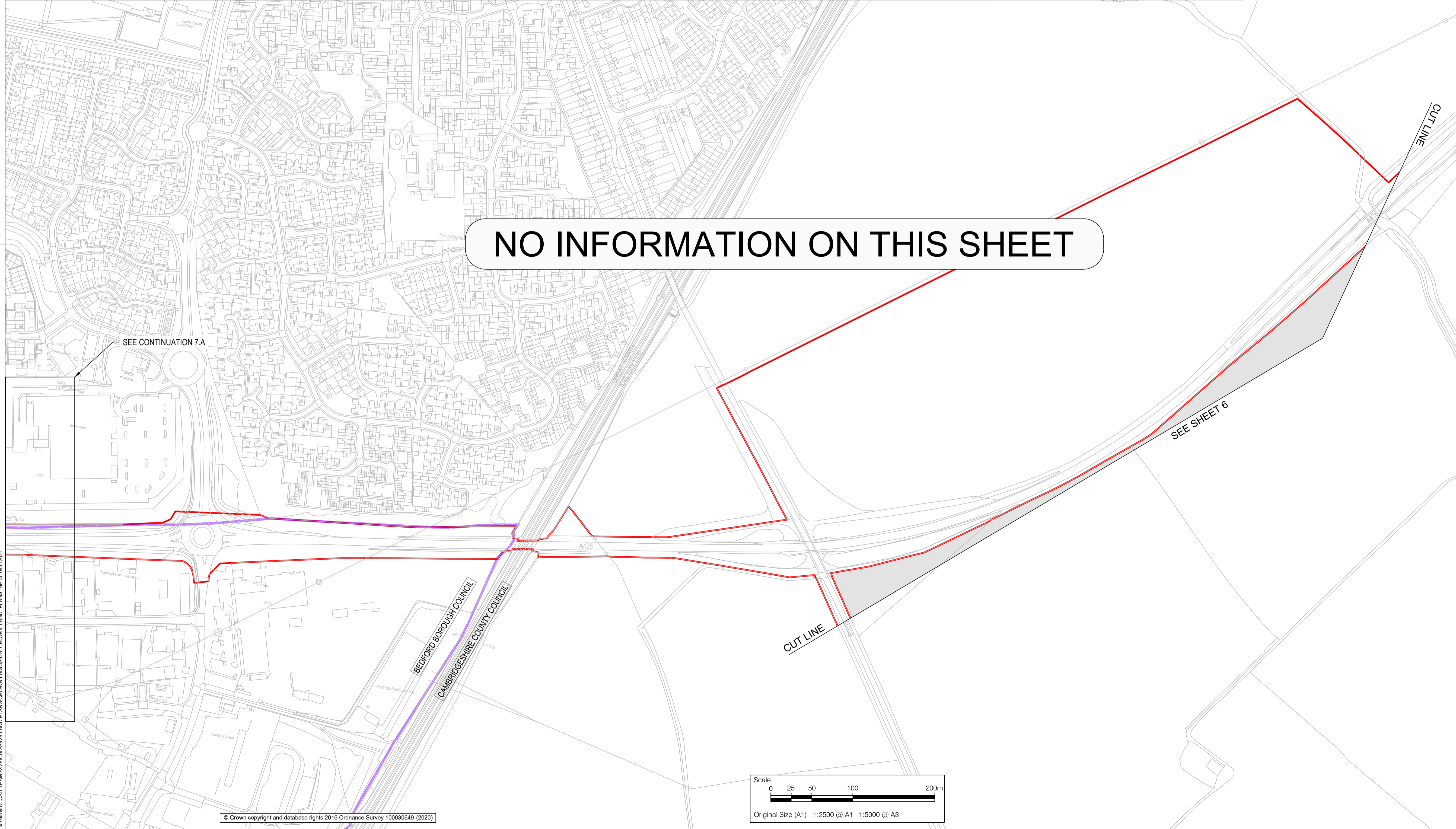

NO INFORMATION ON THIS SHEET

- NOTES
1. ALL DIMENSIONS ARE IN METRES UNLESS STATED OTHERWISE.
 2. DO NOT SCALE FROM THIS DRAWING, USE ONLY PRINTED DIMENSIONS.
 3. ALL EASEMENTS, SERVITUDES AND PRIVATE RIGHTS ARE PROPOSED TO BE EXTINGUISHED ON LAND THAT IS TO BE ACQUIRED UNLESS STATED OTHERWISE IN THE BOOK OF REFERENCE.
 4. THIS DRAWING IS TO BE READ IN CONJUNCTION WITH ALL OTHER PLANS AND DOCUMENTATION, IN PARTICULAR THE WORK PLANS [TR010044/APP/2.3] AND THE BOOK OF REFERENCE [TR010044/APP/4.3].

LEGEND

- ORDER LIMITS
- EXCLUSION FROM ORDER LIMITS
- ADMINISTRATIVE BOUNDARY

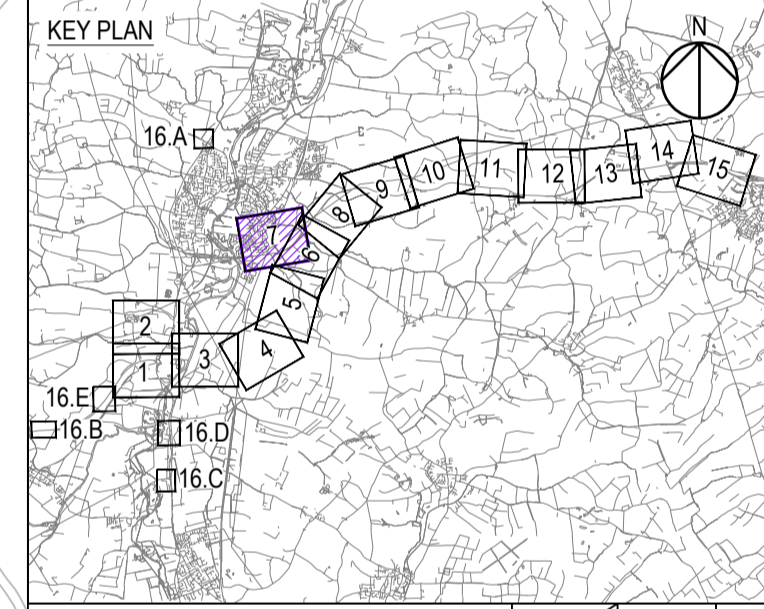

Final for DCO Examination	GJ	AP	04/11/21	P07
Revision Details	By	Check	Date	Suffix

Purpose of issue
DCO Examination

Client
National Highways
Woodlands
Manton Lane
Manton Industrial Estate
Bedford
MK41 7LW



Development Consent Order Number
TR010044

Project Title
A428 BLACK CAT TO CAXTON GIBBET IMPROVEMENTS

Drawing Title
CROWN LAND PLANS REGULATION 5(2)(n) SHEET 7

Designed AECOM	Drawn GJ	Checked AP	Approved PG	Date 04/11/21
Internal Project No. 60541541			Suitability D9	
Scale @ A1 1:2500			Zone ZN2	

THIS DOCUMENT HAS BEEN PREPARED PURSUANT TO AND SUBJECT TO THE TERMS OF AECOM'S APPOINTMENT BY ITS CLIENT. AECOM ACCEPTS NO LIABILITY FOR ANY USE OF THIS DOCUMENT OTHER THAN BY ITS ORIGINAL CLIENT OR FOLLOWING AECOM'S EXPRESS AGREEMENT TO SUCH USE, AND ONLY FOR THE PURPOSES FOR WHICH IT WAS PREPARED AND PROVIDED.

Drawing Number HE551495	National Highways PIN -ARD	1 Originator -LSI	1 Volume -	Rev P07
Location ZN2_SW_Z_ZZ -DR-DC-2117				1 Type 1 Role 1 Number

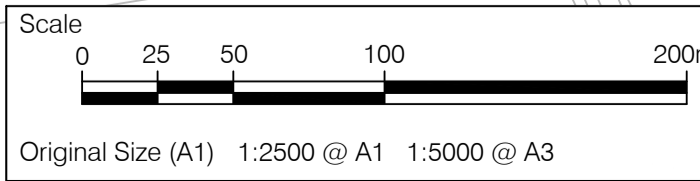

- NOTES**
1. ALL DIMENSIONS ARE IN METRES UNLESS STATED OTHERWISE.
 2. DO NOT SCALE FROM THIS DRAWING, USE ONLY PRINTED DIMENSIONS.
 3. ALL EASEMENTS, SERVITUDES AND PRIVATE RIGHTS ARE PROPOSED TO BE EXTINGUISHED ON LAND THAT IS TO BE ACQUIRED UNLESS STATED OTHERWISE IN THE BOOK OF REFERENCE.
 4. THIS DRAWING IS TO BE READ IN CONJUNCTION WITH ALL OTHER PLANS AND DOCUMENTATION, IN PARTICULAR THE WORK PLANS [TR010044/APP/2.3] AND THE BOOK OF REFERENCE [TR010044/APP/4.3].

LEGEND

- ORDER LIMITS
- EXCLUSION FROM ORDER LIMITS
- ADMINISTRATIVE BOUNDARY

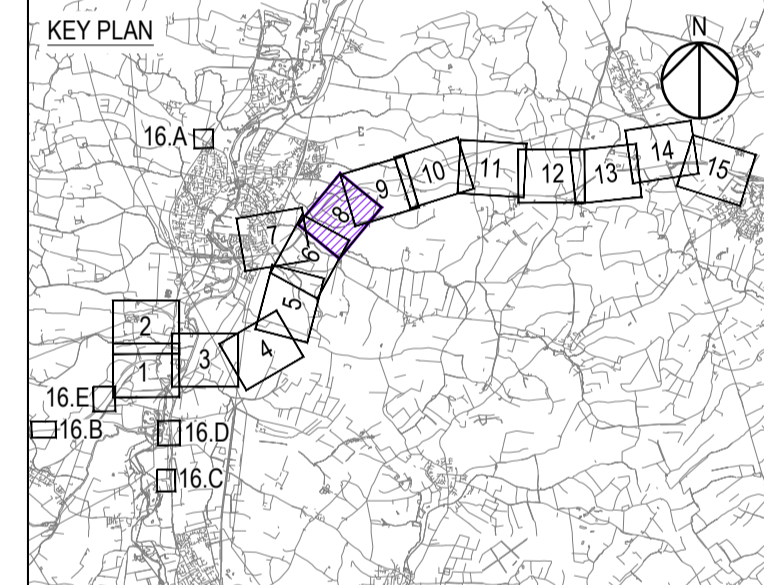

Final for DCO Examination	GJ	AP	04/11/21	P07
Revision Details	By	Check	Date	Suffix

Purpose of issue
DCO Examination

Client
National Highways
Woodlands
Manton Lane
Manton Industrial Estate
Bedford
MK41 7LW

Working on behalf of
national highways

Development Consent Order Number
TR010044

Project Title
A428 BLACK CAT TO CAXTON GIBBET IMPROVEMENTS

Drawing Title
CROWN LAND PLANS REGULATION 5(2)(n) SHEET 8

Designed AECOM	Drawn GJ	Checked AP	Approved PG	Date 04/11/21
Internal Project No. 60541541			Suitability D9	
Scale @ A1 1:2500			Zone ZN3	

THIS DOCUMENT HAS BEEN PREPARED PURSUANT TO AND SUBJECT TO THE TERMS OF AECOM'S APPOINTMENT BY ITS CLIENT. AECOM ACCEPTS NO LIABILITY FOR ANY USE OF THIS DOCUMENT OTHER THAN BY ITS ORIGINAL CLIENT OR FOLLOWING AECOM'S EXPRESS AGREEMENT TO SUCH USE, AND ONLY FOR THE PURPOSES FOR WHICH IT WAS PREPARED AND PROVIDED.

Drawing Number HE551495	National Highways PIN -ARD	1 Originator -LSI	1 Volume -	Rev P07
Location ZN3_SW_Z_ZZ -DR-DC-2118				1 Type -

NO INFORMATION ON THIS SHEET

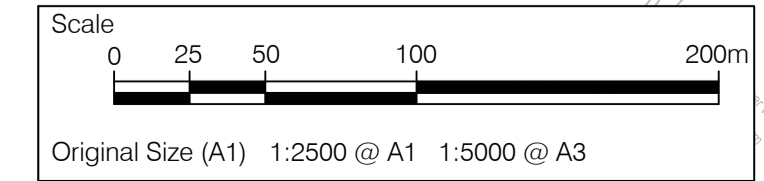

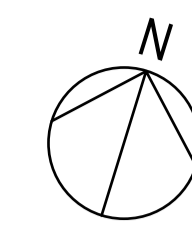



NOTES

1. ALL DIMENSIONS ARE IN METRES UNLESS STATED OTHERWISE.
2. DO NOT SCALE FROM THIS DRAWING, USE ONLY PRINTED DIMENSIONS.
3. ALL EASEMENTS, SERVITUDES AND PRIVATE RIGHTS ARE PROPOSED TO BE EXTINGUISHED ON LAND THAT IS TO BE ACQUIRED UNLESS STATED OTHERWISE IN THE BOOK OF REFERENCE.
4. THIS DRAWING IS TO BE READ IN CONJUNCTION WITH ALL OTHER PLANS AND DOCUMENTATION, IN PARTICULAR THE WORK PLANS [TR010044/APP/2.3] AND THE BOOK OF REFERENCE [TR010044/APP/4.3].

LEGEND

-  ORDER LIMITS
-  EXCLUSION FROM ORDER LIMITS
-  ADMINISTRATIVE BOUNDARY

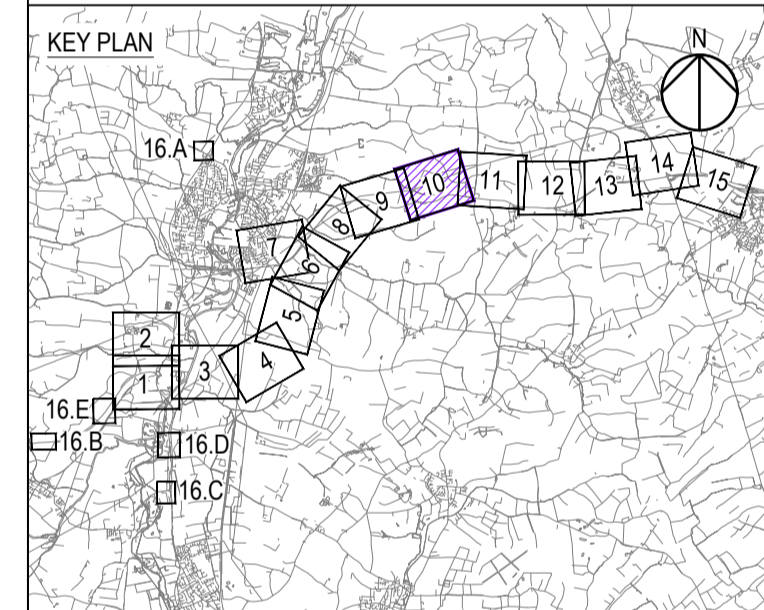

NO INFORMATION ON THIS SHEET

Final for DCO Examination	GJ	04/11/21	P07
Revision Details	By	Date	Suffix
	Check		

Purpose of issue
DCO Examination

Client
National Highways
Woodlands
Manton Lane
Manton Industrial Estate
Bedford
MK41 7LW

Working on behalf of

Development Consent Order Number
TR010044

Project Title
A428 BLACK CAT TO CAXTON GIBBET IMPROVEMENTS

Drawing Title
CROWN LAND PLANS REGULATION 5(2)(n) SHEET 10

Designed AECOM	Drawn GJ	Checked AP	Approved PG	Date 04/11/21
Internal Project No. 60541541	Suitability D9		Zone ZN3	
Scale @ A1 1:2500				

THIS DOCUMENT HAS BEEN PREPARED PURSUANT TO AND SUBJECT TO THE TERMS OF AECOM'S APPOINTMENT BY ITS CLIENT. AECOM ACCEPTS NO LIABILITY FOR ANY USE OF THIS DOCUMENT OTHER THAN BY ITS ORIGINAL CLIENT OR FOLLOWING AECOM'S EXPRESS AGREEMENT TO SUCH USE, AND ONLY FOR THE PURPOSES FOR WHICH IT WAS PREPARED AND PROVIDED.

Drawing Number National Highways PIN HE551495	1 Originator -ARD	1 Volume -LSI	Rev P07
Location ZN3_SW_Z_ZZ -DR-DC-2120			
I Type 1			I Number 1

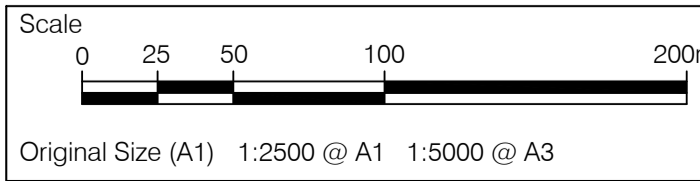

Proj. Cdn: 15 October 2021 15:05:19
File Name: N:\GIS\TEMP\A428\A428_LAND_PLANS\CROWN_LAND_PLANS_HE13_04112021

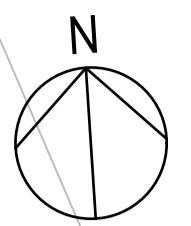
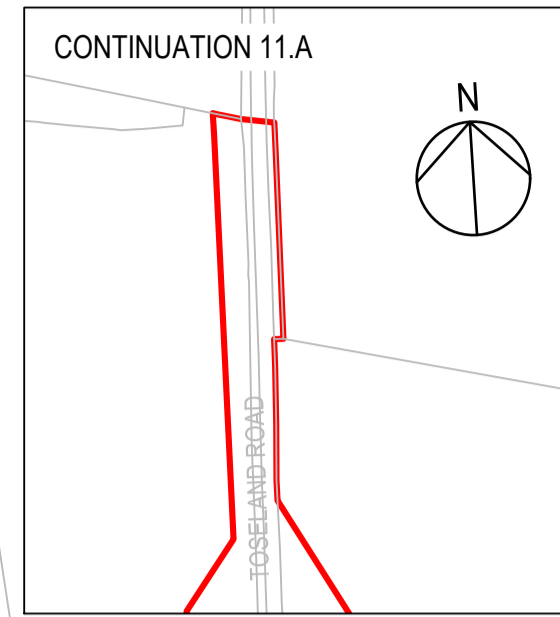

- NOTES**
1. ALL DIMENSIONS ARE IN METRES UNLESS STATED OTHERWISE.
 2. DO NOT SCALE FROM THIS DRAWING, USE ONLY PRINTED DIMENSIONS.
 3. ALL EASEMENTS, SERVITUDES AND PRIVATE RIGHTS ARE PROPOSED TO BE EXTINGUISHED ON LAND THAT IS TO BE ACQUIRED UNLESS STATED OTHERWISE IN THE BOOK OF REFERENCE.
 4. THIS DRAWING IS TO BE READ IN CONJUNCTION WITH ALL OTHER PLANS AND DOCUMENTATION, IN PARTICULAR THE WORK PLANS [TR010044/APP/2.3] AND THE BOOK OF REFERENCE [TR010044/APP/4.3].

- LEGEND**
- ORDER LIMITS
 - EXCLUSION FROM ORDER LIMITS
 - ADMINISTRATIVE BOUNDARY

NO INFORMATION ON THIS SHEET

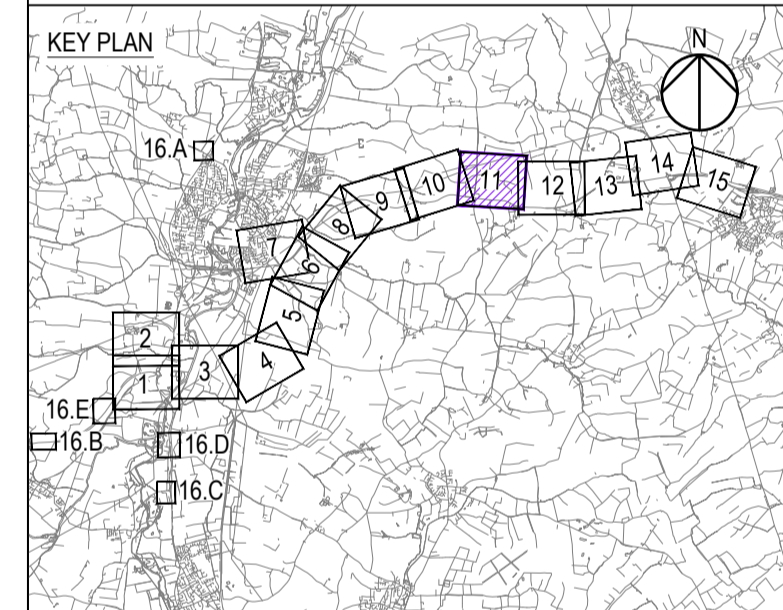

Final for DCO Examination	GJ	AP	04/11/21	P07
Revision Details	By	Check	Date	Suffix

Purpose of issue
DCO Examination

Client
National Highways
Woodlands
Manton Lane
Manton Industrial Estate
Bedford
MK41 7LW

Development Consent Order Number
TR010044

Project Title
A428 BLACK CAT TO CAXTON GIBBET IMPROVEMENTS

Drawing Title
CROWN LAND PLANS REGULATION 5(2)(n) SHEET 11

Designed AECOM	Drawn GJ	Checked AP	Approved PG	Date 04/11/21
Internal Project No. 60541541	Suitability D9		Zone ZN4	
Scale @ A1 1:2500				

THIS DOCUMENT HAS BEEN PREPARED PURSUANT TO AND SUBJECT TO THE TERMS OF AECOM'S APPOINTMENT BY ITS CLIENT. AECOM ACCEPTS NO LIABILITY FOR ANY USE OF THIS DOCUMENT OTHER THAN BY ITS ORIGINAL CLIENT OR FOLLOWING AECOM'S EXPRESS AGREEMENT TO SUCH USE, AND ONLY FOR THE PURPOSES FOR WHICH IT WAS PREPARED AND PROVIDED.

Drawing Number National Highways PIN HE551495	1 Originator -ARD	1 Volume -LSI	Rev P07
Location ZN4_SW_Z_ZZ -DR-DC-2121			
I Type 1 Role 1 Number			

File Name: C:\GIS\Projects\2021\2021_04_11\2021_04_11_12021_LAND PLANS\CROWN LAND PLANS\CROWN LAND PLANS_HE13_04_11_2021

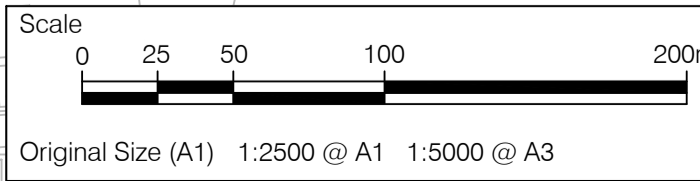

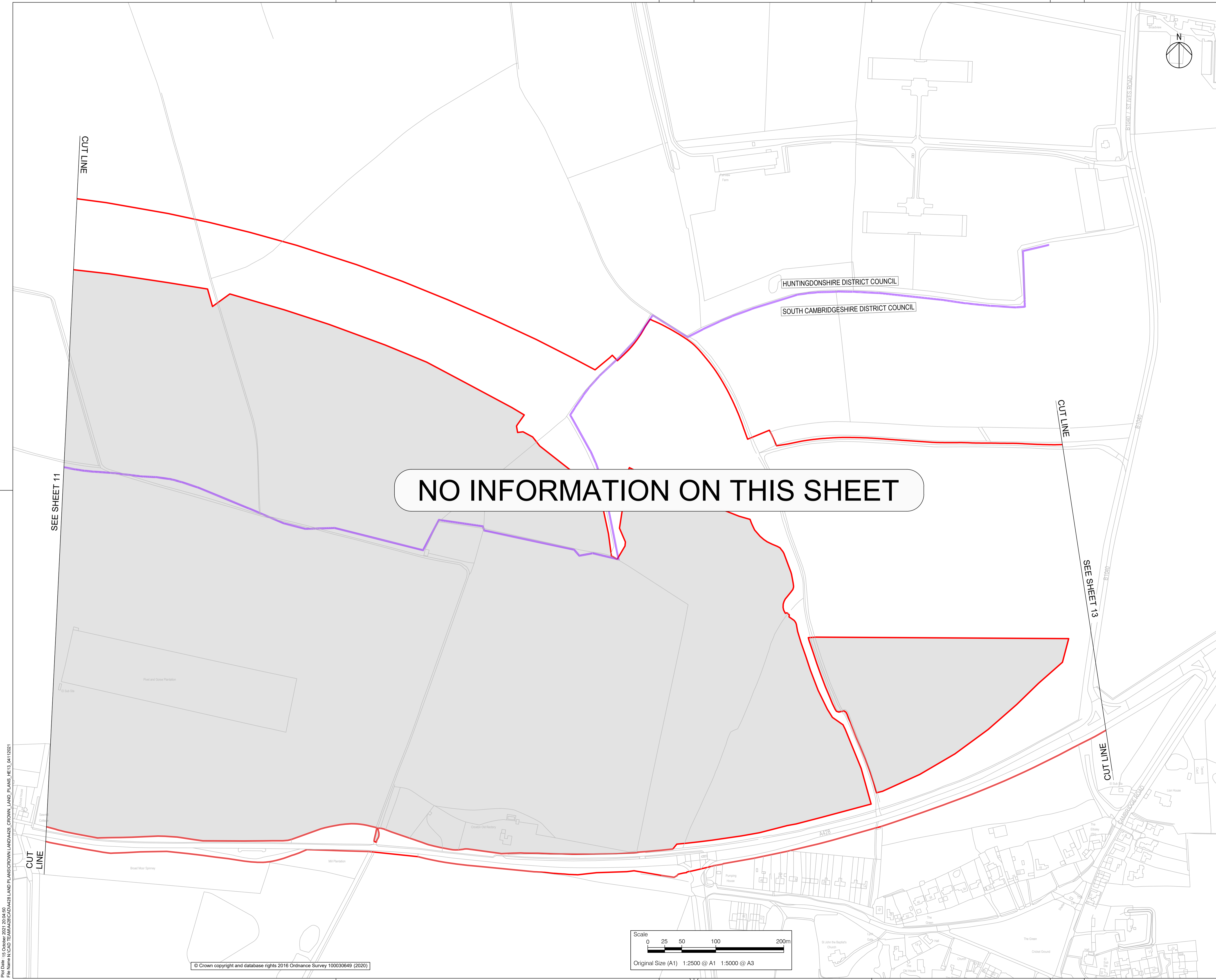

NO INFORMATION ON THIS SHEET

- NOTES**
1. ALL DIMENSIONS ARE IN METRES UNLESS STATED OTHERWISE.
 2. DO NOT SCALE FROM THIS DRAWING, USE ONLY PRINTED DIMENSIONS.
 3. ALL EASEMENTS, SERVITUDES AND PRIVATE RIGHTS ARE PROPOSED TO BE EXTINGUISHED ON LAND THAT IS TO BE ACQUIRED UNLESS STATED OTHERWISE IN THE BOOK OF REFERENCE.
 4. THIS DRAWING IS TO BE READ IN CONJUNCTION WITH ALL OTHER PLANS AND DOCUMENTATION, IN PARTICULAR THE WORK PLANS [TR010044/APP/2.3] AND THE BOOK OF REFERENCE [TR010044/APP/4.3].

LEGEND

- ORDER LIMITS
- EXCLUSION FROM ORDER LIMITS
- ADMINISTRATIVE BOUNDARY

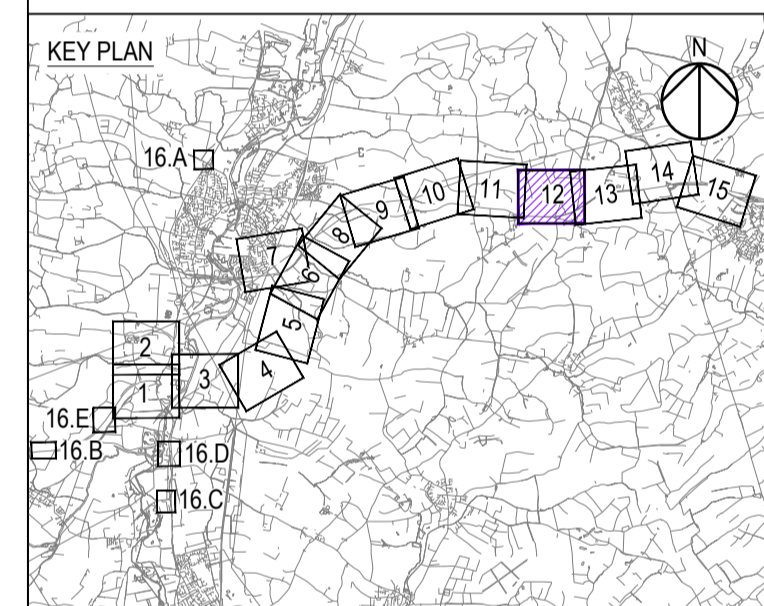

Final for DCO Examination	GJ	AP	04/11/21	P07
Revision Details	By	Check	Date	Suffix

Purpose of issue
DCO Examination

Client
National Highways
Woodlands
Marlton Lane
Marlton Industrial Estate
Bedford
MK41 7LW

Development Consent Order Number
TR010044

Project Title
A428 BLACK CAT TO CAXTON GIBBET IMPROVEMENTS

Drawing Title
CROWN LAND PLANS REGULATION 5(2)(n) SHEET 12

Designed AECOM	Drawn GJ	Checked AP	Approved PG	Date 04/11/21
Internal Project No. 60541541	Suitability D9		Zone ZN4	

THIS DOCUMENT HAS BEEN PREPARED PURSUANT TO AND SUBJECT TO THE TERMS OF AECOM'S APPOINTMENT BY ITS CLIENT. AECOM ACCEPTS NO LIABILITY FOR ANY USE OF THIS DOCUMENT OTHER THAN BY ITS ORIGINAL CLIENT OR FOLLOWING AECOM'S EXPRESS AGREEMENT TO SUCH USE, AND ONLY FOR THE PURPOSES FOR WHICH IT WAS PREPARED AND PROVIDED.

Drawing Number National Highways PIN HE551495	1 Originator -ARD	1 Volume -LSI	Rev P07
Location ZN4_SW_Z_ZZ -DR-DC-2122			1 Type 1 Role 1 Number

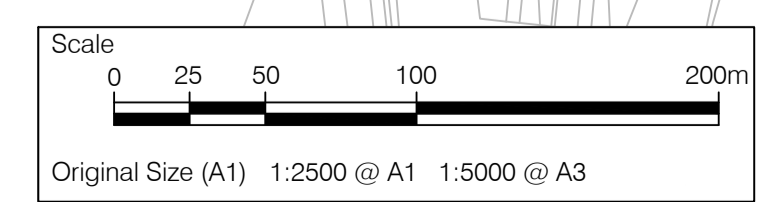



File Name: R:\GIS\TEMP\2021\20210413\20210413_04112021_CROWN LAND PLANS REGULATION 5(2)(n)_A428_BLACK_CAT_TO_CAXTON_GIBBET_IMPROVEMENTS.dwg
 Plot Date: 15 October 2021 20:04:00
 File Name: R:\GIS\TEMP\2021\20210413\20210413_04112021_CROWN LAND PLANS REGULATION 5(2)(n)_A428_BLACK_CAT_TO_CAXTON_GIBBET_IMPROVEMENTS.dwg

NOTES

- 1. ALL DIMENSIONS ARE IN METRES UNLESS STATED OTHERWISE.
- 2. DO NOT SCALE FROM THIS DRAWING, USE ONLY PRINTED DIMENSIONS.
- 3. ALL EASEMENTS, SERVITUDES AND PRIVATE RIGHTS ARE PROPOSED TO BE EXTINGUISHED ON LAND THAT IS TO BE ACQUIRED UNLESS STATED OTHERWISE IN THE BOOK OF REFERENCE.
- 4. THIS DRAWING IS TO BE READ IN CONJUNCTION WITH ALL OTHER PLANS AND DOCUMENTATION, IN PARTICULAR THE WORK PLANS [TR010044/APP/2.3] AND THE BOOK OF REFERENCE [TR010044/APP/4.3].

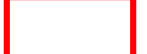
LEGEND

-  ORDER LIMITS
-  EXCLUSION FROM ORDER LIMITS
-  ADMINISTRATIVE BOUNDARY

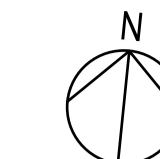

NO INFORMATION ON THIS SHEET

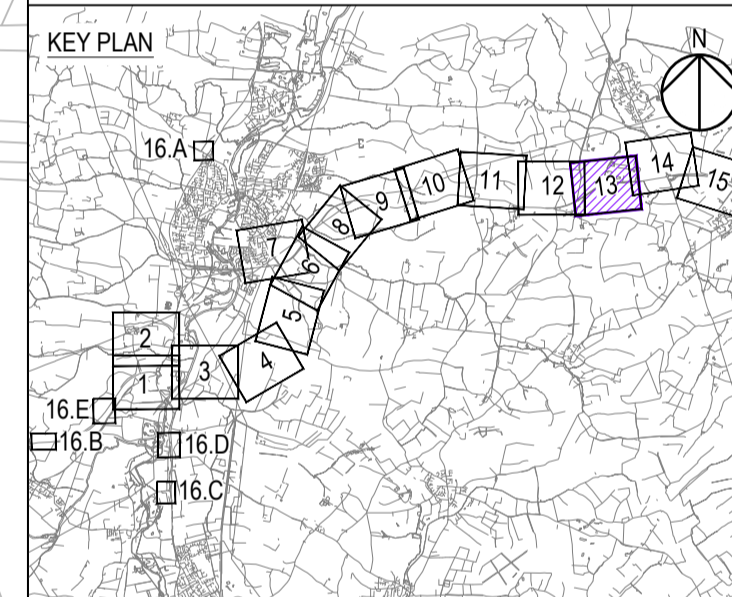

Final for DCO Examination	GJ	AP	04/11/21	P07
Revision Details	By	Check	Date	Suffix

Purpose of issue
DCO Examination

Client
National Highways
Woodlands
Manton Lane
Manton Industrial Estate
Bedford
MK41 7LW

Working on behalf of

Development Consent Order Number
TR010044

Project Title
A428 BLACK CAT TO CAXTON GIBBET IMPROVEMENTS

Drawing Title
CROWN LAND PLANS REGULATION 5(2)(n) SHEET 13

Designed AECOM	Drawn GJ	Checked AP	Approved PG	Date 04/11/21
Internal Project No. 60541541	Suitability D9		Zone ZN4	
Scale @ A1 1:2500				

THIS DOCUMENT HAS BEEN PREPARED PURSUANT TO AND SUBJECT TO THE TERMS OF AECOM'S APPOINTMENT BY ITS CLIENT. AECOM ACCEPTS NO LIABILITY FOR ANY USE OF THIS DOCUMENT OTHER THAN BY ITS ORIGINAL CLIENT OR FOLLOWING AECOM'S EXPRESS AGREEMENT TO SUCH USE, AND ONLY FOR THE PURPOSES FOR WHICH IT WAS PREPARED AND PROVIDED.

Drawing Number HE551495	Drawn ARD	Checked -LSI-	Approved -P07
Location ZN4_SW_Z_ZZ	I Type -DR-DC-2123	I Role 1	I Number 1

Plot Date: 15 October 2021 20:07:35
File Name: TR010044/APP/2.3/128_LAND PLANS/CROWN LAND/PLANS/CROWN LAND/A428_CROWN LAND_PLANS_HE13_04112021

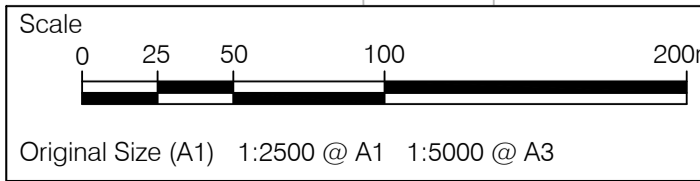

NOTES

1. ALL DIMENSIONS ARE IN METRES UNLESS STATED OTHERWISE.
2. DO NOT SCALE FROM THIS DRAWING, USE ONLY PRINTED DIMENSIONS.
3. ALL EASEMENTS, SERVITUDES AND PRIVATE RIGHTS ARE PROPOSED TO BE EXTINGUISHED ON LAND THAT IS TO BE ACQUIRED UNLESS STATED OTHERWISE IN THE BOOK OF REFERENCE.
4. THIS DRAWING IS TO BE READ IN CONJUNCTION WITH ALL OTHER PLANS AND DOCUMENTATION, IN PARTICULAR THE WORK PLANS [TR010044/APP/2.3] AND THE BOOK OF REFERENCE [TR010044/APP/4.3].

LEGEND

- ORDER LIMITS
- EXCLUSION FROM ORDER LIMITS
- ADMINISTRATIVE BOUNDARY

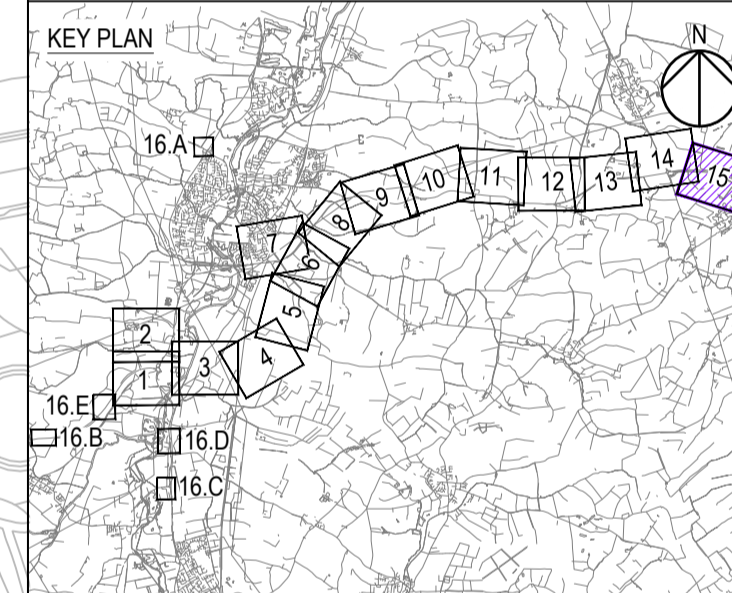

Final for DCO Examination	GJ	AP	04/11/21	P07
Revision Details	By	Check	Date	Suffix

Purpose of issue
DCO Examination

Client
National Highways
Woodlands
Manton Lane
Manton Industrial Estate
Bedford
MK41 7LW



Development Consent Order Number
TR010044

Project Title
A428 BLACK CAT TO CAXTON GIBBET IMPROVEMENTS

Drawing Title
CROWN LAND PLANS REGULATION 5(2)(n) SHEET 15

Designed AECOM	Drawn GJ	Checked AP	Approved PG	Date 04/11/21
Internal Project No. 60541541	Suitability D9		Zone ZN5	
Scale @ A1 1:2500				

THIS DOCUMENT HAS BEEN PREPARED PURSUANT TO AND SUBJECT TO THE TERMS OF AECOM'S APPOINTMENT BY ITS CLIENT. AECOM ACCEPTS NO LIABILITY FOR ANY USE OF THIS DOCUMENT OTHER THAN BY ITS ORIGINAL CLIENT OR FOLLOWING AECOM'S EXPRESS AGREEMENT TO SUCH USE, AND ONLY FOR THE PURPOSES FOR WHICH IT WAS PREPARED AND PROVIDED.

Drawing Number National Highways PIN HE551495	1 Originator -ARD	1 Volume -LSI	Rev P07
Location ZN5_SW_Z_ZZ -DR-DC-2125			
Location I Type 1 Role 1 Number			

NO INFORMATION ON THIS SHEET

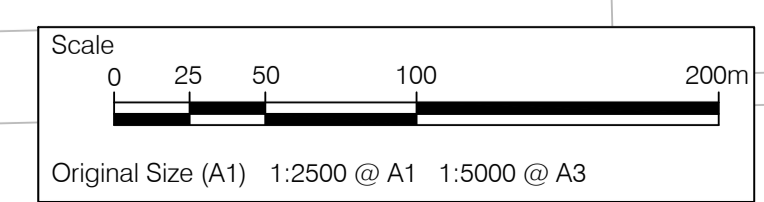

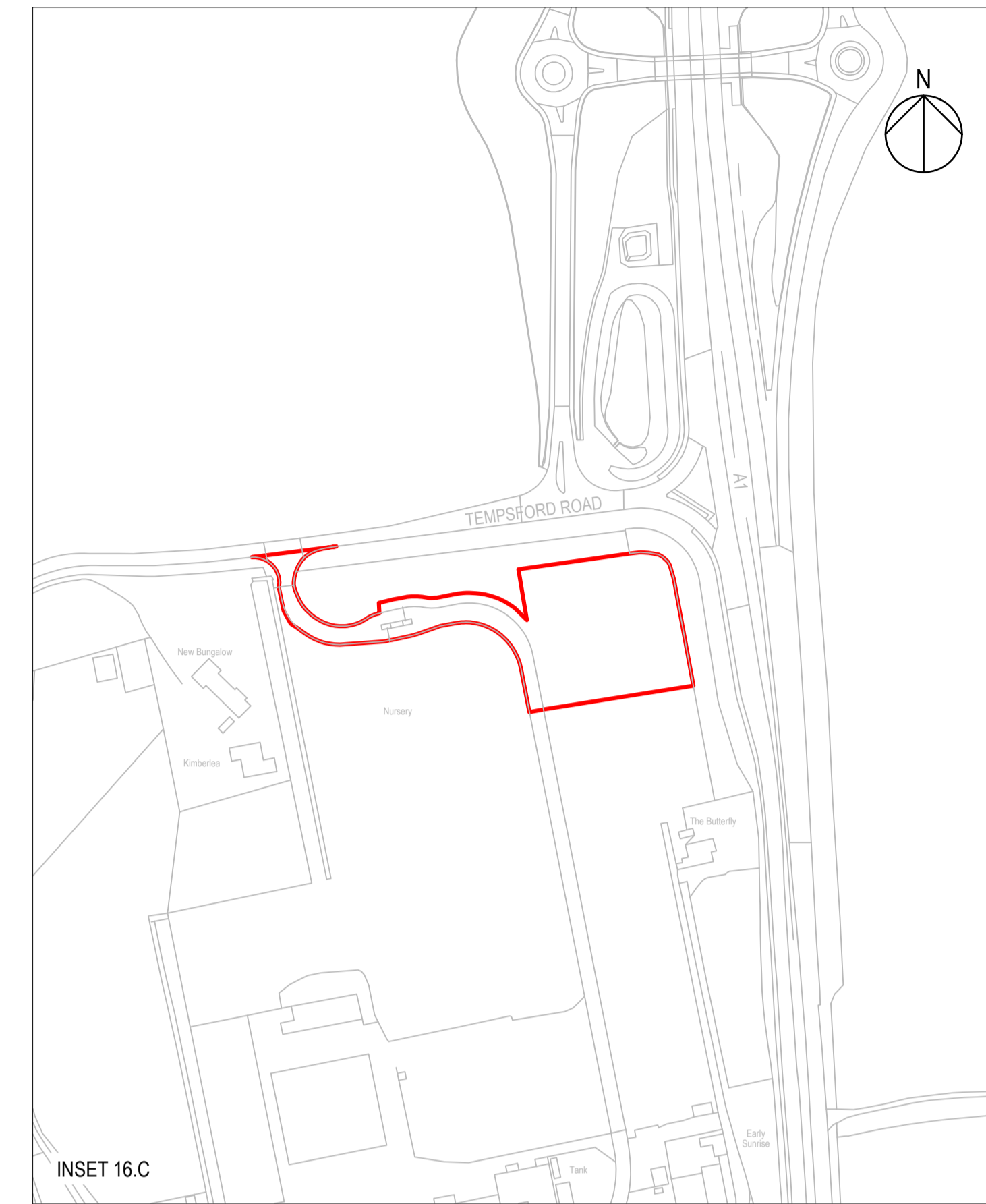
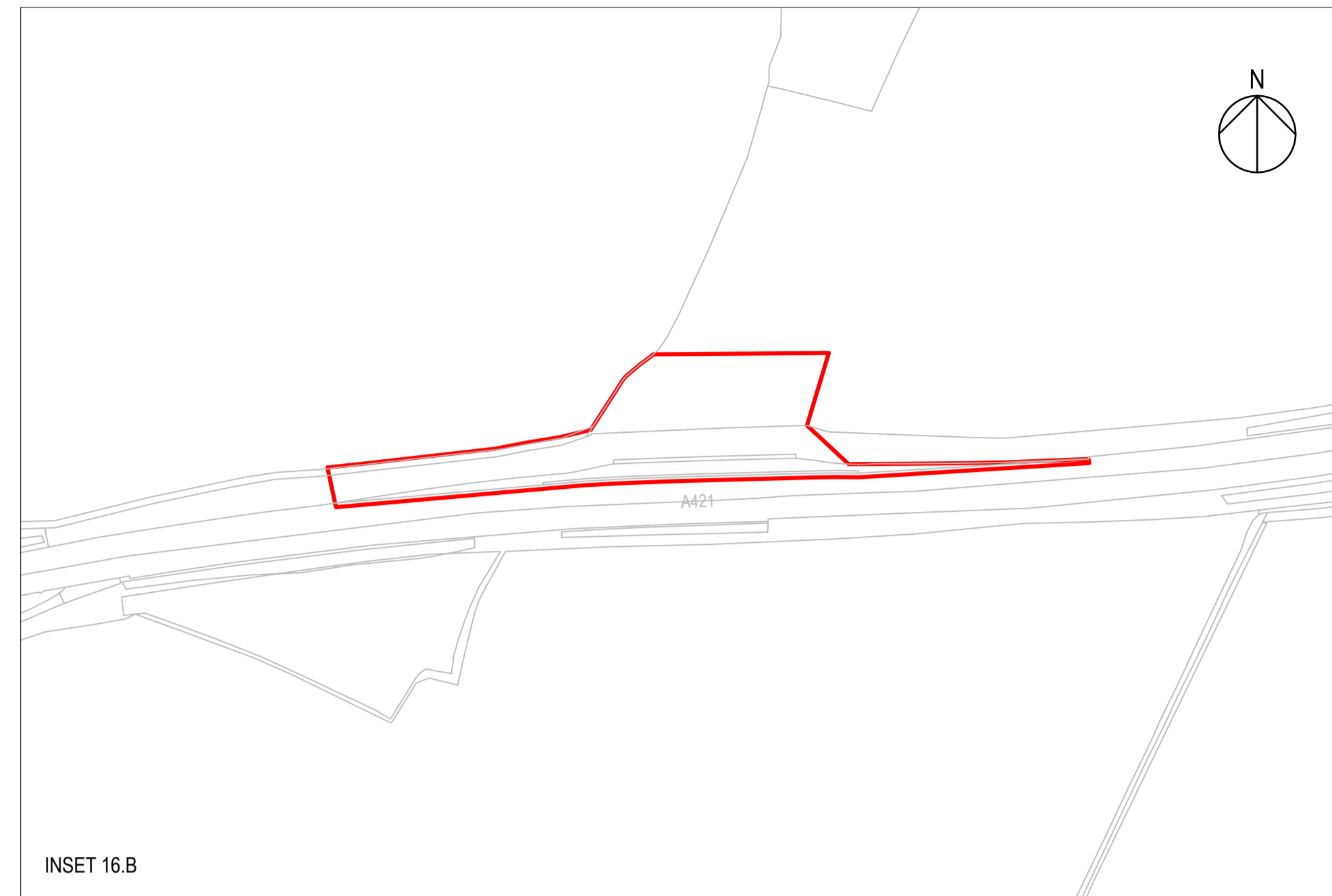
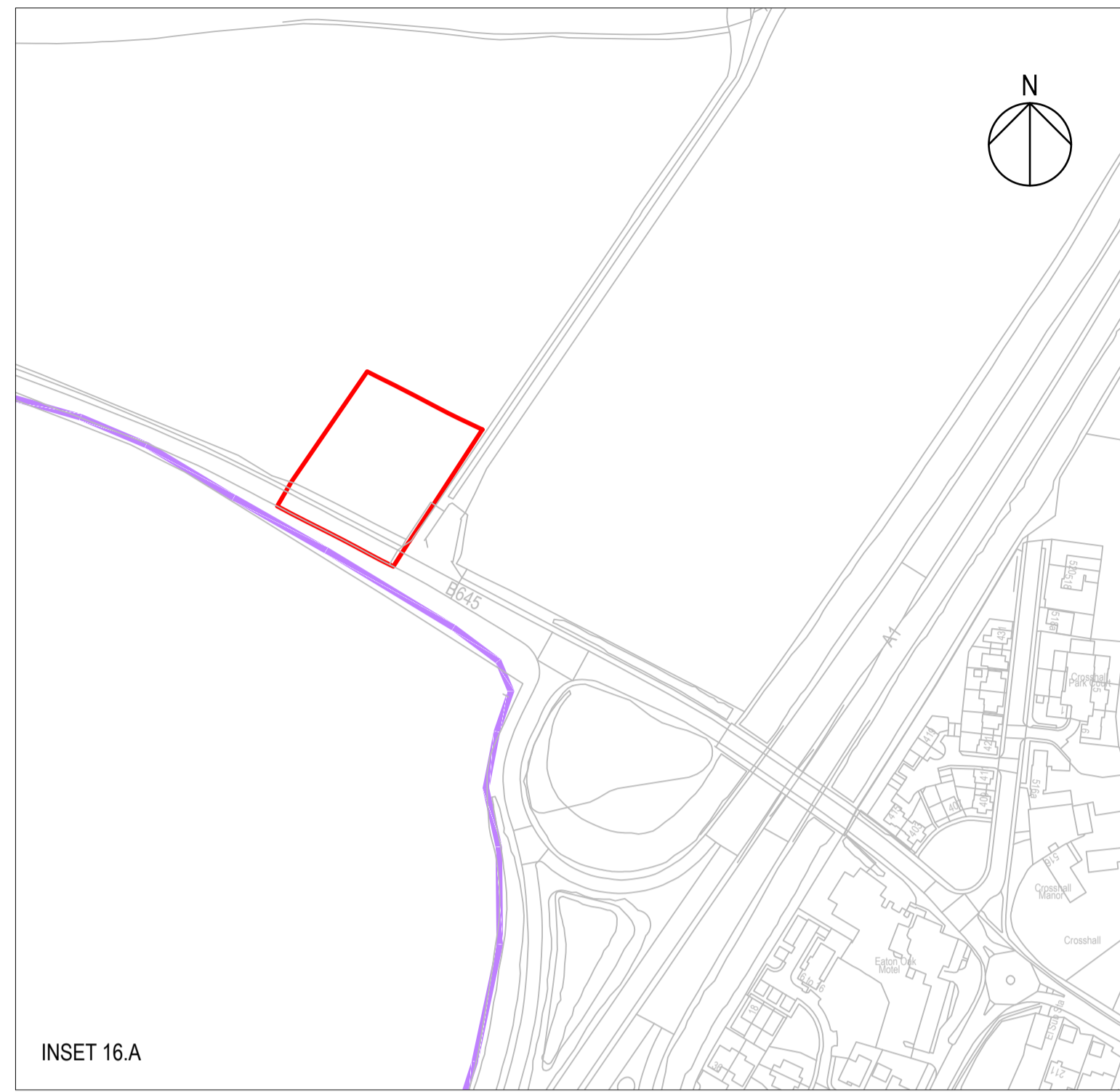

NO INFORMATION ON THIS SHEET

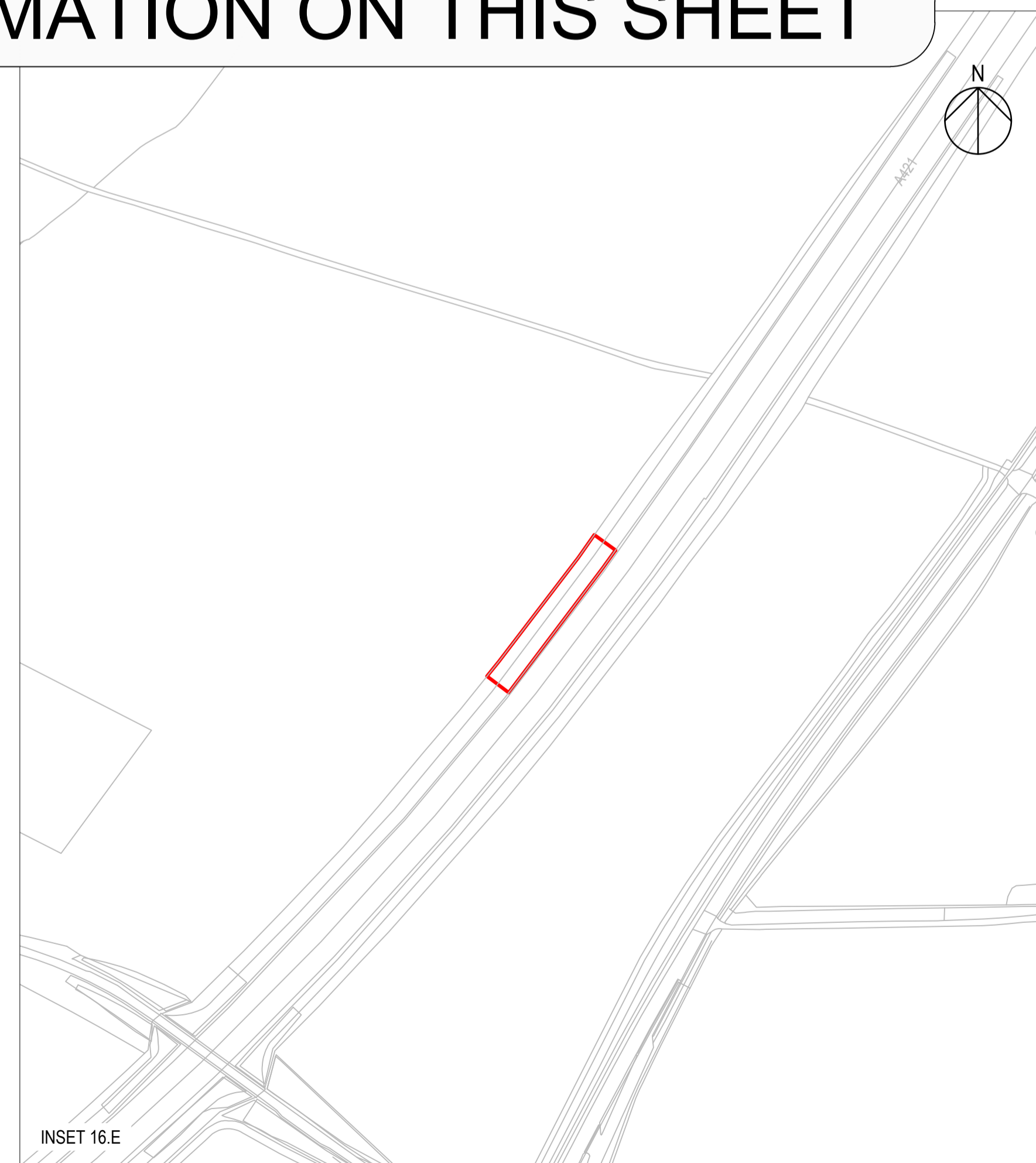
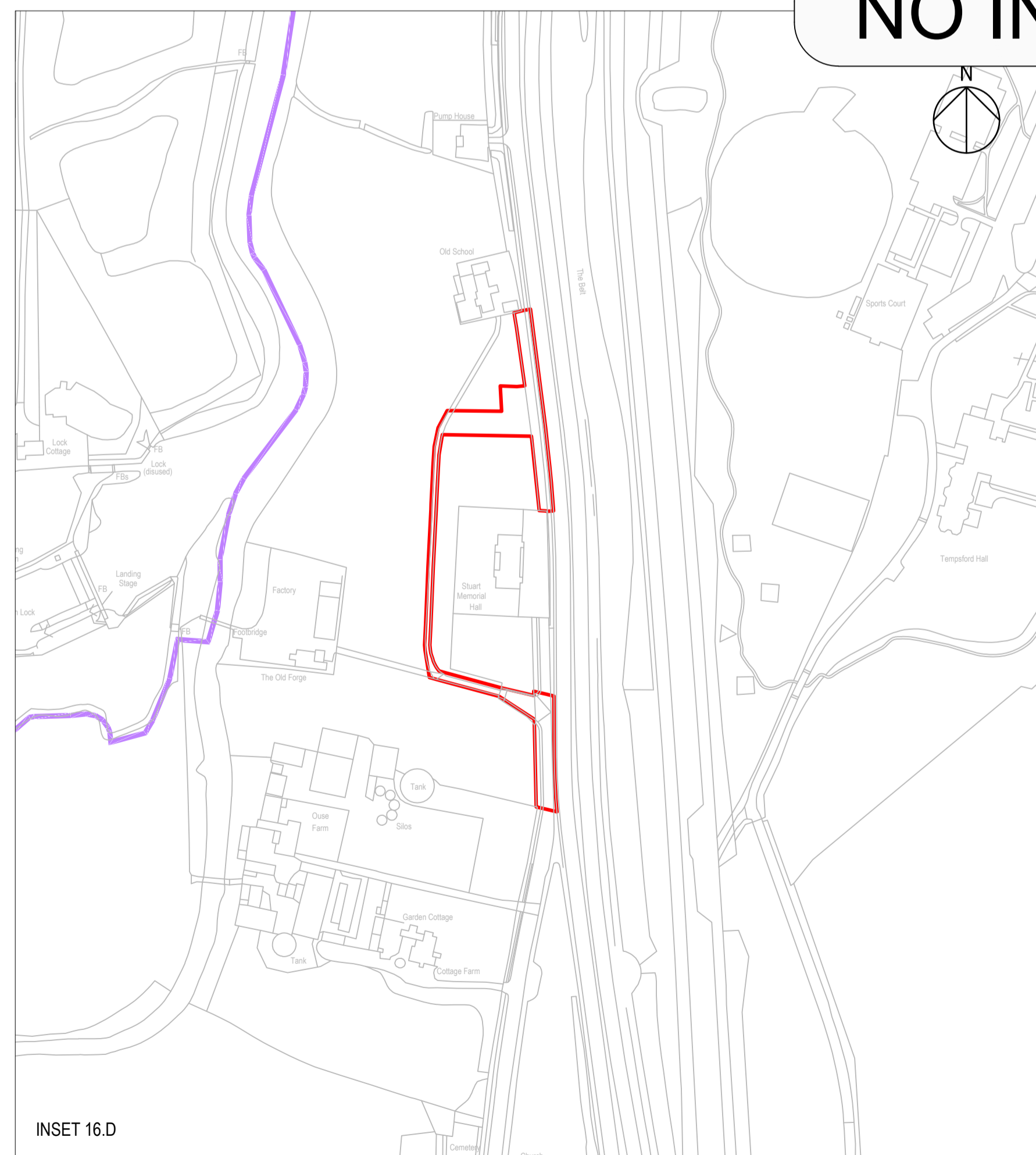

NOTES

1. ALL DIMENSIONS ARE IN METRES UNLESS STATED OTHERWISE.
2. DO NOT SCALE FROM THIS DRAWING, USE ONLY PRINTED DIMENSIONS.
3. ALL EASEMENTS, SERVITUDES AND PRIVATE RIGHTS ARE PROPOSED TO BE EXTINGUISHED ON LAND THAT IS TO BE ACQUIRED UNLESS STATED OTHERWISE IN THE BOOK OF REFERENCE.
4. THIS DRAWING IS TO BE READ IN CONJUNCTION WITH ALL OTHER PLANS AND DOCUMENTATION, IN PARTICULAR THE WORK PLANS [TR010044/APP/2.3] AND THE BOOK OF REFERENCE [TR010044/APP/4.3].

LEGEND

- ORDER LIMITS
- EXCLUSION FROM ORDER LIMITS
- ADMINISTRATIVE BOUNDARY

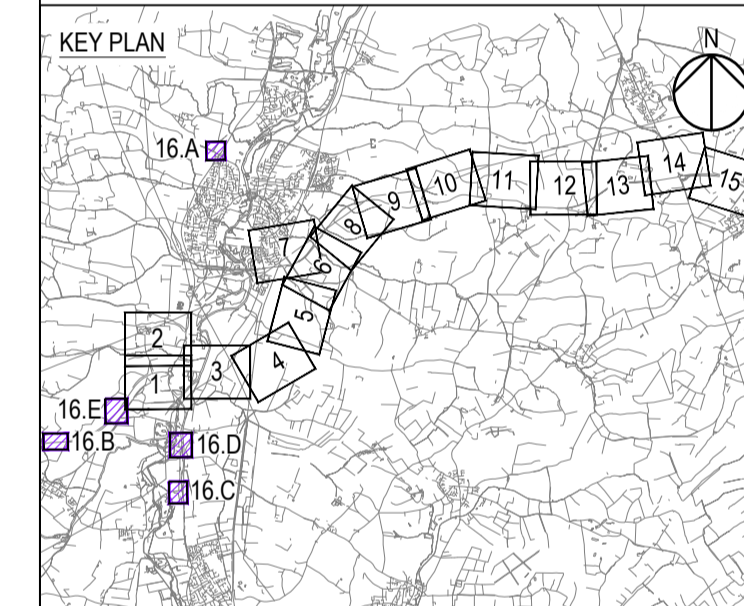

Final for DCO Examination	GJ	AP	04/11/21	P07
Revision Details	By	Check	Date	Suffix

Purpose of issue
DCO Examination

Client
National Highways
Woodlands
Manton Lane
Manton Industrial Estate
Bedford
MK41 7LW

Working on behalf of
national highways

Development Consent Order Number
TR010044

Project Title
A428 BLACK CAT TO CAXTON GIBBET IMPROVEMENTS

Drawing Title
CROWN LAND PLANS REGULATION 5(2)(n) SHEET 16

Designed AECOM	Drawn GJ	Checked AP	Approved PG	Date 04/11/21
Internal Project No. 60541541			Suitability D9	
Scale @ A1 1:2500			Zone ZN5	

THIS DOCUMENT HAS BEEN PREPARED PURSUANT TO AND SUBJECT TO THE TERMS OF AECOM'S APPOINTMENT BY ITS CLIENT. AECOM ACCEPTS NO LIABILITY FOR ANY USE OF THIS DOCUMENT OTHER THAN BY ITS ORIGINAL CLIENT OR FOLLOWING AECOM'S EXPRESS AGREEMENT TO SUCH USE, AND ONLY FOR THE PURPOSES FOR WHICH IT WAS PREPARED AND PROVIDED.

Drawing Number HE551495	National Highways PIN -ARD	1 Originator -LSI	1 Volume -	Rev P07
Location ZN5_SW_Z_ZZ -DR-DC-2126				I Type 1

