

# A428 Black Cat to Caxton Gibbet improvements

TR010044

Volume 5

5.2 Consultation Report Appendix

Appendix M (Part 1.4): Statutory consultation material

Section 37(3)(c) of the Planning Act 2008

Regulation 5(2)(q) of the Infrastructure Planning (Applications:  
Prescribed Forms and Procedure) Regulations 2009

26 February 2021

Infrastructure Planning

Planning Act 2008

**The Infrastructure Planning  
(Applications: Prescribed Forms and  
Procedure) Regulations 2009**

**A428 Black Cat to Caxton Gibbet  
improvements  
Development Consent Order 202[ ]**

---

**5.2 Consultation Report Appendix  
Appendix M (Part 1.4): Statutory consultation material**

---

<b>Regulation Reference:</b>	Regulation 5(2)(q)
<b>Planning Inspectorate Scheme Reference</b>	TR010044
<b>Application Document Reference</b>	TR010044/APP/5.2
<b>Author</b>	A428 Black Cat to Caxton Gibbet improvements Project Team, Highways England

<b>Version</b>	<b>Date</b>	<b>Status of Version</b>
Rev 1	26 February 2021	DCO Application

## Appendix M: Statutory consultation material

### Table of contents

<b>Contents</b>	<b>Page</b>
<b>Part 1.1</b>	
M1 Technical Working Groups and Community Forums – An overview .....	1
M2 Statutory consultation booklet (June 2019) .....	14
M3 Statutory consultation response form (June 2019).....	86
<b>Part 1.2</b>	
M4 Map book 1 – General Arrangements .....	1
<b>Part 1.3</b>	
M5 Map book 2 – land plans .....	1
<b>Part 1.4</b>	
M6 Map book 3 – engineering plans .....	1
<b>Part 1.5</b>	
M7 PEI Report NTS .....	1
<b>Part 1.6</b>	
M8 Statutory consultation exhibition panels .....	1
M9 Statutory consultation exhibition panels new junctions (revised) .....	12
<b>Part 1.7</b>	
M10 Photo of full scheme satellite map.....	1
M11 Full Scheme drawing.....	3
M12 Development consent guide.....	5
M13 Statutory consultation event feedback .....	10
M14 Mobile visitor centre external posters.....	12
M15 Shopping centre pop-up stand .....	17
M16 Shopping centre wrap around banner .....	19
M17 Photos of statutory consultation exhibitions .....	22
M18 Photos of statutory consultation materials at deposit location.....	25

**Part 2**

M19	S48 notice .....	1
M20	S47 notice .....	3
M21	S47 notice in Cambridge News (03-06-19) .....	5
M22	S47 notice in The Hunts Post (05-06-19) .....	7
M23	S47 notice in Bedford Times and Citizen (06-06-19).....	9
M24	Statutory consultation zone postcard .....	11
M25	Statutory consultation parish councils email (09-06-19).....	14
M26	Statutory consultation email to local authorities (04-6-19).....	16
M27	Statutory consultation poster.....	18
M28	Statutory consultation flyer.....	20
M29	Statutory consultation Minecraft flyer .....	23
M30	Statutory consultation promotional tweet .....	26
M31	Statutory consultation Facebook advert .....	28
M32	Statutory consultation website adverts.....	30
M33	Statutory consultation launch press release (03-06-19) (issued by Highways England).....	34
M34	Statutory consultation email to those who registered to receive emails (03-06-19) .....	38
M35	Statutory consultation community and hard to reach groups email (06-06-19) .....	40
M36	Statutory consultation hard to reach groups letter (04-06-19) .....	43
M37	Statutory consultation Cambridge News advert (20-06-19).....	46
M38	Statutory consultation Cambridge News advert (27-06-19).....	48
M39	Statutory consultation Cambridge News advert (11-07-19).....	50
M40	Statutory consultation Milton Keynes Citizen advert (20-06-19).....	52
M41	Statutory consultation Milton Keynes Citizen advert (27-06-19).....	54
M42	Statutory consultation Milton Keynes Citizen advert (11-07-19).....	56
M43	Statutory consultation Hunts Post advert (26-06-19).....	58
M44	Statutory consultation Hunts Post advert (03-07-19).....	60
M45	Statutory consultation Hunts Post advert (10-07-19).....	62
M46	Mumsnet articles .....	64
M47	Screenshots of parish councils promoting the statutory consultation via their websites and social media .....	76



### Part 3

M48	Screenshot of A428 app.....	1
M49	Screenshot of Scheme flythrough .....	3
M50	Screenshot of VISSIM model showing construction.....	5
M51	Screenshot of Minecraft model .....	7
M52	Geographical distribution on Minecraft users .....	9
M53	Statutory consultation land interest event invitation (03-06-19).....	11
M54	Launch event invite list.....	14
M55	Statutory consultation postcode discrepancy letter (03-07-19) .....	17
M56	Statutory consultation community and hard to reach groups list .....	19
M57	Statutory consultation community and hard to reach groups contact log .....	29
M58	BBC Look East (West) screenshots (10-06-10) .....	40
M59	ITV Anglia (03-07-19).....	42
M60	Cambridge Independent (03-07-19) .....	44
M61	Biggleswade Chronical (07-07-19) .....	47
M62	The Hunts Post (03-06-19).....	49
M63	Cambridge Network (02-07-19).....	53
M64	Government Computing (02-07-19) .....	55
M65	The Hunts Post (17-07-19).....	61
M66	Milton Keynes FM (04-07-19).....	65
M67	Cambridge News (04-07-19).....	71
M68	Project update: February 2020.....	76

## M6 Map book 3 – engineering plans

# A428

## Black Cat to Caxton Gibbet improvements

Public consultation 2019

Map book 3: engineering plans



June 2019

# A428 Black Cat to Caxton Gibbet map books

The three map books contain plans of the proposed project under the following headings:

- Map book 1 – General Arrangements (layout plans)
- Map book 2 – land plans
- Map book 3 – engineering plans

These plans show our current proposals and are published for the purposes of consultation on the project. The proposals are therefore subject to change due to consultation feedback and further design development.

The plans run from the Black Cat junction in the west to the Caxton Gibbet junction in the east.

## Map book 1 - General Arrangements

The General Arrangements show the proposed details of the project including:

- Engineering & construction
- Environment
- Development boundary

## Map book 2 - land plans

The land plans show the areas we may need to purchase or require temporary rights to use, in order to construct and operate the project.

Areas we may need to purchase or require temporary rights to use include the land for the permanent works, temporary works and compensation land.

## Permanent works

Permanent use of land will be required along the route of the road, for re-connecting local roads and for associated structures, drainage ponds and landscape areas.

## Temporary works

Temporary use of land is needed for the project's construction works and to provide sufficient space to do so safely. The plans show land that may be required temporarily for the main construction compounds and storage areas along the route. We will also require rights over land to divert utilities such as gas pipelines, electricity cables and water pipes. Any land that is only required temporarily will be returned to its previous use wherever possible once construction has been completed.

## Compensation land

Compensation land may include environmental protection measures such as habitat creation and for flood compensation. This land may also need to be acquired permanently.

## Map book 3 - engineering plans

This book contains engineering drawings in the following order:

- The plan and profile drawings which detail the vertical and horizontal alignment of the new dual carriageway
- The typical cross section of the new dual carriageway

The plan and profile drawings show the highway details of the route in plan and profile. The drawings are split into two views with the plan on the top and profile underneath.

The profile gives the road level in relation to existing ground at a given chainage\*. An exaggerated scale is used in the profile to help show the differences in levels and gradients of the design. The profile also shows where existing roads and public rights of way cross over or under the route.

All levels are given in relation to the ordnance datum level\*\* which might be different on each drawing.

\*Chainage measures the distance along the route in metres

\*\*Above Ordnance Datum level (AOD) is a measurement above mean sea level





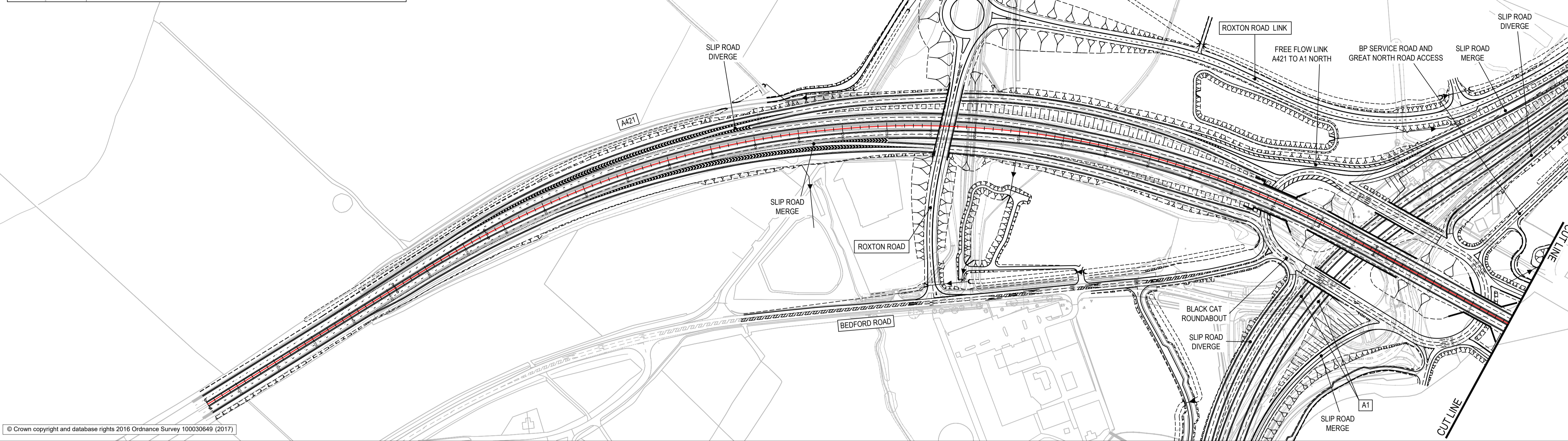
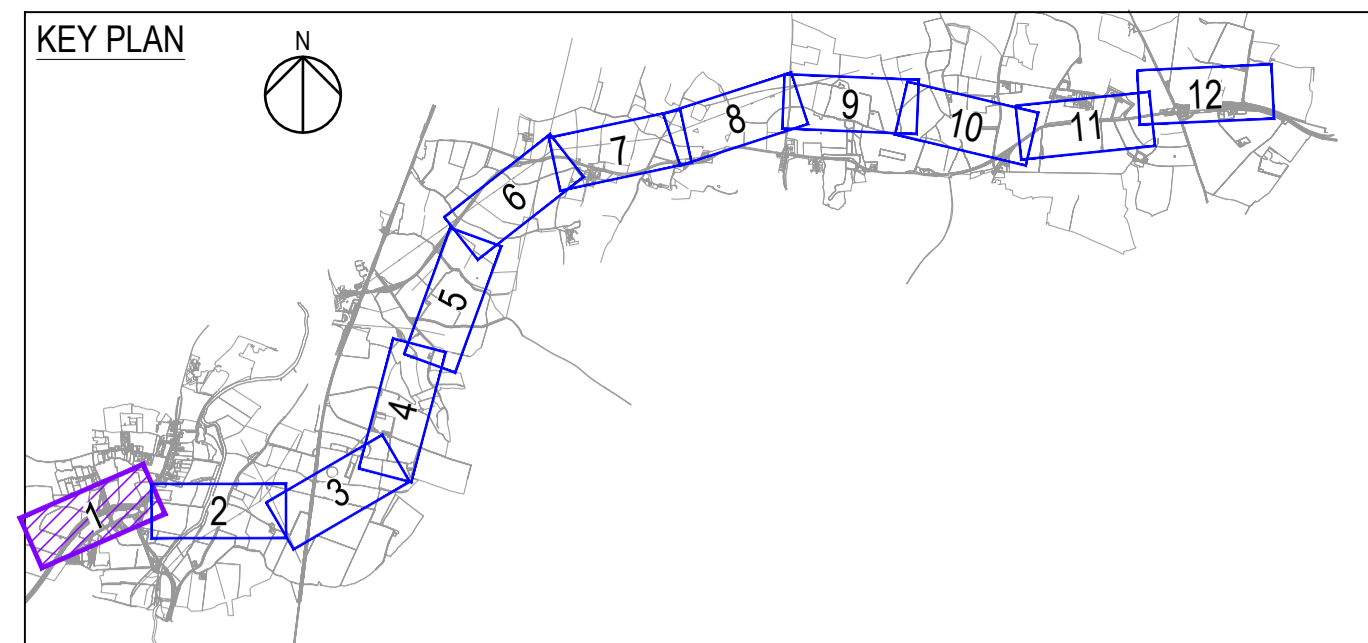

© Crown copyright and database rights 2016 Ordnance Survey 100030649 (2017)

- NOTES**
- DO NOT SCALE FROM THIS DRAWING, USE ONLY PRINTED DIMENSIONS.
  - ALL DIMENSIONS, CHAINAGES, LEVELS AND COORDINATES ARE IN METRES UNLESS DEFINED OTHERWISE.
- KEY**
- FINISHED ROAD LEVEL AT CENTRELINE OF NEW ROAD
  - TOPOGRAPHICAL SURVEY (EXISTING GROUND)
  - BRIDGE
  - CULVERT
  - DITCH

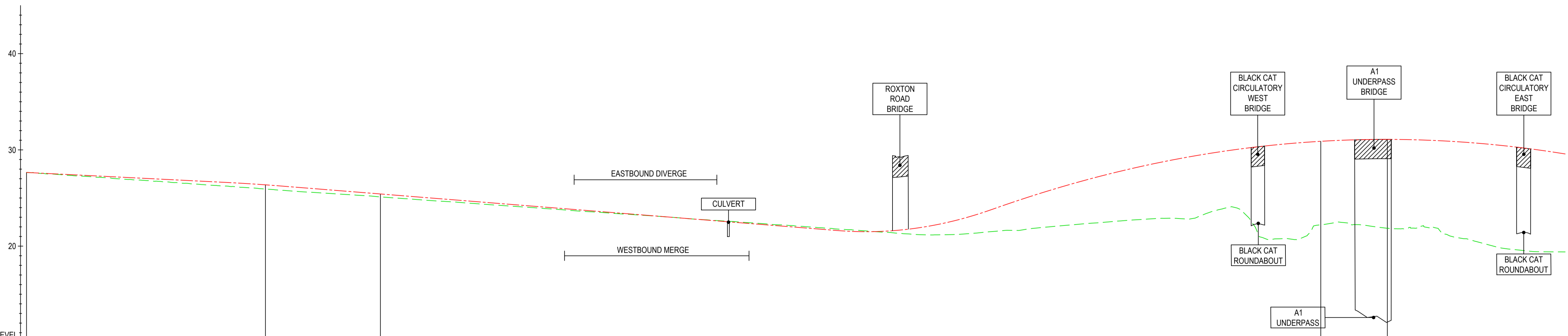

CHAINAGE	EXISTING LEVELS	PROPOSED LEVELS	VERTICAL ALIGNMENT	HORIZONTAL ALIGNMENT
210.843	27.655	27.655	G=-0.50%	L=248.311
250.000	27.381	27.459		
300.000	27.039	27.209	L=55.50 K=185.00	RL=121512.35
350.000	26.717	26.959		
400.000	26.343	26.709	G=-0.80%	R=1017.01
450.000	26.011	26.432		
500.000	25.629	26.046	L=161.038 K=37.00	RL=70316.07
550.000	25.321	25.644		
600.000	24.960	25.248	G=3.55%	L=614.244
650.000	24.618	24.848		
700.000	24.252	24.448		
750.000	23.992	24.048		
800.000	23.552	23.644		
850.000	23.213	23.248		
900.000	22.841	22.848		
950.000	22.517	22.448		
1000.000	22.177	22.048		
1050.000	21.804	21.644		
1100.000	21.455	21.538		
1150.000	21.161	22.097		
1200.000	21.375	23.334		
1250.000	21.750	25.028		
1300.000	22.231	26.541		
1350.000	22.636	27.639		
1400.000	22.890	28.919		
1450.000	23.788	29.782		
1500.000	20.709	30.427		
1550.000	22.132	30.855		
1600.000	22.194	31.065		
1650.000	21.871	31.059		
1700.000	20.848	30.834		
1750.000	19.711	30.392		
1800.000	19.402	29.733		
1810.000	19.399	29.575		

CENTRELINE LONGSECTION  
SCALE: H 1:2500, V 1:250

For Statutory Consultation	JMW	22/05/19	P01
Revision Details	By	Date	Suffix
	Check		

**FOR INFORMATION**

Client  
Highways England  
Woodlands  
Manton Lane  
Manton Industrial Estate  
Bedford  
MK41 7LW

Project Title  
**A428 BLACK CAT TO CAXTON GIBBET IMPROVEMENTS**

Drawing Title  
**PLAN AND PROFILE SHEET 1 OF 12**

Designed JMW	Drawn JMW	Checked PS	Approved TD	Date 22/05/19
Internal Project No. 60541541		Suitability S2		
Scale @ A1 ---		Zone General		

THIS DOCUMENT HAS BEEN PREPARED PURSUANT TO AND SUBJECT TO THE TERMS OF AECOM'S APPOINTMENT BY ITS CLIENT. AECOM ACCEPTS NO LIABILITY FOR ANY USE OF THIS DOCUMENT OTHER THAN BY ITS ORIGINAL CLIENT OR FOLLOWING AECOM'S EXPRESS AGREEMENT TO SUCH USE, AND ONLY FOR THE PURPOSES FOR WHICH IT WAS PREPARED AND PROVIDED.

Drawing Number HE551495 -ACM -HML - GEN_ML_Z_ZZ -DR-CH-0001	Location I Type I Role I Number	Rev P01
---	------------------------------------	------------

File Name: C:\P\WORKING\DRG\GEN\_ML\_Z\_ZZ\DR-CH-0001  
 File Date: 22 May 2019 15:13:25  
 File Name: C:\P\WORKING\DRG\GEN\_ML\_Z\_ZZ\DR-CH-0001



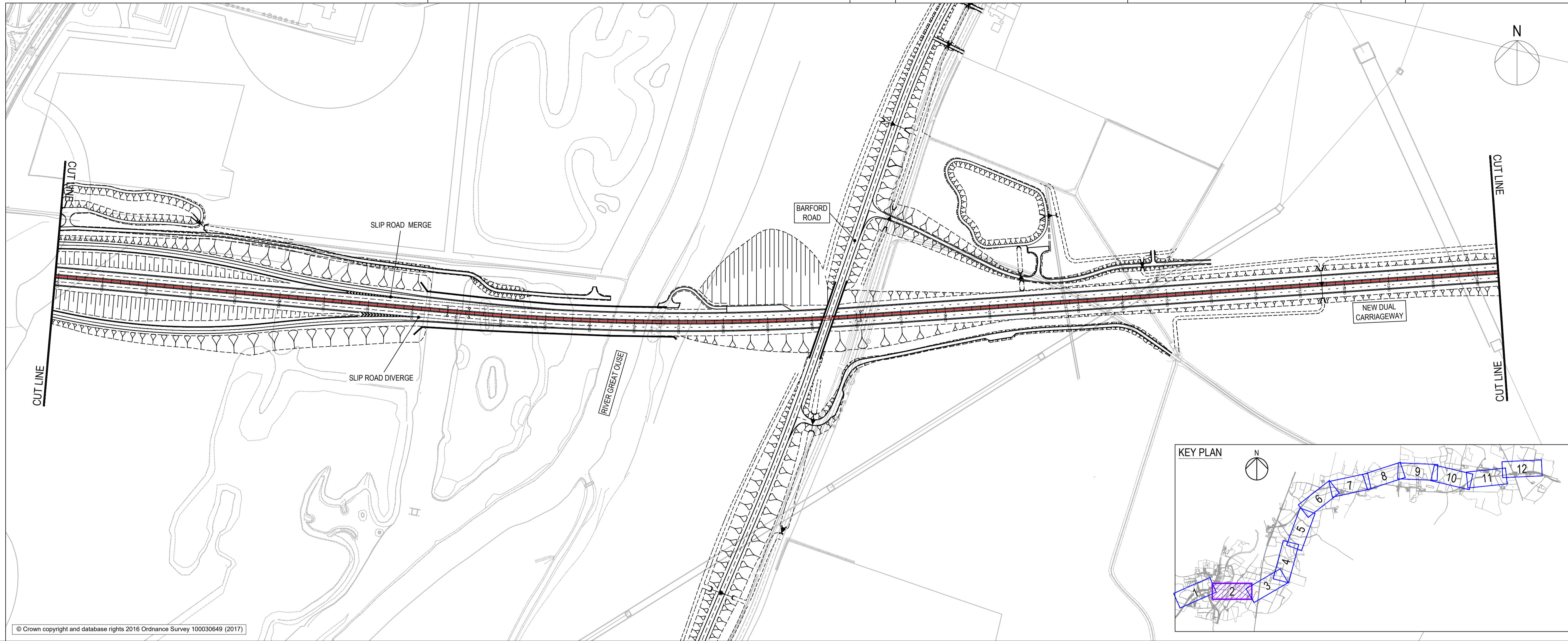

- NOTES**
- DO NOT SCALE FROM THIS DRAWING, USE ONLY PRINTED DIMENSIONS.
  - ALL DIMENSIONS, CHAINAGES, LEVELS AND COORDINATES ARE IN METRES UNLESS DEFINED OTHERWISE.
- KEY**
- FINISHED ROAD LEVEL AT CENTRELINE OF NEW ROAD
  - TOPOGRAPHICAL SURVEY (EXISTING GROUND)
  - BRIDGE
  - CULVERT
  - DITCH



© Crown copyright and database rights 2016 Ordnance Survey 100030649 (2017)

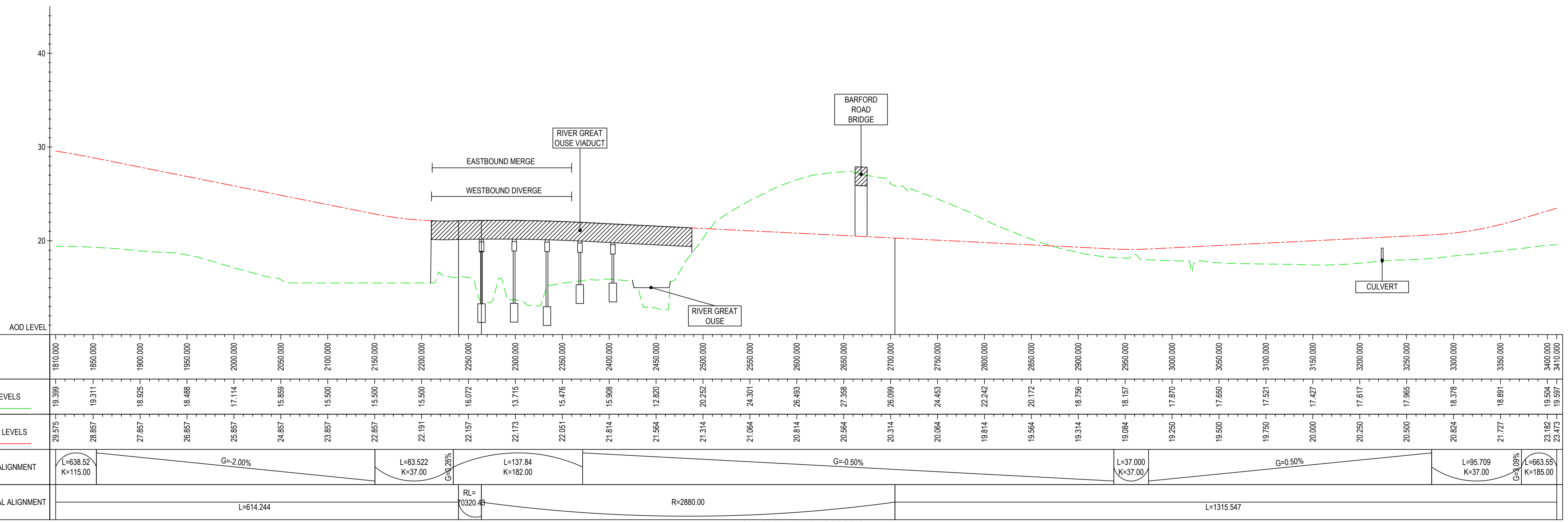

CENTRELINE LONGSECTION  
SCALE: H 1:2500, V 1:250

For Statutory Consultation	JMW	22/05/19	P01
Revision Details	By	Date	Suffix
	Check		

Purpose of issue  
**FOR INFORMATION**

Client  
Highways England  
Woodlands  
Manton Lane  
Bedford  
MK41 7LW



Project Title  
**A428 BLACK CAT TO CAXTON GIBBET IMPROVEMENTS**

Drawing Title  
**PLAN AND PROFILE SHEET 2 OF 12**

Designed JMW	Drawn JMW	Checked PS	Approved TD	Date 22/05/19
Internal Project No. 60541541	Scale @ A1	Subsidiary S2	Zone General	

THIS DOCUMENT HAS BEEN PREPARED PURSUANT TO AND SUBJECT TO THE TERMS OF AECOM'S APPOINTMENT BY ITS CLIENT. AECOM ACCEPTS NO LIABILITY FOR ANY USE OF THIS DOCUMENT OTHER THAN BY ITS ORIGINAL CLIENT OR FOLLOWING AECOM'S EXPRESS AGREEMENT TO SUCH USE, AND ONLY FOR THE PURPOSES FOR WHICH IT WAS PREPARED AND PROVIDED.

Drawing Number HE551495 - ACM - HML - GEN_ML_Z_ZZ - DR - CH-0002	Highways England PIN 1 Originator 1 Volume	Rev P01
---	--	------------

File Name: C:\P\WORKING\AECOM\_EIA\WORKING\03052017\HE551495-ACM-HML\_GEN\_ML\_Z\_ZZ-DR-CH-0002  
 Plot Date: 22 May 2019 15:25:51



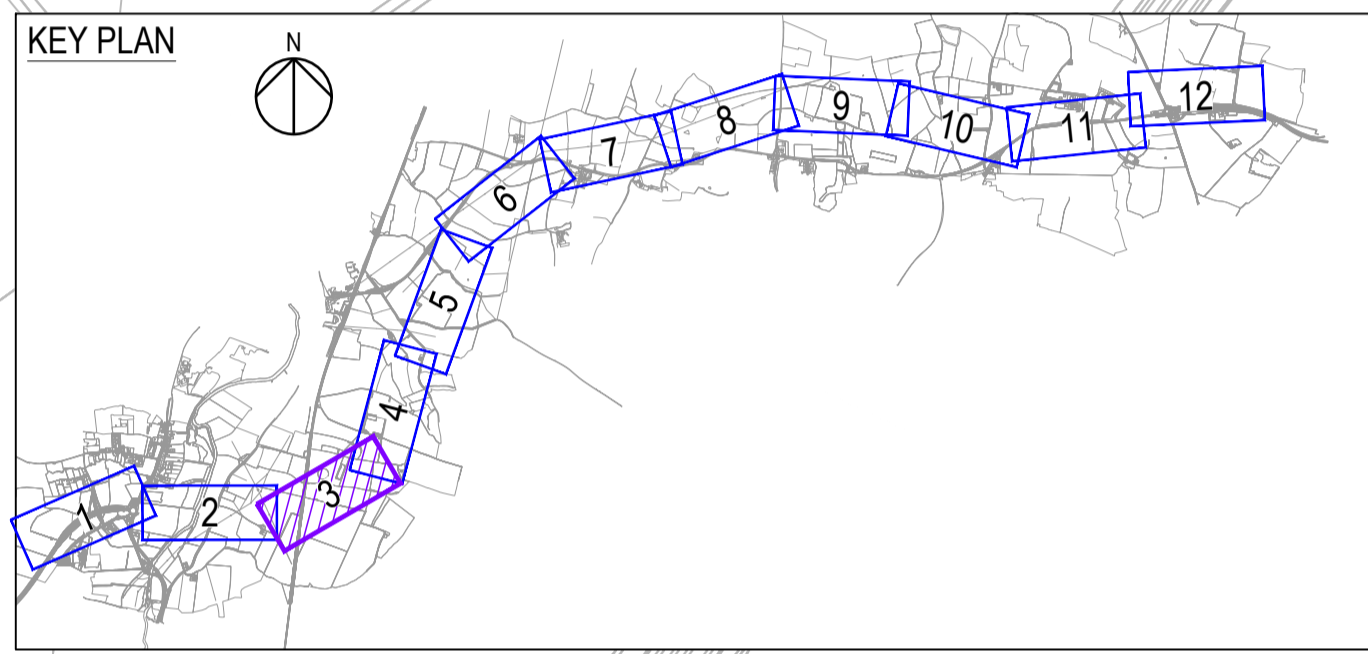
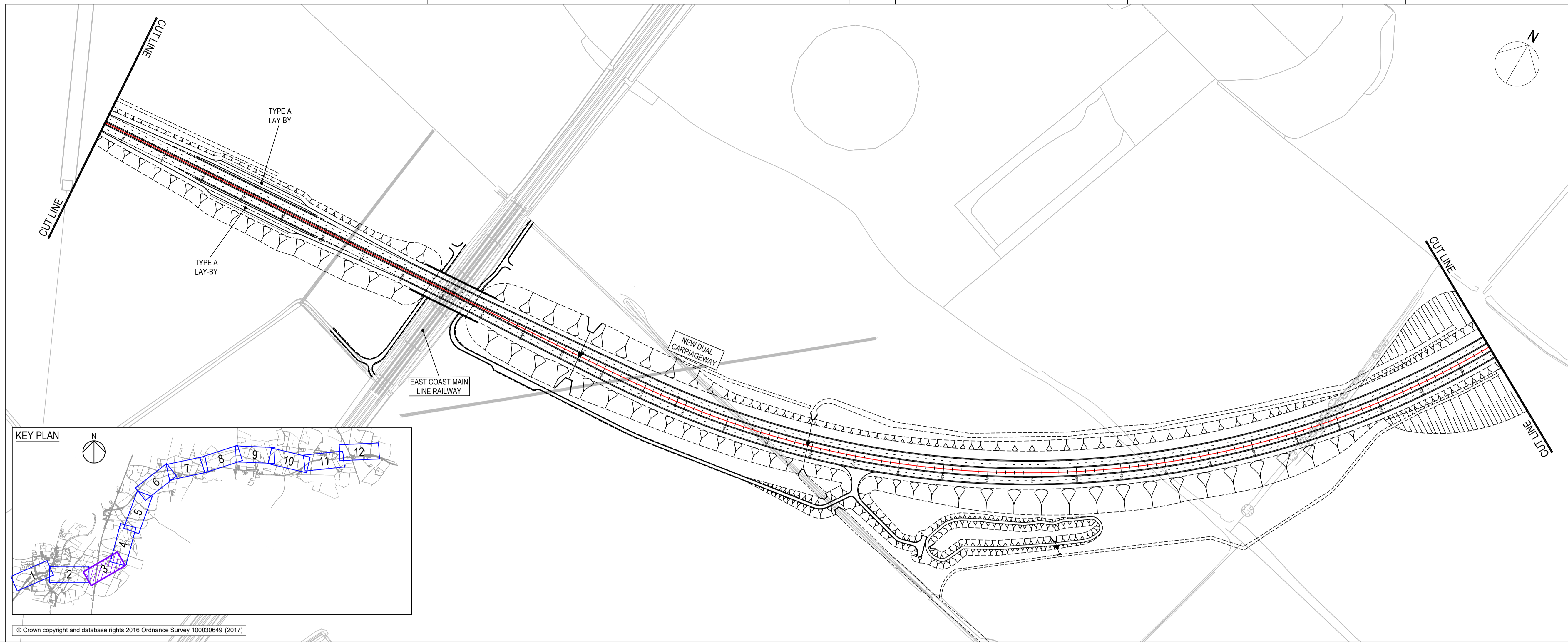

© Crown copyright and database rights 2016 Ordnance Survey 100030649 (2017)

- NOTES**
- DO NOT SCALE FROM THIS DRAWING, USE ONLY PRINTED DIMENSIONS.
  - ALL DIMENSIONS, CHAINAGES, LEVELS AND COORDINATES ARE IN METRES UNLESS DEFINED OTHERWISE.

- KEY**
- FINISHED ROAD LEVEL AT CENTRELINE OF NEW ROAD
  - - - TOPOGRAPHICAL SURVEY (EXISTING GROUND)
  - == BRIDGE
  - - - CULVERT
  - - - DITCH

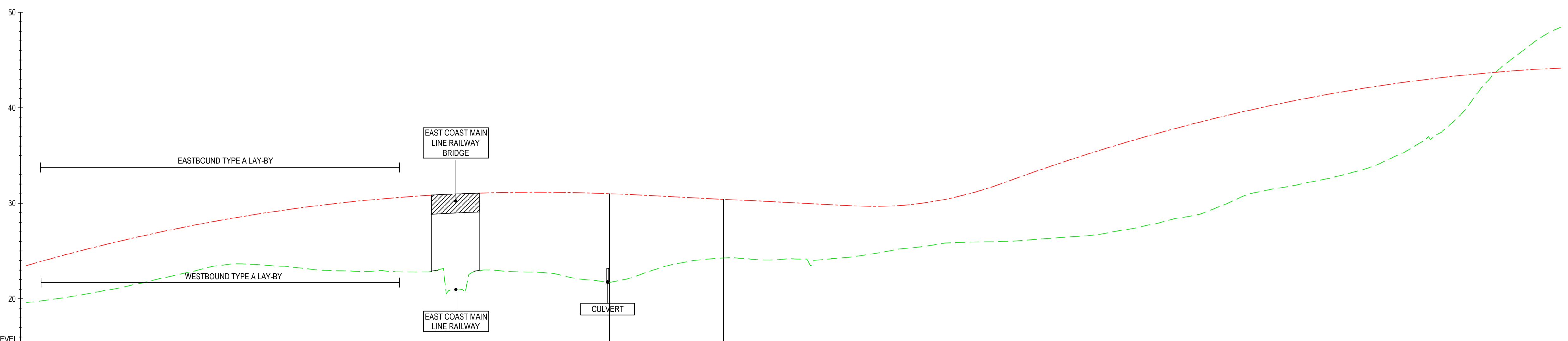

CHAINAGE	EXISTING LEVELS	PROPOSED LEVELS	VERTICAL ALIGNMENT	HORIZONTAL ALIGNMENT	
3410.000	19.597	23.473	L=663.55 K=185.00	L=1315.547	
3450.000	20.108	24.583			
3500.000	20.999	25.849			
3550.000	22.104	26.998			
3600.000	23.279	27.976			
3650.000	23.596	28.836			
3700.000	23.181	29.562			
3750.000	22.913	30.152			
3800.000	22.820	30.607			
3850.000	20.626	30.927			G=-0.50%
3900.000	22.991	31.112			
3950.000	22.794	31.162			
4000.000	21.950	31.077			
4050.000	22.449	30.861			
4100.000	23.847	30.611			
4150.000	24.307	30.361			
4200.000	24.133	30.111			
4250.000	24.172	29.861			
4300.000	24.788	29.672			
4350.000	25.502	30.047	L=153.996 K=37.00		
4400.000	25.993	31.098			
4450.000	26.095	32.776			
4500.000	26.459	34.491			
4550.000	27.064	36.068			
4600.000	28.087	37.509			
4650.000	29.330	38.811			
4700.000	31.213	39.977			
4750.000	32.156	41.005			
4800.000	33.303	41.896			
4850.000	35.281	42.649		G=1.66%	
4900.000	38.289	43.265			
4950.000	43.978	43.744			
5000.000	47.707	44.085			
5015.000	48.414	44.161			

CENTRELINE LONGSECTION  
SCALE: H 1:2500, V 1:250

For Statutory Consultation	JMW	22/05/19	P01
Revision Details	By	Date	Suffix
	Check		

Purpose of issue  
**FOR INFORMATION**

Client  
Highways England  
Woodlands  
Manton Lane  
Bedford  
MK41 7LW



Project Title  
**A428 BLACK CAT TO CAXTON GIBBET IMPROVEMENTS**

Drawing Title  
**PLAN AND PROFILE SHEET 3 OF 12**

Designed JMW	Drawn JMW	Checked PS	Approved TD	Date 22/05/19
Internal Project No. 60541541			Suitability S2	
Scale @ A1 ---			Zone General	

THIS DOCUMENT HAS BEEN PREPARED PURSUANT TO AND SUBJECT TO THE TERMS OF AECOM'S APPOINTMENT BY ITS CLIENT. AECOM ACCEPTS NO LIABILITY FOR ANY USE OF THIS DOCUMENT OTHER THAN BY ITS ORIGINAL CLIENT OR FOLLOWING AECOM'S EXPRESS AGREEMENT TO SUCH USE, AND ONLY FOR THE PURPOSES FOR WHICH IT WAS PREPARED AND PROVIDED.

Drawing Number HE551495 -ACM -HML - GEN_ML_Z_ZZ -DR -CH-0003	1 Originator 1 Volume	Rev P01
--	--------------------------	------------

File Name: C:\P\WORKING\AECOM\_E\ANWILSON\10052071HE551495-ACM-HML-GEN\_ML\_Z\_ZZ-DR-CH-0003  
 Plot Date: 22 May 2019 15:55:53  
 File Name: C:\P\WORKING\AECOM\_E\ANWILSON\10052071HE551495-ACM-HML-GEN\_ML\_Z\_ZZ-DR-CH-0003





© Crown copyright and database rights 2016 Ordnance Survey 100030649 (2017)

- NOTES**
- DO NOT SCALE FROM THIS DRAWING, USE ONLY PRINTED DIMENSIONS.
  - ALL DIMENSIONS, CHAINAGES, LEVELS AND COORDINATES ARE IN METRES UNLESS DEFINED OTHERWISE.
- KEY**
- FINISHED ROAD LEVEL AT CENTRELINE OF NEW ROAD
  - TOPOGRAPHICAL SURVEY (EXISTING GROUND)
  - BRIDGE
  - CULVERT
  - DITCH

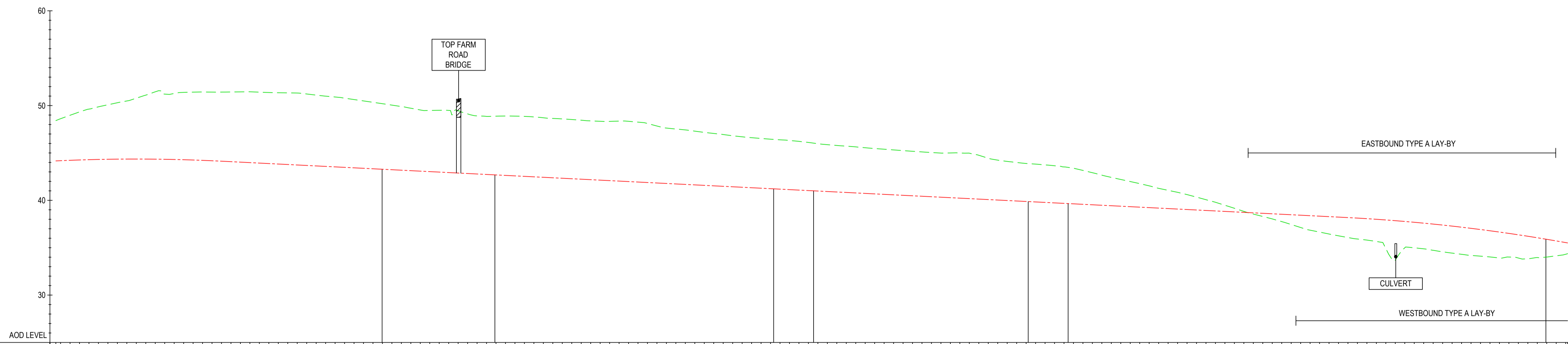

CHAINAGE	EXISTING LEVELS	PROPOSED LEVELS	VERTICAL ALIGNMENT	HORIZONTAL ALIGNMENT
5015.000	48.414	44.161	L=757.49 K=182.00	R=1020.00
5050.000	48.629	44.289		
5100.000	50.779	44.356	G=-0.50%	RL=121514.99
5150.000	51.390	44.285		
5200.000	51.434	44.080	L=294.486	RL=121514.99
5250.000	51.354	43.830		
5300.000	50.993	43.580	R=2880.00	RL=121514.99
5350.000	50.345	43.330		
5400.000	49.537	43.080	L=504.701	L=233.79 K=182.00
5450.000	49.121	42.830		
5500.000	48.886	42.580	L=504.701	L=233.79 K=182.00
5550.000	48.592	42.330		
5600.000	48.331	42.080	L=504.701	L=233.79 K=182.00
5650.000	47.841	41.830		
5700.000	47.189	41.580	L=504.701	L=233.79 K=182.00
5750.000	46.610	41.330		
5800.000	46.222	41.080	L=504.701	L=233.79 K=182.00
5850.000	45.716	40.830		
5900.000	45.319	40.580	L=504.701	L=233.79 K=182.00
5950.000	44.987	40.330		
6000.000	44.444	40.080	L=504.701	L=233.79 K=182.00
6050.000	43.823	39.830		
6100.000	43.158	39.580	L=504.701	L=233.79 K=182.00
6150.000	41.984	39.330		
6200.000	40.846	39.080	L=504.701	L=233.79 K=182.00
6250.000	39.478	38.830		
6300.000	38.039	38.580	L=504.701	L=233.79 K=182.00
6350.000	36.650	38.330		
6400.000	35.806	38.085	L=504.701	L=233.79 K=182.00
6450.000	34.989	37.684		
6500.000	34.303	37.169	L=504.701	L=233.79 K=182.00
6550.000	34.015	36.510		
6600.000	34.143	35.717	L=504.701	L=233.79 K=182.00
6612.000	34.372	35.506		

CENTRELINE LONGSECTION  
SCALE: H 1:2500, V 1:250

For Statutory Consultation	JMW	22/05/19	P01
Revision Details	By TD	Date	Suffix
Purpose of issue	Check		

**FOR INFORMATION**

Client  
Highways England  
Woodlands  
Manton Lane  
Manton Industrial Estate  
Bedford  
MK41 7LW

Working on behalf of  
**highways england**

**A428 BLACK CAT TO CAXTON GIBBET IMPROVEMENTS**

**PLAN AND PROFILE SHEET 4 OF 12**

Designed JMW	Drawn JMW	Checked PS	Approved TD	Date 22/05/19
Internal Project No. 60541541	Suitability S2	Zone General		

THIS DOCUMENT HAS BEEN PREPARED PURSUANT TO AND SUBJECT TO THE TERMS OF AECOM'S APPOINTMENT BY ITS CLIENT. AECOM ACCEPTS NO LIABILITY FOR ANY USE OF THIS DOCUMENT OTHER THAN BY ITS ORIGINAL CLIENT OR FOLLOWING AECOM'S EXPRESS AGREEMENT TO SUCH USE, AND ONLY FOR THE PURPOSES FOR WHICH IT WAS PREPARED AND PROVIDED.

Drawing Number HE551495 - ACM - HML - GEN_ML_Z_ZZ - DR - CH-0004	Location	1 Originator	1 Volume	Rev P01
---	----------	--------------	----------	------------

File Name: C:\P\WORKING\AECOM\_EIA\WORKING\03052019\HE551495-ACM-HML\_GEN\_ML\_Z\_ZZ-DR-CH-0004  
 File Date: 22 May 2019 14:15:32



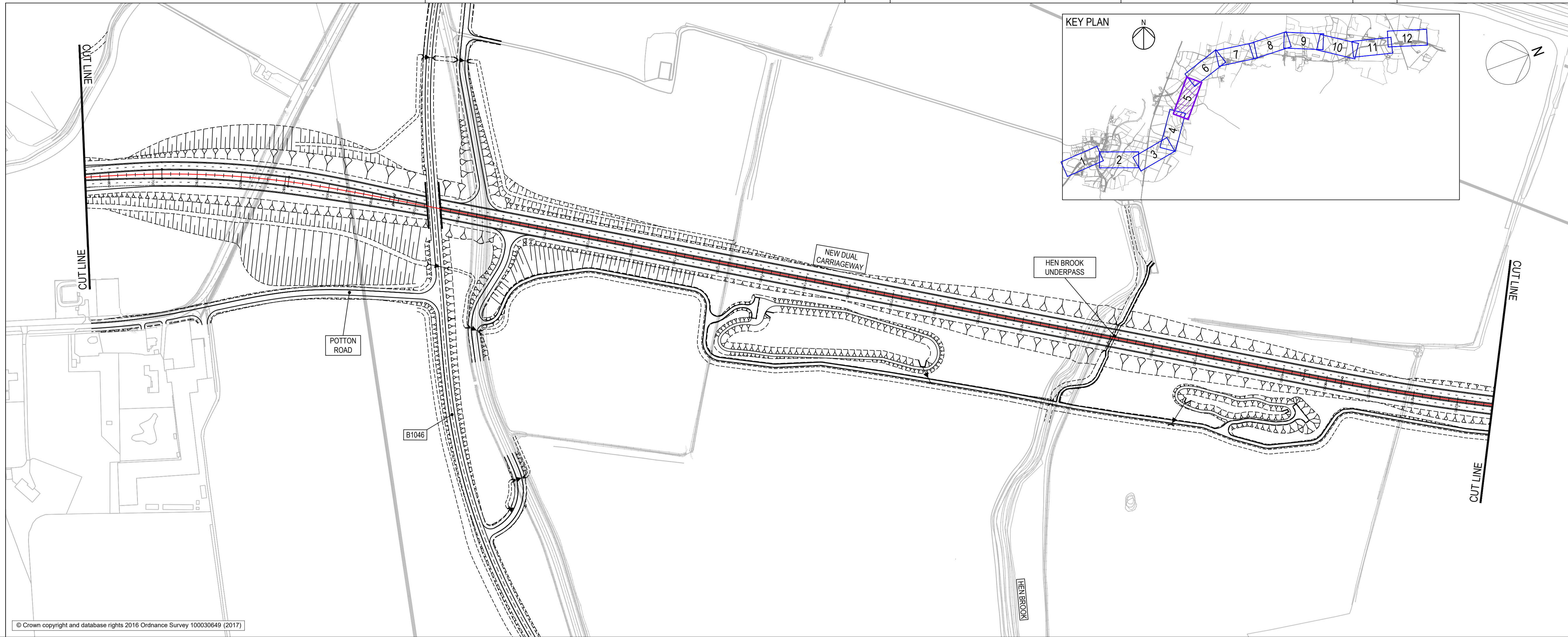

- NOTES
- DO NOT SCALE FROM THIS DRAWING, USE ONLY PRINTED DIMENSIONS.
  - ALL DIMENSIONS, CHAINAGES, LEVELS AND COORDINATES ARE IN METRES UNLESS DEFINED OTHERWISE.
- KEY
- FINISHED ROAD LEVEL AT CENTRELINE OF NEW ROAD
  - TOPOGRAPHICAL SURVEY (EXISTING GROUND)
  - BRIDGE
  - CULVERT
  - DITCH

© Crown copyright and database rights 2016 Ordnance Survey 100030649 (2017)

For Statutory Consultation	JMW	22/05/19	PO1
Revision Details	By	Date	Suffix
	Check		

Purpose of issue

**FOR INFORMATION**

Client  
Highways England  
Woodlands  
Manton Lane  
Manton Industrial Estate  
Bedford  
MK41 7LW

Working on behalf of  
**highways england**

Project Title

**A428 BLACK CAT TO CAXTON GIBBET IMPROVEMENTS**

Drawing Title

**PLAN AND PROFILE SHEET 5 OF 12**

Designed JMW	Drawn JMW	Checked PS	Approved TD	Date 22/05/19
Internal Project No. 60541541	Suitability S2	Scale @ A1 Zone General		

THIS DOCUMENT HAS BEEN PREPARED PURSUANT TO AND SUBJECT TO THE TERMS OF AECOM'S APPOINTMENT BY ITS CLIENT. AECOM ACCEPTS NO LIABILITY FOR ANY USE OF THIS DOCUMENT OTHER THAN BY ITS ORIGINAL CLIENT OR FOLLOWING AECOM'S EXPRESS AGREEMENT TO SUCH USE, AND ONLY FOR THE PURPOSES FOR WHICH IT WAS PREPARED AND PROVIDED.

Drawing Number HE551495 -ACM -HML -	1 Originator	1 Volume	Rev P01
GEN_ML_Z_ZZ -DR-CH-0005	Location		I Type I Role I Number

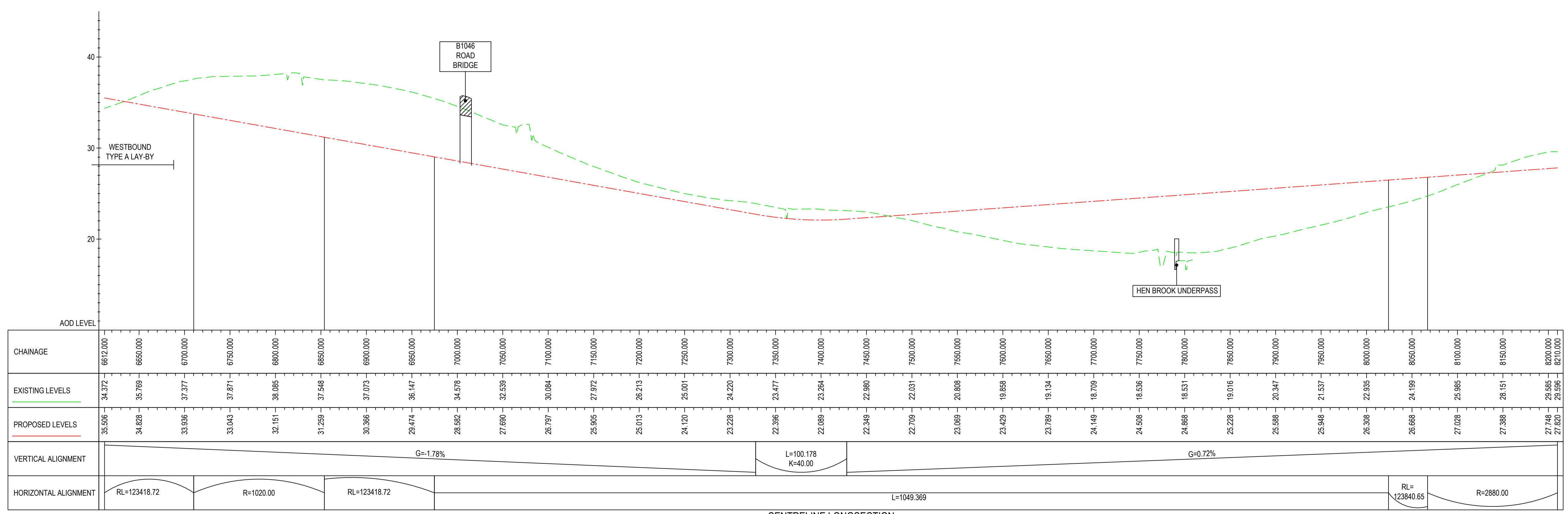

CENTRELINE LONGSECTION  
SCALE: H 1:2500, V 1:250

File Name: C:\P\WORKING\AECOM\_E\ANWILSON\1005207\HE551495-ACM-HML-GEN\_ML\_Z\_ZZ-DR-CH-0005  
 Plot Date: 22 May 2019 14:07:37



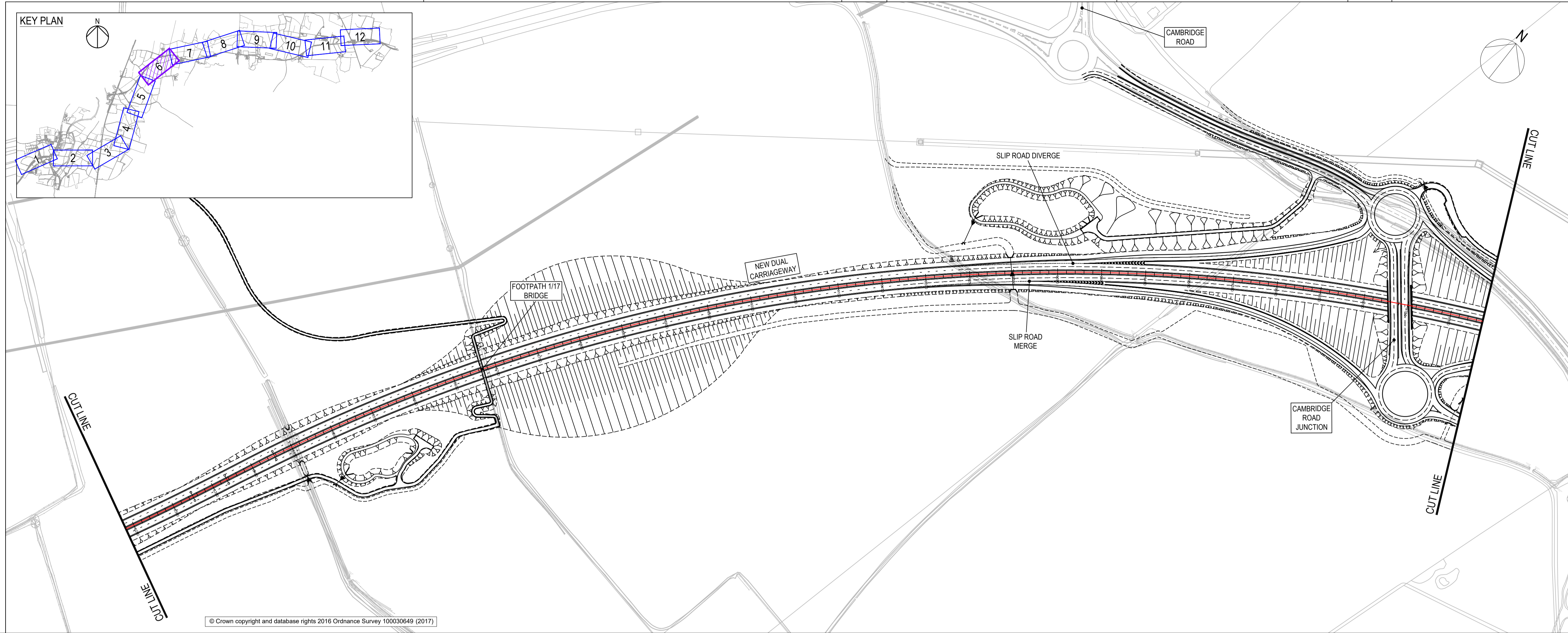

- NOTES**
- DO NOT SCALE FROM THIS DRAWING, USE ONLY PRINTED DIMENSIONS.
  - ALL DIMENSIONS, CHAINAGES, LEVELS AND COORDINATES ARE IN METRES UNLESS DEFINED OTHERWISE.
- KEY**
- FINISHED ROAD LEVEL AT CENTRELINE OF NEW ROAD
  - TOPOGRAPHICAL SURVEY (EXISTING GROUND)
  - BRIDGE
  - CULVERT
  - DITCH

© Crown copyright and database rights 2016 Ordnance Survey 100030649 (2017)

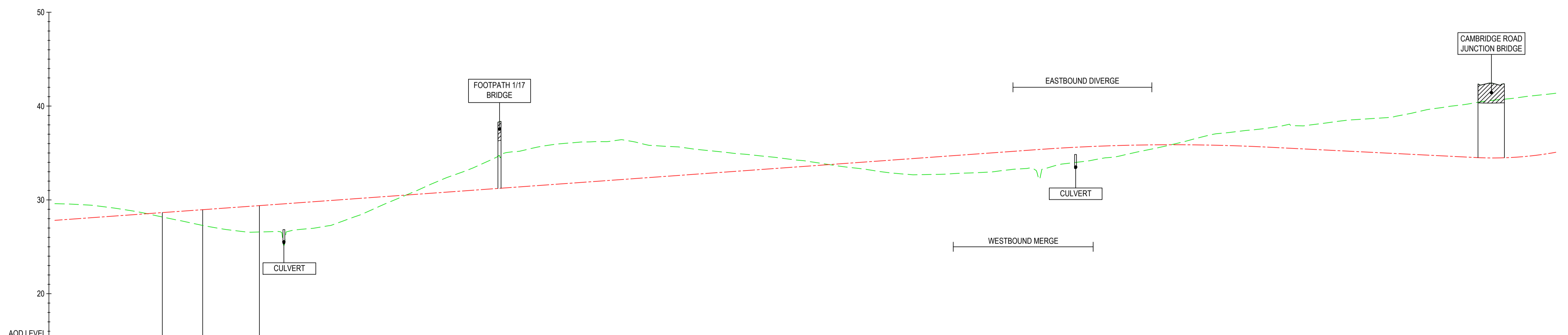

CHAINAGE	EXISTING LEVELS	PROPOSED LEVELS
8210.000	29.596	27.620
8250.000	28.419	28.103
8300.000	28.700	28.468
8350.000	27.655	28.828
8400.000	26.749	29.188
8450.000	26.609	29.548
8500.000	27.214	29.908
8550.000	29.037	30.268
8600.000	31.173	30.627
8650.000	33.178	30.987
8700.000	35.136	31.347
8750.000	35.991	31.707
8800.000	36.220	32.067
8850.000	35.782	32.427
8900.000	35.325	32.787
8950.000	34.823	33.147
9000.000	34.251	33.507
9050.000	33.549	33.867
9100.000	32.887	34.227
9150.000	32.717	34.587
9200.000	32.934	34.947
9250.000	33.386	35.307
9300.000	34.016	35.622
9350.000	34.793	35.813
9400.000	35.877	35.879
9450.000	37.069	35.820
9500.000	37.604	35.637
9550.000	38.008	35.387
9600.000	38.576	35.137
9650.000	39.115	34.897
9700.000	40.010	34.637
9750.000	40.680	34.474
9800.000	41.247	34.907
9850.000	41.366	35.074

CENTRELINE LONGSECTION  
SCALE: H 1:2500, V 1:250

For Statutory Consultation	JMW	22/05/19	P01
Revision Details	By	Date	Suffix
	Check		

FOR INFORMATION

Client  
Highways England  
Woodlands  
Manton Lane  
Manton Industrial Estate  
Bedford  
MK41 7LW

Project Title  
**A428 BLACK CAT TO CAXTON GIBBET IMPROVEMENTS**

Drawing Title  
**PLAN AND PROFILE SHEET 6 OF 12**

Designed JMW	Drawn JMW	Checked PS	Approved TD	Date 22/05/19
Internal Project No. 60541541	Scale @ A1 ---	Subsidiary S2	Zone General	

THIS DOCUMENT HAS BEEN PREPARED PURSUANT TO AND SUBJECT TO THE TERMS OF AECOM'S APPOINTMENT BY ITS CLIENT. AECOM ACCEPTS NO LIABILITY FOR ANY USE OF THIS DOCUMENT OTHER THAN BY ITS ORIGINAL CLIENT OR FOLLOWING AECOM'S EXPRESS AGREEMENT TO SUCH USE, AND ONLY FOR THE PURPOSES FOR WHICH IT WAS PREPARED AND PROVIDED.

Drawing Number HE551495 - ACM - HML - GEN_ML_Z_Z - DR - CH - 0006	1 Originator	1 Volume	Rev P01
--	--------------	----------	------------

File Name: C:\P\WORKING\AECOM\_EIA\WORKING\03052017\HE551495-ACM-HML\_GEN\_ML\_Z\_Z-DR-CH-0006  
 Plot Date: 27 May 2019 15:05:53



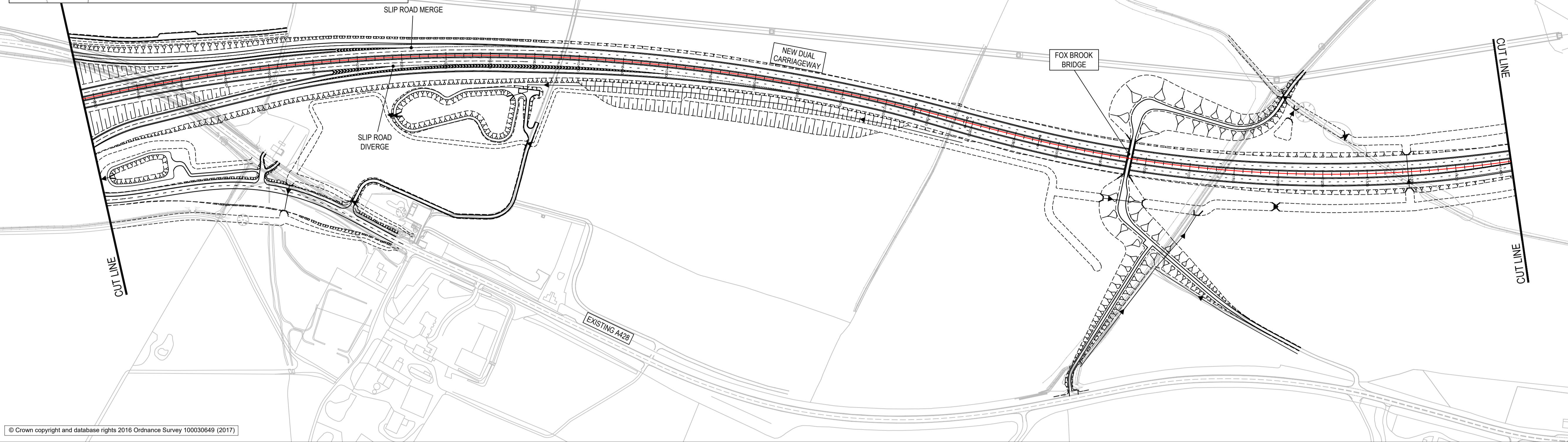
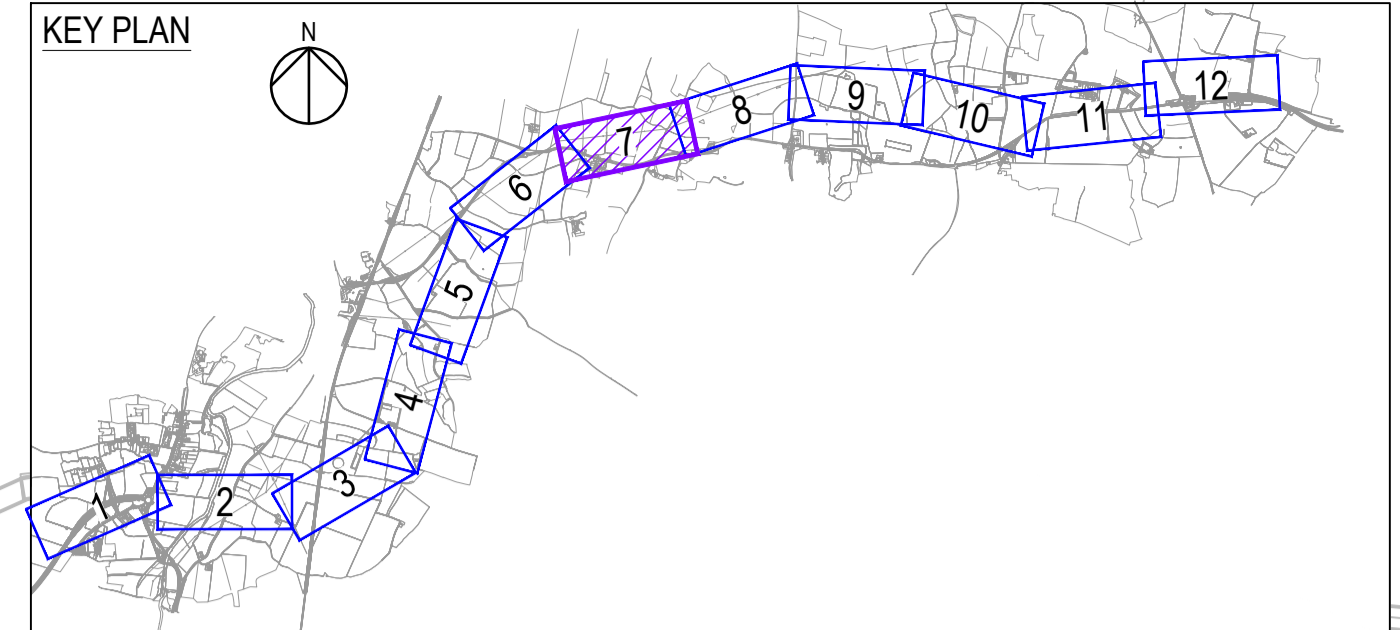

© Crown copyright and database rights 2016 Ordnance Survey 100030649 (2017)

- NOTES**
- DO NOT SCALE FROM THIS DRAWING, USE ONLY PRINTED DIMENSIONS.
  - ALL DIMENSIONS, CHAINAGES, LEVELS AND COORDINATES ARE IN METRES UNLESS DEFINED OTHERWISE.
- KEY**
- FINISHED ROAD LEVEL AT CENTRELINE OF NEW ROAD
  - TOPOGRAPHICAL SURVEY (EXISTING GROUND)
  - BRIDGE
  - CULVERT
  - DITCH

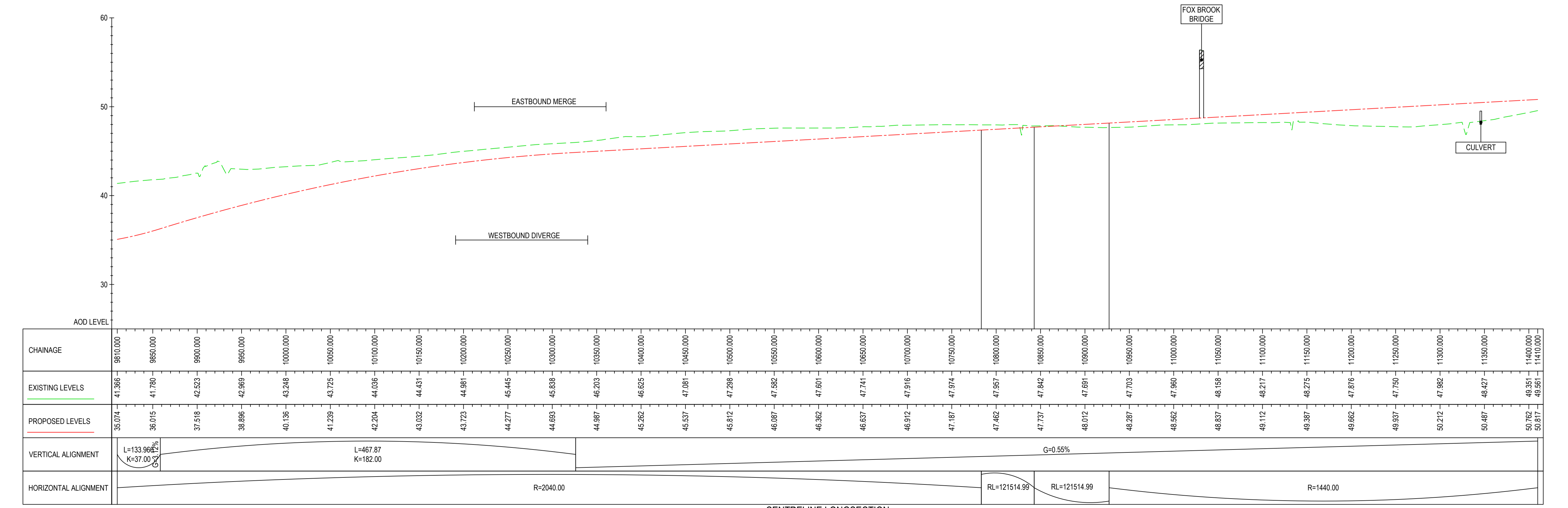

CENTRELINE LONGSECTION  
SCALE: H 1:2500, V 1:250

For Statutory Consultation	JMW	22/05/19	P01
Revision Details	By	Date	Suffix
	Check		

Purpose of issue  
**FOR INFORMATION**

Client  
Highways England  
Woodlands  
Manton Lane  
Bedford  
MK41 7LW



Project Title  
**A428 BLACK CAT TO CAXTON GIBBET IMPROVEMENTS**

Drawing Title  
**PLAN AND PROFILE SHEET 7 OF 12**

Designed JMW	Drawn JMW	Checked PS	Approved TD	Date 22/05/19
Internal Project No. 60541541	Subsidiary S2		Zone General	

THIS DOCUMENT HAS BEEN PREPARED PURSUANT TO AND SUBJECT TO THE TERMS OF AECOM'S APPOINTMENT BY ITS CLIENT. AECOM ACCEPTS NO LIABILITY FOR ANY USE OF THIS DOCUMENT OTHER THAN BY ITS ORIGINAL CLIENT OR FOLLOWING AECOM'S EXPRESS AGREEMENT TO SUCH USE, AND ONLY FOR THE PURPOSES FOR WHICH IT WAS PREPARED AND PROVIDED.

Drawing Number HE551495 -ACM -HML - GEN_ML_Z_ZZ -DR -CH-0007	Location I Type I Role I Number	Rev P01
--	------------------------------------	------------

File Name: C:\P\WORKING\AECOM\_EIA\WILSON\10052071HE551495-ACM-HML\_GEN\_ML\_Z\_ZZ-DR-CH-0007  
 Plot Date: 22 May 2019 15:15:51  
 File Name: C:\P\WORKING\AECOM\_EIA\WILSON\10052071HE551495-ACM-HML\_GEN\_ML\_Z\_ZZ-DR-CH-0007



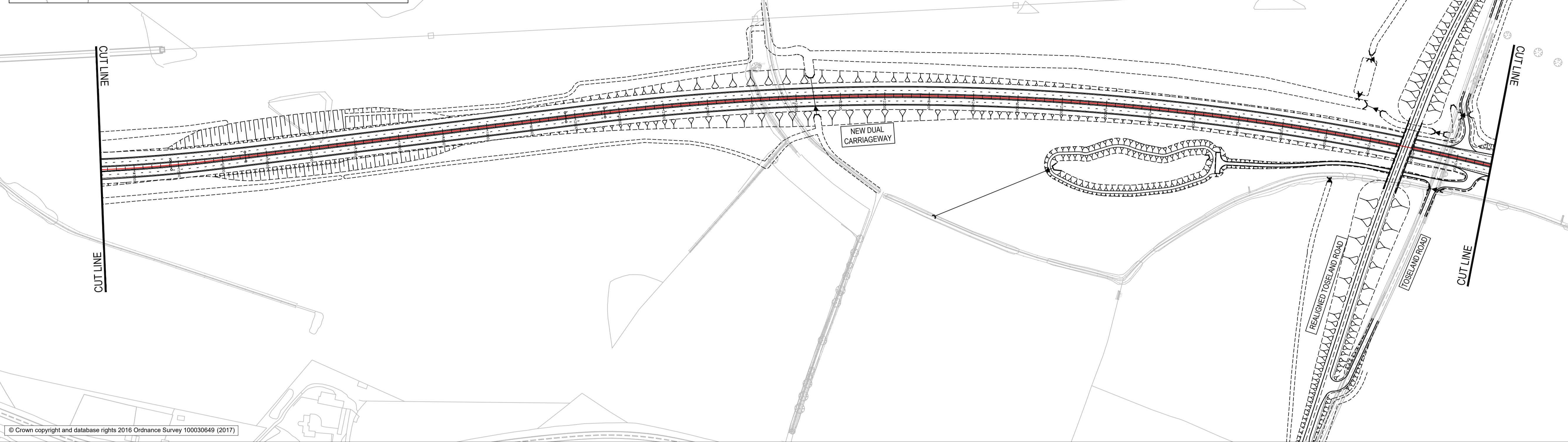

© Crown copyright and database rights 2016 Ordnance Survey 100030649 (2017)

- NOTES**
- DO NOT SCALE FROM THIS DRAWING, USE ONLY PRINTED DIMENSIONS.
  - ALL DIMENSIONS, CHAINAGES, LEVELS AND COORDINATES ARE IN METRES UNLESS DEFINED OTHERWISE.
- KEY**
- FINISHED ROAD LEVEL AT CENTRELINE OF NEW ROAD
  - - - TOPOGRAPHICAL SURVEY (EXISTING GROUND)
  - BRIDGE
  - CULVERT
  - - - DITCH

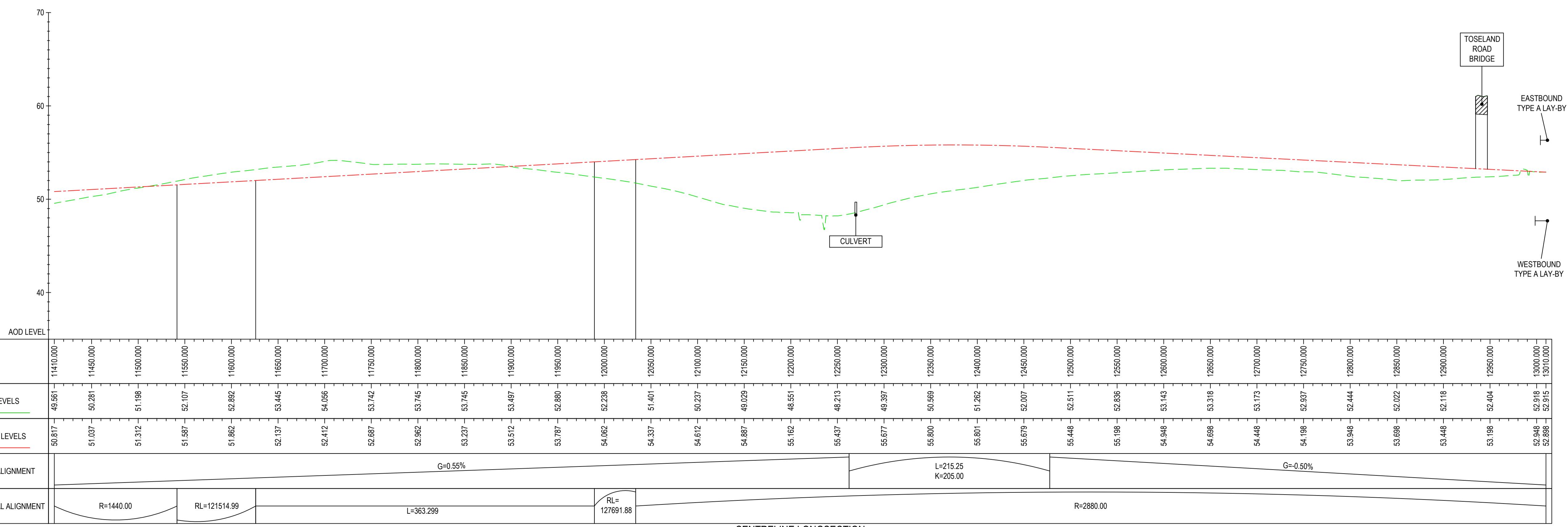

CENTRELINE LONGSECTION  
SCALE: H 1:2500, V 1:250

For Statutory Consultation	JMW	22/05/19	P01
Revision Details	By	Date	Suffix
	Check		

Purpose of issue  
**FOR INFORMATION**

Client  
Highways England  
Woodlands  
Manton Lane  
Manton Industrial Estate  
Bedford  
MK41 7LW

Working on behalf of  
**highways england**

Project Title  
**A428 BLACK CAT TO CAXTON GIBBET IMPROVEMENTS**

Drawing Title  
**PLAN AND PROFILE SHEET 8 OF 12**

Designed JMW	Drawn JMW	Checked PS	Approved TD	Date 22/05/19
Internal Project No. 60541541	Subsidiary S2	Scale @ A1 Zone General		

THIS DOCUMENT HAS BEEN PREPARED PURSUANT TO AND SUBJECT TO THE TERMS OF AECOM'S APPOINTMENT BY ITS CLIENT. AECOM ACCEPTS NO LIABILITY FOR ANY USE OF THIS DOCUMENT OTHER THAN BY ITS ORIGINAL CLIENT OR FOLLOWING AECOM'S EXPRESS AGREEMENT TO SUCH USE, AND ONLY FOR THE PURPOSES FOR WHICH IT WAS PREPARED AND PROVIDED.

Drawing Number HE551495 - ACM - HML - GEN_ML_Z_ZZ - DR-CH-0008	1 Originator	1 Volume	Rev P01
Location	I Type	I Role	I Number

Proj Name: C:\P\00000000\GEN\_ML\_Z\_ZZ\DR-CH-0008  
 File Name: C:\P\00000000\GEN\_ML\_Z\_ZZ\DR-CH-0008  
 Rev: 01  
 Date: 22/05/19  
 Scale: A1  
 Zone: General



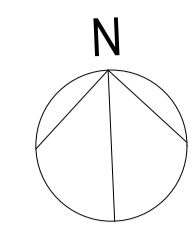

- NOTES**
- DO NOT SCALE FROM THIS DRAWING, USE ONLY PRINTED DIMENSIONS.
  - ALL DIMENSIONS, CHAINAGES, LEVELS AND COORDINATES ARE IN METRES UNLESS DEFINED OTHERWISE.

- KEY**
- FINISHED ROAD LEVEL AT CENTRELINE OF NEW ROAD
  - - - TOPOGRAPHICAL SURVEY (EXISTING GROUND)
  - BRIDGE
  - CULVERT
  - - - - DITCH



© Crown copyright and database rights 2016 Ordnance Survey 100030649 (2017)

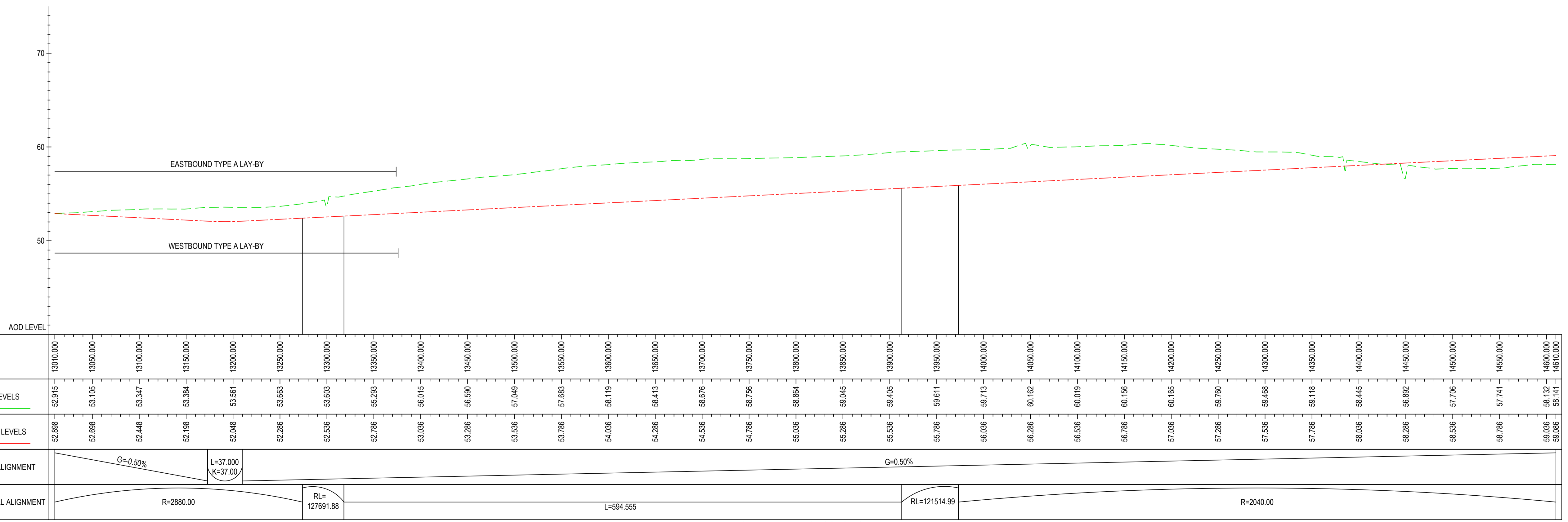

CENTRELINE LONGSECTION  
SCALE: H 1:2500, V 1:250

For Statutory Consultation	JMW	22/05/19	P01
Revision Details	By TD	Date	Suffix
Purpose of issue	Check		

**FOR INFORMATION**

Client  
Highways England  
Woodlands  
Manton Lane  
Manton Industrial Estate  
Bedford  
MK41 7LW



**A428 BLACK CAT TO  
CAXTON GIBBET  
IMPROVEMENTS**

**PLAN AND PROFILE  
SHEET 9 OF 12**

Designed JMW	Drawn JMW	Checked PS	Approved TD	Date 22/05/19
Internal Project No. 60541541	Suitability S2	Zone General		

THIS DOCUMENT HAS BEEN PREPARED PURSUANT TO AND SUBJECT TO THE TERMS OF AECOM'S APPOINTMENT BY ITS CLIENT. AECOM ACCEPTS NO LIABILITY FOR ANY USE OF THIS DOCUMENT OTHER THAN BY ITS ORIGINAL CLIENT OR FOLLOWING AECOM'S EXPRESS AGREEMENT TO SUCH USE, AND ONLY FOR THE PURPOSES FOR WHICH IT WAS PREPARED AND PROVIDED.

Drawing Number HE551495 -ACM -HML - GEN_ML_Z_ZZ -DR -CH-0009	Location	1 Originator 1 Volume 1 Number	Rev P01
--	----------	--------------------------------------	------------

File Name: C:\P\WORKING\AECOM\_EIA\WORKING\03052017\HE551495-ACM-HML\_GEN\_ML\_Z\_ZZ-DR-CH-0009  
 Plot Date: 22 May 2019 11:11:15



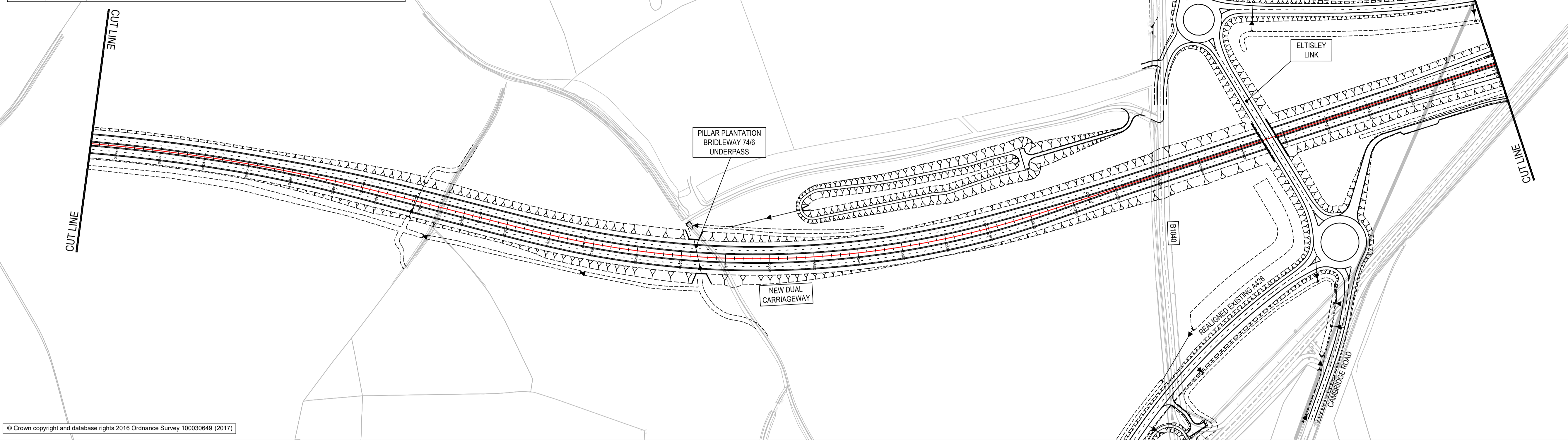

© Crown copyright and database rights 2016 Ordnance Survey 100030649 (2017)

- NOTES**
- DO NOT SCALE FROM THIS DRAWING, USE ONLY PRINTED DIMENSIONS.
  - ALL DIMENSIONS, CHAINAGES, LEVELS AND COORDINATES ARE IN METRES UNLESS DEFINED OTHERWISE.
- KEY**
- FINISHED ROAD LEVEL AT CENTRELINE OF NEW ROAD
  - TOPOGRAPHICAL SURVEY (EXISTING GROUND)
  - BRIDGE
  - CULVERT
  - DITCH

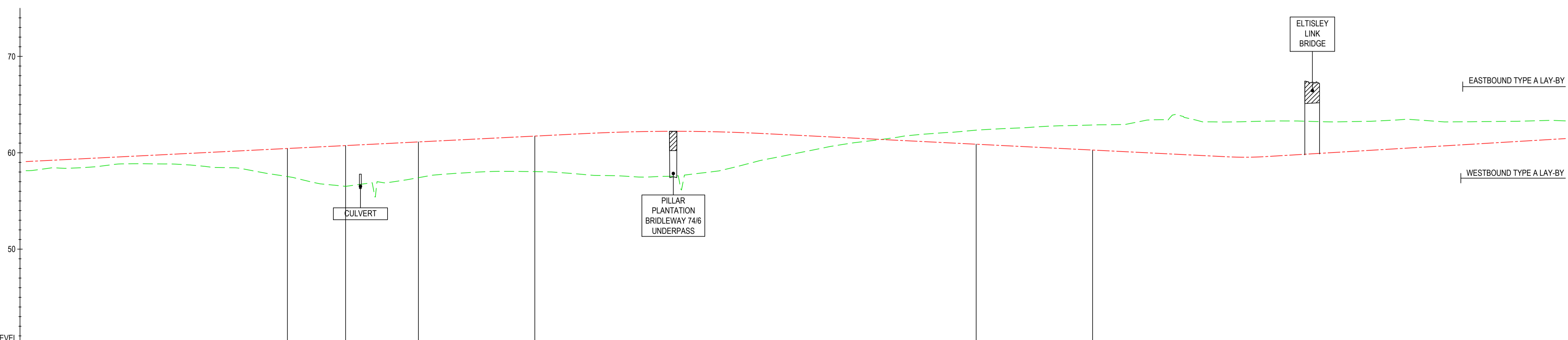

CHAINAGE	EXISTING LEVELS	PROPOSED LEVELS	VERTICAL ALIGNMENT	HORIZONTAL ALIGNMENT
14610.000	58.141	59.086	G=0.50%	R=2040.00
14650.000	58.384	59.286		
14700.000	58.766	59.536	L=121514.99	L=75.634
14750.000	58.843	59.786		
14800.000	58.555	60.036	R=121514.99	R=1020.00
14850.000	58.063	60.286		
14900.000	57.129	60.536	L=182.00 K=182.00	R=121514.99
14950.000	56.622	60.786		
15000.000	57.112	61.036	G=0.50%	R=1020.00
15050.000	57.815	61.286		
15100.000	58.070	61.536	L=40.700 K=37.00	R=121514.99
15150.000	58.022	61.786		
15200.000	57.663	62.034	G=0.60%	L=1513.992
15250.000	57.477	62.196		
15300.000	57.753	62.220		
15350.000	58.591	62.101		
15400.000	59.725	61.874		
15450.000	60.779	61.624		
15500.000	61.391	61.374		
15550.000	61.978	61.124		
15600.000	62.364	60.874		
15650.000	62.611	60.624		
15700.000	62.830	60.374		
15750.000	62.929	60.124		
15800.000	63.757	59.874		
15850.000	63.198	59.624		
15900.000	63.284	59.611		
15950.000	63.241	59.911		
16000.000	63.255	60.211		
16050.000	63.448	60.511		
16100.000	63.214	60.811		
16150.000	63.258	61.111		
16200.000	63.346	61.411		
16210.000	63.309	61.477		

CENTRELINE LONGSECTION  
SCALE: H 1:2500, V 1:250

For Statutory Consultation	JMW	22/05/19	PO1
Revision Details	By	Date	Suffix
	Check		

Purpose of issue  
**FOR INFORMATION**

Client  
Highways England  
Woodlands  
Manton Lane  
Manton Industrial Estate  
Bedford  
MK41 7LW

Project Title  
**A428 BLACK CAT TO CAXTON GIBBET IMPROVEMENTS**

Drawing Title  
**PLAN AND PROFILE SHEET 10 OF 12**

Designed	Drawn	Checked	Approved	Date
JMW	JMW	PS	TD	22/05/19

Internal Project No.  
60541541

Scale @ A1  
---

Suitability  
S2

Zone  
General

THIS DOCUMENT HAS BEEN PREPARED PURSUANT TO AND SUBJECT TO THE TERMS OF AECOM'S APPOINTMENT BY ITS CLIENT. AECOM ACCEPTS NO LIABILITY FOR ANY USE OF THIS DOCUMENT OTHER THAN BY ITS ORIGINAL CLIENT OR FOLLOWING AECOM'S EXPRESS AGREEMENT TO SUCH USE, AND ONLY FOR THE PURPOSES FOR WHICH IT WAS PREPARED AND PROVIDED.

Drawing Number HE551495 -ACM -HML - GEN_ML_Z_ZZ -DR -CH-0010	Location	1 Originator	1 Volume	Rev P01
--	----------	--------------	----------	------------

File Name: C:\P\WORKING\AECOM\_E\A\ML\SON\10052071HE551495-ACM-HML\_GEN\_ML\_Z\_ZZ-DR-CH-0010  
 Plot Date: 22 May 2019 11:28:23



- NOTES**
- DO NOT SCALE FROM THIS DRAWING, USE ONLY PRINTED DIMENSIONS.
  - ALL DIMENSIONS, CHAINAGES, LEVELS AND COORDINATES ARE IN METRES UNLESS DEFINED OTHERWISE.

- KEY**
- FINISHED ROAD LEVEL AT CENTRELINE OF NEW ROAD
  - TOPOGRAPHICAL SURVEY (EXISTING GROUND)
  - BRIDGE
  - CULVERT
  - DITCH

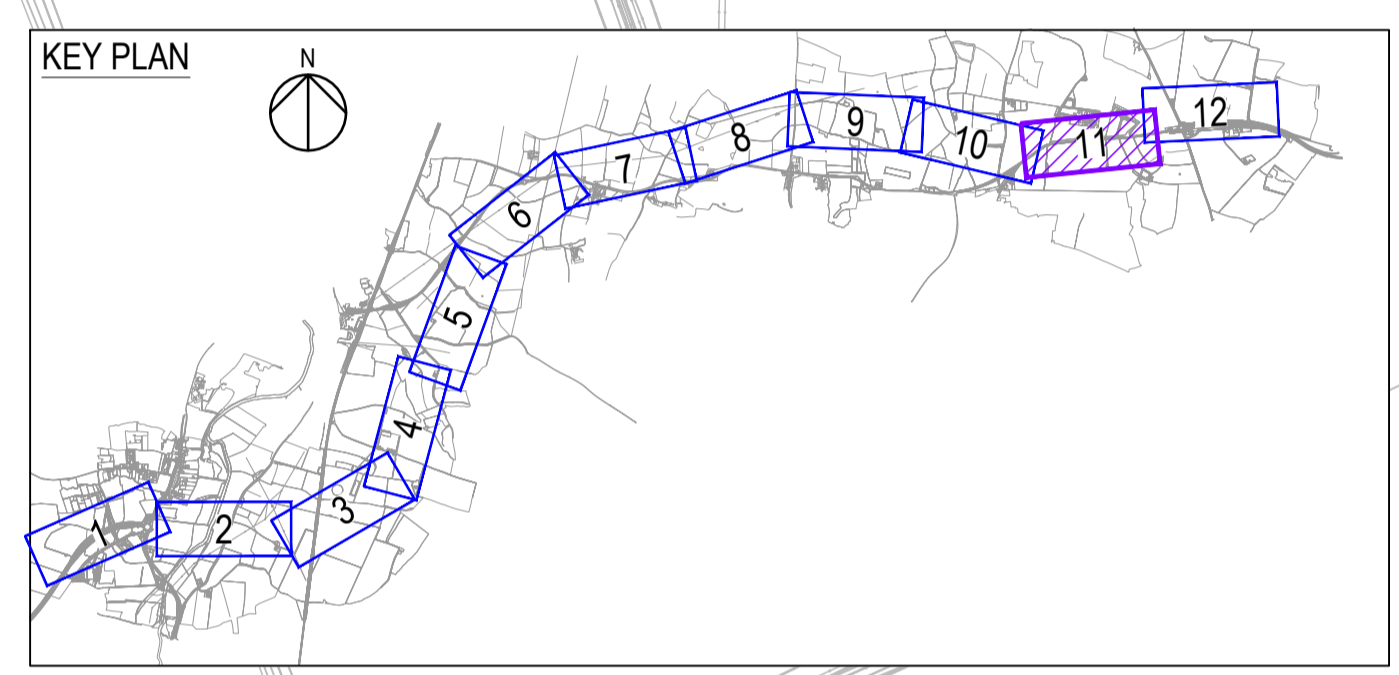
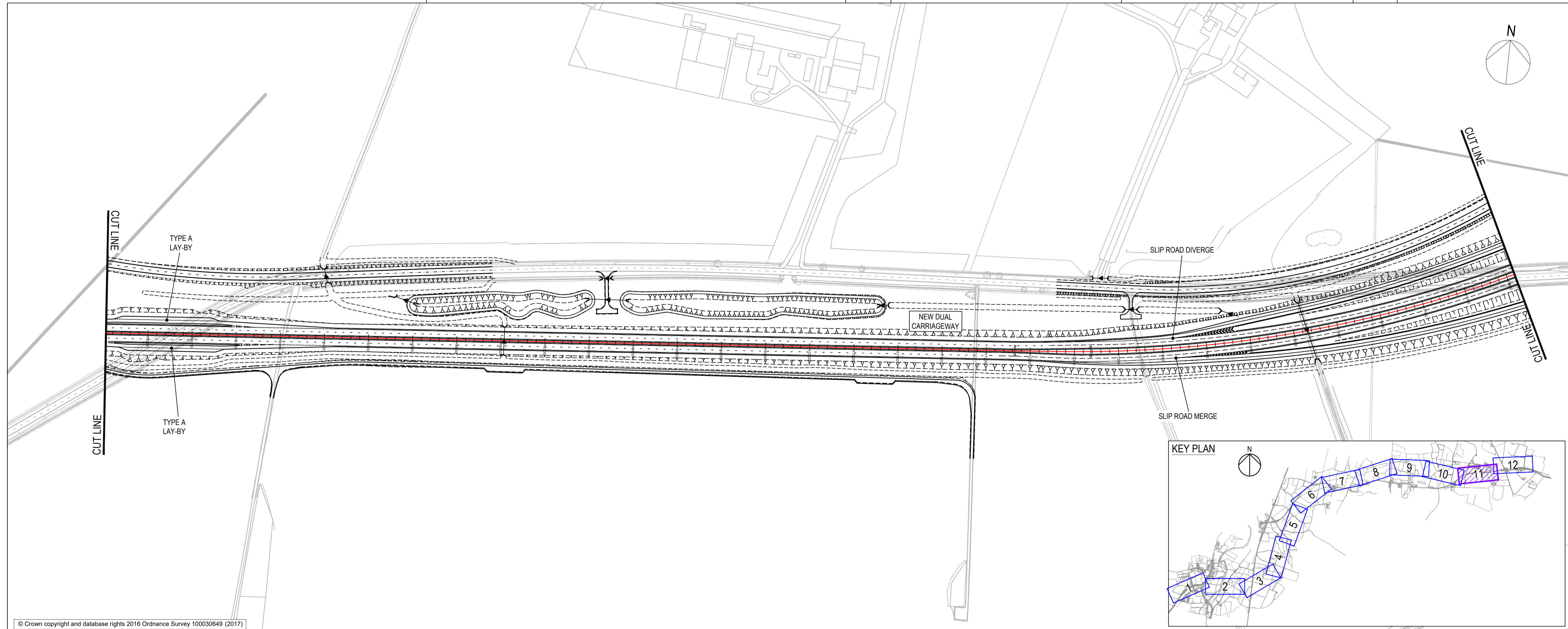

© Crown copyright and database rights 2016 Ordnance Survey 100030649 (2017)

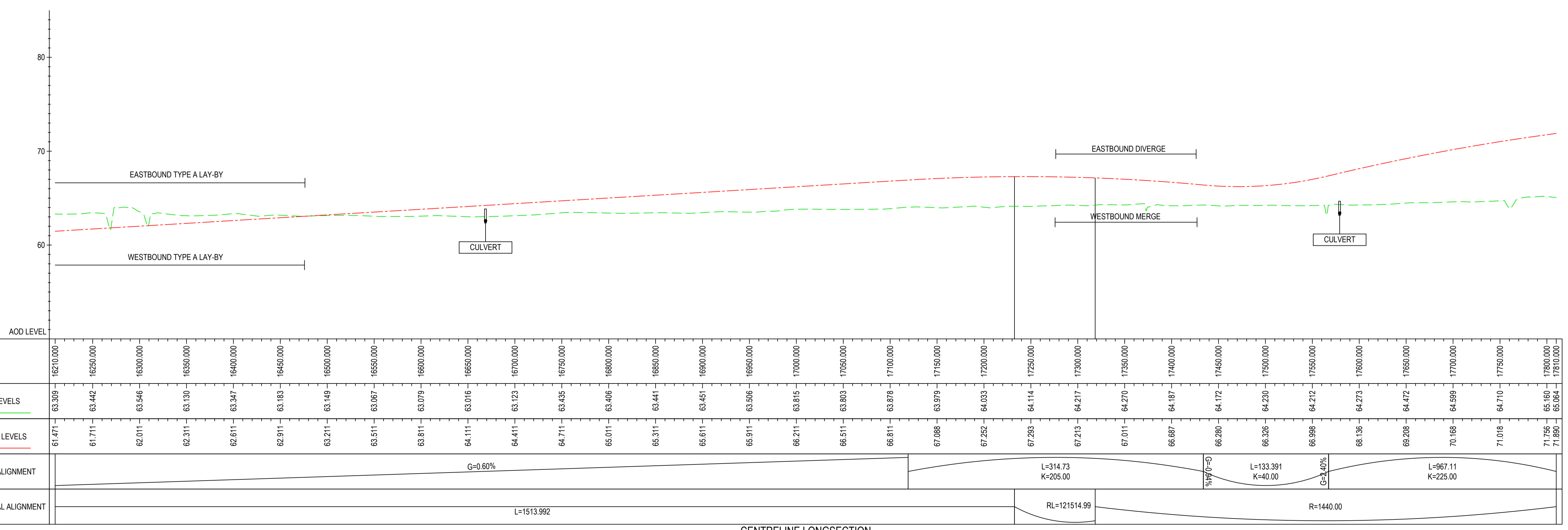

CENTRELINE LONGSECTION  
SCALE: H 1:2500, V 1:250

For Statutory Consultation	JMW	22/05/19	P01
Revision Details	By	Date	Suffix
	Check		

Purpose of issue  
**FOR INFORMATION**

Client  
Highways England  
Woodlands  
Manton Lane  
Bedford  
MK41 7LW



Project Title  
**A428 BLACK CAT TO CAXTON GIBBET IMPROVEMENTS**

Drawing Title  
**PLAN AND PROFILE SHEET 11 OF 12**

Designed JMW	Drawn JMW	Checked PS	Approved TD	Date 22/05/19
Internal Project No. 60541541		Subsidiary S2		
Scale @ A1 ---		Zone General		

THIS DOCUMENT HAS BEEN PREPARED PURSUANT TO AND SUBJECT TO THE TERMS OF AECOM'S APPOINTMENT BY ITS CLIENT. AECOM ACCEPTS NO LIABILITY FOR ANY USE OF THIS DOCUMENT OTHER THAN BY ITS ORIGINAL CLIENT OR FOLLOWING AECOM'S EXPRESS AGREEMENT TO SUCH USE, AND ONLY FOR THE PURPOSES FOR WHICH IT WAS PREPARED AND PROVIDED.

Drawing Number HE551495 - ACM - HML - GEN_ML_Z_ZZ - DR - CH-0011	1 Originator	1 Volume	Rev P01
Location	I Type	I Role	I Number

File Name: C:\P\WORKING\AECOM\_E\A\ML\SON\10052071HE551495-ACM-HML\_GEN\_ML\_Z\_ZZ-DR-CH-0011  
 File Date: 21 May 2019 15:55:51



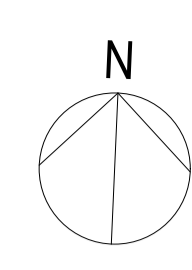
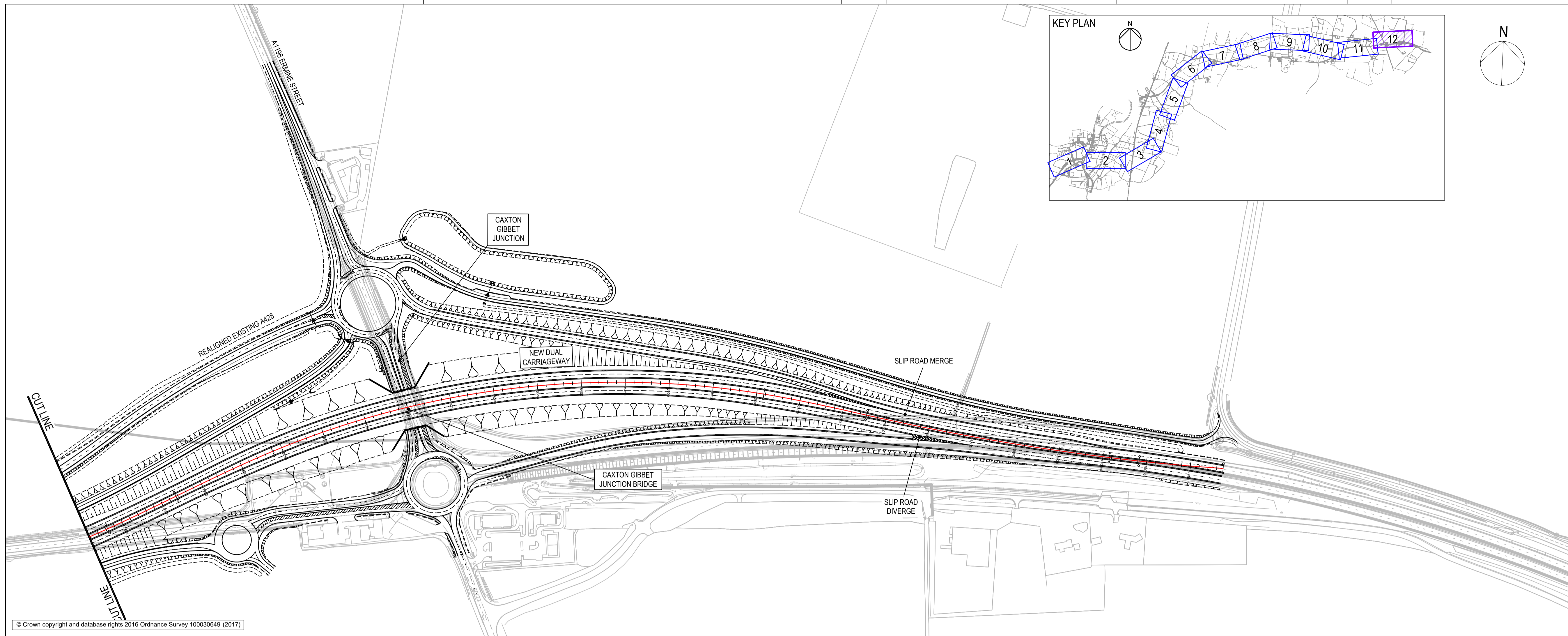

- NOTES**
- DO NOT SCALE FROM THIS DRAWING, USE ONLY PRINTED DIMENSIONS.
  - ALL DIMENSIONS, CHAINAGES, LEVELS AND COORDINATES ARE IN METRES UNLESS DEFINED OTHERWISE.

- KEY**
- FINISHED ROAD LEVEL AT CENTRELINE OF NEW ROAD
  - - - TOPOGRAPHICAL SURVEY (EXISTING GROUND)
  - BRIDGE
  - CULVERT
  - - - - - DITCH

© Crown copyright and database rights 2016 Ordnance Survey 100030649 (2017)

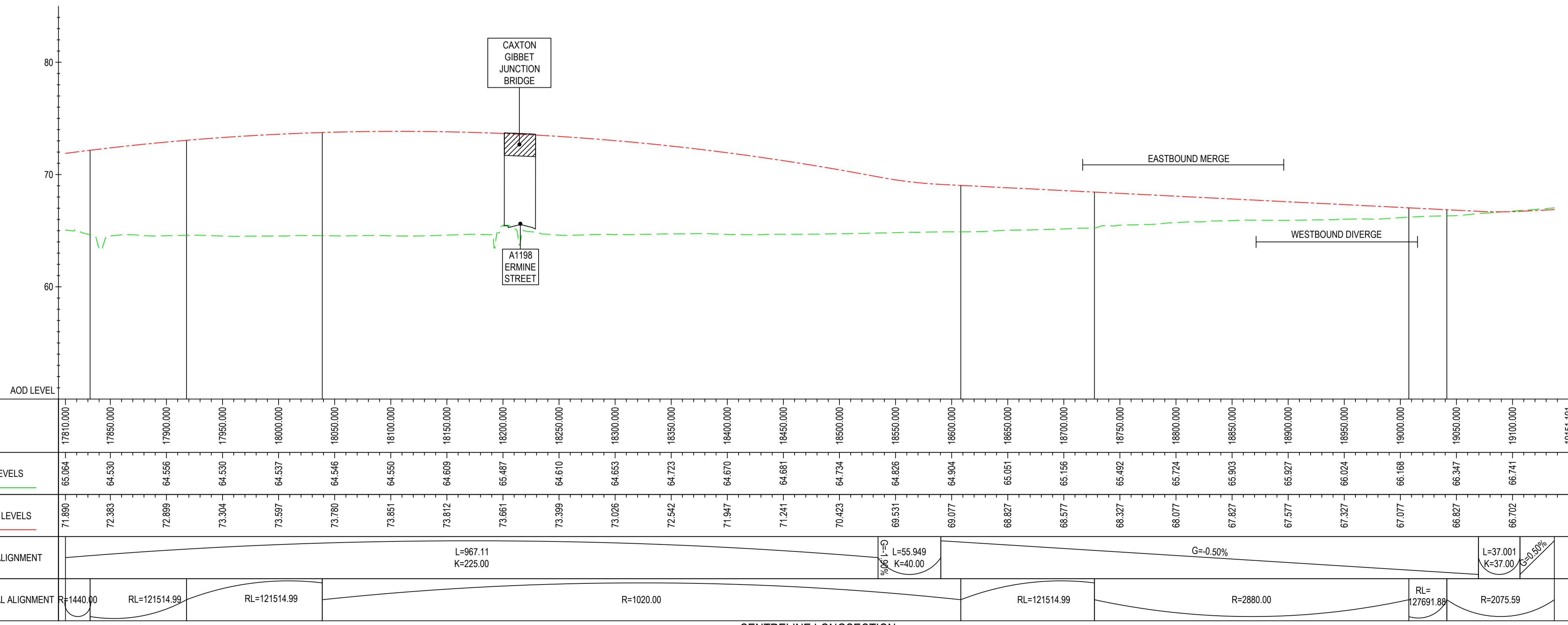

CHAINAGE	EXISTING LEVELS	PROPOSED LEVELS	VERTICAL ALIGNMENT	HORIZONTAL ALIGNMENT
17810.00	65.064	71.890		R=1440.00
17850.00	64.530	72.385		RL=121514.99
17900.00	64.556	72.899		RL=121514.99
17950.00	64.530	73.304		
18000.00	64.537	73.597		
18050.00	64.546	73.789		
18100.00	64.550	73.851		
18150.00	64.609	73.812	L=967.11 K=225.00	
18200.00	65.487	73.661		
18250.00	64.610	73.398	L=55.949 K=40.00	
18300.00	64.653	73.026		R=1020.00
18350.00	64.723	72.542		
18400.00	64.670	71.941		
18450.00	64.681	71.241		
18500.00	64.724	70.423		
18550.00	64.826	69.533		
18600.00	64.904	69.077		
18650.00	65.051	68.827		
18700.00	65.156	68.577		
18750.00	65.492	68.327		RL=121514.99
18800.00	65.724	68.077		R=2880.00
18850.00	65.903	67.827		
18900.00	65.927	67.577		
18950.00	66.024	67.327		
19000.00	66.168	67.077		RL=27691.88
19050.00	66.347	66.827		R=2075.59
19100.00	66.741	66.702		
19151.191				

CENTRELINE LONGSECTION  
SCALE: H 1:2500, V 1:250

For Statutory Consultation	JMW	22/05/19	P01
Revision Details	By	Date	Suffix
	Check		

**FOR INFORMATION**

Client  
Highways England  
Woodlands  
Manton Lane  
Manton Industrial Estate  
Bedford  
MK41 7LW

Working on behalf of  
**highways england**

**A428 BLACK CAT TO  
CAXTON GIBBET  
IMPROVEMENTS**

**PLAN AND PROFILE  
SHEET 12 OF 12**

Designed JMW	Drawn JMW	Checked PS	Approved TD	Date 22/05/19
Internal Project No. 60541541	Subsidiary S2	Scale @ A1 General		

THIS DOCUMENT HAS BEEN PREPARED PURSUANT TO AND SUBJECT TO THE TERMS OF AECOM'S APPOINTMENT BY ITS CLIENT. AECOM ACCEPTS NO LIABILITY FOR ANY USE OF THIS DOCUMENT OTHER THAN BY ITS ORIGINAL CLIENT OR FOLLOWING AECOM'S EXPRESS AGREEMENT TO SUCH USE, AND ONLY FOR THE PURPOSES FOR WHICH IT WAS PREPARED AND PROVIDED.

Drawing Number HE551495 -ACM -HML - GEN_ML_Z_ZZ -DR-CH-0012	1 Originator 1 Volume 1 Type 1 Role 1 Number	Rev P01
---	--	------------



File Name: C:\P\WORKING\AECOM\_E\A\W\50\1\0352071\HE551495-ACM-HML\_GEN\_ML\_Z\_ZZ-DR-CH-0012  
 Plot Date: 22 May 2019 15:11:25



NOTES

- DO NOT SCALE FROM THIS DRAWING, USE ONLY PRINTED DIMENSIONS.
- ALL DIMENSIONS, CHAINAGES, LEVELS AND COORDINATES ARE IN METRES UNLESS DEFINED OTHERWISE.

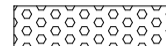
KEY

	CONCRETE
	FILTER DRAINAGE MATERIAL
	FILL MATERIAL
	GRANULAR MATERIAL

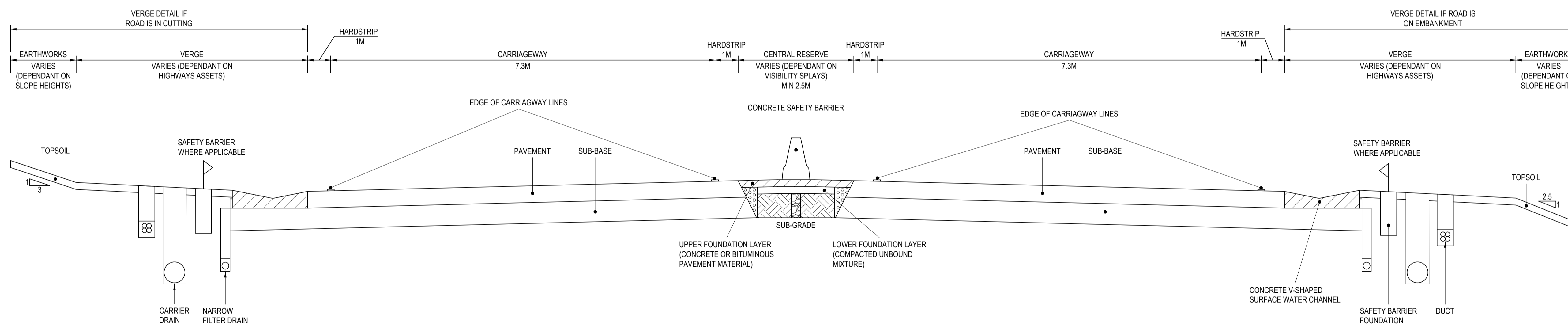

TYPICAL DUAL CARRIAGWAY  
CROSS SECTION  
SCALE 1:50

For Statutory Consultation	JMW	22/05/19	P01
Revision Details	By	Date	Suffix
	Check		

Purpose of issue  
**FOR INFORMATION**

Client  
Highways England  
Woodlands  
Manton Industrial Estate  
Bedford  
MK41 7LW

**Working on behalf of**  

Project Title  
**A428 BLACK CAT TO  
CAXTON GIBBET  
IMPROVEMENTS**

Drawing Title  
**TYPICAL  
DUAL CARRIAGWAY  
CROSS SECTION**

Designed JMW	Drawn JMW	Checked PS	Approved TD	Date 22/05/19
Internal Project No. 60541541			Suitability S2	
Scale @ A1 ---		Zone General		

THIS DOCUMENT HAS BEEN PREPARED PURSUANT TO AND SUBJECT TO THE TERMS OF AECOM'S APPOINTMENT BY ITS CLIENT. AECOM ACCEPTS NO LIABILITY FOR ANY USE OF THIS DOCUMENT OTHER THAN BY ITS ORIGINAL CLIENT OR FOLLOWING AECOM'S EXPRESS AGREEMENT TO SUCH USE, AND ONLY FOR THE PURPOSES FOR WHICH IT WAS PREPARED AND PROVIDED.

Drawing Number Highways England PIN <b>HE551495 -ACM -HML -</b>	1 Originator 1 Volume	Rev <b>P01</b>
GEN_ML_Z_ZZ -DR-CH-0013		
Location	I Type	I Role

P:\01\014\_0119\_05\_05\_17  
 File Name: C:\P\WORKING\AECOM\_EI\WORKING\AECOM\_EI\WORKING\AECOM\_EI\GEN\_ML\_Z\_ZZ-DR-CH-0013

If you need help accessing this or any other Highways England information, please call **0300 123 5000** and we will help you.

© Crown copyright 2019.

You may re-use this information (not including logos) free of charge in any format or medium, under the terms of the Open Government Licence. To view this licence:

visit [www.nationalarchives.gov.uk/doc/open-government-licence/](http://www.nationalarchives.gov.uk/doc/open-government-licence/)

write to the **Information Policy Team, The National Archives, Kew, London TW9 4DU**,  
or email [psi@nationalarchives.gsi.gov.uk](mailto:psi@nationalarchives.gsi.gov.uk)

Mapping (where present): © Crown copyright and database rights 2019 OS 100030649. You are permitted to use this data solely to enable you to respond to, or interact with, the organisation that provided you with the data. You are not permitted to copy, sub-licence, distribute or sell any of this data to third parties in any form.

This document is also available on our website at [www.highwaysengland.co.uk](http://www.highwaysengland.co.uk)

For an accessible version of this publication please call **0300 123 5000** and we will help you.

If you have any enquiries about this publication email [info@highwaysengland.co.uk](mailto:info@highwaysengland.co.uk) or call **0300 123 5000**\*. Please quote the Highways England publications code **PR253/18**.

Highways England creative job number BED19 0095

\*Calls to 03 numbers cost no more than a national rate call to an 01 or 02 number and must count towards any inclusive minutes in the same way as 01 and 02 calls.

These rules apply to calls from any type of line including mobile, BT, other fixed line or payphone. Calls may be recorded or monitored.

Printed on paper from well-managed forests and other controlled sources when issued directly by Highways England.

Registered office Bridge House, 1 Walnut Tree Close, Guildford GU1 4LZ

Highways England Company Limited registered in England and Wales number 09346363