

A1 Birtley to Coal House

Scheme Number: TR010031

Applicant's Responses to ExA's Second Written Questions - Appendix 2.8B - Agricultural Land Plans

Planning Act 2008

Rule 8(1)(b)

Infrastructure Planning (Examination Procedure Rules) 2010



Infrastructure Planning

Planning Act 2008

**The Infrastructure Planning
(Examination Procedure Rules)
2010**

A1 Birtley to Coal House
Development Consent Order 20[xx]

**Applicant's Response to ExA's Second Written
Questions - Appendix 2.8B - Agricultural Land
Plans**

Rule number:	Rule 8(1)(b)
Planning Inspectorate Scheme Reference	TR010031
Application Document Reference	EXA/D4/034
Author:	A1 Birtley to Coal House Project Team, Highways England

Version	Date	Status of Version
Rev 0	20 April 2020	Application Issue

JUNCTION 68 - LOBLEY HILL



NOTES:

1. All dimensions are in metres unless stated otherwise.

KEY:

Order Limits

Agricultural Exercise

- A
- B
- C
- D
- E
- Dunkirk Farm
- Long Acre Farm
- Northside Farm
- Additional Land
- Land Excluded from Agricultural Assessment
- Local Authority Boundary



SCALE 1:2500

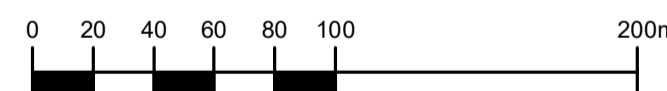

0	01/04/2020	FINAL	BS	CVM	SC	CB
Rev	Date	Description	By	Eng Chk	Disc App'd	App'd
Sustainability						S0

PINS Reference Number



Client: A1 Birtley to Coal House

Drawing Title: AGRICULTURAL LAND PLAN SHEET 1 OF 5

Scale	1:2,500	Drawn	BS	Checked	CVM	Approved	SC	Authorised	NR
Original Size	A1	Date	01/04/2020	Date	01/04/2020	Date	01/04/2020	Date	01/04/2020
Drawing Number	HE551462	Originator	WSP	Volume	LSI	Revision	P00		
ZZ Section	Type	ID	Direction	Type	Role	Number	PW Stage Code		
			X	DR	ZL	31631	4		

NOTES:

1. All dimensions are in metres unless stated otherwise.

KEY:

- Order Limits

- Agricultural Exercise**
- A
- B
- C
- D
- E
- Dunkirk Farm
- Long Acre Farm
- Northside Farm
- Additional Land

- Land Excluded from Agricultural Assessment

- Local Authority Boundary

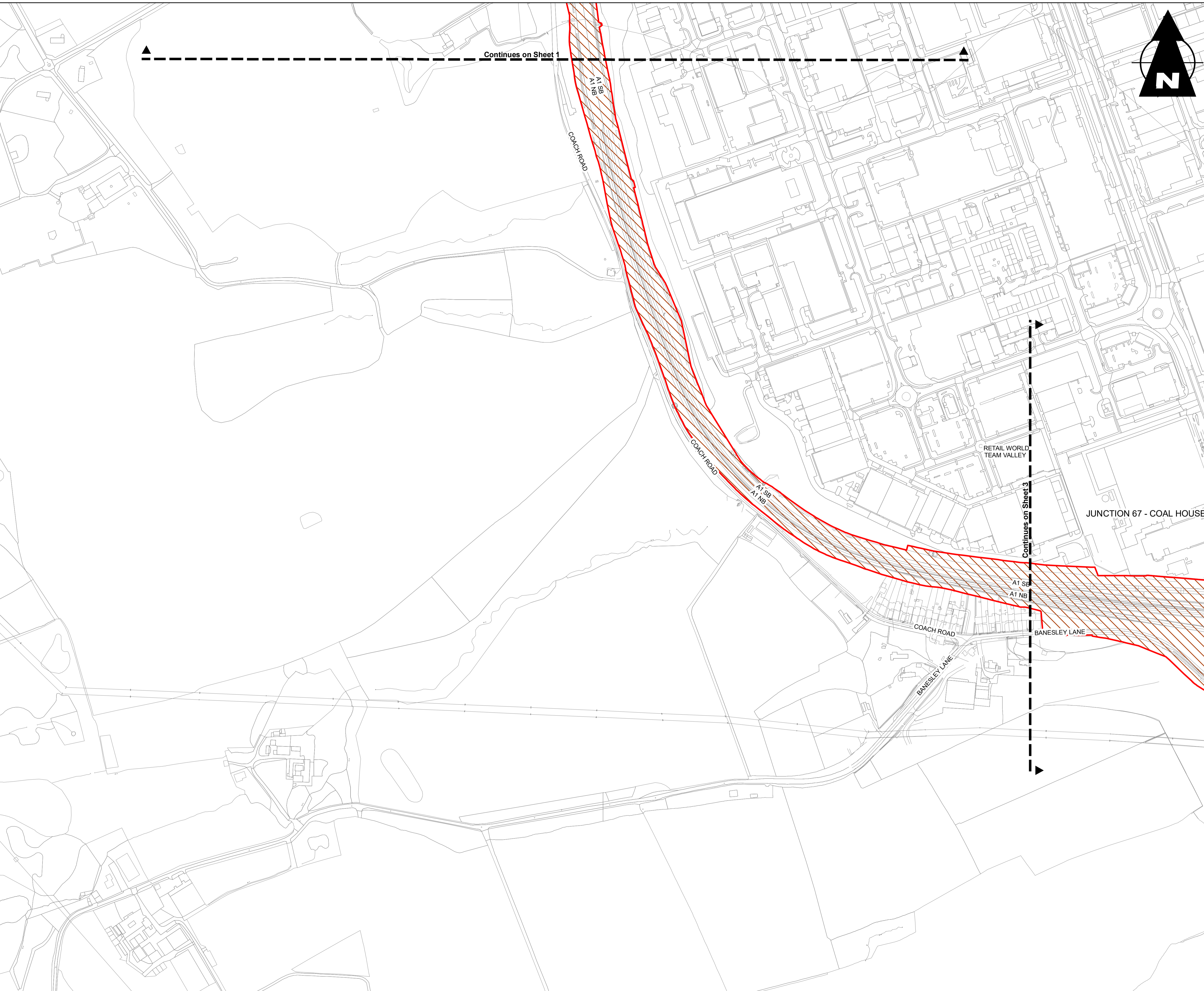
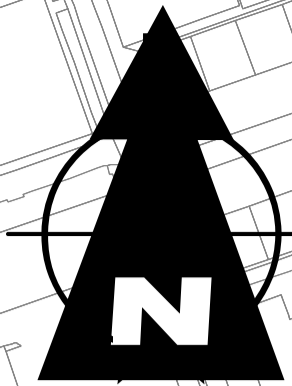

Continues on Sheet 1

Continues on Sheet 3

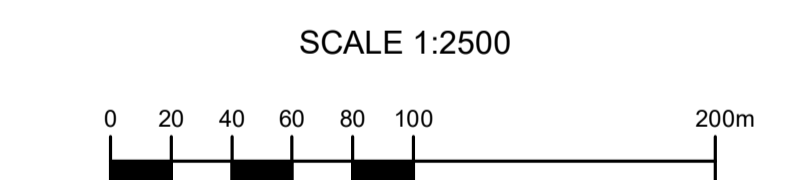

0	01/04/2020	FINAL	BS	CVM	SC	CB
Rev	Date	Description	By	Eng Chk	Disc Chk	App'd
Sustainability						S0

PINS Reference Number



Client: A1 Birtley to Coal House

Drawing Title: AGRICULTURAL LAND PLAN SHEET 2 OF 5

Scale	1:2,500	Drawn	BS	Checked	CVM	Approved	SC	Authorised	NR
Original Site	A1	Date	01/04/2020	Date	01/04/2020	Date	01/04/2020	Date	01/04/2020
Drawing Number	HE PN	Originator	WSP	Volume	LSI	Revision	P00		
ZZ	Section	Type	X	DR	ZL	31632	PW Stage Code 4		









NOTES:

1. All dimensions are in metres unless stated otherwise.

KEY:

 Order Limits

Agricultural Exercise

-  A
-  B
-  C
-  D
-  E
-  Dunkirk Farm
-  Long Acre Farm
-  Northside Farm
-  Additional Land
-  Land Excluded from Agricultural Assessment
-  Local Authority Boundary

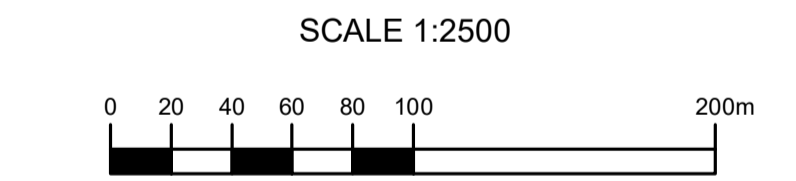
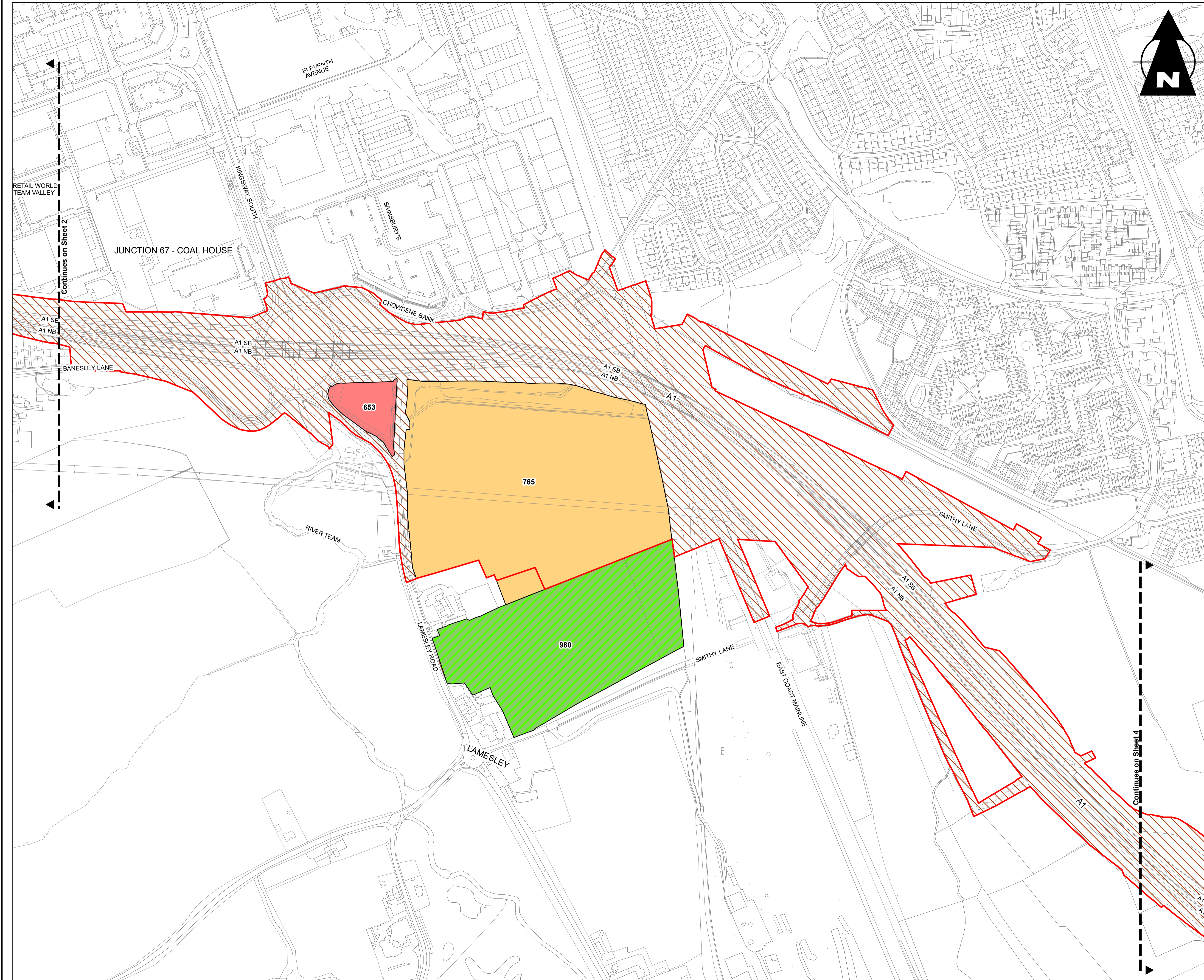

Rev	Date	Description	By	Eng Chk	Disc App'd
0	01/04/2020	FINAL	BS	CVM	SC CB
Suitability					S0

PINS Reference Number



Client
A1 Birtley to Coal House

Drawing Title
AGRICULTURAL LAND PLAN
SHEET 3 OF 5

Scale	1:2,500	Drawn	BS	Checked	CVM	Approved	SC	Authorised	NR
Original Site	A1	Date	01/04/2020	Date	01/04/2020	Date	01/04/2020	Date	01/04/2020
Drawing Number	HE551462	Originator	WSP	Volume	LSI	Revision	P00		
ZZ	Section	Type	ID	Direction	Type	Role	Number	PW Stage Code	
				X	DR	ZL	31633	4	

NOTES:

1. All dimensions are in metres unless stated otherwise.

KEY:

Order Limits

Agricultural Exercise

- A
- B
- C
- D
- E

- Dunkirk Farm
- Long Acre Farm
- Northside Farm
- Additional Land

Land Excluded from Agricultural Assessment

Local Authority Boundary

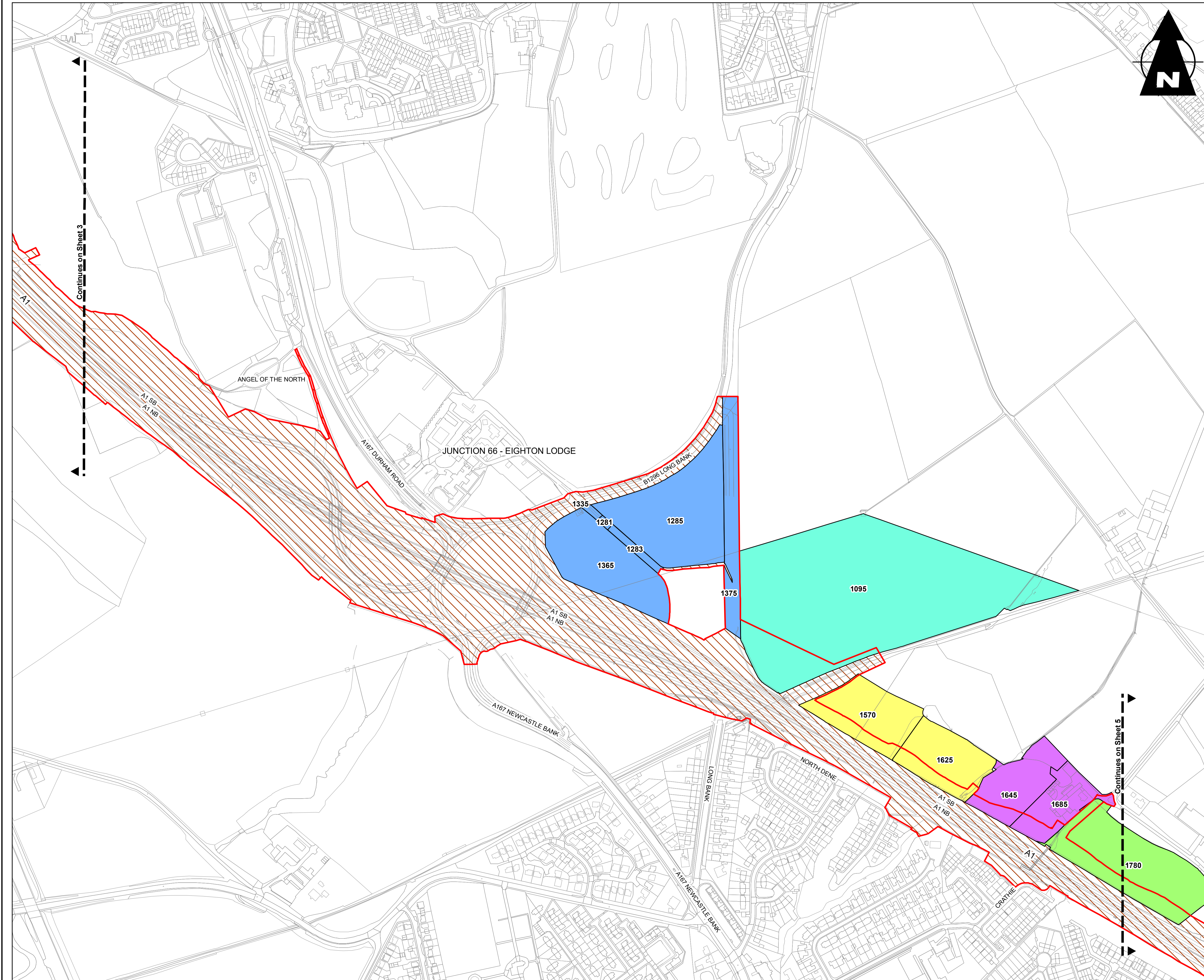

Continues on Sheet 3

Continues on Sheet 5

SCALE 1:2500

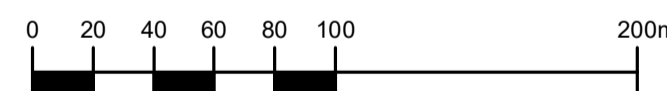

0	01/04/2020	FINAL	BS	CVM	SC	CB
Rev	Date	Description	By	Eng Chk	Disc App'd	
Sustainability						S0

PINS Reference Number



Client

A1 Birtley to Coal House

AGRICULTURAL LAND PLAN SHEET 4 OF 5

Scale	1:2,500	Drawn	BS	Checked	CVM	Approved	SC	Authorised	NR
Original Size	A1	Date	01/04/2020	Date	01/04/2020	Date	01/04/2020	Date	01/04/2020
Drawing Number	HE551462	Originator	WSP	Volume	LSI	Revision	P00		
Section	ZZ	Type	X	DR	ZL	31634	PW Stage Code 4		

NOTES:

1. All dimensions are in metres unless stated otherwise.

KEY:

- Order Limits

- Agricultural Exercise**
- A
- B
- C
- D
- E
- Dunkirk Farm
- Long Acre Farm
- Northside Farm
- Additional Land

- Land Excluded from Agricultural Assessment

- Local Authority Boundary

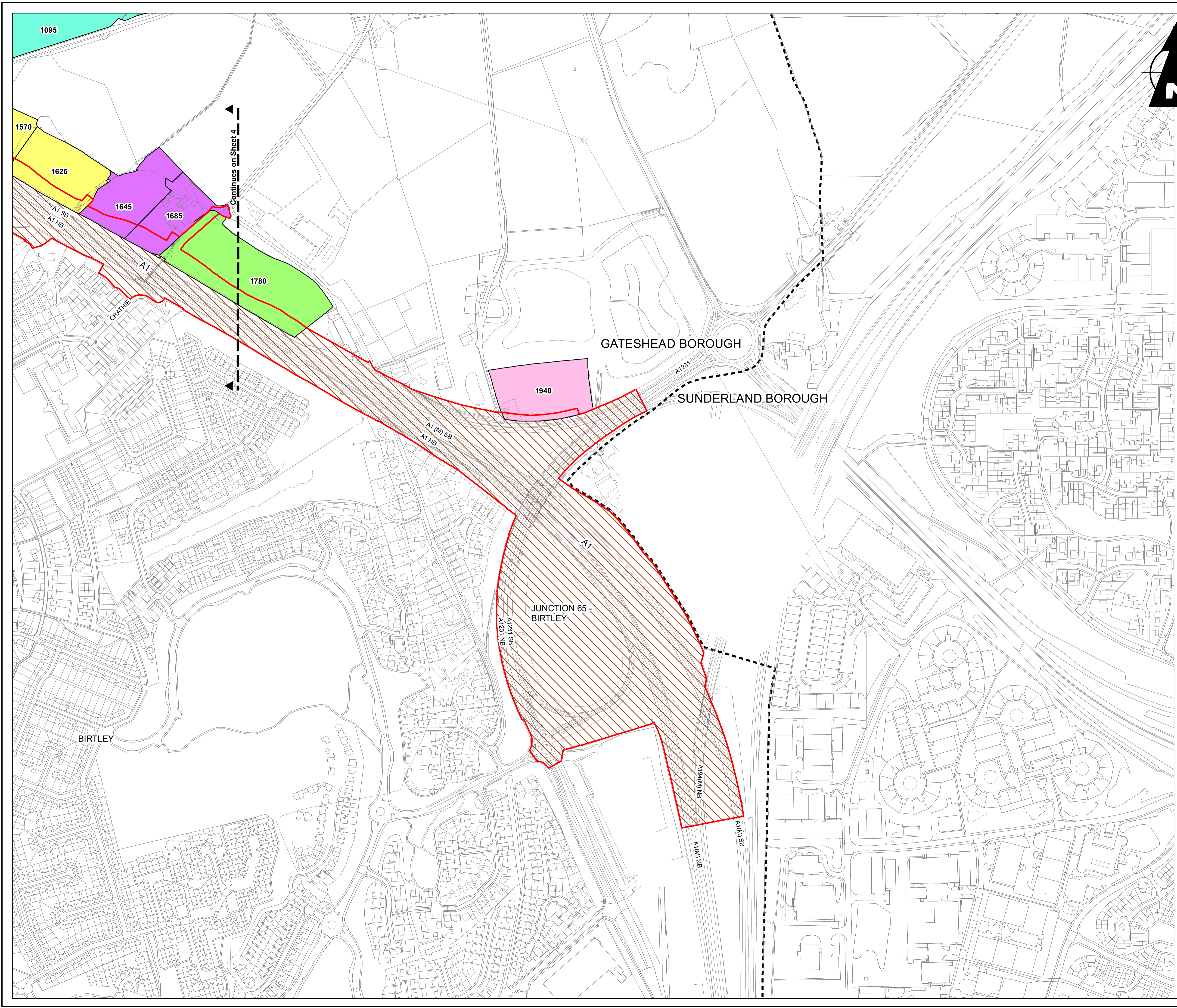

SCALE 1:2500

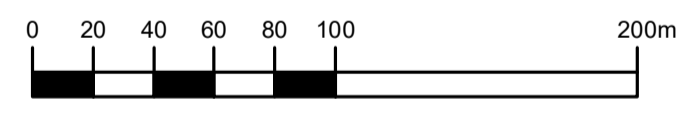

0	01/04/2020	FINAL	BS	CVM	SC	CB
Rev	Date	Description	By	Eng Chk	Disc App'd	
Suitability						S0

PINS Reference Number



Client
A1 Birtley to Coal House

Drawing Title
AGRICULTURAL LAND PLAN
SHEET 5 OF 5

Scale	1:2,500	Drawn	BS	Checked	CVM	Approved	SC	Authorised	NR
Original Sto	A1	Date	01/04/2020	Date	01/04/2020	Date	01/04/2020	Date	01/04/2020
Drawing Number	HE551462	Originator	WSP	Volume	LSI	Revision	P00		
Section	ZZ	Type	X	DR	ZL	31635	PW Stage Code 4		

If you need help accessing this or any other Highways England information, please call **0300 470 4580** and we will help you.

© Crown copyright 2020.

You may re-use this information (not including logos) free of charge in any format or medium, under the terms of the Open Government Licence. To view this licence:

visit www.nationalarchives.gov.uk/doc/open-government-licence/

write to the Information Policy Team, The National Archives,

Kew, London TW9 4DU, or email

psi@nationalarchives.gsi.gov.uk.

This document is also available on our website at www.gov.uk/highways

If you have any enquiries about this document A1BirtleytoCoalhouse@highwaysengland.co.uk or call 0300 470 4580*.

*Calls to 03 numbers cost no more than a national rate call to an 01 or 02 number and must count towards any inclusive minutes in the same way as 01 and 02 calls.

These rules apply to calls from any type of line including mobile, BT, other fixed line or payphone. Calls may be recorded or monitored.

Registered office Bridge House, 1 Walnut Tree Close, Guildford GU1 4LZ
Highways England Company Limited registered in England and Wales number 09346363