

M25 junction 10/A3 Wisley interchange

TR010030

9.70 Errata Update for Plans at 4a

Rule 8(1)(k)

Planning Act 2008

Infrastructure Planning (Examination Procedure) Rules 2010

Volume 9

March 2020

Infrastructure Planning

Planning Act 2008

The Infrastructure Planning (Examination Procedure) Rules 2010

M25 junction 10/A3 Wisley interchange

Development Consent Order 202[x]

9.70 ERRATA UPDATE FOR PLANS SUBMITTED AT DEADLINE 4a

Rule Number:	Rule 8(1)(k)
Planning Inspectorate Scheme Reference	TR010030
Application Document Reference	TR010030/9.67
Author:	M25 junction 10/A3 Wisley interchange project team, Highways England and Atkins

Version	Date	Status of Version
Rev 0	3 March 2020	Deadline 5

1. Schedule of Plans included in this document

Document title	Document number	Revision
Streets, Rights of Way and Access Plans – Regulation 5(2)(k) – Sheet 8 of 31	REP4a-005 Appx D page 32	1
Scheme Layout Plans Regulation 5(2)(o) – Sheet 8 of 31	REP4a-005 Appx G page 54	1

DO NOT SCALE
 0 10 100
 Millimetres

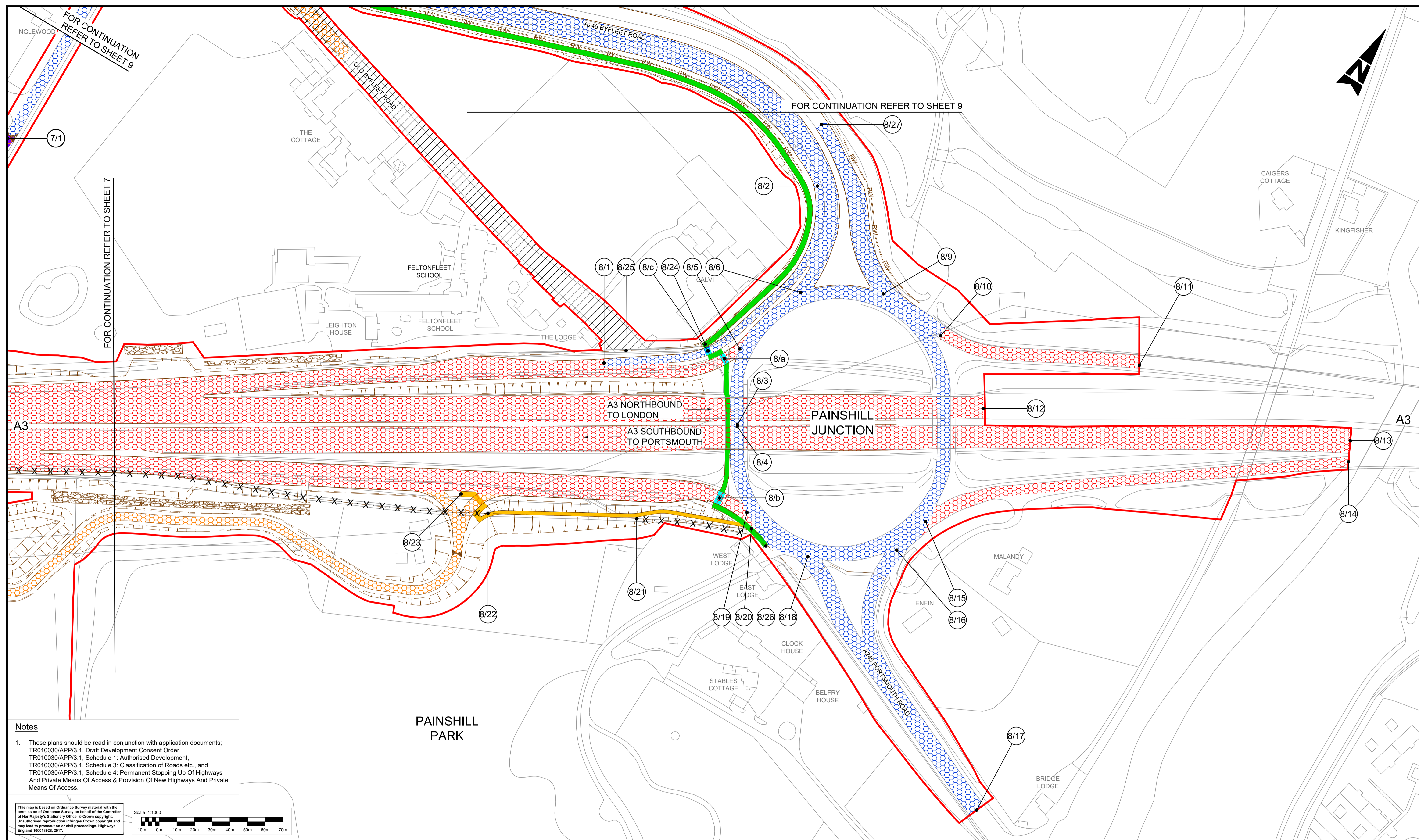

Notes

- These plans should be read in conjunction with application documents; TR010030/APP/3.1. Draft Development Consent Order, TR010030/APP/3.1. Schedule 1: Authorised Development, TR010030/APP/3.1. Schedule 3: Classification of Roads etc., and TR010030/APP/3.1. Schedule 4: Permanent Stopping Up Of Highways And Private Means Of Access & Provision Of New Highways And Private Means Of Access.

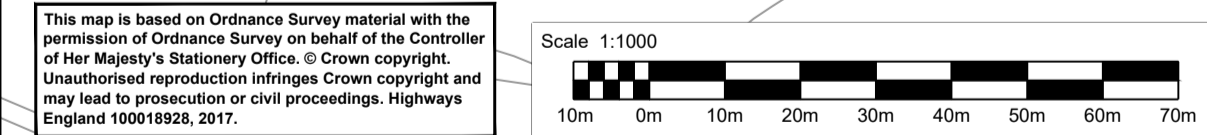

Legend:	
	Local authority boundary
	Development consent order (DCO) boundary
	Scheme layout (shown for illustrative purposes)
	New, altered or improved highway - motorway
	New, altered or improved highway - trunk road
	New or improved highway - side roads
	Existing highways to be stopped up
	Private means of access to be stopped up
	New/altered private means of access
	Existing Public Right of Way (PRoW)
	PRoW or footway/cycleway to be stopped up/extinguished
	Existing permissive signposted route
	New or diverted bridleway
	New or diverted footpath or footway
	New or diverted cycle track
	New non-segregated footway/cycle track
	Byway open to all traffic to be improved
	Existing permissive signposted route to be upgraded to bridleway
	Existing permissive signposted route or track to be upgraded to footpath
	Existing footpath to be upgraded to bridleway
	Start/End point of highway / right of way to be improved, diverted, created, stopped up or extinguished
	New signal controlled non-motorised user crossing
	Existing private means of access to be stopped up
	Other private means of access to be altered
	Secure gate or barriers

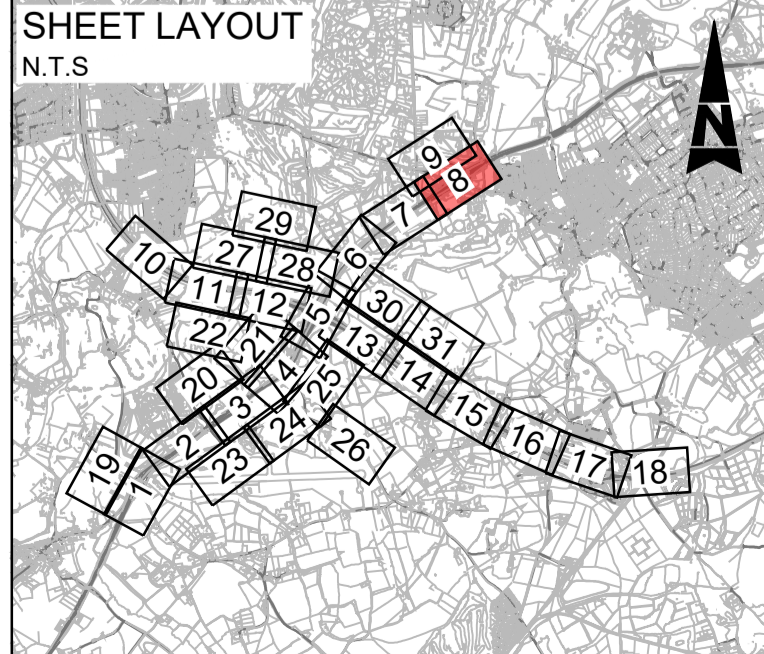

Description	Status	Revision	Drawn	Checked	Reviewed	Authorised	Issue Date
DCO APPLICATION	A4	0	SA	JW	RM	CT	07/06/19
SUBMITTED FOR DEADLINE 4	A1	1	SA	LH	RM	ADK	28/01/20

Drawing Suitability	APPROVED - PUBLISHED	Status	A1	Project Title	M25 junction 10/A3 Wisley interchange
		Epsom Gateway Ashley Avenue Epsom Surrey KT18 5AL Tel: +44 (0)1372 726140 Fax: +44 (0)1372 740055 www.atkinsglobal.com		Drawing Title STREETS, RIGHTS OF WAY AND ACCESS PLANS REGULATION 5(2)(k) SHEET 8 OF 31	
Copyright © Atkins Limited (2018)		Client Working on behalf of highways england		Drawing Number TR010030/APP/2.4	
				Rev: 1	
				HE PIN: HE551522 Scale: 1:1000 Original Size: A1	

DO NOT SCALE

100
0 10
Millimetres

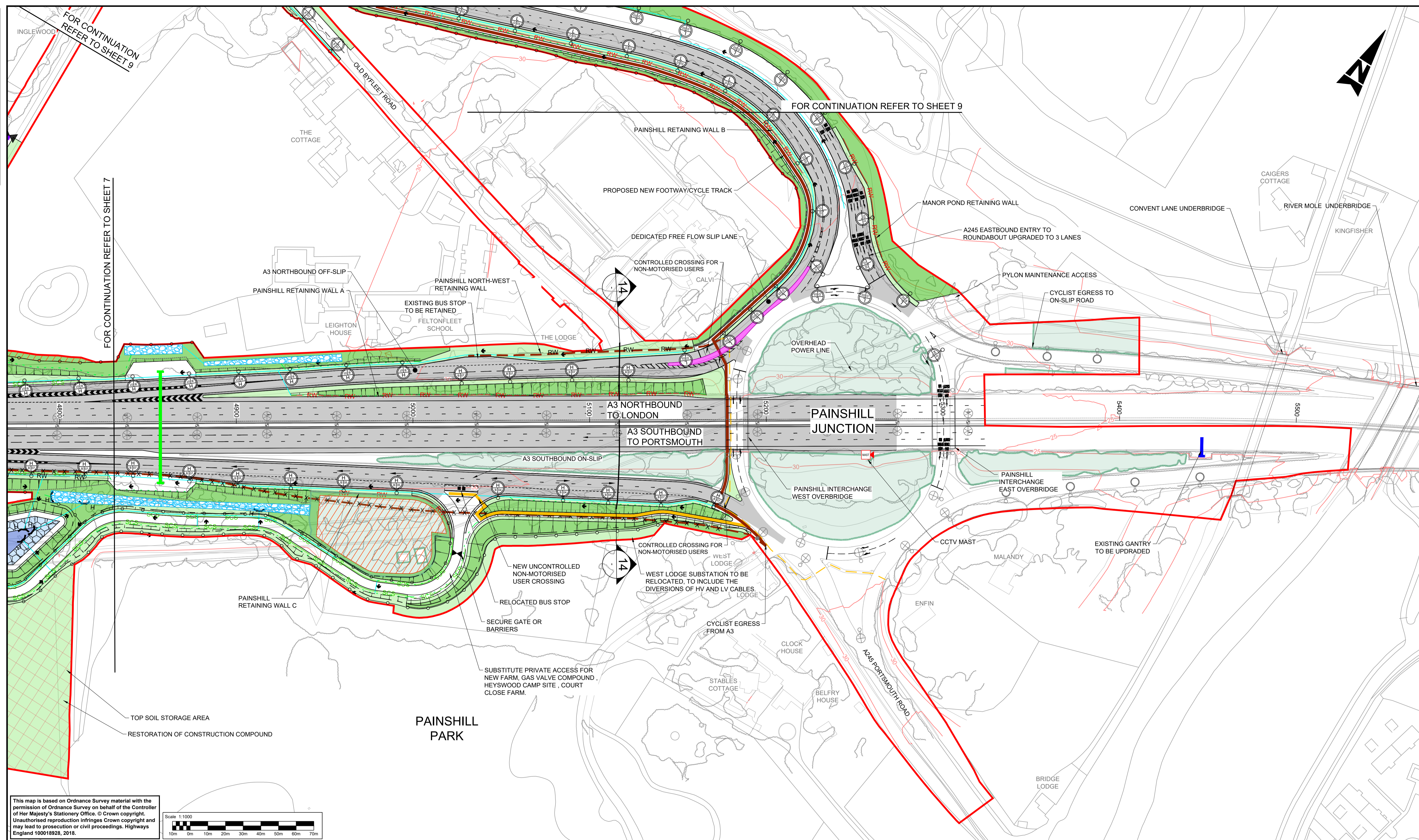

This map is based on Ordnance Survey material with the permission of Ordnance Survey on behalf of the Controller of Her Majesty's Stationery Office. © Crown copyright. Unauthorised reproduction infringes Crown copyright and may lead to prosecution or civil proceedings. Highways England 100018928, 2018.

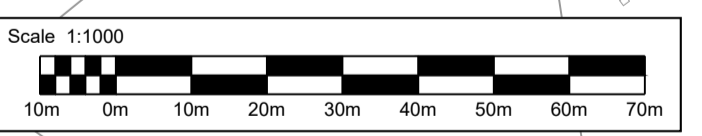

- NOTES**
- THESE PLANS SHOULD BE READ IN CONJUNCTION WITH TR010030/APP/2.8 KEY PLAN AND TR010030/APP/2.8 KEY LEGEND.
 - THESE PLANS SHOULD BE READ IN CONJUNCTION WITH OTHER PLANS AND DOCUMENTS IN THE DEVELOPMENT CONSENT ORDER (DCO). THE PROPOSED SCHEME WILL BE SUBJECT TO DETAILED DESIGN DEVELOPMENT WITHIN THE LIMITS OF DEVIATION, AS SHOWN ON THE TR010030/APP/2.3 WORKS PLANS.
 - THE ALIGNMENT OF UTILITY DIVERSIONS ARE SHOWN ON THE TR010030/APP/2.3 WORKS PLANS.
 - FOR CROSS-SECTIONS REFER TR010030/APP/2.9 DRAWINGS.
 - THE INFORMATION SHOWN ON THE PLANS IS COMMENSURATE WITH THE PRELIMINARY DESIGN STATUS OF THE PROJECT.

SAFETY, HEALTH AND ENVIRONMENTAL INFORMATION

In addition to the hazards/risks normally associated with the types of work detailed on this drawing, note the following significant residual risks (Reference shall also be made to the design hazard log).

Construction	OVERHEAD POWER LINES FROM A3 NB CH:3800.00 TO CH:5400.00. CONSTRUCTION OF STRUCTURE OVER LIVE CARRIAGEWAY.
Maintenance / Cleaning	NONE
Use	NONE
Decommissioning / Demolition	NONE

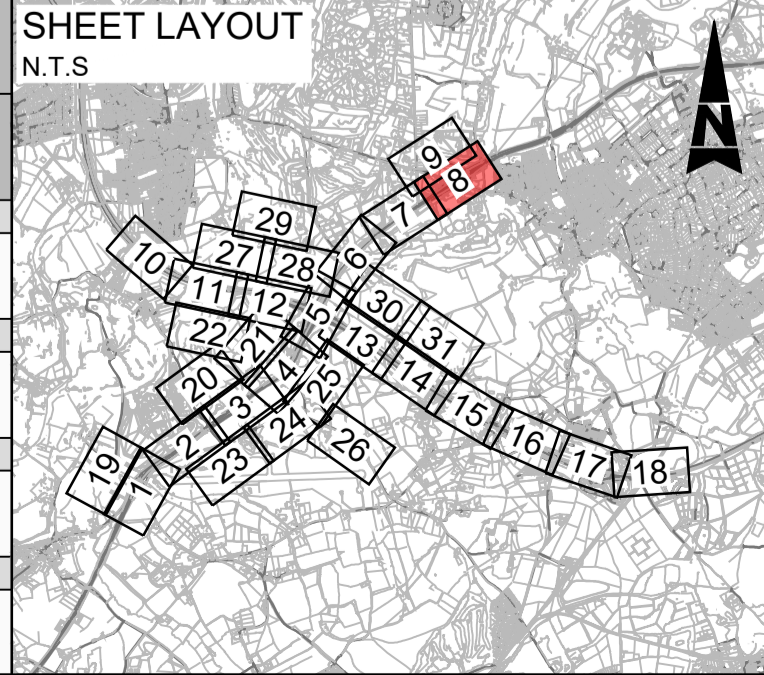

Description	Status	Revision	Drawn	Checked	Reviewed	Authorised	Issue Date
DCO APPLICATION	A4	0	DD	NK	JW	CT	07/06/19
SUBMITTED FOR DEADLINE 4	A1	1	SA	LH	RM	ADK	28/01/20

Drawing Suitability: **APPROVED - PUBLISHED**

Status: **A1**

Client: **Working on behalf of highways england**

Copyright © Atkins Limited (2018)

Project Title: **M25 junction 10/A3 Wisley interchange**

Drawing Title: **SCHEME LAYOUT PLANS REGULATION 5(2)(o)**

SHEET **8 OF 31**

Drawing Number: **TR010030/APP/2.8**

Rev: **1**

HE PIN: HE551522 | Scale: 1:1000 | Original Size: A1

© Crown copyright (2020).

You may re-use this information (not including logos) free of charge in any format or medium, under the terms of the Open Government Licence. To view this licence:

visit www.nationalarchives.gov.uk/doc/open-government-licence/

write to the Information Policy Team, **The National Archives, Kew, London TW9 4DU**,
or email psi@nationalarchives.gsi.gov.uk.

Printed on paper from well-managed forests and other controlled sources.

Registered office Bridge House, 1 Walnut Tree Close, Guildford GU1 4LZ
Highways England Company Limited registered in England and Wales number 09346363

