

DO NOT SCALE

Millimetres
0 10 100

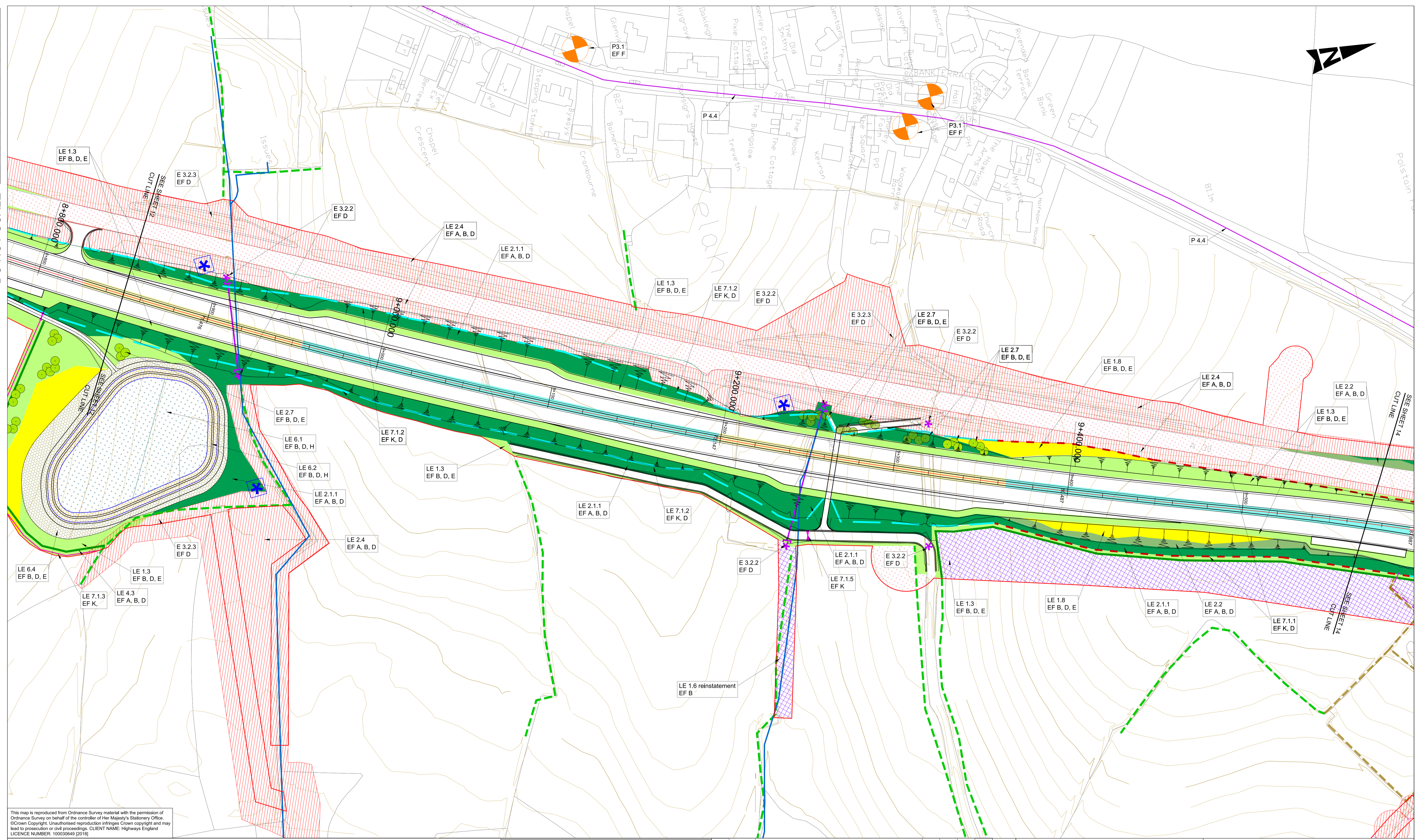

This map is reproduced from Ordnance Survey material with the permission of Ordnance Survey on behalf of the controller of Her Majesty's Stationery Office. © Crown Copyright. Unauthorised reproduction infringes Crown copyright and may lead to prosecution or civil proceedings. CLIENT NAME: Highways England LICENCE NUMBER: 100030649 (2018)

GENERAL NOTES:
 1. FOR LEGEND AND DETAILS PLEASE REFER TO DRAWING HA551502-ARP-ELS-SW-DR-LE-000002
 2. ALL DIMENSIONS ARE IN METRES UNLESS NOTED OTHERWISE.
 3. ONLY WRITTEN DIMENSIONS SHALL BE USED. DO NOT SCALE.

SAFETY, HEALTH AND ENVIRONMENTAL INFORMATION

In addition to the hazards/risks normally associated with the types of work detailed on this drawing, note the following significant residual risks (Reference shall also be made to the design hazard log).

Construction	Maintenance / Cleaning	Use	Decommissioning / Demolition
(Enter "None" if applicable)	(Enter "None" if applicable)	(Enter "None" if applicable)	(Enter "None" if applicable)
P01 15/12/17 FIRST ISSUE	P03 06/07/18 P03	P05 23/08/18 FINAL ISSUE	C01 23/08/18 FINAL ISSUE
P02 15/12/17 FIRST ISSUE	P04 06/07/18 DF3	P06 23/08/18 FINAL ISSUE	
Rev.	Date	Description	By

By	Chk'd	App'd	Auth'd
BO	JP	PH	—
BO	JP	PH	PH
OS	BO	JP	—
OS	BO	JP	PH
BO	CM	JP	JP
BO	CM	JP	SW
BO	CM	JP	SW

Suitability A3 Drawing Status STAGE COMPLETED

ARUP

highways england

European Union Development Fund

Project Title A30 CHIVERTON TO CARLAND CROSS

Drawing Title **FIGURE 7.6 - ENVIRONMENTAL MASTERPLANS SHEET 13 OF 20**

Scale	By	Checked	Approved	Authorised
1:1000	BO	CM	JP	SW
Original Size	Date	Date	Date	Date
A1	09/08/18	23/08/18	23/08/18	23/08/18
Drawing Number	HE PIN	Originator	Volume	Revision
HA551502 - SW	ARP	ELS	-DR-LE-001013	C01
Location	Type	Role	Number	