

DO NOT SCALE

Millimetres

0 10 100

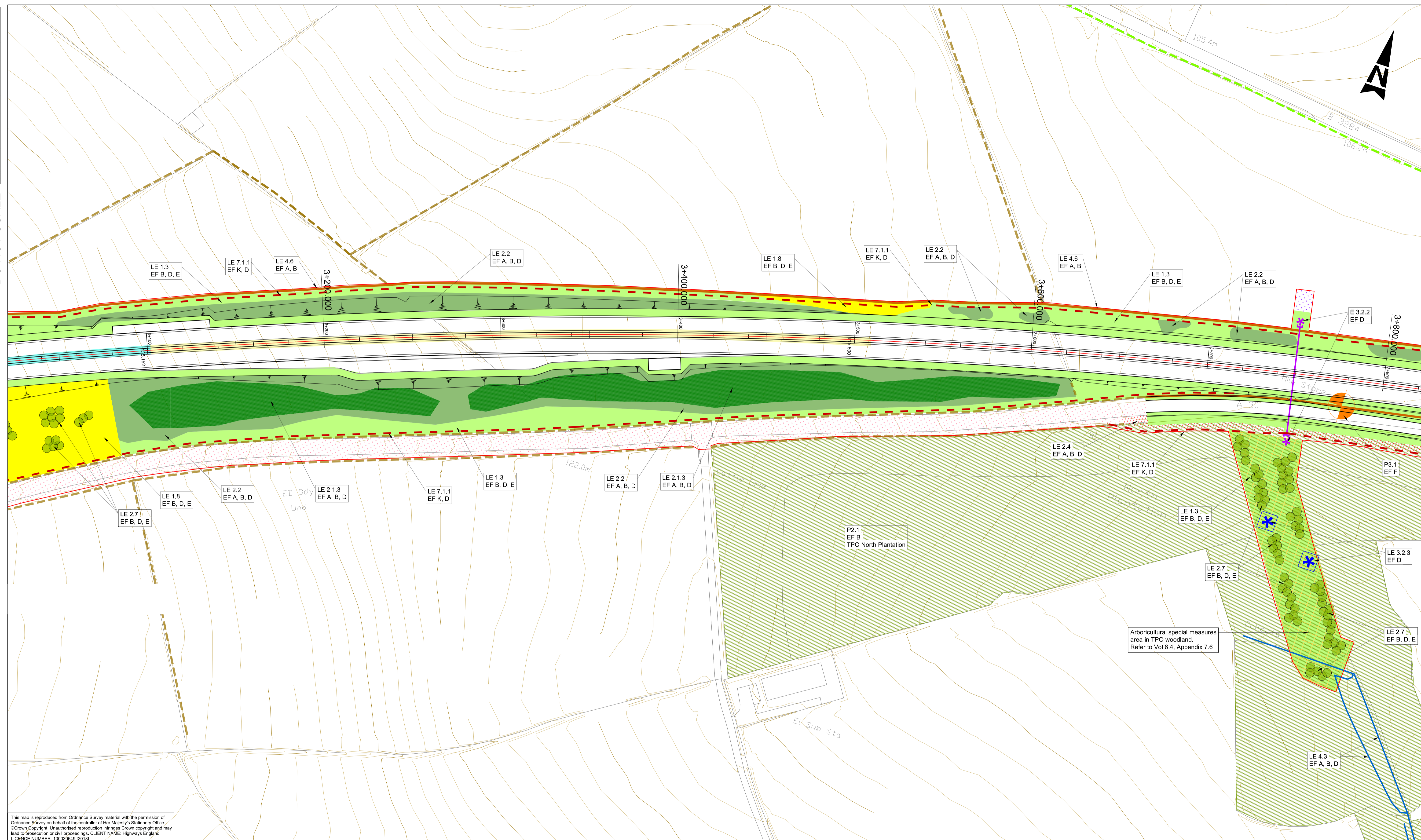

This map is reproduced from Ordnance Survey material with the permission of Ordnance Survey on behalf of the controller of Her Majesty's Stationery Office. © Crown Copyright. Unauthorised reproduction infringes Crown copyright and may lead to prosecution or civil proceedings. CLIENT NAME: Highways England LICENCE NUMBER: 100030649 (2018)

- GENERAL NOTES:
- FOR LEGEND AND DETAILS PLEASE REFER TO DRAWING HA551502-ARP-ELS-SW-DR-LE-000002
 - ALL DIMENSIONS ARE IN METRES UNLESS NOTED OTHERWISE.
 - ONLY WRITTEN DIMENSIONS SHALL BE USED. DO NOT SCALE.
 - FENCELINES WORK-IN-PROGRESS. TO BE UPDATED.

SAFETY, HEALTH AND ENVIRONMENTAL INFORMATION

In addition to the hazards/risks normally associated with the types of work detailed on this drawing, note the following significant residual risks (Reference shall also be made to the design hazard log).

Construction	Maintenance / Cleaning	Use	Decommissioning / Demolition			
(Enter "None" if applicable)	(Enter "None" if applicable)	(Enter "None" if applicable)	(Enter "None" if applicable)			
P01 06/07/18 P01 OS BO JP --	P02 06/07/18 DF3 OS BO JP DG	P03 23/08/18 FINAL ISSUE BO CM JP JP	P04 23/08/18 FINAL ISSUE BO CM JP SW			
			C01 23/08/18 FINAL ISSUE BO CM JP SW			
Rev.	Date	Description	By	Chk'd	App'd	Auth'd

Suitability A3 Drawing Status STAGE COMPLETED



Project Title A30 CHIVERTON TO CARLAND CROSS

Drawing Title **FIGURE 7.6 - ENVIRONMENTAL MASTERPLANS SHEET 5 OF 20**

Scale	By	Checked	Approved	Authorised
1:1000	BO	CM	JP	SW
Original Size A1	Date 09/08/18	Date 23/08/18	Date 23/08/18	Date 23/08/18
Drawing Number HA551502 - SW	Originator ARP	Volume - DR - LE - 001005	Location	Revision C01