

DO NOT SCALE

Millimetres

0 10 100

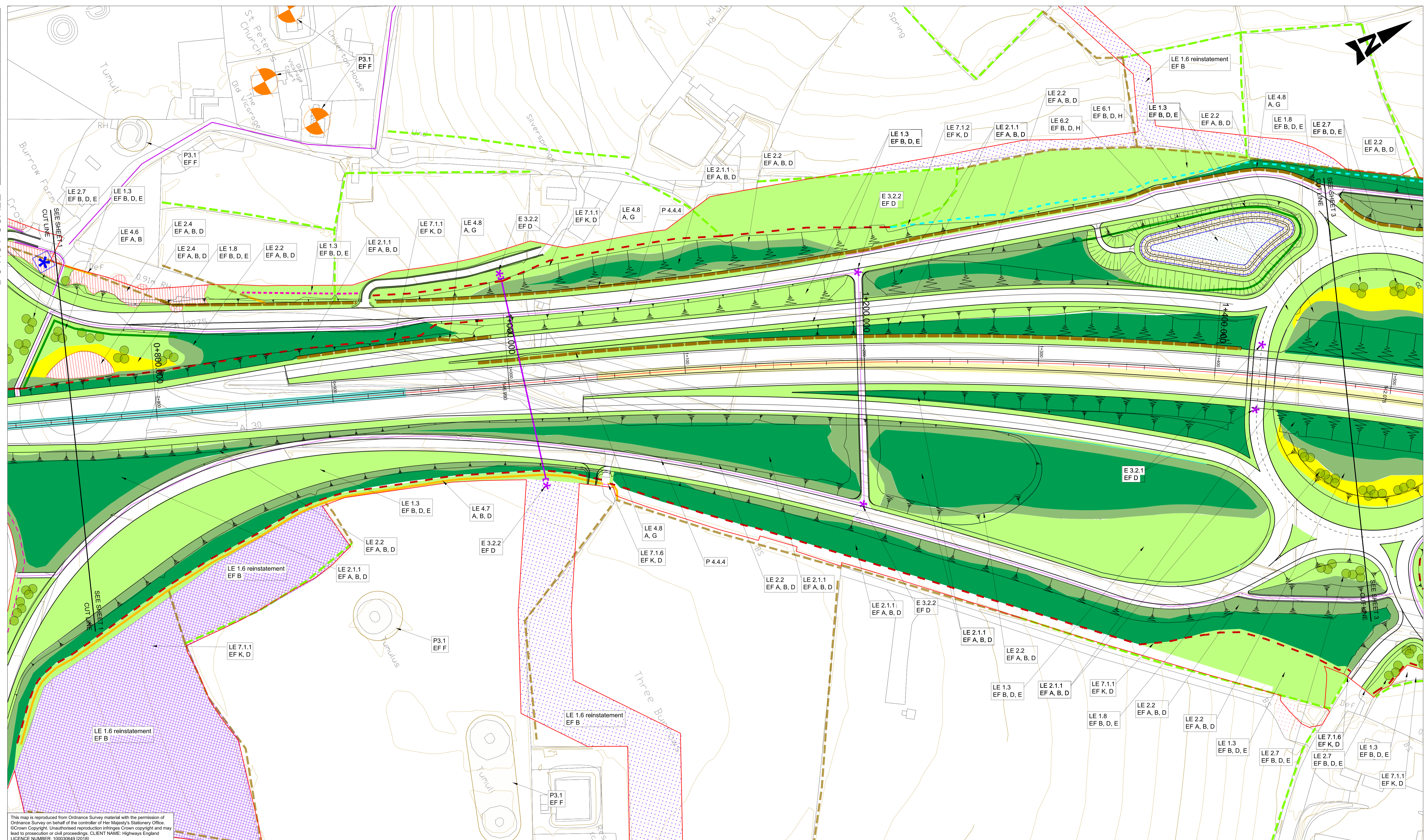

This map is reproduced from Ordnance Survey material with the permission of Ordnance Survey on behalf of the controller of Her Majesty's Stationary Office. © Crown Copyright. Unauthorised reproduction infringes Crown copyright and may lead to prosecution or civil proceedings. CLIENT NAME: Highways England LICENCE NUMBER: 100030649 (2018)

GENERAL NOTES:
 1. ALL DIMENSIONS ARE IN METRES UNLESS NOTED OTHERWISE.
 2. ONLY WRITTEN DIMENSIONS SHALL BE USED, DO NOT SCALE.

SAFETY, HEALTH AND ENVIRONMENTAL INFORMATION

In addition to the hazards/risks normally associated with the types of work detailed on this drawing, note the following significant residual risks (Reference shall also be made to the design hazard log).

Construction (Enter "None" if applicable)	Maintenance / Cleaning (Enter "None" if applicable)	Use (Enter "None" if applicable)	Decommissioning / Demolition (Enter "None" if applicable)
P01 06/07/18 P01	P02 06/07/18 DF3	P03 23/08/18 FINAL ISSUE	C01 23/08/18 FINAL ISSUE

Rev.	Date	Description	By	Chk'd	App'd	Auth'd

Suitability Drawing Status
A3 STAGE COMPLETED

ARUP

highways
england

European Union
European Regional
Development Fund

Project Title		Drawing Title			
A30 CHIVERTON TO CARLAND CROSS		FIGURE 7.6 - ENVIRONMENTAL MASTERPLANS SHEET 2 OF 20			
Scale	By	Checked	Approved	Authorised	
N/A	BO	OS	JP	SW	
Original Size	Date	Date	Date	Date	
A1	10/08/18	23/08/18	23/08/18	23/08/18	
Drawing Number	HE PIN	Originator	Volume		
HA551502 - SW	ARP	ARP	ELS -DR-LE-001041		C01
Location	Type	Role	Number		