

The Lake Lothing (Lowestoft) Third Crossing Order 201[*]



Lake Lothing
**THIRD
CROSSING**

**Document 6.3: Environmental Statement
Volume 3 Appendices**

Appendix 4A

Tree Preservation Orders

Dated

20 January

1999

WAVENEY DISTRICT COUNCIL

TOWN AND COUNTRY PLANNING ACTS 1990

TREE PRESERVATION ORDER 1999 (NO. 269)

relating to

Land at Land North of 1a Durban Road, Lowestoft

*Confirmed as an unopposed
Order 1st March 1999.*

[LJD.14]

269

863800

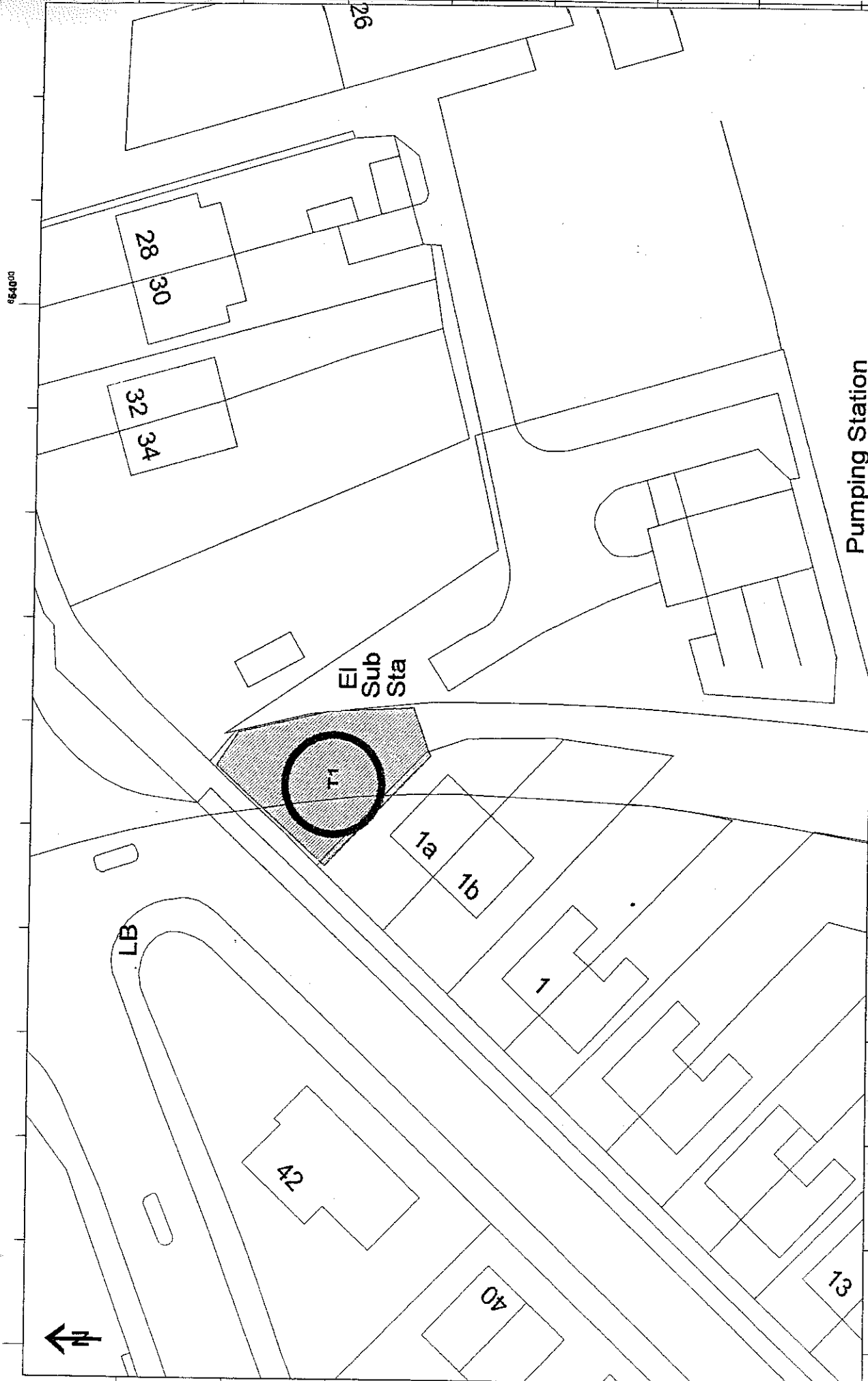

This site plan was prepared for the Planning and Building Unit
 of the City of Vancouver, British Columbia. It is not to be used for
 any other purpose without the written consent of the City of Vancouver.
 Copyright © 2000 by the City of Vancouver. All rights reserved.

LAND NORTH OF 1A DURBAN ROAD, LOWESTOFT

Easting : 5394 Northing : 9240

Pumping Station

864000

1:500

292400

13. The provisions of section 201 of the Act shall apply to this Order and the Order shall take effect on 20th January 1999.

NOTE: Any person contravening the provisions of this Order by cutting down, uprooting or wilfully destroying a tree, or by wilfully damaging, topping or lopping a tree in such a manner as to be likely to destroy it is guilty of an offence and liable on summary conviction to a fine not exceeding the prescribed sum or twice the sum which appears to the court to be the value of the tree, whichever is the greater, or on indictment to a fine. The penalty for any other contravention of this Order is a fine not exceeding Level 4 on the standard scale on summary conviction and, in the case of a continuing offence when the contravention is continued after conviction, a person is liable on summary conviction to an additional fine not exceeding £5 for every day on which the contravention is so continued.

If a tree is removed, uprooted or destroyed in contravention of an order or, except in the case of a tree to which the Order applies as part of a woodland, is removed, uprooted or destroyed or dies at a time when its cutting down or uprooting is authorised only by section 198(6)(a) of the Town and Country Planning Act 1990 relating to trees which are dying or dead or have become dangerous, it is the duty of the owner of the land, unless on his application the local planning authority dispense with the requirement, to plant another tree of appropriate size and species at the same place as soon as he reasonably can.

Except in emergency, not less than 5 days previous notice of the removal, etc., should be given to the authority to enable the latter to decide whether or not to dispense with the requirement. In respect of trees in a woodland it is sufficient to replace the trees removed, uprooted or destroyed by planting the same number of trees either on or near the land on which the trees removed, uprooted or destroyed stood or on such other land as may be agreed between the authority and the owner of the land, and (in either case) in such places as may be designated by the authority.

FIRST SCHEDULE

TREES SPECIFIED INDIVIDUALLY*

(encircled in black on the map)

<i>No. on Map</i>	<i>Description</i>	<i>Situation</i>
T1 <i>original tree felled 2005</i>	Sycamore	Land north of 1a Durban Road, Lowestoft <i>replaced with Ligand Amber in for left hand side of site</i>

TREES SPECIFIED BY REFERENCES TO AN AREA*

(within a dotted black line on the map)

<i>No. on Map</i>	<i>Description</i>	<i>Situation</i>
None		

*the word "NONE" must be entered where necessary.

GROUP OF TREES*

(within a broken black line on the map)

<i>No. on Map</i>	<i>Description</i>	<i>Situation</i>
None		

*the word "NONE" must be entered where necessary.

Order confirmed by D.O. Committee
12th March 1985.
(Min. 112-732/23 refers.)

DATED 4th January 1985

WAVENEY DISTRICT COUNCIL

TREE PRESERVATION ORDER (No.61) 1985

LAND AT 42 WAVENEY DRIVE, LOWESTOFT

TOWN AND COUNTRY PLANNING ACTS

1971 to 1974

District Secretary and
Solicitor,
Town Hall,
Lowestoft,
Suffolk.

P 62.46

12/3/85

PRODUCED FROM THE ORDNANCE SURVEY
MAP WITH THE PERMISSION OF THE CONTROLLER
OF HER MAJESTY'S STATIONERY OFFICE.
CROWN COPYRIGHT RESERVED.
REFERENCE No. LA074608

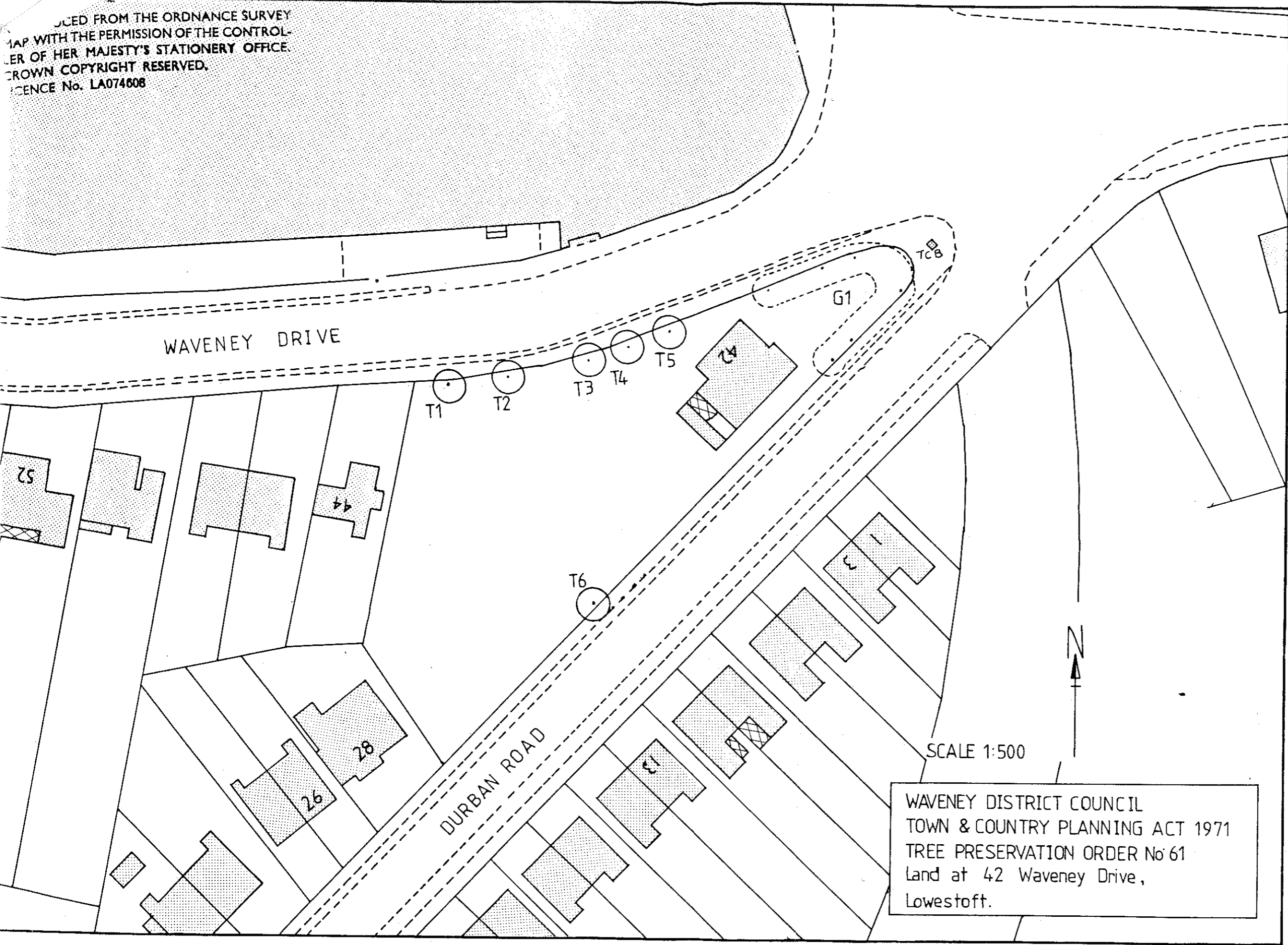

WAVENEY DISTRICT COUNCIL
TOWN & COUNTRY PLANNING ACT 1971
TREE PRESERVATION ORDER No 61
Land at 42 Waveney Drive,
Lowestoft.

removed or destroyed in contravention of the Order it is the duty of the owner of the land unless on his application the local authority dispense with the requirement to plant another tree of appropriate size and species at the same place as soon as he reasonably can _____

FIRST SCHEDULE

Trees specified individually
(encircled in black on the plan)

<u>No. on plan</u>	<u>Description</u>	<u>Situation</u>
T1	Elm) Land at 42 Waveney Drive,) Lowestoft - boundary) abutting Waveney Drive)))
T2	Elm	
T3	Elm	
T4	Sycamore	
T5	Elm	
T6	Elm	

Groups of Trees

(Within a broken black line on the plan)

<u>No. on plan</u>	<u>Description</u>	<u>Situation</u>
G1	Group consisting of 4 Sycamore and 2 Elms	Land at 42 Waveney Drive, Lowestoft - boundary abutting the junction of Waveney Drive and Durban Road