

**WAVENEY DRIVE (EAST) LONG SECTION**  
 WORK NO. 2  
 WORKS PLANS SHEET 2  
 Horizontal Scale = 1:500, Vertical Scale = 1:100

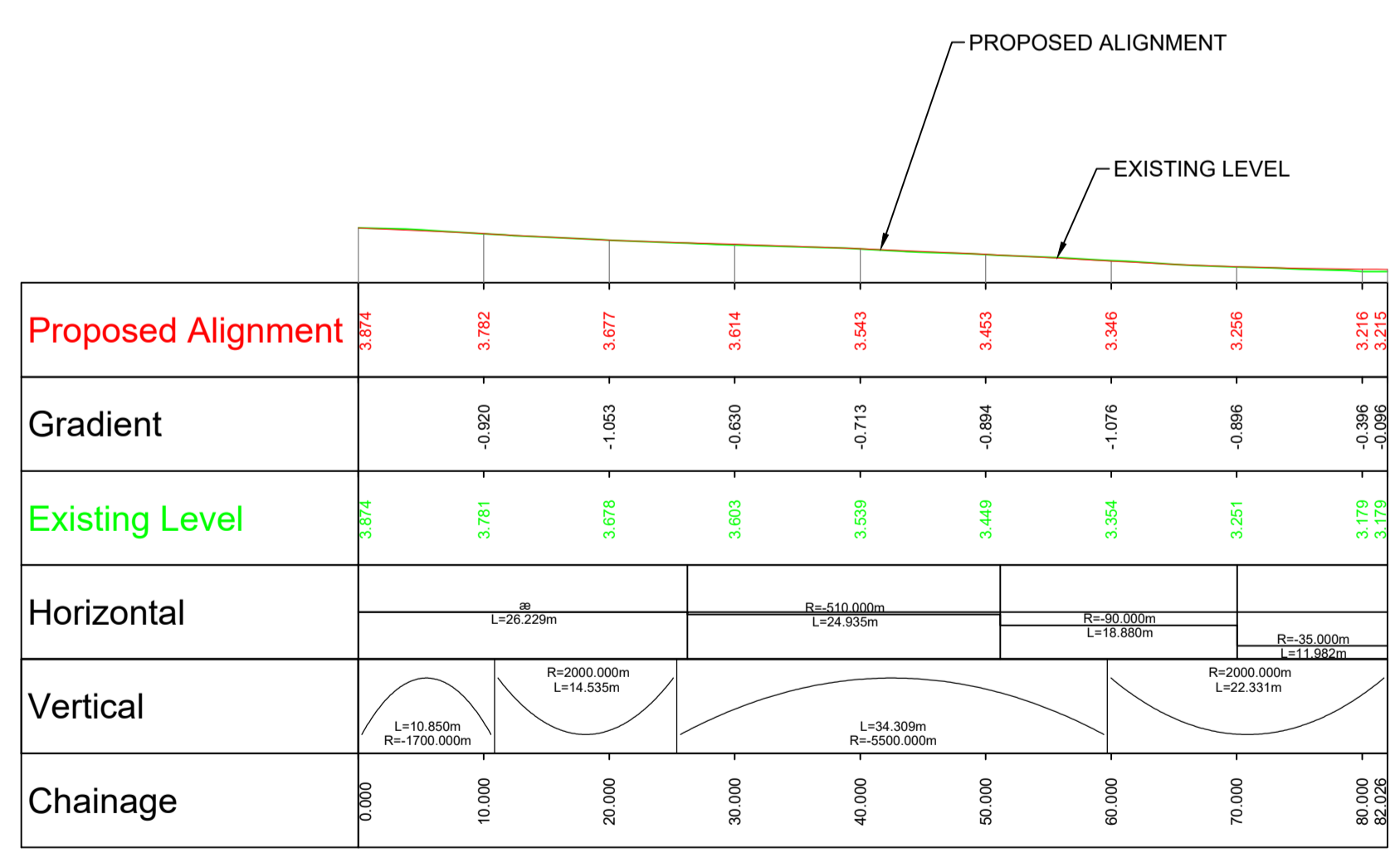

**WAVENEY DRIVE (WEST) LONG SECTION**  
 WORK NO. 2  
 WORKS PLANS SHEET 2  
 Horizontal Scale = 1:500, Vertical Scale = 1:100

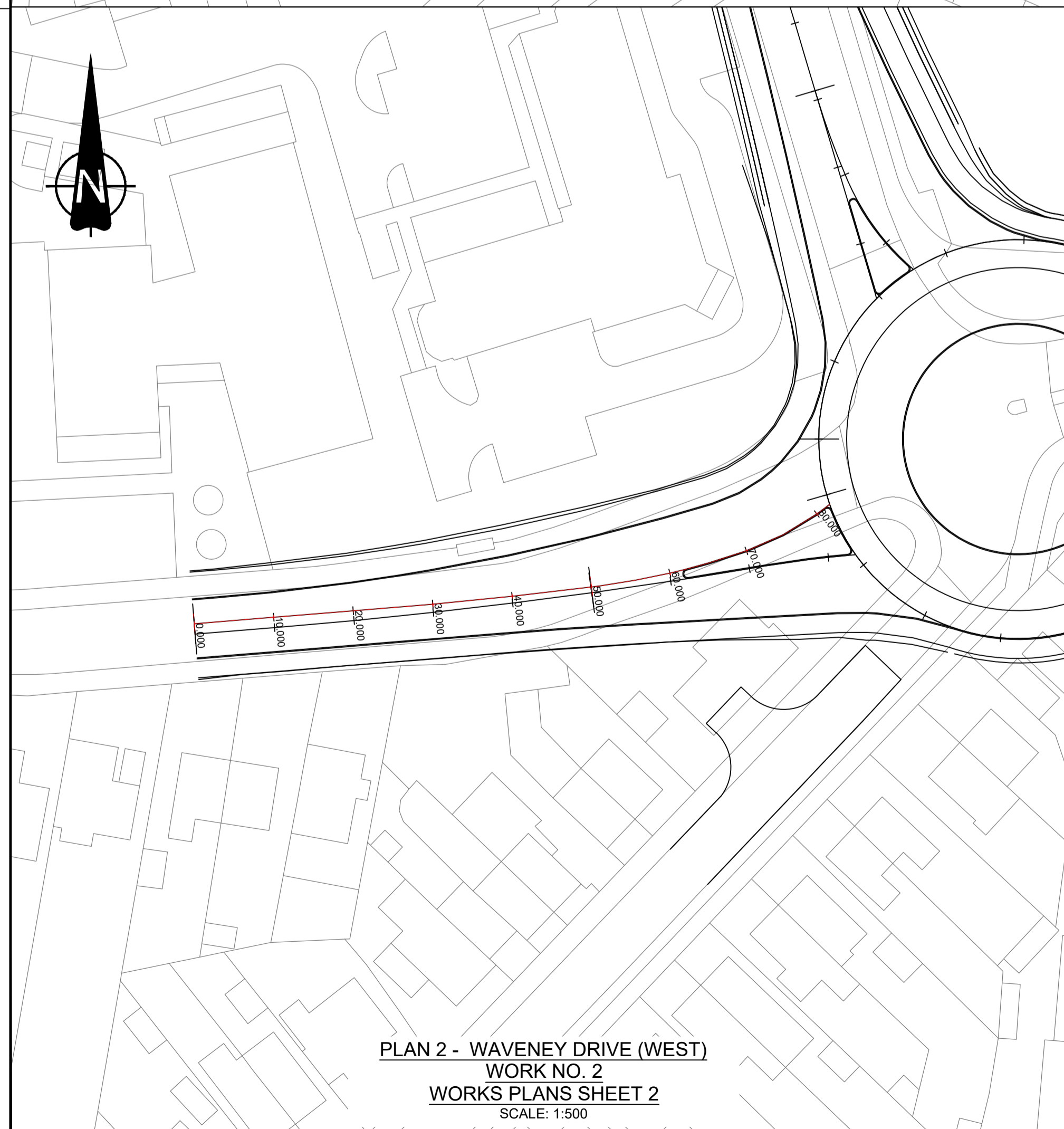
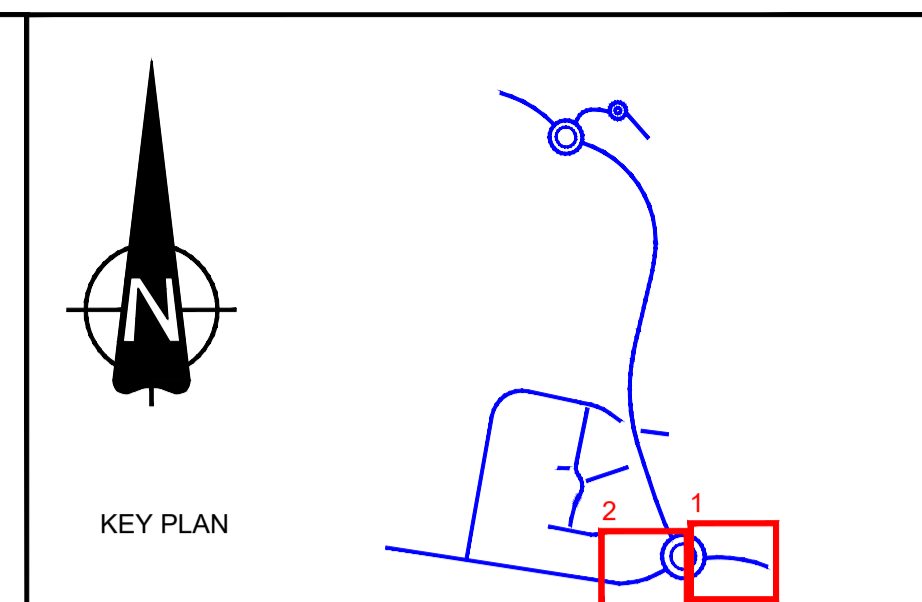

**KEY**

**NOTES**

- ALL DIMENSIONS ARE IN METRES UNLESS OTHERWISE STATED
- THESE ENGINEERING SECTION DRAWINGS AND PLANS SHOULD BE READ IN CONJUNCTION WITH THE KEY PLAN AND ALONGSIDE OTHER PLANS AND DOCUMENTS IN THE DEVELOPMENT CONSENT ORDER APPLICATION. IN PARTICULAR THE WORKS PLANS AND SCHEDULE 1 (AUTHORISED DEVELOPMENT) TO THE DEVELOPMENT CONSENT ORDER.
- WORK NO. REFERENCES ARE DETAILED IN SCHEDULE 1 (AUTHORISED DEVELOPMENT) TO THE DEVELOPMENT CONSENT ORDER.
- THE DESIGN SHOWN ON THESE ENGINEERING SECTION DRAWINGS AND PLANS IS ILLUSTRATIVE AND WILL BE SUBJECT TO DETAILED DESIGN DEVELOPMENT; ANY CHANGES WILL BE LIMITED TO BEING WITHIN THE ORDER LIMITS AND ANY OTHER CONSTRAINTS INCLUDED IN THE DEVELOPMENT CONSENT ORDER.

Mapping reproduced by permission of Ordnance Survey on behalf of HMSO.  
 © Crown copyright and database rights 2017. All rights reserved.  
 Ordnance Survey licence number 100023395  
 Contains OS data © Crown copyright and database rights 2017.

REVISION	DRAWN	CHECKED	APPROVED	DATE

**DESCRIPTION**

**PROJECT TITLE**  
 Lake Lothing  
**THIRD CROSSING**

**DRAWING TITLE**  
 ENGINEERING SECTION DRAWINGS AND PLANS  
 SIDE ROADS - WAVENEY DRIVE  
 REGULATIONS 5(2)(o), 5(2)(p) AND 6(2)(a)  
 SHEET 9 OF 9

**DRAWING STATUS**  
 FOR DCO SUBMISSION

<b>DRAWN</b>	<b>CHECKED</b>	<b>APPROVED</b>	<b>AUTHORISED</b>	<b>SUITABILITY</b>
JC	PC	PC	JB	S4
<b>SCALE @ A1 SIZE</b>		<b>DATE</b>	<b>REVISION</b>	
AS SHOWN		08/06/2018	P00	

**DRAWING NUMBER**

Project	Originator	Volume	
1069948-WSP-HSR-LL-DR-CH-0309			
Location	Type	Role	Number