

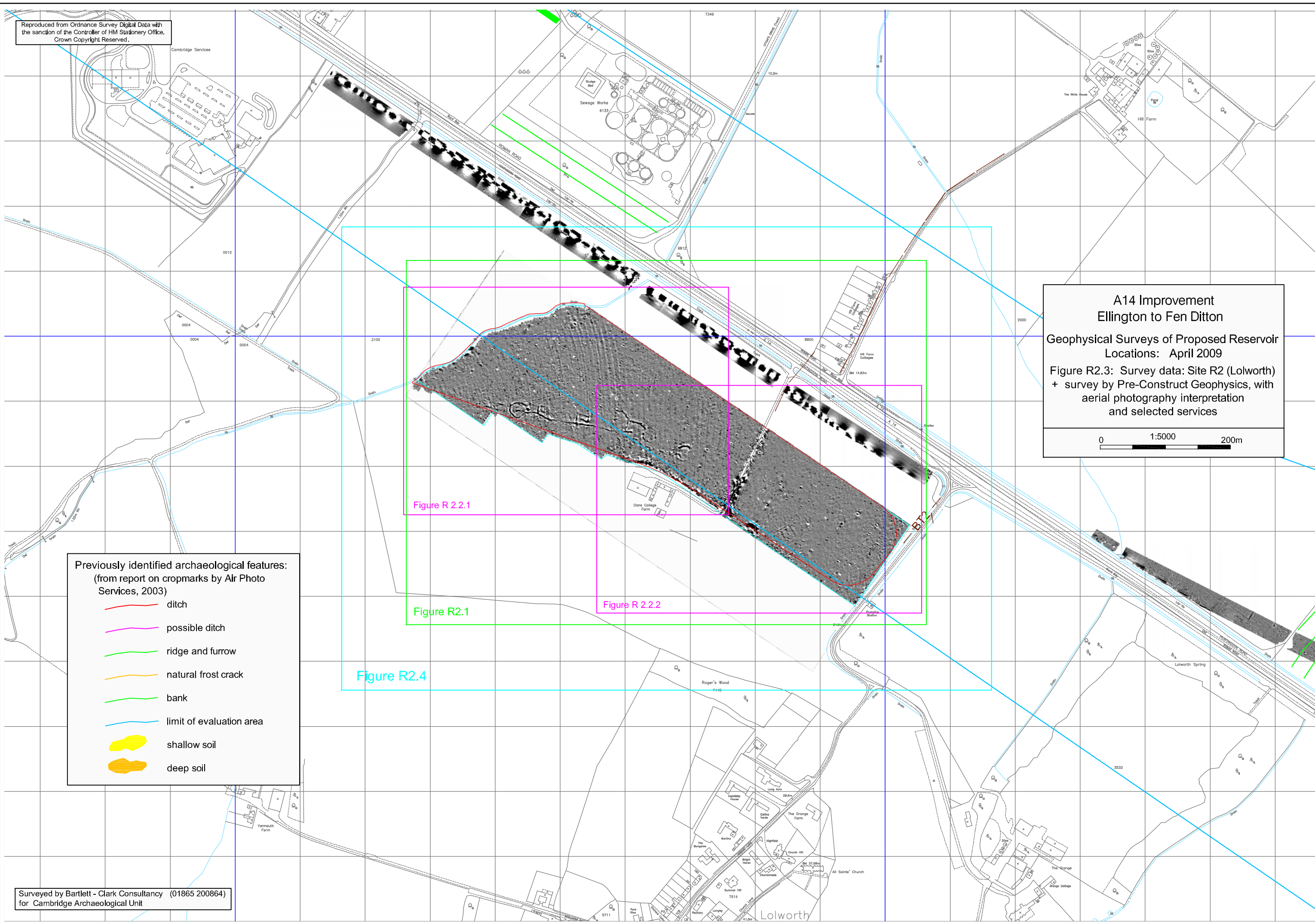





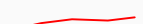

Reproduced from Ordnance Survey Digital Data with the sanction of the Controller of HM Stationery Office. Crown Copyright Reserved.

Cambridge Services



**A14 Improvement
Ellington to Fen Ditton**
Geophysical Surveys of Proposed Reservoir
Locations: April 2009
Figure R2.3: Survey data: Site R2 (Lolworth)
+ survey by Pre-Construct Geophysics, with
aerial photography interpretation
and selected services

0 1:5000 200m

- Previously identified archaeological features:
(from report on cropmarks by Air Photo
Services, 2003)
-  ditch
 -  possible ditch
 -  ridge and furrow
 -  natural frost crack
 -  bank
 -  limit of evaluation area
 -  shallow soil
 -  deep soil

Surveyed by Bartlett - Clark Consultancy (01865 200864)
for Cambridge Archaeological Unit