

**A14 MAINLINE  
WORK NO. 5 - WORKS PLANS SHEET NO. 20 & 21**

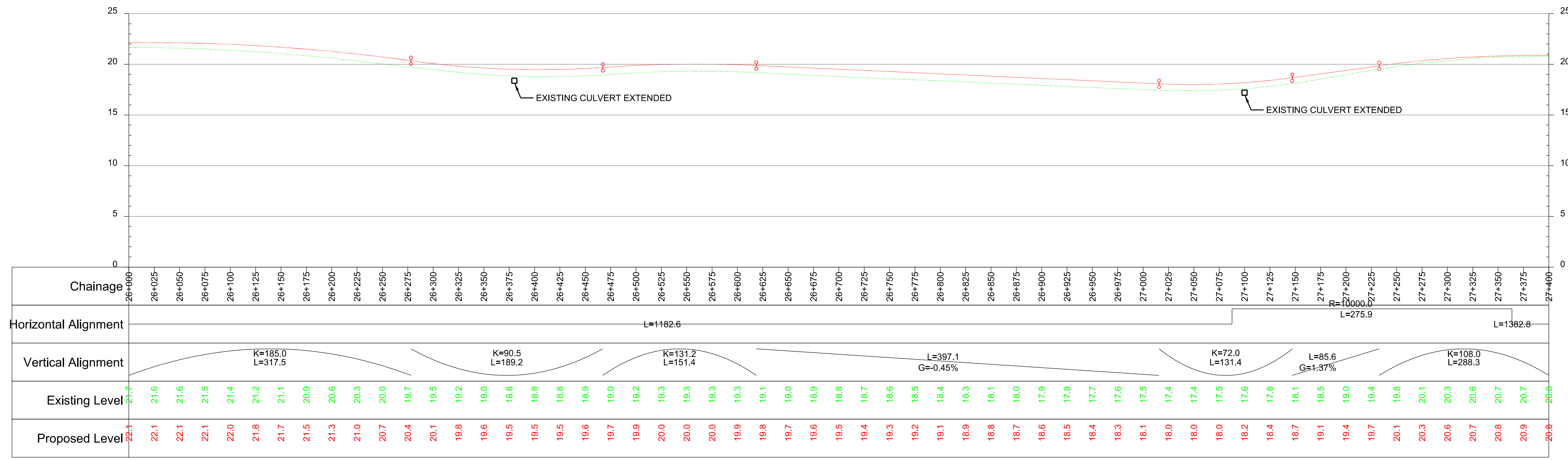

**A14 MAINLINE  
WORK NO. 5 - WORKS PLANS SHEET NO. 21 & 22**

- NOTES**
- All dimensions in metres unless otherwise stated.
  - These Engineering Sections should be read in conjunction with the Works Plans.

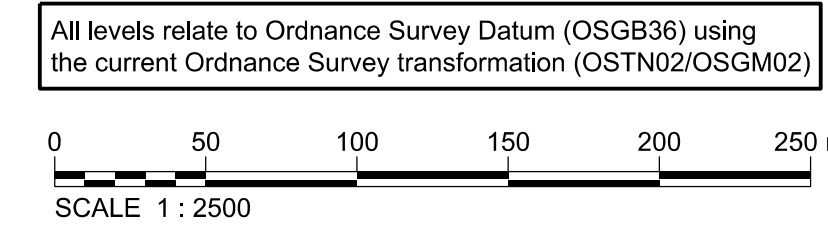

Rev	Rev. Date	Purpose of revision	Drawn	Checked	Rev'd	Apprv'd
0	15/12/14	DCO SUBMISSION	PN	AP	PS	MB

This drawing is not to be used in whole or part other than for the intended purpose and project as defined on this drawing. Refer to the contract for full terms and conditions.

This map is based on Ordnance Survey material with the permission of Ordnance Survey on behalf of the controller of Her Majesty's Stationery Office. © Crown copyright. Unauthorised reproduction infringes Crown copyright and may lead to prosecution or civil proceedings. Highways Agency 100018928, 2008.

**JACOBS**  
Simpson House, 6 Cherry Orchard Road, Croydon, Surrey, CR9 6BE  
Tel: +44(0)208 886 8212 Fax: +44(0) 208 681 2499  
www.jacobs.com

Client: **HIGHWAYS AGENCY**

Project: **A14 CAMBRIDGE TO HUNTINGDON IMPROVEMENT SCHEME**

Drawing title: **ENGINEERING SECTIONS A14 MAINLINE SHEET 25 OF 59 REGULATIONS 5(2)(o) & (p) & 6(2)**

Drawing suitability: **DCO Submission**

Scale: 1:2500@A1, 1:5000@A3

Jacobs No. 233193-00

Client no.

Drawing number: **A14-ARP-ZZ-00-DR-Z-04025**

Rev: **0**