

- NOTES:**
1. All dimensions are in metres unless stated otherwise.
 2. These plans should be read in conjunction with other plans and documents in the Development Consent Order, in particular the Book of Reference.
 3. The numbers in circles relate to plot numbers. Refer to the Book of Reference for more information about these plots including the area of each plot.
 4. The plot numbers shown on this plan are consistent with the plot numbers shown on the associated Land Plans. Plot numbers shown on the Land Plans include a reference to the relevant sheet of the Land Plans. In this numbering convention, a plot number comprises the sheet number followed by the actual plot number: e.g. Plot 30/14 - where "30" is the sheet number and "14" is the plot number. As a result, plots shown on this plan will not necessarily match the sheet number of this plan. The key plans below indicate equivalent sheet numbers in the sets of Crown Land Plans and Land Plans.

- Key:**
- Development Consent Order Boundary/Limits of Order Land
 - Plot Boundary
 - Known / Presumed Crown Land Interest of Secretary of State for Transport (including land interest formerly held by the Secretary of State for Transport, Local Government and the Regions).
 - Known / Presumed Crown Land Interest of the Secretary of State for the Environment, Food and Rural Affairs
 - Known / Presumed Crown Land Interest of the Treasury Solicitor's Department, Bona Vacantia Division
 - Known / Presumed Crown Land Interest of the Highways Agency Historical Railways Estate
 - Parish Boundary
 - Existing Bridleway
 - Existing Footpath

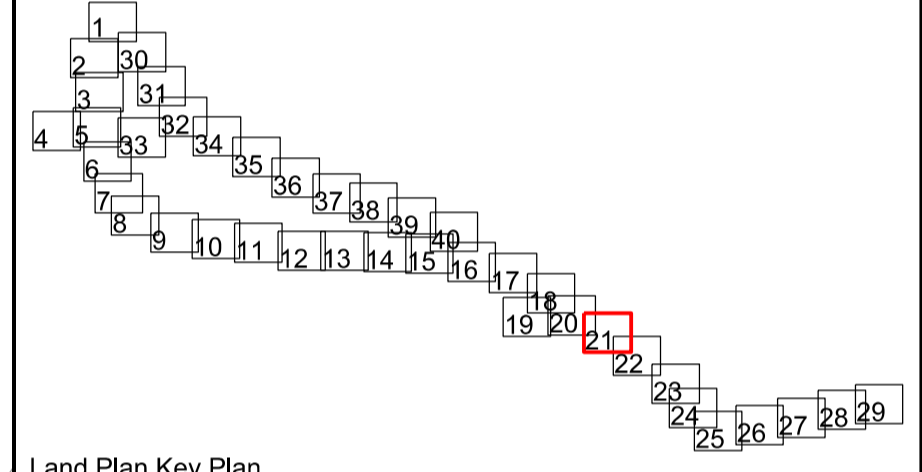
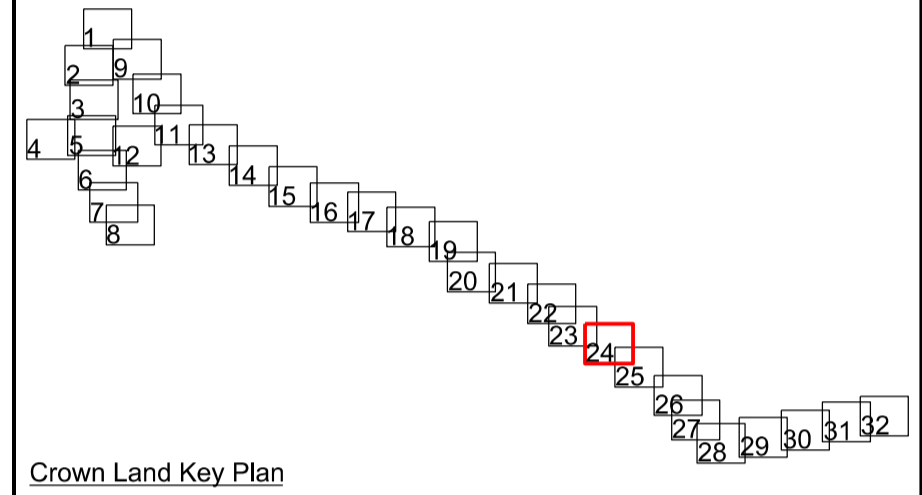

This map is based on Ordnance Survey material with the permission of Ordnance Survey on behalf of the controller of Her Majesty's Stationery Office. © Crown copyright. Unauthorised reproduction infringes Crown copyright and may lead to prosecution or civil proceedings. Highways Agency 100018928, 2008.

0	15/12/14	DCO SUBMISSION	PN	AP	PS	MB
Rev	Rev. Date	Purpose of revision	Drawn	Checked	Rev'd	Apprv'd

JACOBS
 Simpson House, 6 Cherry Orchard Road, Croydon, Surrey, CR9 6BE
 Tel: +44(0)208 686 8212 Fax: +44(0) 208 681 2499
 www.jacobs.com

Client: _____ Employer: _____
HIGHWAYS AGENCY

Project: **A14 CAMBRIDGE TO HUNTINGDON IMPROVEMENT SCHEME**

Drawing title: **CROWN LAND PLANS REGULATION 5(2)(n) SHEET 24 OF 32**

Drawing suitability: **DCO Submission**

Scale: 1:2500@A1, 1:5000@A3
 Anup Job No.: 233193-00

Drawing number: **A14-ARP-ZZ-00-DR-Z-00624** Rev: **0**

This drawing is not to be used in whole or part other than for the intended purpose and project as defined on this drawing. Refer to the contract for full terms and conditions.

