

CUTLINE CONTINUED ON SHEET 1

CUTLINE CONTINUED ON SHEET 2

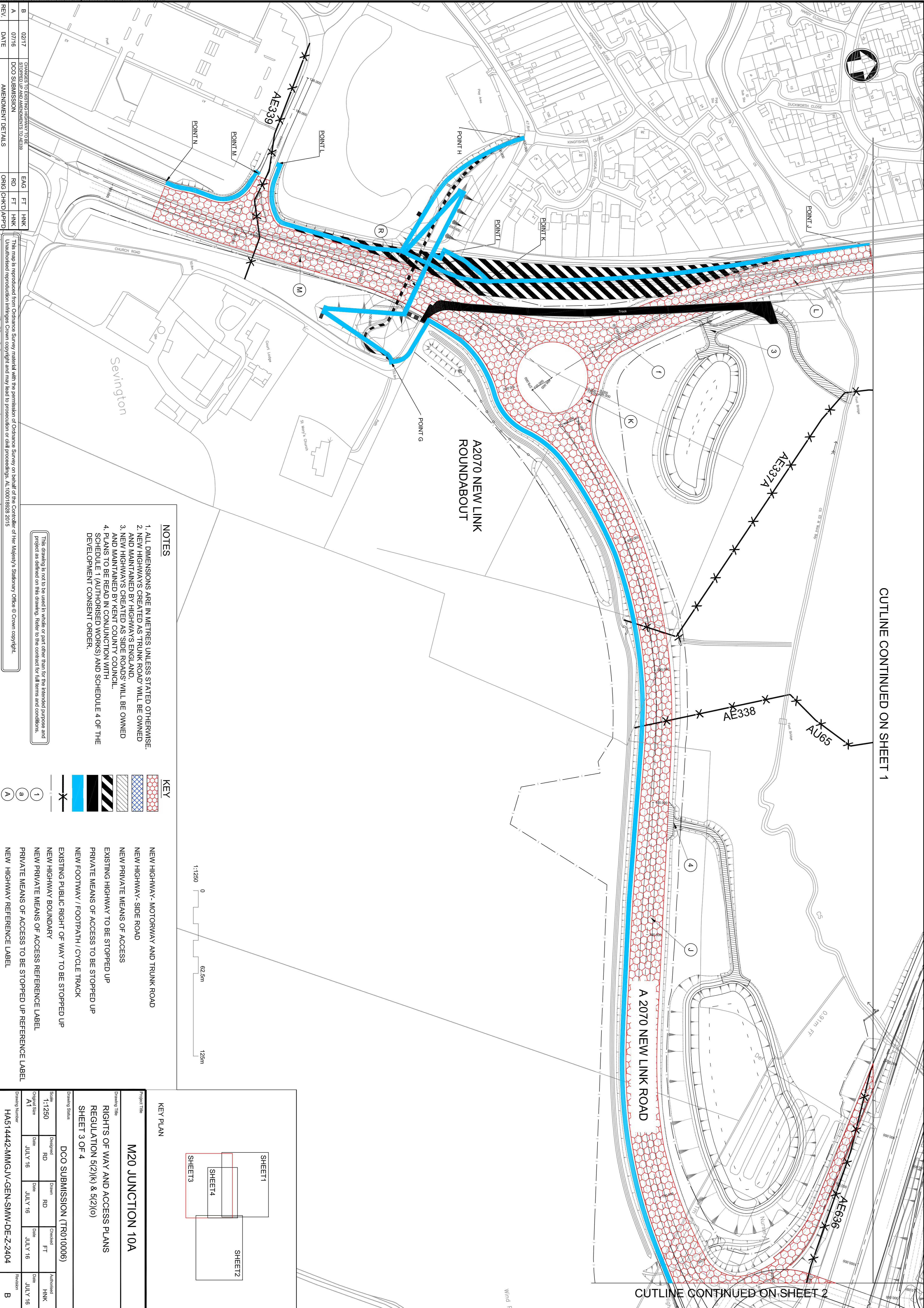

NOTES

1. ALL DIMENSIONS ARE IN METRES UNLESS STATED OTHERWISE.
2. NEW HIGHWAYS CREATED AS TRUNK ROAD WILL BE OWNED AND MAINTAINED BY HIGHWAYS ENGLAND.
3. NEW HIGHWAYS CREATED AS SIDE ROADS WILL BE OWNED AND MAINTAINED BY KENT COUNTY COUNCIL.
4. PLANS TO BE READ IN CONJUNCTION WITH SCHEDULE 1 (AUTHORISED WORKS) AND SCHEDULE 4 OF THE DEVELOPMENT CONSENT ORDER.

KEY

	NEW HIGHWAY - MOTORWAY AND TRUNK ROAD
	NEW HIGHWAY - SIDE ROAD
	NEW PRIVATE MEANS OF ACCESS
	EXISTING HIGHWAY TO BE STOPPED UP
	PRIVATE MEANS OF ACCESS TO BE STOPPED UP
	NEW FOOTWAY / FOOTPATH / CYCLE TRACK
	EXISTING PUBLIC RIGHT OF WAY TO BE STOPPED UP
	NEW HIGHWAY BOUNDARY
	NEW PRIVATE MEANS OF ACCESS REFERENCE LABEL
	PRIVATE MEANS OF ACCESS TO BE STOPPED UP REFERENCE LABEL
	NEW HIGHWAY REFERENCE LABEL

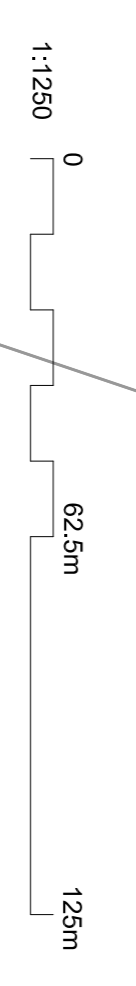

KEY PLAN

M20 JUNCTION 10A

RIGHTS OF WAY AND ACCESS PLANS
REGULATION 5(2)(k) & 5(2)(o)
SHEET 3 OF 4

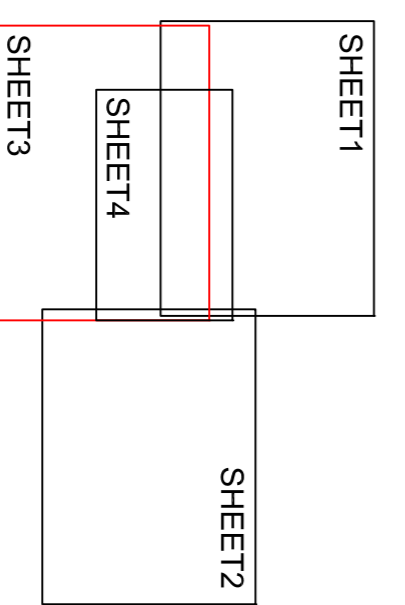

Project Title		M20 JUNCTION 10A	
Drawing Title		RIGHTS OF WAY AND ACCESS PLANS REGULATION 5(2)(k) & 5(2)(o) SHEET 3 OF 4	
Drawing Status			
DCO SUBMISSION (TR010006)	Designed	Drawn	Checked
	RD	RD	FT
	Date	Date	Date
	JULY 16	JULY 16	JULY 16
Scale	1:1250	Original Size	A1
Drawing Number	HA514442-MMGLV-GEN-SMW-DE-Z-2404	Revision	B

REV.	DATE	CHANGES TO EXISTING HIGHWAY TO BE STOPPED UP AND AMENDMENTS TO AE339	ENG	FT	HNK
A	07/16	DCO SUBMISSION	RD	FT	HNK
B	02/17	CHANGES TO EXISTING HIGHWAY TO BE STOPPED UP AND AMENDMENTS TO AE339	RD	FT	HNK

This map is reproduced from Ordnance Survey material with the permission of Ordnance Survey on behalf of the Controller of Her Majesty's Stationary Office © Crown copyright. Unauthorised reproduction infringes Crown copyright and may lead to prosecution or civil proceedings. AL1000182828 2015

This drawing is not to be used in whole or part other than for the intended purpose and project as defined on this drawing. Refer to the contract for full terms and conditions.