

Inset of proposed Construction Compound and Storage Area at - Alamein Barracks Driffield. YO25 9HD  
Scale 1:2500 @ A0

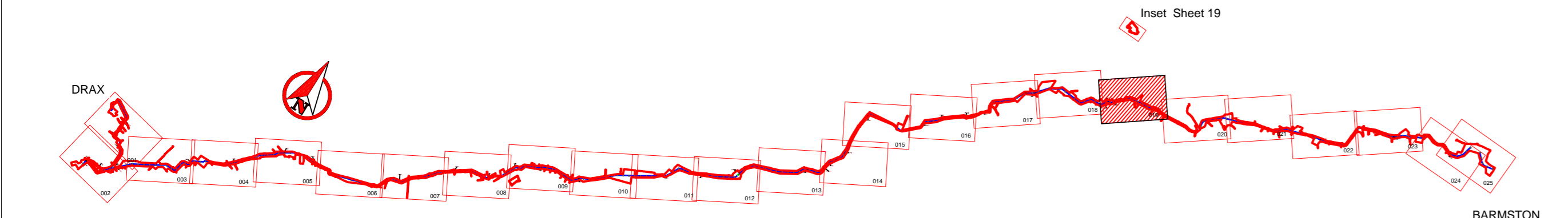
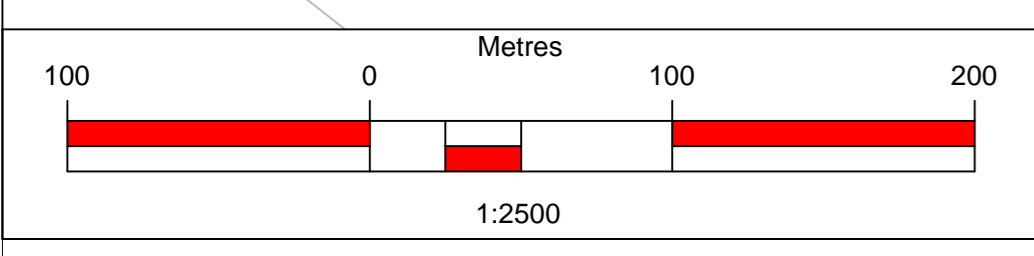
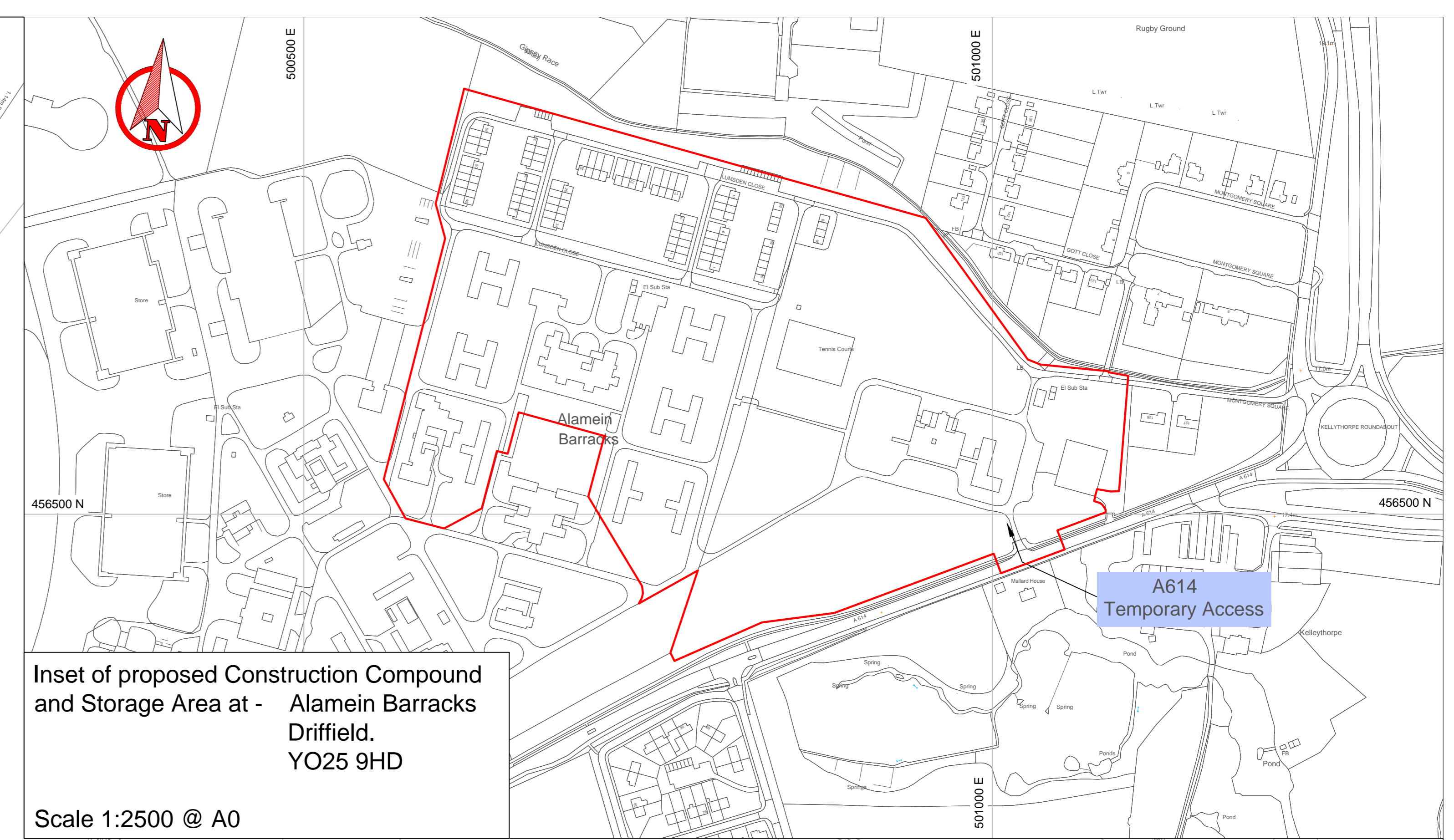

**Legend**

Order Limits	Pipeline Centre Line	RDX 1/A Temporary Access	Access Required
Above Ground Installations	Line of Obstruction	RDX 1/B Permanent Access	Permanent Access Required
RDX 31 (UNMAPPED) Road Crossing Identification	Public Right of Way	RDX 3/A Temporary Access	Temporary Stopping Up of Street
RDX 32 (UNMAPPED) Externs of Temporary Stopping up of streets and Rights of Way	Long Over-Flights	RDX 3/B Temporary Access	Rights of Way Identification
		RDX 35/A Temporary Access	Track Crossing Identification
		RDX 35/B Temporary Access	

Refer to Development Consent Order Schedules (S1 & S7) for Details

Background Mapping reproduced from Ordnance Survey Data, with the permission of the Controller of Her Majesty's Stationary Office.  
© Crown Copyright & Database Rights(2014). National Grid Carbon Ltd. Licence - 100055005.

**YORKSHIRE AND HUMBER  
CARBON CAPTURE AND STORAGE  
CROSS COUNTRY PIPELINE**

Co-financed by the European Union's  
European Energy Programme for Recovery.

© National Grid Carbon Limited (2013)  
All rights reserved. No part of this work  
may be reproduced or used in any form  
(including storage by electronic means)  
without the written permission of National Grid  
Carbon Limited.

WARNING: Any unauthorised act in relation  
to the work may result in both a civil claim for  
damages and criminal prosecution.

**nationalgrid**

National Grid Carbon Limited  
31 Homer Road  
Solphull  
West Midlands  
B91 3LT

DE	24/04/15	DEADLINE 8 SUBMISSION	B	Route Number	DCO Submission Route	Drawn	DE	Date	30th April 2014
DE	30/04/14	ISSUED FOR DCO SUBMISSION	A	Scale	1:2,500 @ A0	Sheet	DE	Sheet	Sheet 19 of 25
Down	Date	Comments	Rev	Drp No	10-2574-GND-01-05-0079	Rev	B		

Location Key Plan  
ACCESS, RIGHTS OF WAY AND STOPPING UP PLANS  
APFP Regulation 5(2)(k)  
PINS Reference EN070001  
Document Reference 2.4