

NOTE:  
FOR CLARITY THE WELD MESH IS EXCLUDED FROM THE VIEWS BELOW

DETAIL OF WELD MESH SECURITY FENCE  
(SCALE 1:10)

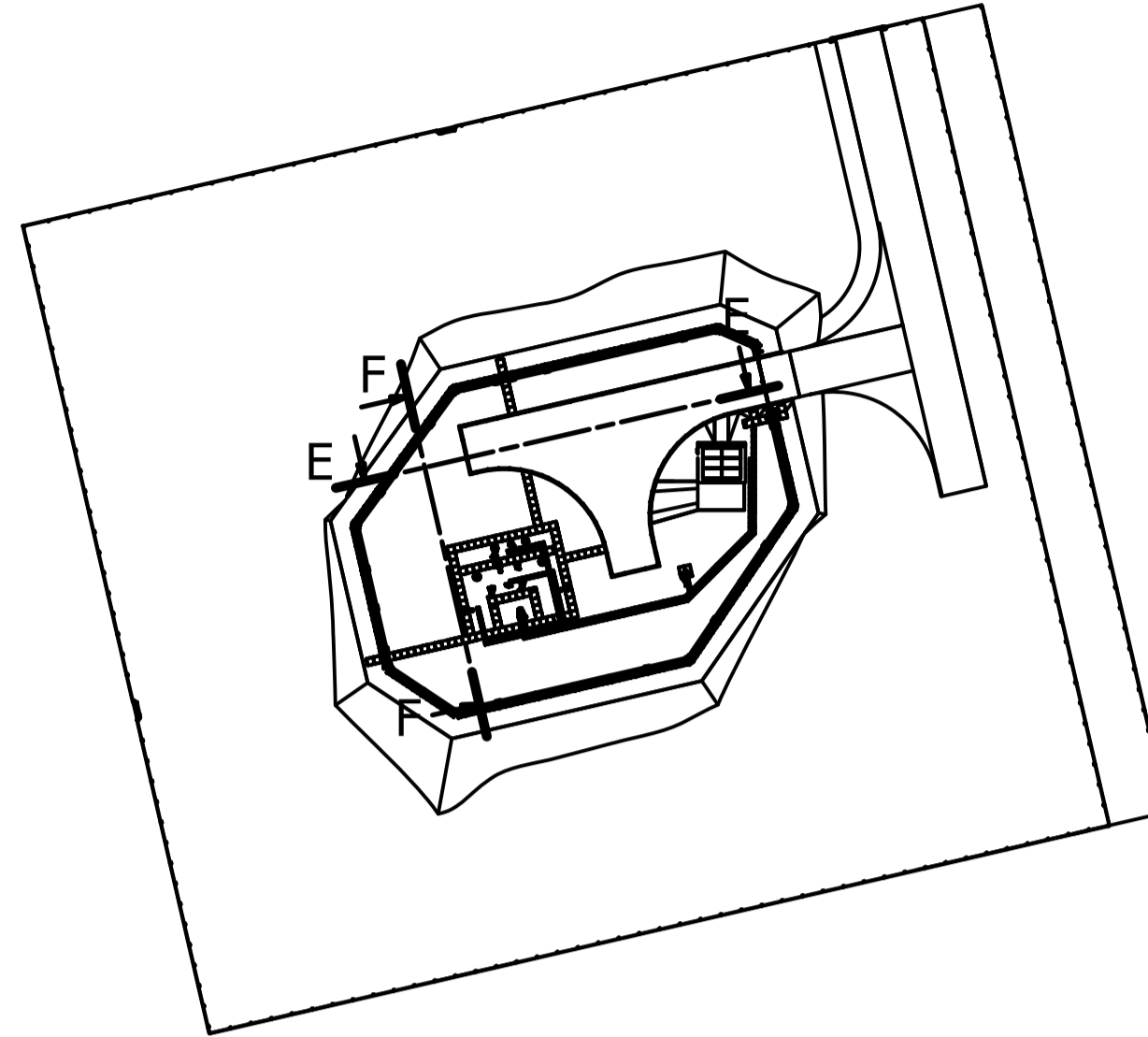

PLAN VIEW  
(SCALE 1:600)

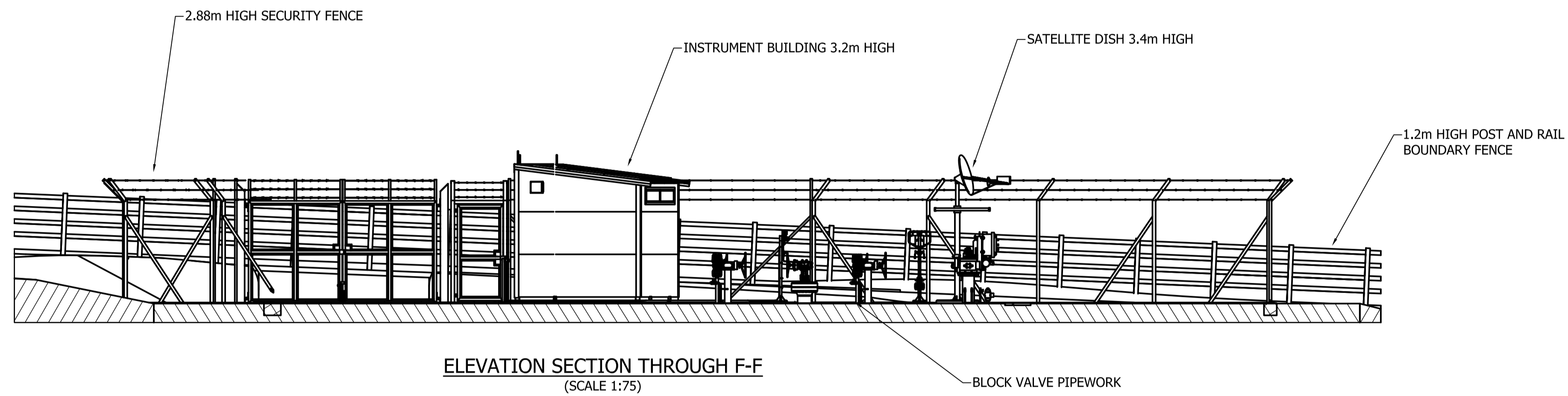

ELEVATION SECTION THROUGH F-F  
(SCALE 1:75)

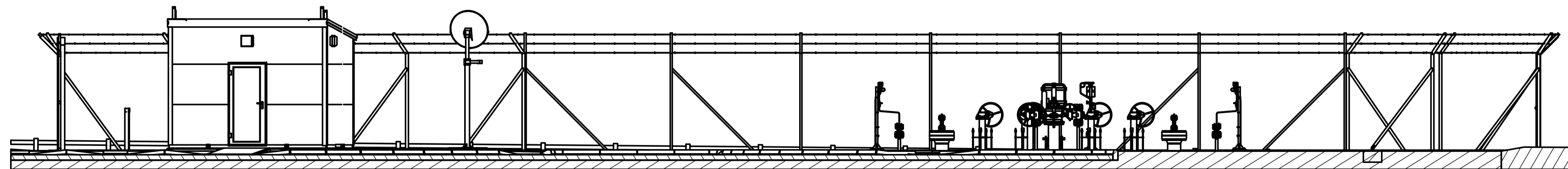

ELEVATION SECTION THROUGH E-E  
(SCALE 1:75)

NOTES:

1. APPROPRIATE PLANTING LANDSCAPING WILL BE PROVIDED TO SCREEN THE SITE FROM PUBLIC VIEW. SEE PLANTING DRAWING 10-2574-PLN-01-0331.
2. ALL ABOVE GROUND PIPEWORK, VALVES AND INSTRUMENT BUILDING TO BE PAINTED OLIVE GREEN.
3. 2.88m HIGH SECURITY FENCE GALVANISED STEEL POSTS WITH WELD MESH INFILL. FENCE TOPPED WITH THREE STANDS OF BARBED WIRE.
4. INSTALLATION GROUND FINISHED WITHIN SECURITY FENCE WILL BE STONE CHIPPINGS.
5. FOR CLARITY PLANTING AND LANDSCAPING NOT SHOWN ON THESE ELEVATIONS FOR TYPICAL TREE MIX AND SHRUB MIX CANOPY HEIGHTS SEE OTHER ELEVATION DRAWINGS 10-2574-GA-01-0323 AND 10-2574-GA-01-0324.
6. ALL SHOWN DIMENSIONS ARE MAXIMA.

CLIENT



National Grid Carbon LTD  
31 Homer Road  
Solihull  
West Midlands  
B91 3LT

DRAWN	Steve Rocks
DATE	JUNE 2014
Tel : 01530 563000 Email: info@premtchtd.com www.premtechtd.com	

PROJECT YORKSHIRE AND HUMBER  
CARBON CAPTURE AND STORAGE  
CROSS COUNTRY PIPELINE

TITLE DALTON BLOCK VALVE  
ELEVATIONS (OPERATIONAL SITE)  
REGULATION 5(2)(0)  
PINS REFERENCE No: EN070001  
DOCUMENT REFERENCE 2.43

SHEET	1	OF	1	SCALE	SEE DRG	A1	
DRG No	10-2574-PLN-01-0324					ISSUE	B



Co-financed by the European Union's European Energy Programme for Recovery.

ISSUE	DATE	DRAWN	CHECKED	APPROVED	ISSUE	DATE	DRAWN	CHECKED	APPROVED	ISSUE	DATE	DRAWN	CHECKED	APPROVED	ISSUE	DATE	DRAWN	CHECKED	APPROVED	ISSUE	DATE	DRAWN	CHECKED	APPROVED	
AMENDMENT					AMENDMENT					AMENDMENT					AMENDMENT					AMENDMENT					
										B					A										
										MAR 2015					JUNE 2014										
										DE					S.ROCKS					IB					
										AMENDMENT					AMENDMENT					AMENDMENT					
										DEADLINE 4 SUBMISSION					DCO SUBMISSION										

© National Grid Carbon Limited (2014)  
All rights reserved. No part of this work may be reproduced or used in any form (including storage by electronic means) without the written permission of National Grid Carbon Limited.  
Warning: Any unauthorised act in relation to the work may result in both a civil claim for damages and criminal prosecution