

PLANTING TO BE ARRANGED AS INDICATED AND IN ACCORDANCE WITH RESTRICTIONS ON PLANTING PROXIMITY TO BURIED PIPELINES AND SECURITY FENCING

TREE AND SHRUB MIX

TO BE PLANTED AT LEAST 6m AWAY FROM BURIED PIPELINES. 600-900mm 1+1 FEATHERED WHIPS PLANTED AT 1.5m SPACING IN GROUPS OF 2-3 OF EACH SPECIES

Table with 3 columns: TREES, Percentage, and SHRUBS. Lists species like Quercus robur, Acer campestre, Malus sylvestris, etc.

STANDARD AND FEATHERED TREES WITHIN TREE & SHRUB MIX

Table with 5 columns: TREES, Girth, Height, No. Lists species like Quercus robur, Acer campestre with dimensions.

GROUP OF STANDARD OAKS AND FEATHERED FIELD MAPLE TO BE PLANTED IN GROUPS OF 3-5 OF EACH SPECIES NEAR SITE ENTRANCE.

STANDARD OAKS ALONG SOUTHERN BOUNDARY PLANTED AT MINIMUM 10m INTERVALS ADJACENT TO HEDGE.

STANDARD AND FEATHER TREES TO BE PLANTED AS BARE ROOTED STOCK. TREES SHALL BE FIXED TO SHORT STAKES, DRIVEN INTO THE GROUND AT THE BOTTOM OF THE TREE PIT EXCAVATIONS IN SUCH A POSITION TO ALLOW THE TREE TO BE PLANTED IN THE CENTRE OF THE PIT AND THE STAKE AT THE PREVAILING WINDWARD SIDE OF THE TREE IN ACCORDANCE WITH NGC/SP/ENV/2.

SHRUB MIX

TO BE PLANTED 1.5m - 6m FROM BURIED PIPELINES. (N.B. 3m GAP IN PLANTING OVER PIPELINES). 600-900mm 1+1 FEATHERED WHIPS PLANTED AT 1.5m SPACING IN GROUPS OF 2-3 OF EACH SPECIES.

Table with 3 columns: SHRUBS, Percentage. Lists species like Crataegus monogyna, Prunus spinosa, etc.

HEDGE MIX

HEDGE BANK TO BE CREATED 1500mm WIDE AND 500mm HIGH. HEDGE TO BE PLANTED AS 600-900mm 1+1 FEATHERED WHIPS PLANTED IN TWO STAGGERED ROWS 450mm APART WITH 6 PLANTS PER METRE.

Table with 3 columns: SHRUBS, Specification, Percentage. Lists species like Crataegus monogyna, Prunus spinosa with specifications.

WILDFLOWER MIX

Wildflower Mix - Tussock Mixture EM10

Large table listing Wildflower species, %Mix, Common Name, and Grasses. Includes species like Achillea millefolium, Agrimonia eupatoria, etc.

HEDGEBANK TO BE SOWN WITH A MIXTURE OF PERENNIAL HERBS AND TALL TUSSOCK-FORMING GRASSES. EMORSGATE EM10 TUSSOCK MIXTURE OR SIMILAR SOWN AT A RATE OF 40kg/ha (4gm²)

WILDFLOWER MIX TO BE EMORSGATE EM10 TUSSOCK MIXTURE OR SIMILAR SEED SOWN AT A RATE OF 40kg/ha (4gm²)

MOWN AMENITY GRASS MIX TO BE MAINTAINED AROUND SECURITY FENCE ADJACENT TO PATHS AND ROADS

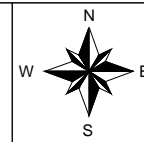

- NOTES: 1. ALL PLANTING, MULCHING AND LANDSCAPE WORKS TO BE CARRIED OUT IN ACCORDANCE WITH NATIONAL GRID TECHNICAL SPECIFICATION FOR LANDSCAPE WORKS NGC/SP/ENV/2 INCLUDING TREE PLANTING GUIDELINES. 2. ALL PLANTS SHALL BE OF BRITISH ORIGIN AND PREFERABLY LOCAL PROVENANCE. 3. ALL PLANTS SHALL COMPLY WITH HTA NATIONAL PLANT SPECIFICATION DOCUMENT. 4. ALL TREES AND SHRUBS SHALL CONFORM TO BS 3936; PART 1 NURSERY STOCK SPECIFICATION FOR TREES AND SHRUBS. TREES WITH VIGOROUS EVENLY DEVELOPED CROWNS, SINGLE ORIGINAL LEADER AND EVEN FIBROUS ROOT SYSTEM. SHRUBS WELL BRANCHED, WELL ROOTED STURDY PLANTS. 5. SHRUBS ONLY TO BE PLANTED WITHIN 3m OF BURIED PIPES. NO PLANTING WITHIN 2m OF ABOVE GROUND INSTALLATION SECURITY FENCING. 6. POST AND WIRE RABBIT PROOF FENCING SHALL BE ERECTED AROUND THE ENTIRE PLANTING AREA IN ACCORDANCE WITH NGC/SP/ENV/2. WITH RABBIT PROOF ACCESS GATES WHERE REQUIRED. 7. RABBIT PROTECTION PROVIDED FOR THE TREE AND SHRUB PLANTING SHALL BE RABBIT PROOF GUARDS IN ACCORDANCE WITH NGC/SP/ENV/2. 8. A FIVE YEAR DEFECTS AND MAINTENANCE PERIOD SHALL APPLY DURING WHICH TIME THE NEW PLANTING SHALL BE MAINTAINED IN ACCORDANCE WITH NATIONAL GRID MANAGEMENT PROCEDURE FOR MAINTENANCE OF LANDSCAPED SITES NGC/MP/ENV/3 INCLUDING REPLACEMENT PLANTING OF DEAD DYING AND DISEASED STOCK. 9. AREA B (OUTLINED IN PURPLE) TO BE SOWN WITH WILD FLOWER MIX PRIOR TO THE INSTALLATION OF 3 PIG TRAPS FOR FUTURE CONNECTIONS. PLUS ASSOCIATED INFRASTRUCTURE. THIS IS CONTROLLED BY REQUIREMENT 6.

KEY: AREA B - 3 PIG TRAPS FOR FUTURE CONNECTIONS, PLUS ASSOCIATED INFRASTRUCTURE. APPROXIMATE POSITION OF EXISTING TREES. STANDARD TREE. FEATHERED TREE. SHRUB MIX. WILDFLOWER MIX. HEDGE MIX. TREE AND SHRUB MIX.

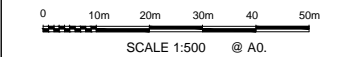
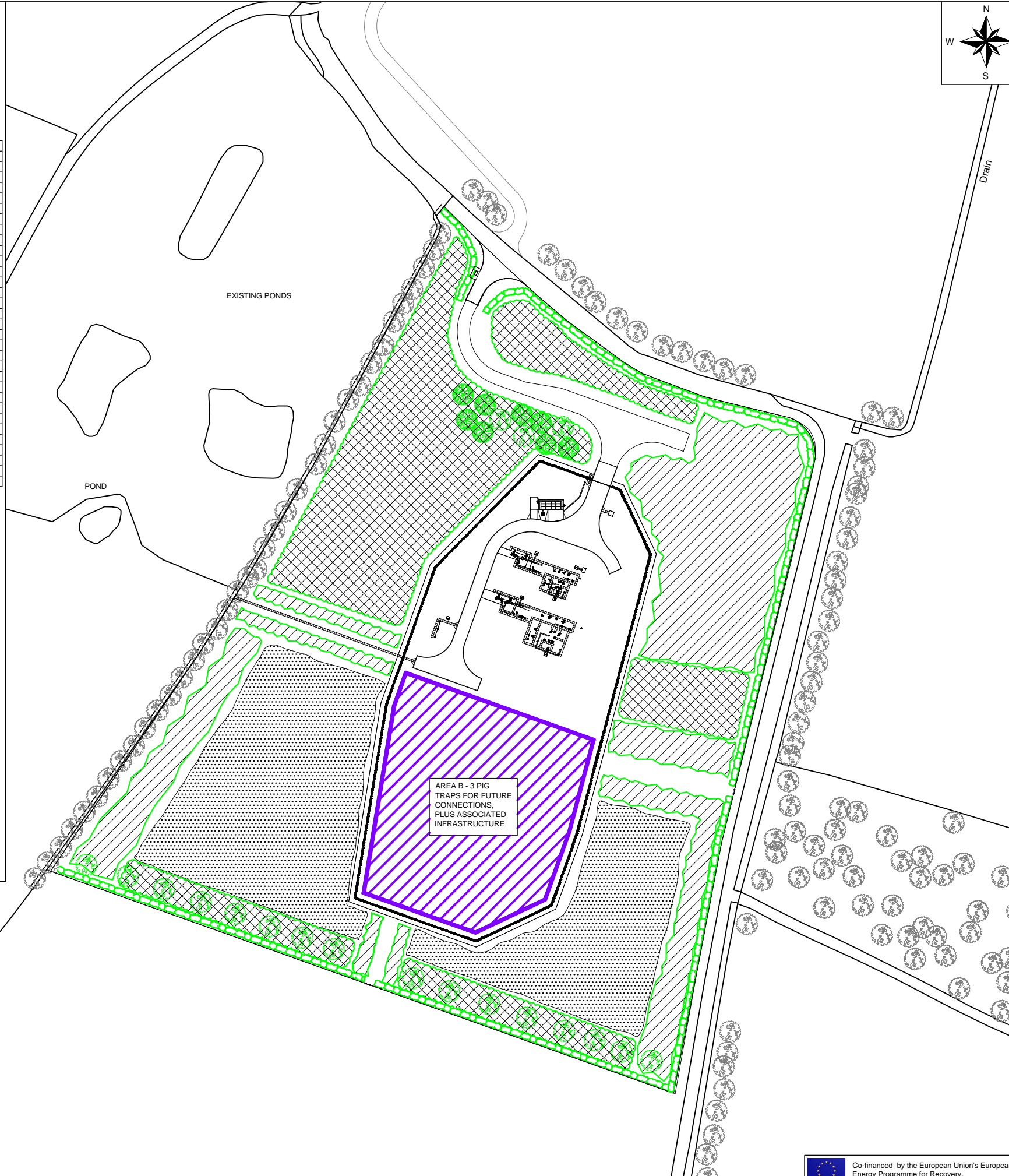

Approval table with columns for ISSUE, DATE, DRAWN, CHECKED, APPROVED, AMENDMENT. Issues I through A are listed, with Issue A being the current version (JUNE 2014, DMP, IB, JB).

Client information: nationalgrid. National Grid Carbon LTD, 31 Homer Road, Solihull, West Midlands, B91 3LT. PROJECT: YORKSHIRE AND HUMBER CARBON CAPTURE AND STORAGE CROSS COUNTRY PIPELINE. TITLE: CAMBLESFORTH MULTI-JUNCTION PLANTING DRAWING. APPF REGULATION 5(2)(O) PINS REFERENCE No: EN070001 DOCUMENT REFERENCE 2.30. SHEET 1 OF 1. SCALE 1:500 @ A0. DRG No 10-2574-PLN-01-0328. ISSUE A.

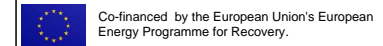

© National Grid Carbon Limited (2014) All rights reserved. No part of this work may be reproduced or used in any form (including storage by electronic means) without the written permission of National Grid Carbon Limited. Warning: Any unauthorised act in relation to the work may result in both a civil claim for damages and criminal prosecution.