

Outer Dowsing Offshore Wind

The Applicant's Change Request dated 24 October 2024

Date: October 2024
Document Reference: 18.22
Rev: 1.0

Company:	Outer Dowsing Offshore Wind		Asset:	Whole Asset		
Project:	Whole Wind Farm		Sub Project/Package:	Whole Asset		
Document Title or Description:	18.22 The Applicant's Change Request dated 24 October 2024					
Internal Document Number:	PP1-ODOW-DEV-CS-LET-0023		3 rd Party Doc No (If applicable):	N/A		
Rev No.	Date	Status / Reason for Issue	Author	Checked by	Reviewed by	Approved by
1.0	October 2024	Response to Procedural Decision within Rule 8 Letter of 17 October 2024 (PD-011)	Shepherd and Wedderburn	Outer Dowsing	Outer Dowsing	Outer Dowsing

FAO: Louise Harraway
Case Manager
National Infrastructure Planning
Planning Inspectorate
Temple Quay House
Temple Quay
Bristol
BS1 6PN

[outerdowsing.com](https://www.outerdowsing.com)
2nd Floor, Boundary House
91-93 Charterhouse Street
London
EC1M 6HR

24 October 2024

Dear Louise,

**Planning Act 2008 – Application for Development Consent
GT R4 Limited, trading as Outer Dowsing Offshore Wind (the “Applicant”)
The Proposed Outer Dowsing Offshore Wind Farm Order
Change Request
Application Reference: EN010130**

The Applicant refers to:

- the Applicant’s Change Notification of 29 August 2024 (AS-021) and the Examining Authority’s (“**ExA**”) procedural decision (PD-008) which responds to it; and
- the Applicant’s Change Notification of 8 October 2024 (AS-025 “Response to the ExA’s Procedural Decision and Change Notification”) and the ExA’s corresponding procedural decision contained within its Rule 8 Letter (PD-011, B5-B7).

This letter provides the Change Requests which the Applicant was requested to submit in the above procedural decisions (PD-008; PD-011).

The Applicant notes that the ExA has decided that a number of the amendments notified in AS-025 should not be subject to a formal change request¹ and other changes require further consultation prior to the relevant change application being submitted.² The Applicant will be carrying out the

¹ Minor onshore works number amendments – change from landscaping works to drainage works; Reductions in the compulsory acquisition rights sought from freehold acquisition to acquisition of permanent rights in respect of certain plots; and Changes to documents to account for an additional pipeline crossing

² Changes to documents to account for five recently identified proposed Public Rights of Way (“**PROWs**”), the proposed diversions to three of those five PROWs; The introduction of the Offshore Restricted Build Area (“**ORBA**”).

recommended consultation and will submit a Change Request related to those changes listed at (a) and (b) of page B6 of PD-011 at a future deadline.

This letter provides the Applicant’s Change Request for the following proposed changes which were notified in AS-021 and AS-025:

- **Change 1:** The change resulting from updates to the Ordnance Survey (“OS”) MasterMap data which identified changes to the Mean High Water Springs (“MHWS”) and Mean Low Water Springs (“MLWS”) dataset (Notified in AS-021).
- **Change 2:** Revision to the Offshore Export Cable Corridor (“ECC”) (Notified in AS-025).
- **Change 3:** Onshore Order Limit reductions - removal of unnecessary plots (Notified in AS-021 and AS-025).

Table 1 below signposts to where, within this Change Request, the information required by the relevant guidance³ is provided.

Table 1: Information to include in the change application

Section of Change Request	Information required to be included in change application (extracts from the Change Guidance)
Column A	Column B
<p>Appendix 1: Requested Changes provides the Applicant’s description of the reasons for and need for the relevant change; a description of the proposed change; the applicant’s position on whether the Infrastructure Planning (Compulsory Acquisition) Regulations 2010 (the “CA Regulations”) are engaged; an overview of the Consultation which has taken place and the Applicant’s position on whether there are any new or different likely significant environmental effects (“LSE”)</p>	<p><i>“A confirmed description of the proposed change. Where this has changed from that provided with the change notification this should be clearly explained”.</i></p> <p><i>“A confirmed statement setting out the reasons and need for making the change. The applicant should provide any further information that was not included in the change notification.”</i></p> <p><i>“A statement identifying any impact the proposed change would have on securing any consents or licences for the project.”</i></p> <p><i>“If the proposed change includes a request to include additional compulsory acquisition powers, confirmation that the applicant has consent from all persons with an interest in the additional land that the additional powers can be included in the application. Evidence of the consent must be provided...”</i></p> <p>[...]</p> <p><i>“The applicant should also include a detailed description of how they consider the procedures in</i></p>

³ Step 4 (“The change application”) of the Nationally Significant Infrastructure Projects: Changes to an application after it has been accepted for examination (the “**Change Guidance**”)

Section of Change Request	Information required to be included in change application (extracts from the Change Guidance)
	<p><i>regulations 6 to 19 of the CA Regulations can be accommodated within the examination timetable.”</i></p> <p><i>“If the proposed change results in any new or different likely significant environmental effects, provision of other environmental information as necessary and confirmation that:</i></p> <ul style="list-style-type: none"> <i>• the effects of the proposed change have been adequately assessed and that the environmental information has been subject to publicity...</i> <i>• any consultation bodies who might have an interest in the proposed change have been consulted (reflecting the requirements of the EIA Regulations 2017). The applicant should identify those consultation bodies who were consulted on the proposed changes but were not consulted on the original application”</i>
<p>Appendix 2: Consultation Report provides a description of the consultation which has taken place in relation to each proposed change and provides evidence of such consultation;</p>	<p><i>“Where consultation has been carried out (either voluntarily, at the direction of the Examining Authority, or in accordance with the requirements of the CA Regulations or EIA Regulations 2017) a consultation report must be provided.”</i></p>
<p>Appendix 3: Document updates and Schedule of all Application Documents provides a full schedule of which documents relate to the proposed change and provides the Applicant’s position on other document updates required in the Change Guidance.</p>	<p><i>“A full schedule of all application documents and plans listing the revisions to each document and plan which would occur because of the change or, as necessary, marked as ‘no change’.”</i></p>
<p>Appendix 4: Plan illustrating minor onshore Order Limit reductions notified in AS-025 provides plans to illustrate this change</p>	<p>N/A</p>
<p>Appendix 5: Plan illustrating minor onshore Order Limit reductions referred to in AS-021 provides plans to illustrate this change</p>	<p>N/A</p>

The Change Guidance also refers to the submission of the following documents:

- Clean and track changed versions of the draft DCO showing the proposed changes. Also, clean and track changed versions of the draft explanatory memorandum;
- a supplemental land rights tracker giving details of the status of negotiations about the additional land.

Version 2 of the dDCO submitted with the Applicant’s Response to Section 51 Advice (clean: AS1-024; tracked: AS1-025) updated the dDCO to reflect the changes that would be required to the dDCO as a

result of the proposed changes to MHWS and MLWS, and the proposed onshore Order Limit reductions that were referred to in the Applicant's Change Notification dated 29 August (AS-021).

Version 3 of the dDCO submitted at the Procedural Deadline of 19 September (clean: PD1-024; tracked: PD1-025) shows the proposed revision to the Offshore ECC, and the proposed further onshore Order Limit reductions that were the subject of the Applicant's Response to the ExA's Procedural Decision 30 September 2024 and Change Notification (AS-025).

It should be noted that the latest version of the dDCO includes amendments which remain the subject of a future change request, being the Changes to documents to account for five recently identified proposed Public Rights of Way, the proposed diversions to three of those five Public Rights of Way; the introduction of the Offshore Restricted Build Area.

None of the changes described in this Change Request have prompted changes to the explanatory memorandum and hence a new version has not been provided.

The only change within this Request which includes additional land is Change 1 (Amendments to MHWS and MLWS). The land rights tracker which was submitted by the Applicant at the Procedural Deadline of 19 September (PD1-072) was drafted following the inclusion of this change in application documents and includes details of the status of negotiations about the additional land.

If we can be of any further assistance, please contact Beth Travis [REDACTED] (outerdowsing.com).

Yours sincerely,

[REDACTED]
Development Manager
Outer Dowsing Offshore Wind

1 Appendix 1: Requested Changes

1.1 Change 1: Amendments to MHWS and MLWS

1.1.1 Description of the Proposed Change

As set out in AS-021, after the Applicant submitted its DCO Application, the OS mapping upon which the Order Limits and associated plans are based was updated to amend the MHWS and MLWS. This has resulted in the MHWS and MLWS mark within the ODOW Order limits moving. The extent of this change is presented in Figure 1 of the Applicant's Approach to Ordnance Survey Mapping Update submitted on 31 July 2024 (AS1-109).

As a consequence of the updated OS mapping, the extent and shape of land plots immediately adjacent to MLWS and MHWS changed and plot 01-003 was removed from the Order land. The Applicant updated all of the plans that were submitted to support the DCO Application (Documents 2.1 to 2.20, inclusive) to reflect the updated OS mapping at MLWS and MHWS and submitted these with the Applicant's Response to S51 advice (the "S51 Response"). The suite of documents which included these changes was AS1-004 – AS1-023. However, the Applicant subsequently submitted updated versions of each of these plans (PD1-004 – PD1-023) due to subsequent changes to the application, the reasons for which are set out in the Applicant's Procedural Deadline 19th September Covering Letter (PD1-001) and the Applicant's Response to the ExA's Procedural Decision and Change Notification (AS-025), in which the Applicant provided further explanation in response to the ExA's Procedural Decision (PD-010). These plot changes were first set out in the Schedule of Changes to the Book of Reference (AS1-031) and have since been reflected in the subsequent versions of the Schedule of Changes to the Book of Reference. These changes were reflected in the Book of Reference (from version AS1-029 onwards) and Statement of Reasons (from version AS1-032 onwards). Plot 01-003 was removed from Schedule 7 of the Draft DCO from version AS1-024 onwards.

There are three areas (shown in Figure 2 of AS1-109) where the MLWS mark is now seaward of the MLWS mark presented in the ODOW documents at application. This means that these three areas are now considered to form part of the onshore Order land and fall within plot 01-002 on the Land Plans over which the Applicant is seeking powers to compulsorily acquire permanent rights.

Some land previously within plot 01-002 is now seaward of MLWS and has therefore been removed from the onshore Order land due to the change in MLWS.

All updates to plots are set out in the Applicant's Schedule of Changes for Plans. This was originally submitted with its S51 Response Schedule of Changes for Plans (AS1-003) and has been reflected in subsequently provided versions of the Schedule of Changes to Plans (see, more recently, PD1-003). It should be noted that it has not been necessary to make any updates to the Compulsory Acquisition Funding Statement due to the very small nature of the changes.

1.1.2 Reason and need for change

This change is necessary in order to accurately show the locations of the MHWS and MLWS marks in relation to the Order land, and to ensure that the draft Development Consent Order (document 3.1, version 4) provides the Applicant with the necessary powers required to construct, operate, maintain

and decommission the project on land which is considered to be within the onshore Order limits by reason of the change in the MHWS and MLWS.

1.1.3 Securing consents and licences

The Applicant confirms that the proposed change does not impact on securing any consent or licences for the project nor will it create any delay in securing such consents or licences.

1.1.4 Compulsory Acquisition

As set out in AS-021, the three areas of land discussed above (shown in Figure 2 of AS1-109) fall within the definition of “additional land” set out in the CA Regulations (being land over which compulsory acquisition powers are sought and which was not identified in the book of reference submitted with the application) because they were not included in the Book of Reference or shown on the Land Plans submitted with the Application. These areas did however fall within the Order Limits within the Applicant’s application for development consent, but because they were seaward of MLWS based on the location of the MHWS and MLWS at the time of submission, they were not shown on the Land Plans or listed in the Book of Reference.

Plot 01-002 is owned by The Crown Estate (“TCE”) and the Applicant has engaged with TCE in respect of this amendment. As evidenced in Appendix 2, TCE has advised that it consents, for the purpose of regulation 4(b) of the CA Regulations, to the provision in the DCO authorising compulsory acquisition powers in respect of the “additional land” provided that:

- a. The “additional land” is treated the same as all other Crown land in the Book of Reference (i.e. the text “(excluding all interests of the Crown)” is included in the description of the relevant plots in the Book of Reference); and
- b. The “additional land”, like all other Crown plots affected by the DCO, will be subject to Section 135(1) consent and the Applicant will need to enter into the Crown’s standard form agreement.

With respect to (a), the requested text is included in the description of the relevant plot (plot 01-002) in the Book of Reference (first provided in 4.1 of the S51 Response, AS1-029 and included in subsequent versions of the Book of Reference). Furthermore, the powers that apply to the “additional land” will be subject to Article 43 of the DCO which provides protection for Crown interests. With respect to (b), the Applicant is working with TCE in order to obtain Section 135 consent for all plots within the Order land in which the Crown has an interest.

In the Book of Reference submitted in June 2024 (AS-006), Chapel St Leonards Parish Council is listed as a Category 2 person in respect of plot 01-002 in relation to legal easements granted by lease dated 17 June 2004 however having reviewed the relevant lease, the Applicant can confirm that Chapel St Leonards Parish Council does not have any interests in plot 01-002 and their inclusion as a Category 2 person in the Book of Reference in relation to plot 01-002 is an error. The Applicant has removed Chapel St Leonards Parish Council as a Category 2 person in relation to plot 01-002 in the Book of Reference (Document 4.1, AS1-029) submitted with its S51 Response. Therefore, the consent of Chapel St Leonards Parish Council is not required for this small change to the Order land.

Following the Applicant carrying out the consultation requested by the ExA, Chapel St Leonards Parish Council has confirmed this position (see Consultation Report below).

Given that TCE has consented to the inclusion of the “additional land” and no other persons have an interest in the “additional land”, Regulations 5 to 19 of the CA Regulations do not apply.

1.1.5 New or different likely significant environmental effects

The Applicant can confirm that Change 1 does not give rise to any new or different likely significant environmental effects.

1.1.6 Consultation

Following advice from the ExA in its Procedural Decision (PD-008), the Applicant consulted with the Marine Management Organisation (the “**MMO**”) and Chapel St Leonards Parish Council. As set out in the Consultation Report in Appendix 2, the MMO confirmed that it welcomed the change made and Chapel St Leonards Parish Council confirmed that it did not have any interest in the Order Limits.

1.2 Change 2: Revision to the Offshore Export Cable Corridor (“Change 2”)

1.2.1 Description of the Proposed Change

The “northern option” within the offshore ECC within the inshore area (described below) has been removed from the Order Limits. In addition, a minor amendment has been made to the ORCP area within the southern route to exclude an area at the eastern extent. The total maximum offshore export cable lengths, number of cables, number of ORCPs and all other parameters remain, as provided within the DCO Application.

1.2.2 Reason and need for change

The offshore ECC presented within Application documents included two routing options within the inshore area of the cable route, a northern and a southern route: approximately 6.4km east of Mean High Water Springs, the offshore ECC split before the two sections joined approximately 21.4km north east of Mean High Water Springs. The northern route was included as it is situated north of the Inner Dowsing sandbank and thus avoided impacts to this designated feature. The southern route was also included as the northern route passes through aggregates Area 1805 which has an Exploration and Option area agreement with TCE, although this was due to expire on 31st August 2024. In the event that the option agreement was not taken up by the holder, this seabed area may have become available to the project, thus allowing the project to avoid crossing the Inner Dowsing sandbank.

It has now been confirmed that the option on this area has been extended by TCE until 2025 (pers. comms. Hansons via email 1st May 2024), with a Marine Licence Application (MLA/2024/00227) having been made by the agreement holder on 25th April 2024 to permit aggregates extraction within the site for a period of 15 years. As such, it is clear that the agreement holder intends to take up the option over this area of the seabed for aggregate extraction, and therefore it is no longer a viable option for the project to pursue. Consequently, the project has excluded the northern route from the offshore ECC and is amending the Order Limits to exclude this section of the offshore ECC from the draft DCO.

The minor amendment to the ORCP location within the southern route has been made as it would not be technically feasible to install the structures whilst meeting the minimum bend radii requirements for the offshore export cables.

The proposed change involves a reduction to the Order land offshore. One of the options included within the application Order land for the offshore ECC and ORCPs has been removed from the Order land as a result of the proposed change.

1.2.3 Securing consents and licences

The Applicant confirms that the change does not impact on securing any consent or licences for the project nor will it provide any delay in securing such consents or licences.

1.2.4 Compulsory Acquisition

The change does not involve a request to include additional compulsory acquisition powers therefore the procedures in regulations 5 to 19 of the CA Regulations do not apply.

1.2.5 New or different likely significant environmental effects

The environmental implications of this change have been reviewed to fully understand whether the changes affect the conclusions of the ES or the Report to Inform Appropriate Assessment (“**RIAA**”). The assessment in relation to the conclusions of the ES is set out in the Environmental Report for the Offshore Restricted Build Area and Revision to the Offshore Export Cable Corridor (PD1-081). The assessment in relation to the conclusions of the RIAA is set out in the Habitats Regulations Assessment for the Offshore Restricted Build Area and Revision to the Offshore Export Cable Corridor (PD1-091). The conclusions of these reports are that the proposed change will have no effect on the overall conclusions drawn within ES or RIAA.

1.2.6 Consultation

The Applicant has consulted with all relevant prescribed consultees, being the MMO, Natural England, the Maritime and Coastguard Agency and Trinity House on the proposed change. In addition to prescribed consultees, the Applicant has also consulted with the Chamber of Shipping. Details of that consultation is set out in Table 3.1 of both Documents PD1-081 and PD1-091, and in the Consultation Report in Appendix 2 of this Change Request. It should be noted that the Maritime and Coastguard Agency, Trinity House and the Chamber of Shipping have all confirmed that this is a positive change from a shipping and navigation perspective.

The Applicant welcomes the ExA’s agreement *“that no further consultation with additional persons prescribed under section 42(1)(a) to (d) of the Planning Act 2008 is required and that all necessary consultation has taken place.”* (PD-011, B6).

1.3 Change 3: Onshore Order Limit reductions – removal of unnecessary plots

1.3.1 Description of the Proposed Change

The Applicant has removed plots 35-004, 35-005, 35-006, 35-007, 35-008, 46-048 from the Order land and reduced the extent of plot 46-045 as these plots relate to accesses which have been removed at the request of the affected landowners and are therefore no longer required. Schedule 9 of the draft DCO (PD1-024) has therefore been updated to reflect this. This change therefore involves a reduction to the Order land onshore. A Plan to illustrate the reductions is set out in Appendix 4.

Proposed onshore Order Limit reductions were also discussed in the Applicant's Change Notification dated 29 August (AS-021) and are set out on pages 28 – 31 of the Applicant's Schedule of Changes for Plans submitted as part of its S51 Response (AS1-003). As set out there, these were Plot 36-001, 39-020, 40-004, 40-005, 43-037. A Plan– replicating pages 28 – 31 of AS1-003 – to illustrate the reductions is set out in Appendix 5.

1.3.2 Reason and need for change

This change removes certain accesses and parts of compounds which, following further design refinement and consultation with landowners, have been assessed as no longer being required to construct, operate, maintain or decommission the project. These areas have therefore been removed from the Order Limits.

1.3.3 Securing consents and licences

The Applicant confirms that the change does not impact on securing any consent or licences for the project nor will it provide any delay in securing such consents or licences.

1.3.4 Compulsory Acquisition

The change does not involve a request to include additional compulsory acquisition powers therefore the procedures in regulations 5 to 19 of the CA Regulations do not apply.

1.3.5 New or different likely significant environmental effects

The environmental implications of this change have been reviewed to fully understand whether the changes affect the conclusions of the ES and it has been concluded that there would be no change in the assessment conclusions of the ES for any environmental topics.

1.3.6 Consultation

The Applicant welcomes the ExA's agreement in relation to the minor onshore Order Limit reductions notified in AS-025 that *"that no further consultation with additional persons prescribed under section 42(1)(a) to (d) of the Planning Act 2008 is required and that all necessary consultation has taken place."* (PD-011, B6).

Changes to accesses, as shown on the plan at Appendix 4, are proposed at the request of the affected landowners following consultation with them on the proposed development. Details of that consultation is set out in the Consultation Report in Appendix 2 of this Change Application.

Regarding the proposed onshore Order Limit reductions discussed in the Applicant's Change Notification dated 29 August (AS-021) (shown on the plan at Appendix 5) consultation conducted by the Applicant is also set out in the Consultation Report in Appendix 2 of this Change Application.

1.4 Conclusion

For the reasons set out above, proposed Changes 1 – 3 do not result in the project being materially different to that originally submitted. Change 1 simply reflects the reality of the current position of MHWS and MLWS. Changes 2 and 3 result in reductions to the Order limits both onshore and offshore, seeking to refine the proposals early by removing flexibility and optionality at this stage rather than post-consent.

The Applicant therefore formally requests that the ExA accepts these proposed changes into the Examination. The Applicant notes that the proposed changes are already incorporated into the most recently submitted versions of Application documents and therefore requests that the ExA accepts those documents already submitted into the Examination, as related to Changes 1 – 3 (set out in Appendix 3).

2 Appendix 2: Consultation Report

This Consultation Report sets out, in Table 2, consultation conducted in relation to each of Changes 1 – 3, noting the reason for the consultation and providing consultation correspondence where relevant in the appended Annex. Table 2 also sets out, where applicable, how the Applicant has considered the content of the consultation responses received.

In conducting consultation the Applicant has, among other things, considered whether it would be appropriate to consult with persons prescribed under section 42(1)(a) to (d) of the Planning Act 2008 in line with the Change Guidance requirement that

“The applicant should consult all those persons prescribed under section 42(1)(a) to (d) of the Planning Act 2008 who would be affected by the proposed change, giving a minimum of 28 days from receipt of the information about the proposed change for responses”.

Table 2: Consultation conducted for each change

Change	Reason for Consultation	Consultation conducted	Relevant correspondence provided
Change 1: Changes to MHWS and MLWS	CA Regulations	TCE Consultation The Applicant engaged with TCE as owner of Plot 01-002. In an email on 26 July 2024, TCE advised that it consented to the amendment to the compulsory acquisition for the purpose of regulation 4(b) of the CA Regulations subject to (i) the additional land being treated the same way in the Book of Reference as other TCE land and (ii) the additional land being subject to "Section 135 consent" (as with other TCE land). Both of these caveats have been taken into account as set out in Appendix 1, Change 1.	Correspondence from TCE provided at 2.1.1
	Requested by ExA	MMO Consultation The Applicant consulted with the MMO following the request by the ExA for it to do so. The MMO confirmed that it <i>"welcomes the updated documents as submitted by GTR4 Limited. The MMO does not consider that formal consultation is required."</i>	Correspondence from MMO provided at 2.1.2
	Requested by ExA	Chapel St Leonards Parish Council Consultation The Applicant consulted with Chapel St Leonards Parish Council following the ExA's request that they "clarify that the Parish Council agrees that it has no interest in the land identified as plot 01-002" (PD-008). In response, Chapel St Leonards Parish Council confirmed by email on 1 October 2024 that it did not have an interest in any land within the Order limits.	Correspondence from Chapel St Leonards Parish Council provided at 2.1.3
Change 2: Revision to the Offshore ECC	Voluntary (consultation with prescribed consultee)	MMO Consultation The MMO was consulted via Teams meetings on 13 August and 3 September 2024 and follow up correspondence. The MMO confirmed that they would provide comments at a later stage in the application (Deadline 1).	Email correspondence provided at 2.1.4.
	Voluntary (consultation with prescribed consultee)	Natural England Consultation Natural England were consulted via a Teams call held on 3 September. Natural England did not raise specific queries related to the ECC Revision (though questions were raised regarding the ORBA which will be subject to a future Change Application	Email correspondence provided at 2.1.5

Change	Reason for Consultation	Consultation conducted	Relevant correspondence provided
		as discussed above). Natural England later confirmed that it would provide its further comment by Deadline 1.	
	Voluntary (consultation with prescribed consultee)	Maritime and Coastguard Agency (“MCA”) Consultation The MCA were consulted via Teams meeting on 15 August (with the Chamber of Shipping also present) in which they stated that the ECC Revision (as well as the ORBA) was positive from a shipping and navigation perspective.	N/A
	Voluntary (consultation with prescribed consultee)	Trinity House Consultation Trinity House was consulted via Teams meeting on 20 August in which they stated that the ECC Revision (as well as the ORBA) was positive from a shipping and navigation perspective.	N/A
	Voluntary	Chamber of Shipping Consultation The Chamber of Shipping were consulted via Teams meeting on 15 August (with the MCA also present) in which they stated that the introduction of the ECC Revision (as well as the ORBA) was positive from a shipping and navigation perspective.	Email of 4 September provided at 2.1.6
Change 3: Onshore Order Limit reductions - removal of unnecessary plots	Voluntary (consultation with prescribed consultee)	Consultation with Affected Owner: B Bush & Sons Limited and EM Bush Limited (Plots 35-004; 35-005; 35-006; 35-007; 35-008) Communications from the owner (via their solicitors) were received on 14 June and 5 July 2024 requesting removal of enabling access due to a Biodiversity Net Gain lease area in existence. Revised plans were updated and agreed with Solicitor and Landowner.	N/A
	Voluntary (consultation with prescribed consultee)	Consultation with Affected Owner: Jarred Wright, William Creasey, Davina Fillingham (Plot 46-048) Following a meeting between the landowner and the Applicant on 3 July 2024, it was agreed, among other things, to remove the enabling access as there is an access gate directly into the option area from the highway.	N/A

Change	Reason for Consultation	Consultation conducted	Relevant correspondence provided
		Updated plans have been agreed with the Land Interest's professional representatives.	
	Voluntary (consultation with prescribed consultee)	<p>Consultation with Affected Owners: Lincolnshire County Council ("LCC") (Plots 36-001; Plots 47-37)</p> <p>LCC was contacted to ensure that they were aware of the proposed removal of the above plots ahead of the submission of this Change Request</p>	N/A
	Voluntary (consultation with prescribed consultee)	<p>Consultation with Affected Owners: Parson Latham's Hospital in Oundle (Plot 39-020)</p> <p>Prior to the change being proposed (Applicant's Response to S51 Advice, 31 July 2024) the affected owner was written to, setting out that due to refinements made to the Order Limits the plots would no longer be used by the Applicant subject to amendments being submitted and accepted as part of the DCO application process.</p>	N/A
	Voluntary (consultation with prescribed consultee)	<p>Consultation with Affected Owners: M Leader (Plots 40-004 and 40-005)</p> <p>Prior to the change being proposed (Applicant's Response to S51 Advice, 31 July 2024) the affected owner was written to setting out that that due to refinements made to the Order Limits the plots would no longer be used by the Applicant subject to amendments being submitted and accepted as part of the DCO application process.</p>	N/A

2.1 Annex to Appendix 2 Consultation Report

2.1.1 Change 1: Correspondence: TCE Consultation



From: [Redacted]
Sent: 26 July 2024 10:08
To: [Redacted]
Subject: ODOW - Land at MLWS
Attachments: 20240708_22000087_PLN_INFO_13228.1.pdf
Importance: High

Dear Greg,

"For the purpose of regulation 4(b) of the Infrastructure Planning (Compulsory Acquisition) Regulations 2010 only, we consent to the provision in the DCO authorising compulsory acquisition powers in respect of the "additional land" shown on the plan, provided that:

- 1. The "additional land" is treated the same as all other Crown land in the Book of Reference i.e. there is an express reference to "(excluding all interests of the Crown)".*
- 2. This "additional land", like all other Crown plots affected by the DCO, will be subject to s. 135 consent and ODOW will need to enter into the Crown's standard form agreement."*

Kind regards

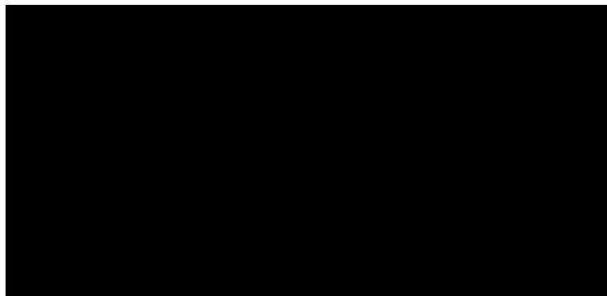

LEGAL DISCLAIMER - IMPORTANT NOTICE

The information in this message, including any attachments, is intended solely for the use of the person to whom it is addressed. It may be confidential and subject to legal professional privilege and it should not be disclosed to or used by anyone else. If you receive this message in error please let the sender know straight away. The Crown Estate's head office is at 1 St James's Market London SW1Y 4AH.

We cannot accept liability resulting from email transmission.

2.1.2 Change 1: Correspondence: MMO Consultation



Marine Licensing
Lancaster House
Hampshire Court
Newcastle upon Tyne
NE4 7YH

T +44 (0) [REDACTED]
F +44 (0) [REDACTED]
www.gov.uk/mmo

Mr Chris Jenner
Development Manager
Outer Dowsing Offshore Wind
12 Alva Street
Edinburgh
EH2 4QG
[REDACTED]

Our reference: DCO/2021/00003

By email only

08 October 2024

Dear Mr Jenner,

Outer Dowsing Offshore Wind Farm

Ordinance Survey Mapping Update

Section 42 Planning Act 2008

Thank you for your email dated 13 September 2024, notifying the Marine Management Organisation (the MMO) of GTR4 Limited's (trading as Outer Dowsing Offshore Wind) (the Applicant) changes to documentation submitted under the Development Consent Order (DCO) application to the Examining Authority (ExA).

The MMO's role in Nationally Significant Infrastructure Projects

The MMO was established by the Marine and Coastal Access Act 2009 (the 2009 Act) to make a contribution to sustainable development in the marine area and to promote clean, healthy, safe, productive and biologically diverse oceans and seas.

The responsibilities of the MMO include the licensing of construction works, deposits and removals in English inshore and offshore waters and for Welsh and Northern Ireland offshore waters by way of a marine licence¹. Inshore waters include any area which is submerged at mean high water spring (MHWS) tide. They also include the waters of every estuary, river or channel where the tide flows at MHWS tide. Waters in areas which are closed permanently or intermittently by a lock or other artificial means against the regular action of the tide are included, where seawater flows into or out from the area.

¹ Under Part 4 of the 2009 Act



In the case of Nationally Significant Infrastructure Projects (NSIPs), the 2008 Act enables Development Consent Order's (DCO) for projects which affect the marine environment to include provisions which deem marine licences².

As a prescribed consultee under the 2008 Act, the MMO advises developers during pre-application on those aspects of a project that may have an impact on the marine area or those who use it. In addition to considering the impacts of any construction, deposit or removal within the marine area, this also includes assessing any risks to human health, other legitimate uses of the sea and any potential impacts on the marine environment from terrestrial works.

Where a marine licence is deemed within a DCO, the MMO is the delivery body responsible for post-consent monitoring, variation, enforcement and revocation of provisions relating to the marine environment. As such, the MMO has a keen interest in ensuring that provisions drafted in a deemed marine licence (DML) enable the MMO to fulfil these obligations.

Further information on licensable activities can be found on the MMO's website³. Further information on the interaction between the Planning Inspectorate and the MMO can be found in our joint advice note⁴.

Yours Sincerely,

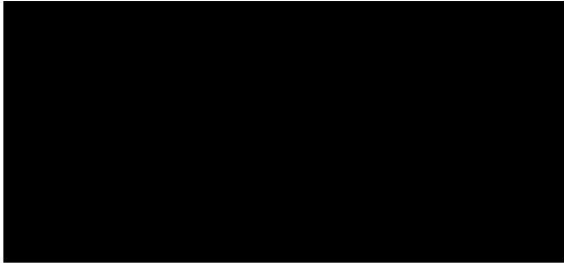

² Section 149A of the 2008 Act

³ <https://www.gov.uk/planning-development/marine-licences>

⁴ <http://infrastructure.planningportal.gov.uk/wp-content/uploads/2013/04/Advice-note-11-v2.pdf>



Ordinance Survey Mapping Update

- 1.1. The MMO notes that there have been updates to Ordnance Survey (OS) mapping within the Order Limits and subsequent changes to the lines of Mean High Water Springs (MHWS) and Mean Low Water Springs (MLWS) that result from these updates. The changes to the MHWS and MLWS mark within the ODOW Order limits are shown in Annex 1.
- 1.2. As a result of the updated OS mapping, there are changes to the extent and shape of land plots immediately adjacent to MLWS and MHWS. Plot 01-003 has been removed from the Order land and that three areas of additional land are now considered to form part of the onshore Order land within plot 01-002.
- 1.3. The Applicant has updated relevant documents to account for these changes. This includes Land Plans and the Draft DCO. The MMO welcomes the submission of the Schedule of changes to the DCO (AS1-026) to detail the changes made to the Draft DCO. The MMO is content that the grid coordinates have been updated within the relevant Deemed Marine Licences (DMLs) Schedules 10, 11, 12, 13, 14, 15 and 16 to reflect the updated position of the mean low and mean high water marks.
- 1.4. The MMO notes that the Applicant considers that the refinements do not result in any changes to the assessment conclusions presented in the DCO application.
- 1.5. In accordance with Section 42(1)(aa) of the Planning Act 2008, the Examining Authority (ExA) have advised that the MMO should be consulted. After discussion with the Applicant, the MMO considers that no further information is required and that the MMO does not need to be consulted for a period of 28 days in light of the updated to OS mapping.
- 1.6. The MMO reserves the right to make further comments on the Project throughout the examination process and may modify its present advice or opinion in view of any additional information that may come to our attention.

Conclusion

The MMO welcomes the updated documents as submitted by GTR4 Limited. The MMO does not consider that formal consultation is required.

Please note this letter comprises the MMO's initial comments in respect of the Outer Dowsing Offshore Wind Farm's updated DCO and is without prejudice to any future representation the MMO may make about the proposed Project and associated documents.

Your feedback

We are committed to providing excellent customer service and continually improving our standards and we would be delighted to know what you thought of the service you have received from us. Please help us by taking a few minutes to complete the following short survey

If you require any further information, please do not hesitate to contact me using the details provided below.



Yours Sincerely,

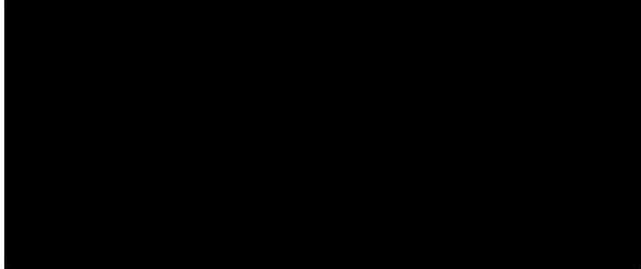

Annex 1



Figure 1: Change in Onshore Order Limits. Taken from the 'Applicant's Approach to Ordnance Survey mapping Update, Document Reference 13.3.'



Figure 2: Enlarged image of Figure 1 above. Taken from the 'Applicant's Approach to Ordnance Survey mapping Update, Document Reference 13.3.'

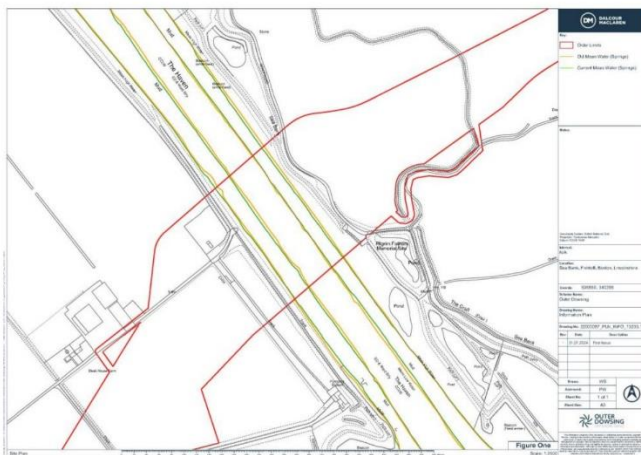

Figure 2: The Order Limits at The Haven. Taken from the 'Applicant's Approach to Ordnance Survey mapping Update, Document Reference 13.3.'

2.1.3 Change 1: Correspondence: Chapel St Leonards Parish Council Consultation

From: [REDACTED]
Sent: Tuesday, October 1, 2024 1:43 PM
To: [REDACTED]
Subject: RE: Outer Dowsing Offshore Wind - change notification

You don't often get email from [REDACTED] [Learn why this is important](#)

Dear David

As per our conversation yesterday, this is confirmation that Chapel St Leonards Parish Council has no rights where Outer Dowsing projects are taking place.

Best wishes

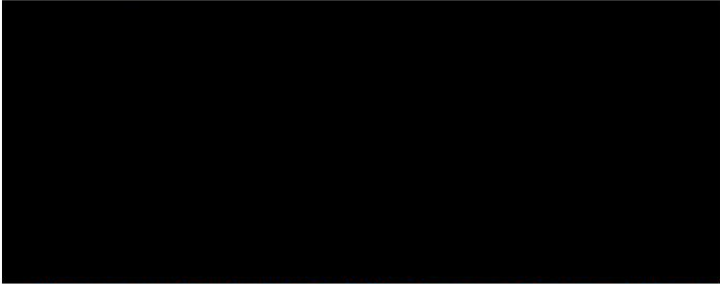

Please note that the Parish Office is normally open 8:00am to 3:30pm, Monday to Wednesday, Thursday 8:00am to 1:00pm and that emails received outside these times will be responded to when staff are back in the office.

From: [REDACTED]
Sent: 27 September 2024 08:54
To: [REDACTED]
Subject: Outer Dowsing Offshore Wind - change notification

FAO The Clerk

Dear Sir/Madam,

Please find enclosed a letter regarding the Outer Dowsing Offshore Wind Project. A copy has also been posted to your address.

I also attach a copy of the lease dated 17 June 2004 referenced in the letter for your reference. This lease was thought to overlap with the Projects order limits which is why you were, incorrectly, included as a Category 2 interest in our initial Application. Following further interrogation it transpires that the lease extends only

Northwards to Wolla Bank car park (page 17 of the lease) and the order limits for the Project are North of Wolla Bank as shown below:

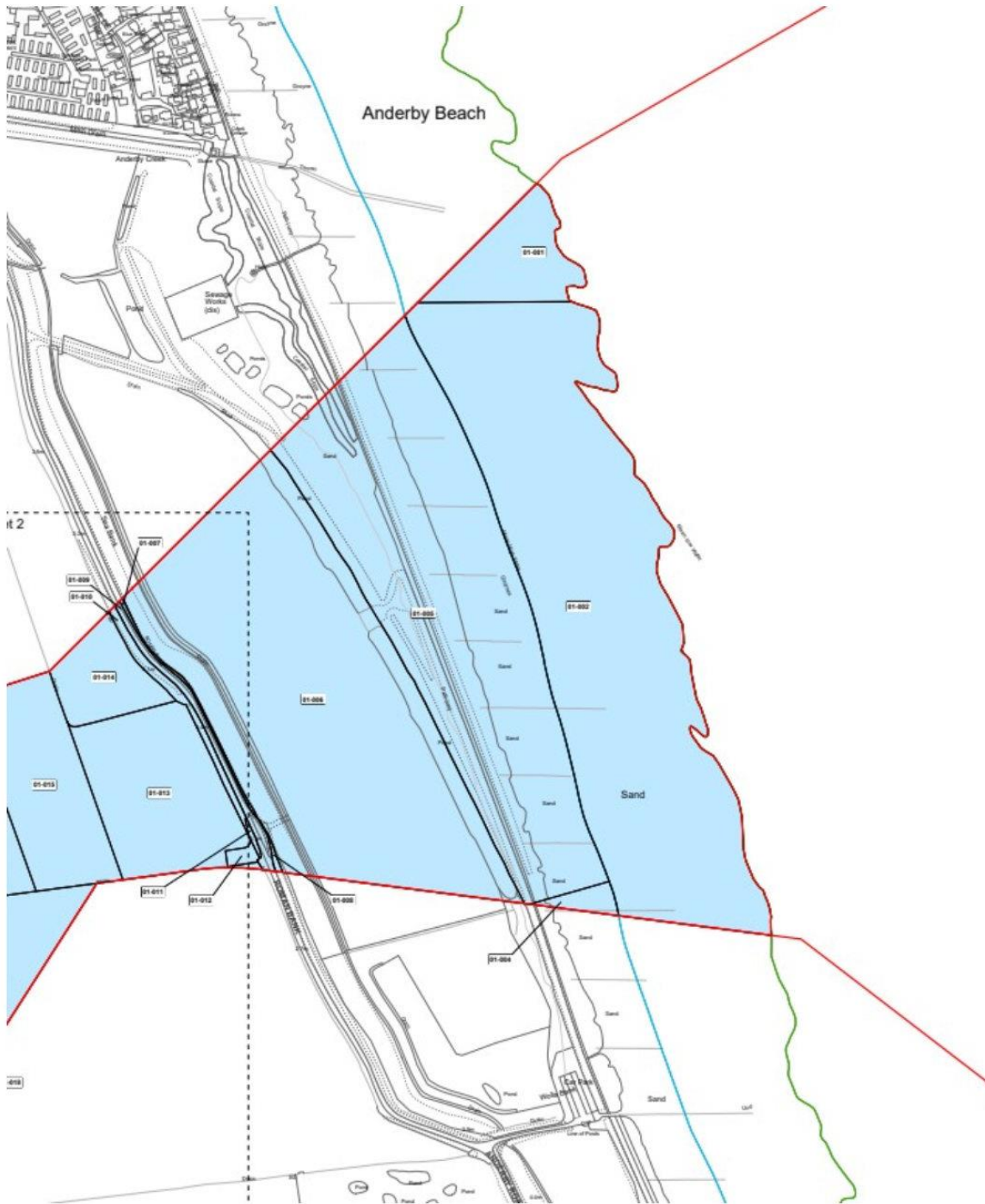

I will try to give you a call on Monday to discuss this but if you have any questions in the meantime please get in touch.

Regards,

David

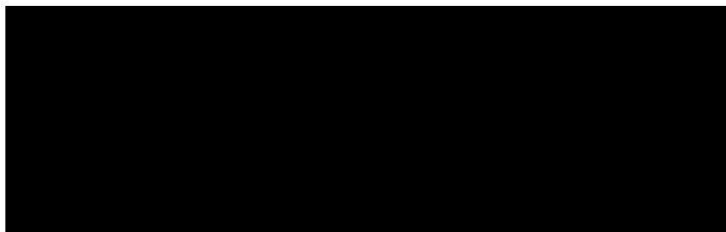

This email (including any attachments) is confidential and intended for the addressee only. If you are not the intended recipient, do not copy, disclose, distribute or take any action in reliance on it and please delete the email and notify us immediately. GT R4 Limited does not guarantee the integrity of any emails or attachments and does not accept any liability for any harm that may be caused to the recipient's system or data by this email or any attachment. For further details, including our privacy policy, please visit our website (<https://www.outerdowsing.com/>). GT R4 Limited is a company incorporated in England with company number 13281221 and having its registered office at c/o Johnson Carmichael LLP, Birchin Court, 20 Birchin Lane, London, England, EC3V 9DU.

2.1.4 Change 2: Correspondence: MMO Consultation

[Redacted]

From: [Redacted]
Sent: 05 September 2024 16:48
To: [Redacted]
Cc: [Redacted]
Subject: RE: ODOW Additional Mitigation Measures

Hi Laura,

Thanks for sending the meeting minutes. The MMO has reviewed them and has no comments. We would like to note that we will not be providing a written response as the overview was high level and will provide one once the written report with further detail is submitted.

Thanks again.

Kind regards,

[Redacted]

Our MMO Values: Together we are **Accountable**, **Innovative**, **Engaging** and **Inclusive**
[Website](#) [Blog](#) [Twitter](#) [Facebook](#) [LinkedIn](#) [YouTube](#)



From: Laura Vickery [Redacted]
Sent: 04 September 2024 17:28

[Redacted]

[Redacted]

Subject: RE: ODOW Additional Mitigation Measures

Hi all,

Thank you very much for meeting with us yesterday to discuss the ODOW Offshore Restricted Build Area (ORBA) and ECC Modification.
As discussed, please see the attached draft minutes for your review and comment.

We would be grateful if we could please have all comments back by **5.30pm 11th September.**

Have a nice evening,
Many thanks,
Laura

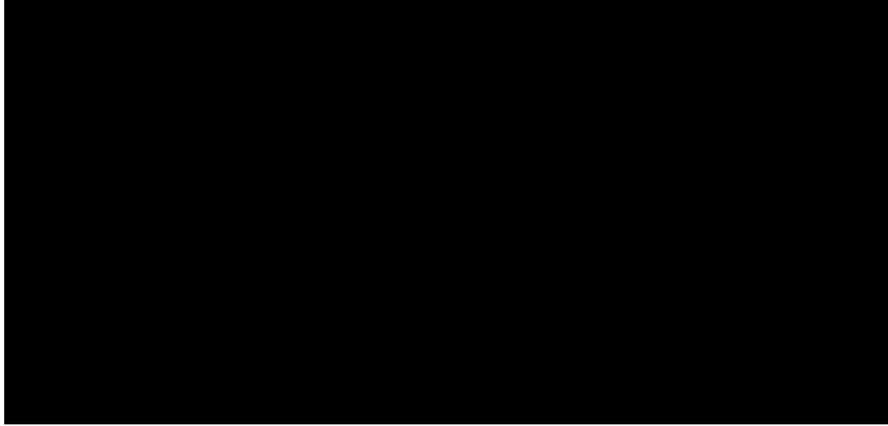

2.1.5 Change 2: Correspondence: Natural England Consultation

From: [REDACTED]
Sent: 05 September 2024 09:30
To: [REDACTED]
Cc: [REDACTED]
[REDACTED]
[REDACTED]
Subject: RE: ODOW Additional Mitigation Measures

Hi [REDACTED]

Thank you for sending the minutes from our meeting on the 3rd September. I just wanted to highlight as discussed previously, the earliest Natural England can return written comments is by 13th September.

Many thanks,

[REDACTED]

[REDACTED]
Norfolk and Suffolk Area Team
Natural England - www.gov.uk/natural-england
[REDACTED]

From: [REDACTED] >
Sent: Wednesday, September 4, 2024 5:28 PM
To: [REDACTED]

1

The Project will provide materials for review w/c 12th August 2024.

Please forward the invite to relevant technical specialists.

Kind regards,
Greg

Microsoft Teams [Need help?](#)

[Join the meeting now](#)



For organizers: [Meeting options](#)

This email (including any attachments) is confidential and intended for the addressee only. If you are not the intended recipient, do not copy, disclose, distribute or take any action in reliance on it and please delete the email and notify us immediately. GT R4 Limited does not guarantee the integrity of any emails or attachments and does not accept any liability for any harm that may be caused to the recipient's system or data by this email or any attachment. For further details, including our privacy policy, please visit our website (<https://www.outerdowsing.com/>). GT R4 Limited is a company incorporated in England with company number 13281221 and having its registered office at c/o Johnson Carmichael LLP, Birchin Court, 20 Birchin Lane, London, England, EC3V 9DU.

This email and any attachments is intended for the named recipient only. If you have received it in error you have no authority to use, disclose, store or copy any of its contents and you should destroy it and inform the sender. Whilst this email and associated attachments will have been checked for known viruses whilst within the Natural England systems, we can accept no responsibility once it has left our systems. Communications on Natural England systems may be monitored and/or recorded to secure the effective operation of the system and for other lawful purposes.

2.1.6 Change 2: Correspondence: Chamber of Shipping

[REDACTED]

From: [REDACTED]
Sent: 04 September 2024 19:58
To: [REDACTED]
Cc: [REDACTED]
Subject: RE: ODOW Meeting Minutes

Evening all,

Confirm receipt and acceptance of the minutes.

The Chamber has shared the slides and update with DFDS [REDACTED] who have no issues and find the changes positive.

Thank you for continued constructive approach.

Kind regards,

[REDACTED]

From: [REDACTED]
Sent: 20 August 2024 15:14

[REDACTED]

Subject: ODOW Meeting Minutes

Hi All,

Many thanks again for your time last week to discuss the ODOW project.

The link below provides download access to draft minutes for comment, a PDF of the slides we shared, and project SHP files (array, ORBA, ECC, ORCP area, and ANS areas).

[ODOW - MCA and CoS Meeting Documentation](#)

Just to reflag, this content has not yet been put into examination. However, Robert as mentioned please feel free to share the slides with DFDS for feedback on the ORBA.

I would be grateful if you could let me know any comments on the minutes before we finalise.

Thanks,



Anatec Limited
Risk based decision making
An Employee Owned Company



Anatec is a limited company, registered in Scotland. Registered number: SC215208

The contents of this email are confidential, and do not necessarily represent the views of Anatec Ltd, or any associated organisations. If you are not the intended recipient of this email, then you should advise the sender immediately of this fact, and subsequently delete the email. Any other actions taken based on the contents of this email by an unintended recipient (including, but not limited to archiving, disclosure, distribution, or copying) are strictly prohibited. Note that Anatec Ltd accepts no responsibility for viruses and it is your responsibility to scan attachments.

3 Appendix 3: Document updates and Schedule of all Application

Documents

In line with the Change Guidance, this Schedule provides a list of all current application documents and plans and flags any revisions to each as a result of the changes described in Appendix 1. We note the following points which may be of assistance to the ExA when reviewing the schedule.

- We have listed the revisions to documents against the most up to date version of documents however please note that Change 1 was made to earlier versions of the relevant documents (those provided in the Applicant’s “Response to s51 advice” submissions on 31 July 2024) whereas Changes 2 and 3 were contained in documents submitted at the Procedural Deadline on 19 September 2024.
- Where a new version of a document is being submitted at Deadline 1 (at the same time as the submission of this document) the PINS reference has not been provided given the current PINS reference will be superseded. Where this is the case, the previous PINS reference has been provided in square brackets for reference. The documents have been provided in order of submission.
- As set out in the summaries below, a range of the documents were revised due to Change 1 – 3 but also due to other refinements and amendments to the Application, some of which relate to other changes which have been notified but which are not the subject of this Change Application because either (1) they are subject to further consultation following which a formal Change Application will be submitted in due course; or (2) the ExA has determined that they do not require to be the subject of a Change Request. The Applicant has made clear where documents have been updated due to Change 1 – 3 but, for brevity, has not sought to set out in detail where documents have been revised due to other changes or updates.

Table 3: Schedule of all Application Documents

Current PINS Library Reference	Applicant Reference	Document Title	Change
APP-001	1.1	Cover Letter	No change
APP-003	1.3	Draft Section 55 Checklist	No change
APP-004	1.4	Application Form	No change
APP-027	4.2.1	Accounts of TotalEnergies	No change
APP-028	4.2.2	Accounts of Macquarie Group	No change
APP-029	4.2.3	Accounts of GULF	No change
APP-030	4.2.4	Property Cost Estimate	No change
APP-033	5.1.1	Consultation Report Appendix 1 Consultation Compliance Statement	No change
APP-034	5.1.2	Consultation Report Appendix 2 Scoping Part 1 of 2 Scoping Opinion and Report	No change
APP-035	5.1.2	Consultation Report Appendix 2 Scoping Part 2 of 2 Scoping Opinion and Report	No change
APP-036	5.1.3	Consultation Report Appendix 3 List of Consultees Consulted Under Section 42	No change
APP-037	5.1.4A	Consultation Report Appendix 4A Section 47 Consultation Responses	No change

APP-039	5.1.5	Consultation Report Appendix 5 Consultation on the draft Statement of Community Consultation Part 1 of 2	No change
APP-040	5.1.5	Consultation Report Appendix 5 Consultation on the draft Statement of Community Consultation Part 2 of 2	No change
APP-041	5.1.6	Consultation Report Appendix 6 Formal Notices Part 1 of 3	No change
APP-042	5.1.6	Consultation Report Appendix 6 Formal Notices Part 2 of 3	No change
APP-043	5.1.6	Consultation Report Appendix 6 Formal Notices Part 3 of 3	No change
APP-044	5.1.7	Consultation Report Appendix 7 Phase 1 Consultation Documentation	No change
APP-045	5.1.8	Consultation Report Appendix 8 Phase 1A Consultation Documentation	No change
APP-046	5.1.9	Consultation Report Appendix 9 Phase 2 Consultation Documentation	No change
APP-047	5.1.10	Consultation Report Appendix 10 Autumn Consultation Documentation	No change
APP-048	5.1.11	Consultation Report Appendix 11 Targeted Winter Consultation Documentation	No change
APP-049	5.1.12	Consultation Report Appendix 12 Community Liaison Group Documentation	No change
APP-050	5.1.13	Consultation Report Appendix 13 Other Community Engagement	No change
APP-051	5.1.14	Consultation Report Appendix 14 Land Interest Consultation Documentation	No change
APP-052	5.1.15	Consultation Report Appendix 15 Evidence Plan Process Consultation	No change
APP-053	5.1.16	Consultation Report Appendix 16 Principal Areas of Disagreement Statements	No change
APP-054	5.1.17	Consultation Report Appendix 17 Transboundary Responses	No change
APP-055	6.1	Non-Technical Summary	No change
APP-056	6.1.1	Chapter 1 Introduction	No change

APP-087	6.2.1	Chapter 1 Introduction Figures	No change
APP-140	6.3.1	Chapter 1 Introduction Appendices [No Appendices]	No change
APP-057	6.1.2	Chapter 2 Need, Policy and Legislative Context	No change
APP-088	6.2.2	Chapter 2 Need, Policy and Legislative Context Figures	No change
APP-141	6.3.1	Chapter 2 Need, Policy and Legislative Context Appendices [No Appendices]	No change
APP-058	6.1.3	Chapter 3 Project Description	No change
APP-089	6.2.3	Chapter 3 Project Description Figures	No change
APP-142	6.3.3.1	Chapter 3 Appendix 1 Cable Burial Risk Assessment [Confidential]	No change
APP-144	6.3.3.3	Chapter 3 Appendix 3 Offshore Crossing Schedule	No change
APP-059	6.1.4	Chapter 4 Site Selection and Consideration of Alternatives	No change
APP-090	6.2.4	Chapter 4 Site Selection and Consideration of Alternatives	No change
APP-145	6.3.4.1	Chapter 4 Appendix 1 Landfall Assessment & Offshore ECC Route Optioneering	No change
APP-060	6.1.5	Chapter 5 EIA Methodology	No change
APP-091	6.2.5	Chapter 5 EIA Methodology Figures	No change
APP-146	6.3.5.1	Chapter 5 Appendix 1 Statement of Competence	No change
APP-147	6.3.5.2	Chapter 5 Appendix 2 Cumulative Effects Assessment Approach Offshore	No change
APP-148	6.3.5.3	Chapter 5 Appendix 3 Cumulative Effects Assessment Approach Onshore	No change
APP-061	6.1.6	Chapter 6 Technical Consultation	No change
APP-092	6.2.6	Chapter 6 Technical Consultation Figures [No Figures]	No change

APP-149	6.3.6.1	Chapter 6 Appendix 1 Evidence Plan Process Consultation	No change
APP-062	6.1.7	Chapter 7 Marine Physical Processes	No change
APP-093	6.2.7	Chapter 7 Marine Physical Processes Figures (Part 1 of 2)	No change
APP-094	6.2.7	Chapter 7 Marine Physical Processes Figures (Part 2 of 2)	No change
APP-151	6.3.7.2	Chapter 7 Appendix 2 Physical Processes Modelling Report	No change
APP-152	6.3.7.3	Chapter 7 Appendix 3 Seabed Mobility Report [Confidential]	No change
APP-095	6.2.8	Chapter 8 Marine Water and Sediment Quality Figures	No change
APP-153	6.3.8.1	Chapter 8 Appendix 1 Water Framework Directive	No change
APP-064	6.1.9	Chapter 9 Benthic and Intertidal Ecology	No change
APP-096	6.2.9	Chapter 9 Benthic and Intertidal Ecology Figures	No change
APP-154	6.3.9.1	Chapter 9 Appendix 1 Benthic Ecology Technical Report (Array)	No change
APP-156	6.3.9.3	Chapter 9 Appendix 3 Intertidal Technical Report	No change
APP-157	6.3.9.4	Chapter 9 Appendix 4 Marine Conservation Zone Assessment	No change
APP-158	6.3.9.5	Chapter 9 Appendix 5 Envision Data Analysis	No change
APP-065	6.1.10	Chapter 10 Fish and Shellfish Ecology	No change
APP-097	6.2.10	Chapter 10 Fish and Shellfish Ecology Figures (Part 1 of 2)	No change
APP-098	6.2.10	Chapter 10 Fish and Shellfish Ecology Figures (Part 2 of 2)	No change
APP-159	6.3.10.1	Chapter 10 Appendix 1 Fish and Shellfish Ecology Technical Baseline	No change
APP-066	6.1.11	Chapter 11 Marine Mammals	No change
APP-099	6.2.11	Chapter 11 Marine Mammals Figures	No change

APP-160	6.3.11.1	Chapter 11 Appendix 1 Marine Mammals Technical Baseline	No change
APP-161	6.3.11.2	Chapter 11 Appendix 2 Underwater Noise Assessment	No change
APP-100	6.2.12	Chapter 12 Offshore and Intertidal Ornithology Figures	No change
APP-163	6.3.12.2	Chapter 12 Appendix 2 Collision Risk Modelling	No change
APP-164	6.3.12.3	Chapter 12 Appendix 3 Displacement Assessment	No change
APP-165	6.3.12.4	Chapter 12 Appendix 4 Population Viability Analysis	No change
APP-068	6.1.13	Chapter 13 Marine and Intertidal Archaeology	No change
APP-101	6.2.13	Chapter 13 Marine and Intertidal Archaeology Figures	No change
APP-167	6.3.13.1	Chapter 13 Appendix 1 Marine and Intertidal Archaeology Technical Report	No change
APP-168	6.3.13.2	Chapter 13 Appendix 2 Geoarchaeological Phase 1 Report ECC	No change
APP-169	6.3.13.3	Chapter 13 Appendix 3 Geoarchaeological Phase 1 Report OWF	No change
APP-069	6.1.14	Chapter 14 Commercial Fisheries	No change
APP-102	6.2.14	Chapter 14 Commercial Fisheries Figures	No change
APP-170	6.3.14.1	Chapter 14 Appendix 1 Commercial Fisheries Technical Baseline	No change
APP-070	6.1.15	Chapter 15 Shipping and Navigation	No change
APP-103	6.2.15	Chapter 15 Shipping and Navigation Figures	No change
APP-171	6.3.15.1	Chapter 15 Appendix 1 Navigational Risk Assessment	No change
APP-172	6.3.15.2	Chapter 15 Appendix 2 Oil and Gas Platform Allision and Marine Access Study	No change
APP-104	6.2.16	Chapter 16 Aviation, Radar, Military and Communication Figures	No change
APP-173	6.3.16.1	Chapter 16 Appendix 1 Aviation Technical Report	No change

APP-106	6.2.17	Chapter 17 Seascape, Landscape and Visual Figures (Part 2 of 3)	No change
APP-107	6.2.17	Chapter 17 Seascape, Landscape and Visual Figures (Part 3 of 3)	No change
APP-174	6.3.17.1	Chapter 17 Appendix 1 Seascape, Landscape and Visual Assessment Methodology	No change
APP-073	6.1.18	Chapter 18 Marine Infrastructure and Other Users	No change
APP-108	6.2.18	Chapter 18 Marine Infrastructure and Other Users Figures	No change
APP-175	6.3.18.1	Chapter 18 Appendix 1 Helicopter Access Report	No change
APP-109	6.2.19	Chapter 19 Onshore Air Quality Figures	No change
APP-177	6.3.19.2	Chapter 19 Appendix 2 Non-Road Mobile Machinery Emissions Assessment	No change
APP-178	6.3.19.3	Chapter 19 Appendix 3 Offshore Activities Assessment	No change
APP-179	6.3.19.4	Chapter 19 Appendix 4 Road Traffic Dispersion Modelling	No change
APP-110	6.2.20	Chapter 20 Onshore Archaeology and Cultural Heritage Figures	No change
APP-180	6.3.20.1	Chapter 20 Appendix 1 Onshore Archaeology and Cultural Heritage Desk-Based Assessment (Part 1 of 8)	No change
APP-181	6.3.20.1	Chapter 20 Appendix 1 Onshore Archaeology and Cultural Heritage Desk-Based Assessment (Part 2 of 8)	No change
APP-182	6.3.20.1	Chapter 20 Appendix 1 Onshore Archaeology and Cultural Heritage Desk-Based Assessment (Part 3 of 8)	No change
APP-183	6.3.20.1	Chapter 20 Appendix 1 Onshore Archaeology and Cultural Heritage Desk-Based Assessment (Part 4 of 8)	No change
APP-184	6.3.20.1	Chapter 20 Appendix 1 Onshore Archaeology and Cultural Heritage Desk-Based Assessment (Part 5 of 8)	No change

APP-185	6.3.20.1	Chapter 20 Appendix 1 Onshore Archaeology and Cultural Heritage Desk-Based Assessment (Part 6 of 8)	No change
APP-186	6.3.20.1	Chapter 20 Appendix 1 Onshore Archaeology and Cultural Heritage Desk-Based Assessment (Part 7 of 8)	No change
APP-187	6.3.20.1	Chapter 20 Appendix 1 Onshore Archaeology and Cultural Heritage Desk-Based Assessment (Part 8 of 8)	No change
APP-188	6.3.20.2	Chapter 20 Appendix 2 Onshore Archaeology and Cultural Heritage - Heritage Statement	No change
APP-076	6.1.21	Chapter 21 Onshore Ecology	No change
APP-112	6.2.21	Chapter 21 Onshore Ecology Figures (Part 2 of 2)	No change
APP-189	6.3.21.1	Chapter 21 Appendix 1 Onshore Ecology Desk Based Assessment	No change
APP-190	6.3.21.2	Chapter 21 Appendix 2 UK Habitat Survey Report	No change
APP-191	6.3.21.3	Chapter 21 Appendix 3 Important Hedgerows Report	No change
APP-192	6.3.21.4	Chapter 21 Appendix 4 Bat Surveys (Part 1 of 2)	No change
APP-193	6.3.21.4	Chapter 21 Appendix 4 Bat Surveys (Part 2 of 2)	No change
APP-194	6.3.21.5	Chapter 21 Appendix 5 Badger Desk Study and Field Survey [Confidential]	No change
APP-195	6.3.21.6	Chapter 21 Appendix 6 Riparian Mammal Report	No change
APP-196	6.3.21.7	Chapter 21 Appendix 7 Great Crested Newt Report	No change
APP-197	6.3.21.8	Chapter 21 Appendix 8 Reptile Habitat Suitability Study	No change
APP-198	6.3.21.9	Chapter 21 Appendix 9 Invertebrates Study	No change
APP-199	6.3.21.10	Chapter 21 Appendix 10 Fish Habitat Study	No change

APP-077	6.1.22	Chapter 22 Onshore Ornithology	No change
N/A	6.1.22	Chapter 22 Onshore Ornithology [Confidential]	No change
APP-113	6.2.22	Chapter 22 Onshore Ornithology Figures	No change
APP-200	6.3.22.1	Chapter 22 Appendix 1 Ornithology Desk Study	No change
APP-201	6.3.22.2	Chapter 22 Appendix 2 Ornithology Desk Study Annex [Confidential]	No change
APP-202	6.3.22.3	Chapter 22 Appendix 3 Winter Bird Survey 2022 – 2023 (Part 1 of 4)	No change
APP-306	6.3.22.3	Chapter 22 Appendix 3 Winter Bird Survey 2022 – 2023 (Part 2 of 4)	No change
APP-203	6.3.22.3	Chapter 22 Appendix 3 Winter Bird Survey 2022 – 2023 (Part 3 of 4)	No change
APP-204	6.3.22.3	Chapter 22 Appendix 3 Winter Bird Survey 2022 – 2023 (Part 4 of 4)	No change
APP-205	6.3.22.4	Chapter 22 Appendix 4 Breeding Bird Survey 2023	No change
APP-206	6.3.22.5	Chapter 22 Appendix 5 Breeding Bird Survey [Confidential]	No change
APP-207	6.3.22.6	Chapter 22 Appendix 6 Bird Species List	No change
APP-208	6.3.22.7	Chapter 22 Appendix 7 Winter Bird Survey 2023-2024 Preliminary Summary	No change
APP-078	6.1.23	Chapter 23 Geology and Ground Conditions	No change
APP-079	6.1.24	Chapter 24 Hydrology, Hydrogeology and Flood Risk	No change
APP-115	6.2.24	Chapter 24 Hydrology, Hydrogeology and Flood Risk Figures	No change
APP-210	6.3.24.1	Chapter 24 Appendix 1 Groundwater Risk Assessment	No change
APP-213	6.3.25	Chapter 25 Land Use Appendices	No change
APP-081	6.1.26	Chapter 26 Noise and Vibration	No change
APP-117	6.2.26	Chapter 26 Noise and Vibration Figures	No change

APP-214	6.3.26.1	Chapter 26 Appendix 1 Sound Level Meter Calibration Certificates	No change
APP-215	6.3.26.2	Chapter 26 Appendix 2 Full Baseline Survey Results	No change
APP-216	6.3.26.3	Chapter 26 Appendix 3 Construction Plant List	No change
APP-217	6.3.26.4	Chapter 26 Appendix 4 Noise Model Outputs	No change
APP-218	6.3.27.1	Chapter 27 Appendix 1 Transport Assessment Annex A Special Order AIL Swept Path Analysis	No change
APP-220	6.3.27.1	Chapter 27 Appendix 1 Transport Assessment Annex D Personal Injury Accident Data	No change
APP-121	6.3.27.1	Chapter 27 Appendix 1 Transport Assessment Annex E Construction Access Locations	No change
APP-223	6.3.27.1	Chapter 27 Appendix 1 Transport Assessment Annex H Haul Road Crossings	No change
APP-224	6.3.27.1	Chapter 27 Appendix 1 Transport Assessment Annex I ES Public Rights of Way	No change
APP-227	6.3.27.1	Chapter 27 Appendix 1 Transport Assessment Annex L Workforce Gravity Model	No change
APP-228	6.3.27.1	Chapter 27 Appendix 1 Transport Assessment Annex M Swept Path Analysis Checks	No change
APP-083	6.1.28	Chapter 28 Landscape and Visual Assessment	No change
APP-122	6.2.28	Chapter 28 Landscape and Visual Assessment Figures (Part 1 of 15)	No change
APP-123	6.2.28	Chapter 28 Landscape and Visual Assessment Figures (Part 2 of 15)	No change
APP-124	6.2.28	Chapter 28 Landscape and Visual Assessment Figures (Part 3 of 15)	No change
APP-125	6.2.28	Chapter 28 Landscape and Visual Assessment Figures (Part 4 of 15)	No change

APP-126	6.2.28	Chapter 28 Landscape and Visual Assessment Figures (Part 5 of 15)	No change
APP-127	6.2.28	Chapter 28 Landscape and Visual Assessment Figures (Part 6 of 15)	No change
APP-128	6.2.28	Chapter 28 Landscape and Visual Assessment Figures (Part 7 of 15)	No change
APP-129	6.2.28	Chapter 28 Landscape and Visual Assessment Figures (Part 8 of 15)	No change
APP-130	6.2.28	Chapter 28 Landscape and Visual Assessment Figures (Part 9 of 15)	No change
APP-131	6.2.28	Chapter 28 Landscape and Visual Assessment Figures (Part 10 of 15)	No change
APP-132	6.2.28	Chapter 28 Landscape and Visual Assessment Figures (Part 11 of 15)	No change
APP-133	6.2.28	Chapter 28 Landscape and Visual Assessment Figures (Part 12 of 15)	No change
APP-134	6.2.28	Chapter 28 Landscape and Visual Assessment Figures (Part 13 of 15)	No change
APP-135	6.2.28	Chapter 28 Landscape and Visual Assessment Figures (Part 14 of 15)	No change
APP-136	6.2.28	Chapter 28 Landscape and Visual Assessment Figures (Part 15 of 15)	No change
APP-230	6.3.28	Chapter 28 Landscape and Visual Assessment Appendices [No Appendices]	No change
APP-084	6.1.29	Chapter 29 Socio-Economic Characteristics	No change
APP-137	6.2.29	Chapter 29 Socio-Economic Characteristics Figures	No change
APP-231	6.3.29	Chapter 29 Socio-Economic Characteristics Appendices [No Appendices]	No change
APP-138	6.2.30	Chapter 30 Human Health Figures	No change
APP-232	6.3.30.1	Chapter 30 Appendix 1 Population Baseline	No change
APP-233	6.3.30.2	Chapter 30 Appendix 2 Human Health Literature Review	No change
APP-086	6.1.31	Chapter 31 Climate Change	No change
APP-139	6.2.31	Chapter 31 Climate Change Figures	No change

APP-234	6.3.31	Chapter 31 Climate Change Appendices	No change
APP-238	7.1.2	Ornithology Population Viability Analysis (Habitats Regulations Assessment)	No change
APP-239	7.2	Habitats Regulations Assessment Screening Report	No change
APP-241	7.4	Report to Inform Appropriate Assessment Integrity Matrices	No change
APP-242	7.5	Derogation Case	No change
APP-243	7.6	Without Prejudice Benthic Without Prejudice Compensation Strategy	No change
APP-244	7.6.1	Without Prejudice Sandbank Compensation Plan	No change
APP-245	7.6.1.1	Sandbank Compensation Implementation and Monitoring Plan	No change
APP-246	7.6.2	Without Prejudice Biogenic Reef Compensation Plan	No change
APP-247	7.6.2.1	Biogenic Reef Compensation Implementation and Monitoring Plan	No change
APP-248	7.6.3	Without Prejudice Benthic Compensation Evidence Base and Roadmap	No change
APP-249	7.7	Ornithology Compensation Strategy	No change
APP-250	7.7.1	Kittiwake Compensation Plan	No change
APP-251	7.7.1.1	Outline Kittiwake Compensation Implementation and Monitoring Plan	No change
APP-252	7.7.2	Without Prejudice Guillemot Compensation Plan	No change
APP-253	7.7.2.1	Outline Guillemot Compensation Implementation and Monitoring Plan	No change
APP-254	7.7.3	Without Prejudice Razorbill Compensation Plan	No change
APP-255	7.7.3.1	Outline Razorbill Compensation Implementation and Monitoring Plan	No change
APP-256	7.7.4	Offshore Artificial Nesting Structure Evidence & Road Map	No change
APP-257	7.7.5	Without Prejudice Predator Control Evidence & Road Map	No change

APP-258	7.7.5.1	Plémont Seabird Reserve Feasibility Study Report	No change
APP-259	7.7.6	Without Prejudice Other measures Evidence & Road Map	No change
APP-260	7.8	The Crown Estate Kittiwake Strategic Compensation Plan	No change
APP-261	7.8.1	App A TCE Kittiwake Strategic Implementation Monitoring Plan	No change
APP-262	7.8.2	App B Letter of Acceptance from Secretary of State	No change
APP-263	7.8.3	App D NIRAS Site Selection ANS AoS	No change
APP-265	7.9.1	Accounts of TotalEnergies	No change
APP-266	7.9.2	Accounts of Macquarie Group	No change
APP-267	7.9.3	Accounts of GULF	No change
APP-269	8.1.1	Outline Noise and Vibration Management Plan	No change
APP-270	8.1.2	Outline Air quality management plan	No change
APP-272	8.1.4	Outline Pollution Prevention and Emergency Incident Response Plan	No change
APP-273	8.1.5	Outline Surface Water Drainage Strategy	No change
APP-274	8.1.6	Outline Site Waste Management Plan	No change
APP-275	8.2	Outline Offshore Operations and Maintenance Plan	No change
APP-276	8.3	In Principle Monitoring Plan	No change
APP-277	8.4	Outline Project Environmental Management Plan	No change
APP-285	8.11	Outline Operational Artificial Light Emissions Management Plan	No change
APP-286	8.12	Outline Operational Drainage Management Plan	No change
APP-289	8.15	Outline Construction Traffic Management Plan	No change

APP-290	8.16	Outline Travel Plan	No change
APP-292	8.18	Design Approach Document	No change
APP-293	8.19	Design Principles Statement	No change
APP-295	8.21	Outline Scour Protection and Cable Protection Management Plan	No change
APP-297	9.1	Planning Statement	No change
APP-300	9.3	Safety Zone Statement	No change
APP-301	9.4	Statutory Nuisance Statement	No change
APP-302	9.5	Biodiversity Net Gain Report Principles and Approach	No change
AS-001	PP1-ODOW-DEV-CS-LOG-0008	Ornithology: Population Viability Analysis Parameter log	No change
AS-002	PP1-ODOW-DEV-CS-LOG-0009	Offshore and Intertidal Ornithology: Population Viability Analysis Parameter log	No change
AS-003	6.3.7.1	Chapter 7 Appendix 1 Physical Processes Technical Baseline	No change
AS-004	6.3.9.2	Chapter 9 Appendix 2 Benthic Ecology Technical Report (ECC)	No change
AS-005	6.3.12.5	Chapter 12 Appendix 5 Migratory Collision Risk Modelling	No change
AS1-001	13.1	The Applicant's Response to Section 51 Advice Covering Letter	No change
AS1-027; AS1-028	3.3*	Other Consents and Licences	No change
AS1-034; AS1-035	5.1*	Consultation Report	No change

AS1-036; AS1-037	5.1.4B*	Consultation Report Appendix 4B Section 42 Consultation Responses	No change
AS1-038; AS1-039	6.1.8*	Chapter 8 Marine Water and Sediment Quality	No change
AS1-040; AS1-041	6.1.12*	Chapter 12 Offshore and Intertidal Ornithology	No change
AS1-064; AS1-065	6.3.12.1*	Chapter 12 Appendix 1 Offshore and Intertidal Ornithology Technical Baseline	No change
AS1-042; AS1-043	6.1.16*	Chapter 16 Aviation, Radar, Military and Communication	No change
AS1-044; AS1-045	6.1.17*	Chapter 17 Seascape, Landscape and Visual	No change
AS1-056	6.2.17	Chapter 17 Seascape, Landscape and Visual Figures (Part 1 of 3)	No change
AS1-046; AS1-047	6.1.19*	Chapter 19 Onshore Air Quality	No change
AS1-066; AS1-067	6.3.19.1*	Chapter 19 Appendix 1 Construction Phase Dust Assessment Methodology	No change
AS1-048; AS1-049	6.1.20*	Chapter 20 Onshore Archaeology and Cultural Heritage	No change
AS1-057	6.2.21.1	Chapter 21 Onshore Ecology Figures (Part 1 of 2)	No change
AS1-058	6.2.23	Chapter 23 Geology and Ground Conditions Figures	No change
AS1-059	6.3.23.1	Chapter 23 Appendix 1 Preliminary Land Quality Risk Assessment	No change

AS1-070; AS1-071	6.3.24.3*	Chapter 24 Appendix 3 Flood Risk Assessment: Onshore Substation Part 1 of 8	No change
AS1-072; AS1-073	6.3.24.3*	Chapter 24 Appendix 3 Flood Risk Assessment: Onshore Substation Part 2 of 8	No change
AS1-074; AS1-075	6.3.24.3*	Chapter 24 Appendix 3 Flood Risk Assessment: Onshore Substation Part 3 of 8	No change
AS1-076; AS1-077	6.3.24.3*	Chapter 24 Appendix 3 Flood Risk Assessment: Onshore Substation Part 4 of 8	No change
AS1-078; AS1-079	6.3.24.3*	Chapter 24 Appendix 3 Flood Risk Assessment: Onshore Substation Part 5 of 8	No change
AS1-080; AS1-081	6.3.24.3*	Chapter 24 Appendix 3 Flood Risk Assessment: Onshore Substation Part 6 of 8	No change
AS1-082; AS1-083	6.3.24.3*	Chapter 24 Appendix 3 Flood Risk Assessment: Onshore Substation Part 7 of 8	No change
AS1-084; AS1-085	6.3.24.3*	Chapter 24 Appendix 3 Flood Risk Assessment: Onshore Substation Part 8 of 8	No change
AS1-050; AS1-051	6.1.25*	Chapter 25 Land Use	No change
AS1-060	6.2.25	Chapter 25 Land Use Figures	No change
AS1-052; AS1-053	6.1.27*	Chapter 27 Traffic and Transport	No change
AS1-061	6.2.27	Chapter 27 Traffic and Transport Figures	No change
AS1-086; AS1-087	6.3.27.1*	Chapter 27 Appendix 1 Transport Assessment	No change

AS1-088	6.3.27.1	Chapter 27 Appendix 1 Transport Assessment Annex B DfT Traffic Data	No change
AS1-089	6.3.27.1	Chapter 27 Appendix 1 Transport Assessment Annex C Automatic Traffic Count Data	No change
AS1-090	6.3.27.1	Chapter 27 Appendix 1 Transport Assessment Annex F Construction Access General Arrangement Drawings	No change
AS1-091	6.3.27.1	Chapter 27 Appendix 1 Transport Assessment Annex G Core and Local Construction Vehicle Access Routes	No change
AS1-092	6.3.27.1	Chapter 27 Appendix 1 Transport Assessment Annex J Trip Generation Calculations	No change
AS1-093	6.3.27.1	Chapter 27 Appendix 1 Transport Assessment Annex K Daylight Hours Availability	No change
AS1-094	6.3.27.1	Chapter 27 Appendix 1 Transport Assessment Annex N Passing Place Proposals	No change
AS1-054; AS1-055	6.1.30*	Chapter 30 Human Health	No change
AS1-095; AS1-096	7.1*	Report to Inform Appropriate Assessment	No change
AS1-097; AS1-098	7.1*	Report to Inform Appropriate Assessment [Confidential]	No change
AS1-099; AS1-100	7.1.1*	Offshore and Intertidal Ornithology Apportioning	No change
AS1-101; AS1-102	7.3*	Report to Inform Appropriate Assessment Screening Matrices	No change
AS1-108	13.2	Chapter 22 Appendix 3 Addendum: Winter Bird Survey 2023/24	No change
AS1-109	13.3	Applicant's Approach to Ordnance Survey Mapping Update	No change
AS-009	14.1	The Applicant's Response to Rule 17 Letter dated 3 July 2024 Covering Letter	No change

AS-011	14.2	The Applicant's Response to the Rule 17 Letter dated 3 July 2024	No change
AS-012	14.3	Biodiversity Net Gain Assessment Report	No change
AS-013	14.3.1	Biodiversity Net Gain Assessment Report Figure 1 BNG Assessment Boundary	No change
AS-014	14.3.2	Biodiversity Net Gain Assessment Report Figure 2 Pre-development (Baseline) Habitats	No change
AS-015	14.3.3	Biodiversity Net Gain Assessment Report Figure 3 Habitat Retention and Loss Status	No change
AS-016	14.3.4	Biodiversity Net Gain Assessment Report Figure 4 Post Development Habitats	No change
AS-017	14.3.5	Biodiversity Net Gain Assessment Report Figure 5 OnSS Indicative Layout and Mitigation (BNG)	No change
AS-018	14.3.6	Biodiversity Net Gain Assessment Report Figure 6 Baseline Habitat Units	No change
AS-019	14.3.7	Biodiversity Net Gain Assessment Report Figure 7 Post Development Habitat Units	No change
AS-020	9.1.1	Policy Compliance Document	No change
PD1-001	15.1	The Applicant's Procedural Deadline 19 September Covering Letter	No change
PD1-004	2.1	Works Plans Onshore	Refinements and updates to the Order limits as described in Appendix 1 (Change 1 and 3), as well as other changes which are not the subject of this Change Application.
PD1-005	2.2	Works Plans Offshore	Refinements and updates to the Order limits as described in Appendix 1 (Change 1 and 2) as well as other changes which are not the subject of this Change Application
PD1-006	2.3	Location Plan Onshore	Refinements and updates to the Order limits as described in Appendix 1 (Change 1 and 3) as well as other changes which are not the subject of this Change Application

PD1-007	2.4	Location Plan Offshore	Refinements and updates to the Order limits as described in Appendix 1 (Change 1 and 2) as well as other changes which are not the subject of this Change Application
PD1-009	2.6	Crown Land Plans Onshore	Refinements and updates to the Order limits as described in Appendix 1 (Change 1 and 3) as well as other changes which are not the subject of this Change Application
PD1-010	2.7	Crown Land Plans Offshore	Refinements and updates to the Order limits as described in Appendix 1 (Change 1 and 2) as well as other changes which are not the subject of this Change Application
PD1-011	2.8	Offshore Order Limits and Grid Coordinates Plan	Refinements and updates to the Order limits as described in Appendix 1 (Change 1 and 2) as well as other changes which are not the subject of this Change Application
PD1-012	2.9	Access to Works Plan	Refinements and updates to the Order limits as described in Appendix 1 (Change 1 and 3) as well as other changes which are not the subject of this Change Application
PD1-013	2.10	Public Rights of Way Plan	Refinements and updates to the Order limits as described in Appendix 1 (Change 1 and 3) as well as other changes which are not the subject of this Change Application
PD1-014	2.11	Streets Plan	Refinements and updates to the Order limits as described in Appendix 1 (Change 1 and 3) as well as other changes which are not the subject of this Change Application
PD1-015	2.12	Special Category Land Onshore	Refinements and updates to the Order limits as described in Appendix 1 (Change 1 and 3) as well as other changes which are not the subject of this Change Application

PD1-016	2.13	Historic Environment Plan Onshore	Refinements and updates to the Order limits as described in Appendix 1 (Change 1 and 3) as well as other changes which are not the subject of this Change Application
PD1-017	2.14	Historic Environment Plan Offshore	Refinements and updates to the Order limits as described in Appendix 1 (Change 1 and 2) as well as other changes which are not the subject of this Change Application
PD1-018	2.15	Statutory and Non-Statutory Nature Conservation Sites Plan Onshore	Refinements and updates to the Order limits as described in Appendix 1 (Change 1 and 3) as well as other changes which are not the subject of this Change Application
PD1-019	2.16	Statutory and Non-Statutory Nature Conservation Sites Plan Offshore	Refinements and updates to the Order limits as described in Appendix 1 (Change 1 and 2) as well as other changes which are not the subject of this Change Application
PD1-020	2.17	Important Hedgerows and Tree Preservation Order Plan	Refinements and updates to the Order limits as described in Appendix 1 (Change 3)
PD1-021	2.18	Onshore Crossing Plan	Refinements and updates to the Order limits as described in Appendix 1 (Change 1 and 3) as well as other changes which are not the subject of this Change Application
PD1-022	2.19	Offshore Crossing Plan	Refinements and updates to the Order limits as described in Appendix 1 (Change 1 and 2) as well as other changes which are not the subject of this Change Application
PD1-023	2.20	Traffic Regulation Order Plan	Refinements and updates to the Order limits as described in Appendix 1 (Change 1 and 3) as well as other changes which are not the subject of this Change Application
PD1-027; PD1-028	3.2*	Explanatory Memorandum	No change

PD1-034; PD1-035	6.3.3.2*	Chapter 3 Appendix 2 Onshore Crossing Schedule	No Change.
PD1-036; PD1-037	6.3.24.2*	Chapter 24 Appendix 2 Flood Risk Assessment ECC and 400kV Cable Corridor	Updates to figures within this document reflect the changes to the Order limits as described in Appendix 1 (Change 1 and 3).
PD1-038; PD1-039	8.1*	Outline Code of Construction Practice	No change
PD1-040; PD1-041	8.1.3*	Outline Soil Management Plan	No change
PD1-042; PD1-043	8.5*	Outline Cable Specification and Installation Plan	No change
PD1-044; PD1-045	8.6.1*	Outline Marine Mammal Mitigation Protocol (Piling)	Updated to reflect remodelling carried out as a result of Change 2, as well as other changes which are not the subject of this Change Request (the inclusion of the ORBA).
PD1-046; PD1-047	8.6.2*	Outline Marine Mammal Mitigation Protocol (UXO)	No change
PD1-048; PD1-049	8.7*	In Principle Southern North Sea Special Area of Conservation Site Integrity Plan	Updates to figures within this document reflect the changes to the Order limits as described in Appendix 1 (Change 2) as well as other changes which are not the subject of this (the inclusion of the ORBA).
PD1-050; PD1-051	8.8*	Outline Marine Archaeological WSI	As a result of the Change 2 (ECC Revision), the assessment and mitigation sections of this document have been updated to reflect the smaller area of seabed which could be affected. The inclusion of Change 2 is also reflected in updates to figures (as is the inclusion of the ORBA which is not subject to this Change Request).
PD1-052; PD1-053	8.9*	Outline Onshore Archaeological WSI	No change

PD1-054; PD1-056	8.10*	Outline Landscape and Ecological Management Strategy	No change
PD1-055; PD1-057	8.10* Confidential	Outline Landscape and Ecological Management Strategy [Confidential]	No change
PD1-058; PD1-059	8.13*	Schedule of Mitigation	No Change (Though please note that Change 2 is referred to in a document name (page 14 refers to the “ <i>Environmental Report for the Offshore Restricted Build Area and Revision to the Offshore Export Cable Corridor</i> ”) however it does so in relation to the ORBA – not subject to this Change Request– being a new mitigation)).
PD1-060; PD1-061	8.14*	Outline Fisheries Liaison and Co-existence Plan	Updates to figure within this document reflect the changes to the Order limits as described in Appendix 1 (Change 2) as well as other changes which are not the subject of this Change Request (the inclusion of the ORBA).
PD1-062; PD1-063	8.17	Outline Public Access Management Plan	Changes made to reflect refinements and updates to the Order limits as described in Appendix 1 (Change 3) as well as other changes which are not the subject of this Change Request.
PD1-064; PD1-065	8.20*	Outline Vessel Management Plan	Changes made to reflect refinements and updates to the Order limits as described in Appendix 1 (Change 2) as well as other changes which are not the subject of this Change Request (the inclusion of the ORBA).
PD1-066; PD1-067	8.22*	Outline Biogenic Reef Mitigation Plan	No change
PD1-068; PD1-069	9.2*	Cable statement	This Statement was updated to include a new figure which amends the Order limit in line with Change 2 (ECC Revision) as well as other changes which are not the subject of this Change Request (the

			inclusion of the ORBA). Small textual inclusions were made to explain Change 2.
PD1-070	15.2	The Applicant's Response to the Rule 17 Letter dated 31 July 2024	No change. (though please note that this document refers to the fact that the Applicant has submitted documents which relate in part to Change 2 (Docs 15.9 and 15.10 and appendices, PD1-081-PD1-092).
PD1-071	15.3	The Applicant's Responses to Relevant Representations	Change 2 is referred to in the Applicant's responses to Relevant Representations (see RR-027.002 where reference is made to the updated assessment of offshore archaeology due to, among other things, the removal of the northern option of the ECC (Change 2)).
PD1-073	15.5	Pre-Examination Principal Issues Progress Tracker	No change (though please note that this document refers to the fact that the Applicant has submitted documents which relate in part to Change 2 (Docs 15.9 and 15.10 and appendices, PD1-081-PD1-092)).
PD1-074	15.6	Erratum to Site Selection Report	No change
PD1-075	15.7	Noise Bund Hydraulic Modelling Report	No change
PD1-076	15.7A	Noise Bund Hydraulic Modelling Report Appendix C Figures Part 1 of 4	No change
PD1-077	15.7A	Noise Bund Hydraulic Modelling Report Appendix C Figures Part 2 of 4	No change
PD1-078	15.7A	Noise Bund Hydraulic Modelling Report Appendix C Figures Part 3 of 4	No change
PD1-079	15.7A	Noise Bund Hydraulic Modelling Report Appendix C Figures Part 4 of 4	No change
PD1-080	15.8	Onshore Archaeological Geophysical Report	No change

PD1-081	15.9	Environmental Report for the Offshore Restricted Build Area and Revision to the Offshore Export Cable Corridor	Among other things, this document supports Change 2 (the ECC Revision) as well as the inclusion of the ORBA (not subject to this Change Application).
PD1-082	15.9A	Offshore Restricted Build Area and Revision to the Offshore Export Cable Corridor Appendix A Figures	Among other things, this document supports Change 2 (the ECC Revision) as well as the inclusion of the ORBA (not subject to this Change Application).
PD1-083	15.9A Part 2	Offshore Restricted Build Area and Revision to the Offshore Export Cable Corridor Appendix A Figures	Among other things, this document supports Change 2 (the ECC Revision) as well as the inclusion of the ORBA (not subject to this Change Application).
PD1-084	15.9B	Offshore Restricted Build Area and Revision to the Offshore Export Cable Corridor Appendix B Blockage Modelling Results	Among other things, this document supports Change 2 (the ECC Revision) as well as the inclusion of the ORBA (not subject to this Change Application).
PD1-085	15.9C	Offshore Restricted Build Area and Revision to the Offshore Export Cable Corridor Appendix C Underwater Noise Modelling Report	Among other things, this document supports Change 2 (the ECC Revision) as well as the inclusion of the ORBA (not subject to this Change Application).
PD1-086	15.9D	Offshore Restricted Build Area and Revision to the Offshore Export Cable Corridor Appendix D Ornithology Baseline Summary	Among other things, this document supports Change 2 (the ECC Revision) as well as the inclusion of the ORBA (not subject to this Change Application).
PD1-087	15.9E	Offshore Restricted Build Area and Revision to the Offshore Export Cable Corridor Appendix E Collision Risk Modelling	Among other things, this document supports Change 2 (the ECC Revision) as well as the inclusion of the ORBA (not subject to this Change Application).
PD1-088	15.9F	Offshore Restricted Build Area and Revision to the Offshore Export Cable Corridor Appendix F Offshore Ornithology Displacement Assessment	Among other things, this document supports Change 2 (the ECC Revision) as well as the inclusion of the ORBA (not subject to this Change Application).

PD1-089	15.9G	Offshore Restricted Build Area and Revision to the Offshore Export Cable Corridor Appendix G MRSea Modelling for Offshore Ornithology	Among other things, this document supports Change 2 (the ECC Revision) as well as the inclusion of the ORBA (not subject to this Change Application).
PD1-090	15.9H	Offshore Restricted Build Area and Revision to the Offshore Export Cable Corridor Appendix H Review of Obstacle Free Zone Impact on Shipping Displacement and Collision Risk	Among other things, this document supports Change 2 (the ECC Revision) as well as the inclusion of the ORBA (not subject to this Change Application).
PD1-091	15.10	Habitats Regulations Assessment for the Offshore Restricted Build Area and Revision to the Offshore Export Cable Corridor	Among other things, this document supports Change 2 (the ECC Revision) as the inclusion of the ORBA (not subject to this Change Application).
PD1-092	15.10A	Habitats Regulations Assessment for the Offshore Restricted Build Area and Revision to the Offshore Export Cable Corridor Appendix A Offshore and Intertidal Ornithology Apportioning	Among other things, this document supports Change 2 (the ECC Revision) as well as the inclusion of the ORBA (not subject to this Change Application).
PD1-093	15.11	Additional clarifications relating to Natural England's Relevant Representations (Appendix I Onshore Ornithology)	No change
PD1-094	15.12	iPCoD Interim Population Consequences of Disturbance Modelling Report	No change
PD1-095	15.13	Envision Sabellaria spinulosa reanalysis and report	Figures within the document reflect the change in Order Limit by Change 2 (ECC Revision) among other changes which are not subject to this Change Application (the ORBA)
PD1-096	15.14	Addendum to RIAA Onshore Ornithology	No change
PD1-097	15.15	Disposal Site Characterisation Report	This document takes into account Change 2 as well as other changes which are not subject to this Change Request (the ORBA)
PD1-098	15.16	Collaborative Delivery of Kittiwake Compensation Letter of Intent	No change
PD1-099	15.17	Letter From Jersey Government Anti-Predator Fence East of Plemont, Jersey, Channel Islands	No change
PD1-100	15.18	Draft Statement of Commonality	No change

PD1-101	15.19	The Applicant's Response to Transboundary Consultation Responses	No change
PD1-102	N/A	Responses to the Rule 6 letter relating to Examination procedure, including any submissions about the draft Examination Timetable and the use of virtual methods	No change
AS-021	16.1	Applicant's Notification of Intention to Submit a Change Request dated 29 August 2024	No change
AS-025	17.1	The Applicant's Response to the ExA's Procedural Decision 30 September 2024 and Change Notification	No change
n/a	18.1	The Applicant's Deadline 1 Covering Letter	No change
Superseding PD1-002	1.2	Guide to the Application	Updates to the Guide have included reflecting the fact that certain documents were either (i) updated (such as Plans) or (ii) submitted (such as the ORBA and ECC Revision suite of documents (15.9, 15.10, and appendices; PD1-081-PD1-092)) due to the changes described in Appendix 1 (as well as other changes which are not the subject of this Change Request).
Superseding PD1-003	2.0	Schedule of Changes for Plans	Updated to describe refinements and updates to the Order limit as set out in the Plans as a result of the changes described in Appendix 1 (as well as due to other changes which are not the subject of this Change Request).
Superseding PD1-008	2.5	Land Plans	Refinements and updates to the Order limits as described in Appendix 1 (Change 1 and 3) as well as other changes which are not the subject of this Change Request
Superseding PD1-024; PD1-025	3.1*	Draft Development Consent Order	Updated to reflect the refinements and updates described in Appendix 1 (Changes 1 – 3) as well as other changes which are not the subject of this Change Request.
Superseding PD1-026;	3.1.1	Schedule of Changes to the Draft DCO	Updated to set out the Changes described in relation to Document 3.1.

Superseding PD1-029; PD1-030	4.1*	Book of Reference	Changes made to reflect refinements and updates to the Order limits as described in Appendix 1 (Change 1 and 3) as well as other changes which are not the subject of this Change Request
Superseding PD1-031	4.1.1	Schedule of Changes to the Book of Reference	Updated to set out changes made to reflect refinements and updates to the Order limits as described in Appendix 1 (Change 1 and 3) as well as other changes which are not the subject of this Change Request.
Superseding APP-026	4.2*	Compulsory Acquisition Funding Statement	No change
Superseding PD1-032; PD1-033	4.3*	Statement of Reasons	Changes made to reflect refinements and updates to the Order limits as described in Appendix 1 (Change 1 and 3) as well as other changes which are not the subject of this Change Request
Superseding APP-264	7.9*	Compensation Funding Statement	No change
Superseding PD1-072	15.4*	Compulsory Acquisition and Land Rights Tracker (Schedule of Negotiations and Powers Sought)	No change
n/a	18.2	The Applicant's Responses to Additional Submissions and Relevant Representations	No change
n/a	18.3	The Applicant's Comments on Oral Submissions made and Written Summary of Oral Case at the OFH held on 10 October 2024	No change
n/a	18.4	The Applicant's suggested locations for the ASI	No change
n/a	18.5	Applicant's planning obligations and side agreements tracker	No change
n/a	18.6	The Applicant's response to the ExA's request for further information in relation to the proposed ORBA and the revision to the Offshore ECC	Document submitted partly in response to the notification in relation to Change 2.
n/a	18.7	Statement of Common Ground with Anglian Water Services	No change

n/a	18.8	Statement of Common Ground with Environment Agency	No change
n/a	18.9	Statement of Common Ground with Historic England	No change
n/a	18.10	Statement of Common Ground with Lincolnshire County Council (LCC)	No change
n/a	18.11	Statement of Common Ground with Local Planning Authorities	No change
n/a	18.12	Statement of Common Ground with Maritime and Coastguard Agency (MCA)	This document references Change 2 as well as other changes which are not the subject of this Change Request (inclusion of the ORBA)
n/a	18.13	Statement of Common Ground with NATS	No change
n/a	18.15	Statement of Common Ground with NGET	No change
n/a	18.16	Statement of Common Ground with Chamber of Shipping	This document references Change 2 as well as other changes which are not the subject of this Change Request (inclusion of the ORBA)
n/a	18.17	Statement of Common Ground with the Marine Management Organisation (MMO)	No change (though please note that this document refers to the fact that the Applicant has submitted documents which relate in part to Change 2 (Docs 15.9 and 15.10 and appendices, PD1-081-PD1-092)).
n/a	18.18	Statement of Common Ground with the Ministry of Defence (MoD)	No change
n/a	18.19	Statement of Common Ground with the RSPB	No change
n/a	18.20	Statement of Common Ground with Trinity House	No change (though please note that this document refers to the fact that the Applicant has submitted documents which relate in part to Change 2 (Docs 15.9 and 15.10 and appendices, PD1-081-PD1-092)).
n/a	18.21	The Applicant's Change Notification dated 24 October	No change
n/a	18.22	The Applicant's Change Request dated 24 October	No change

* Indicates that clean and tracked versions have been submitted

4 Appendix 4: Plan illustrating minor onshore Order Limit reductions notified in AS-025

Drawing Location: C:\Users\William.Stuart\Documents\DM Plans\2200087_PLN_INFO_13246.dwg - Generated: 22/09/2024 10:51:22

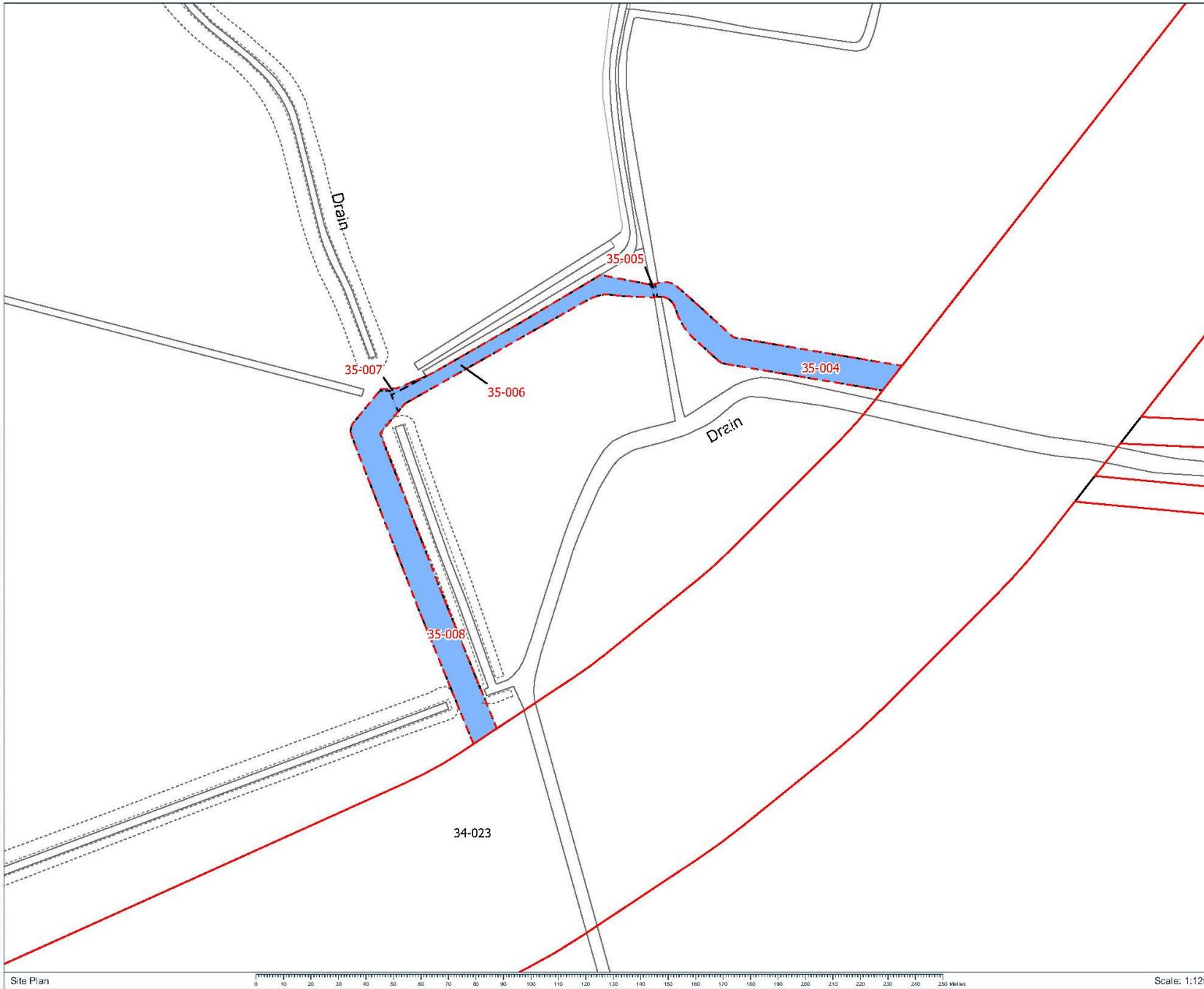

DM
**DALCOUR
MACLAREN**

Location Plan 0 100 200 300 400 500 m Scale: 1:25000

Key:

- Order Limits (September 2024)
- Order Limits (July 2024)
- Previous Plot Extent
- Land Plot
- Land Removed from Order Limits

Notes:

Coordinate System: British National Grid
 Projection: Transverse Mercator
 Datum: OSGB 1936

Interest:
N/A

Location:
Wileys Lane, White House, Boston, PE20 1BB

Coords: 534838, 339406

Scheme Name:
Outer Dowsing

Drawing Name:
Information Plan

Drawing No: 22000087_PLN_INFO_13246.1

Rev	Date	Description
-	22.10.2024	First Issue

Drawn: WS

Approved: PW

Sheet No:

Sheet Size: A3

The information contained in this document is confidential and protected by copyright. The user, recipient or viewer is prohibited from making any copies or extracts from the content, permission of and in the manner prescribed by the Copyright Licensing Corporation. Any use, reproduction or copyright infringement is prohibited. The user, recipient or viewer is prohibited from making any copies or extracts from the content of this document without the prior written consent of the copyright owner. All requirements must be confirmed in the BODS (BODS) terms and conditions. BODS (BODS) is a trademark of the Crown Copyright. BODS (BODS) is a trademark of the Crown Copyright. BODS (BODS) is a trademark of the Crown Copyright. BODS (BODS) is a trademark of the Crown Copyright. BODS (BODS) is a trademark of the Crown Copyright.

Site Plan

Scale: 1:1250

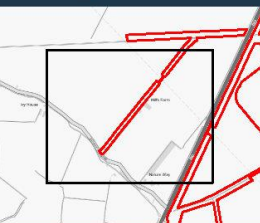
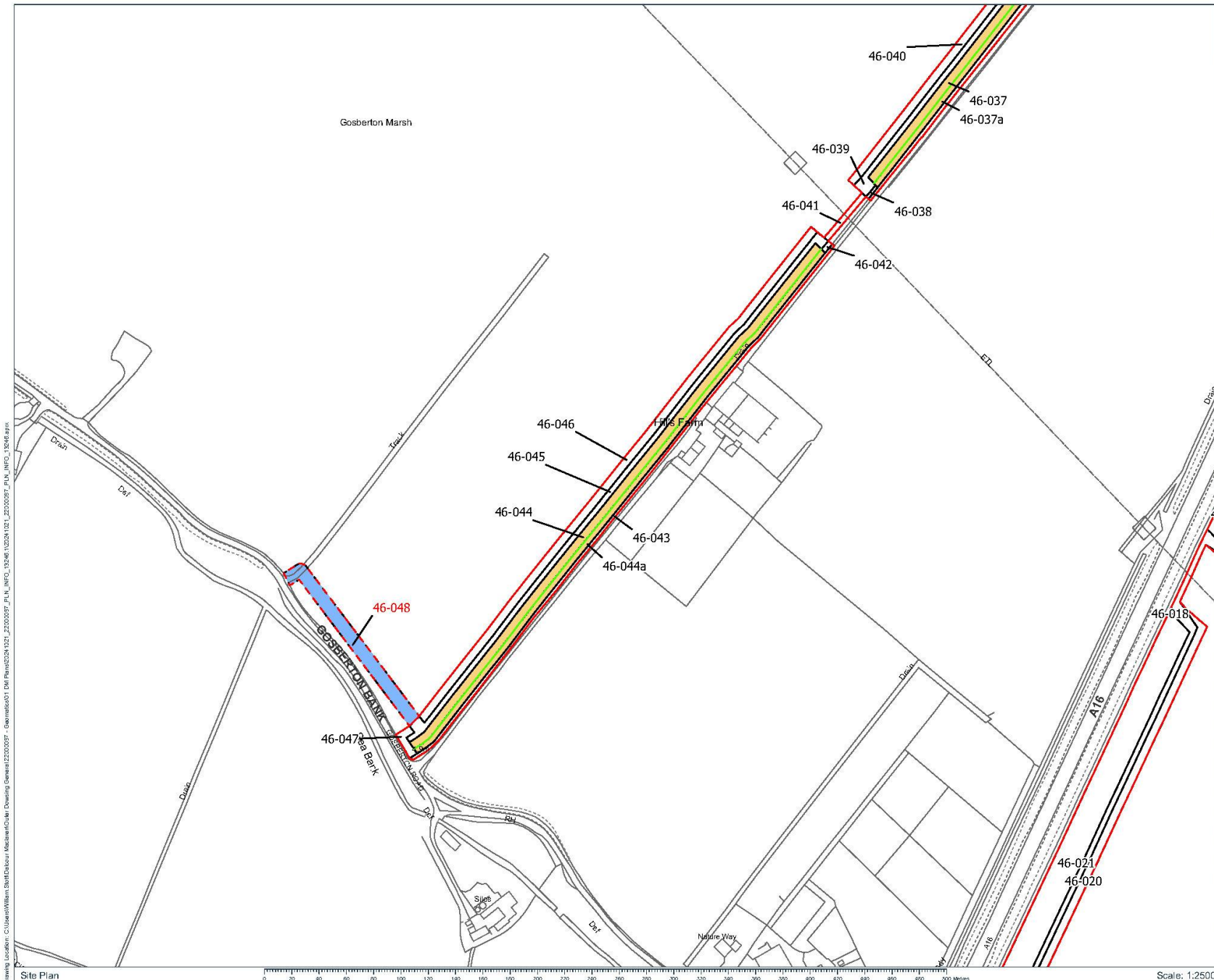

Location Plan 0 100 200 300 400 500 m Scale: 1:25000

- Key:**
- Order Limits (September 2024)
 - Order Limits (July 2024)
 - Previous Plot Extent
 - Land Plot
 - Split Land Plot
 - Land Removed from Order Limits
 - Land removed from plot 46-048 and added to 46-045
 - Plot Split

Notes:
 Coordinate System: British National Grid
 Projection: Transverse Mercator
 Datum: OSGB 1936

Interest:
 N/A

Location:
 Gosberton Bank, Walthams Cottages,
 Gosberton, South Holland, PE11 4PB

Coords: 527258, 331346

Scheme Name:
 Outer Dowsing

Drawing Name:
 Information Plan

Drawing No: 22000087_PLN_INFO_13248.1

Rev	Date	Description
-	22.10.2024	First Issue

Drawn:	WS	
Approved:	PW	
Sheet No:		
Sheet Size:	A3	



The information contained in this document is confidential and protected by copyright. No part of this document may be reproduced, stored in a retrieval system, or transmitted in any form or by any means, electronic, mechanical, photocopying, recording, or by any information storage and retrieval system, without the prior written permission of the copyright owner. The copyright owner shall not be liable for any loss or damage, including consequential loss or damage, arising from the use of this document. All measurements must be confirmed on site. B&B EP UPON THE CERTIFICATE ISSUED AND WITHIN THE SCOPE OF THE CONTRACT OF WORKS UNDER OFFICE 4. CROWN COPYRIGHT RESERVED. © OS LICENCE NO 010001977

Drawing Location: C:\Users\William.Stuart\Documents\Outer Dowsing\General\22000087_PLN_INFO_13248\22000087_PLN_INFO_13248.dwg

5 Appendix 5: Plan illustrating minor onshore Order Limit reductions referred to in AS-021

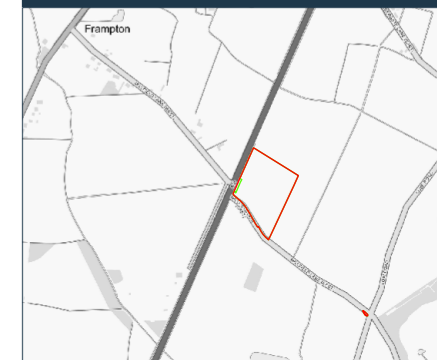

Location Plan 0 100 200 300 400 500 m Scale: 1:25000

- Key:**
- Order Limits (July 2024)
 - Order Limits (March 2024)
 - Land Plot
 - Previous Land Plot Extent
 - Land Removed from Order Limits

Notes:
 Coordinate System: British National Grid
 Projection: Transverse Mercator
 Datum: OSGB 1936

Interest:
 N/A

Location:
 Old Farm, Frampton, Wyberton, Boston,
 Lincolnshire, PE21 7DR

Coords: 531720, 340150

Scheme Name:
 Outer Dowsing

Drawing Name:
 Information Plan - Order Limit Amendments

Drawing No: 22000087_PLN_INFO_13230.5

Rev	Date	Description
-	31.07.2024	First Issue

Drawn: WS
Approved: PW
Sheet No: 5 of 9
Sheet Size: A3



The information contained in this document is confidential and protected by copyright. The use, copying or disclosure to a third party, either wholly or in part, except with the written permission of, and in the manner prescribed by SLR Consulting Limited constitutes an infringement of copyright. Dalcour Maclaren does not warrant that this document is definitive nor free of error and does not accept liability for any loss caused or arising from reliance upon information provided herein. Although our best efforts have been made to ensure the accuracy of these plans, all measurements must be confirmed on site. BASED UPON THE ORDNANCE SURVEY MAP WITH THE SANCTION OF THE CONTROLLER OF HM STATIONERY OFFICE. CROWN COPYRIGHT RESERVED. © OS LICENCE No. 0100031673

Drawing Location: C:\Users\William.Scott\Documents\Outer Dowsing\General\22000087 - Geomatics\01 DM Plans\2024\0722_22000087_PLN_INFO_13230.aprx



Site Plan

Scale: 1:1250

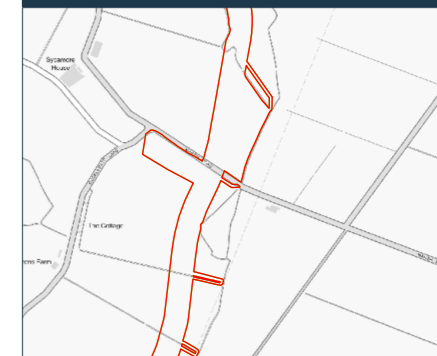

Location Plan 0 100 200 300 400 500 m Scale: 1:25000

- Key:**
- Order Limits (July 2024)
 - Order Limits (March 2024)
 - Land Plot
 - Previous Land Plot Extent
 - Land Removed from Order Limits
 - 0.85m² of land removed from plot 39-018 and Order Limits

Notes:
 Coordinate System: British National Grid
 Projection: Transverse Mercator
 Datum: OSGB 1936

Interest:
 N/A

Location:
 Marsh Road, Kirton, Boston, Lincolnshire,
 PE20 1NA

Coords: 534078, 336115

Scheme Name:
 Outer Dowsing

Drawing Name:
 Information Plan - Order Limit Amendments

Drawing No: 22000087_PLN_INFO_13230.7

Rev	Date	Description
-	31.07.2024	First Issue

Drawn: WS
Approved: PW
Sheet No: 7 of 9
Sheet Size: A3



The information contained in this document is confidential and protected by copyright. The use, copying or disclosure to a third party, either wholly or in part, except with the written permission of, and in the manner prescribed by SLR Consulting Limited constitutes an infringement of copyright. Dalcour Maclaren does not warrant that this document is definitive nor free of error and does not accept liability for any loss caused or arising from reliance upon information provided herein. Although our best efforts have been made to ensure the accuracy of these plans, all measurements must be confirmed on site. BASED UPON THE ORDNANCE SURVEY MAP WITH THE SANCTION OF THE CONTROLLER OF HM STATONERY OFFICE. CROWN COPYRIGHT RESERVED. © OS LICENCE No. 0100031673

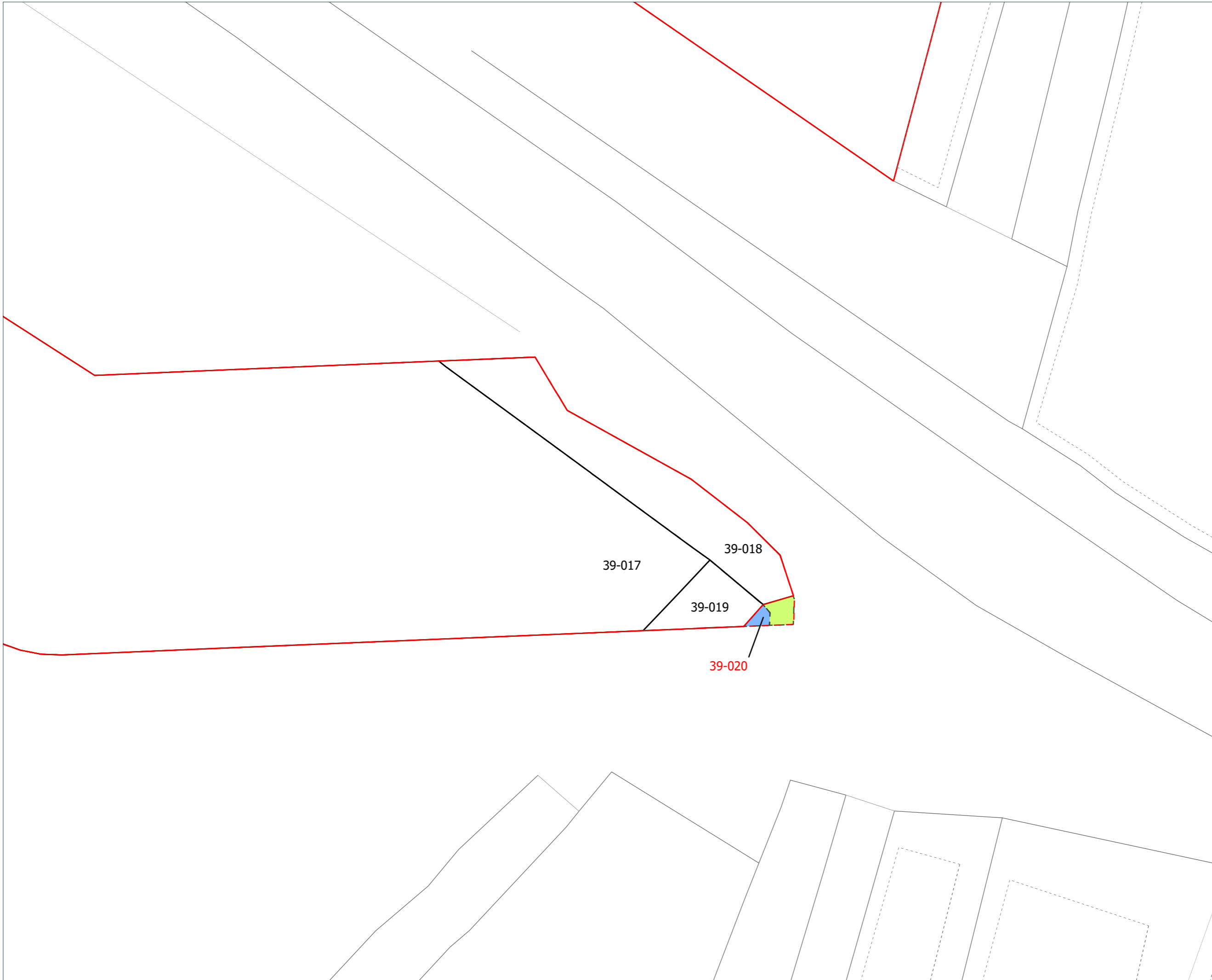

Drawing Location: C:\Users\William.Scott\Documents\Outer Dowsing General\22000087 - Geomatics\01 DM Plans\2024\0722_22000087_PLN_INFO_13230.aprx

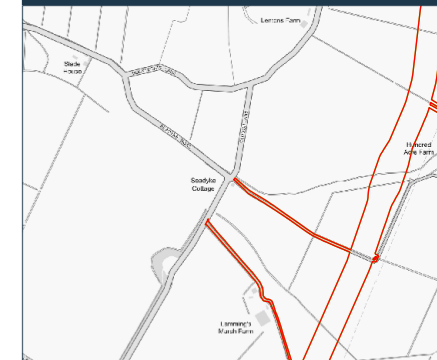

Location Plan 0 100 200 300 400 500 m Scale: 1:25000

Key:

- Order Limits (July 2024)
- Order Limits (March 2024)
- Land Plot
- Previous Land Plot Extent
- Land Removed from Order Limits

Notes:

Coordinate System: British National Grid
Projection: Transverse Mercator
Datum: OSGB 1936

Interest:

N/A

Location:

Clough Lane, Kirton, Boston, Lincolnshire,
PE20 1NB

Coords: 533257, 335324

Scheme Name:

Outer Dowsing

Drawing Name:

Information Plan - Order Limit Amendments

Drawing No: 22000087_PLN_INFO_13230.7

Rev	Date	Description
-	31.07.2024	First Issue

Drawn: WS
Approved: PW
Sheet No: 7 of 9
Sheet Size: A3



The information contained in this document is confidential and protected by copyright. The use, copying or disclosure to a third party, either wholly or in part, except with the written permission of, and in the manner prescribed by SLR Consulting Limited constitutes an infringement of copyright. Dalcour Maclaren does not warrant that this document is definitive nor free of error and does not accept liability for any loss caused or arising from reliance upon information provided herein. Although our best efforts have been made to ensure the accuracy of these plans, all measurements must be confirmed on site. BASED UPON THE ORDNANCE SURVEY MAP WITH THE SANCTION OF THE CONTROLLER OF HM STATONERY OFFICE. CROWN COPYRIGHT RESERVED. © OS LICENCE No. 0100031673

3.2m

40-003
40-004
40-005
40-006

Seadyke Cottage

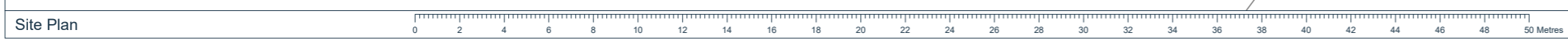

Scale: 1:250

Drawing Location: C:\Users\William.Scott\Documents\Outer Dowsing\General\22000087 - Geomatics\01 DM Plans\2024\0722_22000087_PLN_INFO_13230.aprx



Location Plan 0 100 200 300 400 500 m Scale: 1:25000

- Key:**
- Order Limits (July 2024)
 - Order Limits (March 2024)
 - Land Plot
 - Previous Land Plot Extent
 - Land Removed from Order Limits
 - Current Mean High and Low Water Lines
 - Previous Mean High and Low Water Lines

Notes:
Coordinate System: British National Grid
Projection: Transverse Mercator
Datum: OSGB 1936

Interest:
N/A

Location:
Washway Road, Fosdyke, Boston,
Lincolnshire, PE12 6LJ

Coords: 531996, 332059

Scheme Name:
Outer Dowsing

Drawing Name:
Information Plan - Order Limit Amendments

Drawing No: 22000087_PLN_INFO_13230.8

Rev	Date	Description
-	31.07.2024	First Issue

Drawn: WS
Approved: PW
Sheet No: 8 of 9
Sheet Size: A3



The information contained in this document is confidential and protected by copyright. The use, copying or disclosure to a third party, either wholly or in part, except with the written permission of, and in the manner prescribed by SLR Consulting Limited constitutes an infringement of copyright. Dalcour MacLaren does not warrant that this document is definitive nor free of error and does not accept liability for any loss caused or arising from reliance upon information provided herein. Although our best efforts have been made to ensure the accuracy of these plans, all measurements must be confirmed on site. BASED UPON THE ORDNANCE SURVEY MAP WITH THE SANCTION OF THE CONTROLLER OF HM STATIONERY OFFICE. CROWN COPYRIGHT RESERVED. © OS LICENCE No. 0100031673

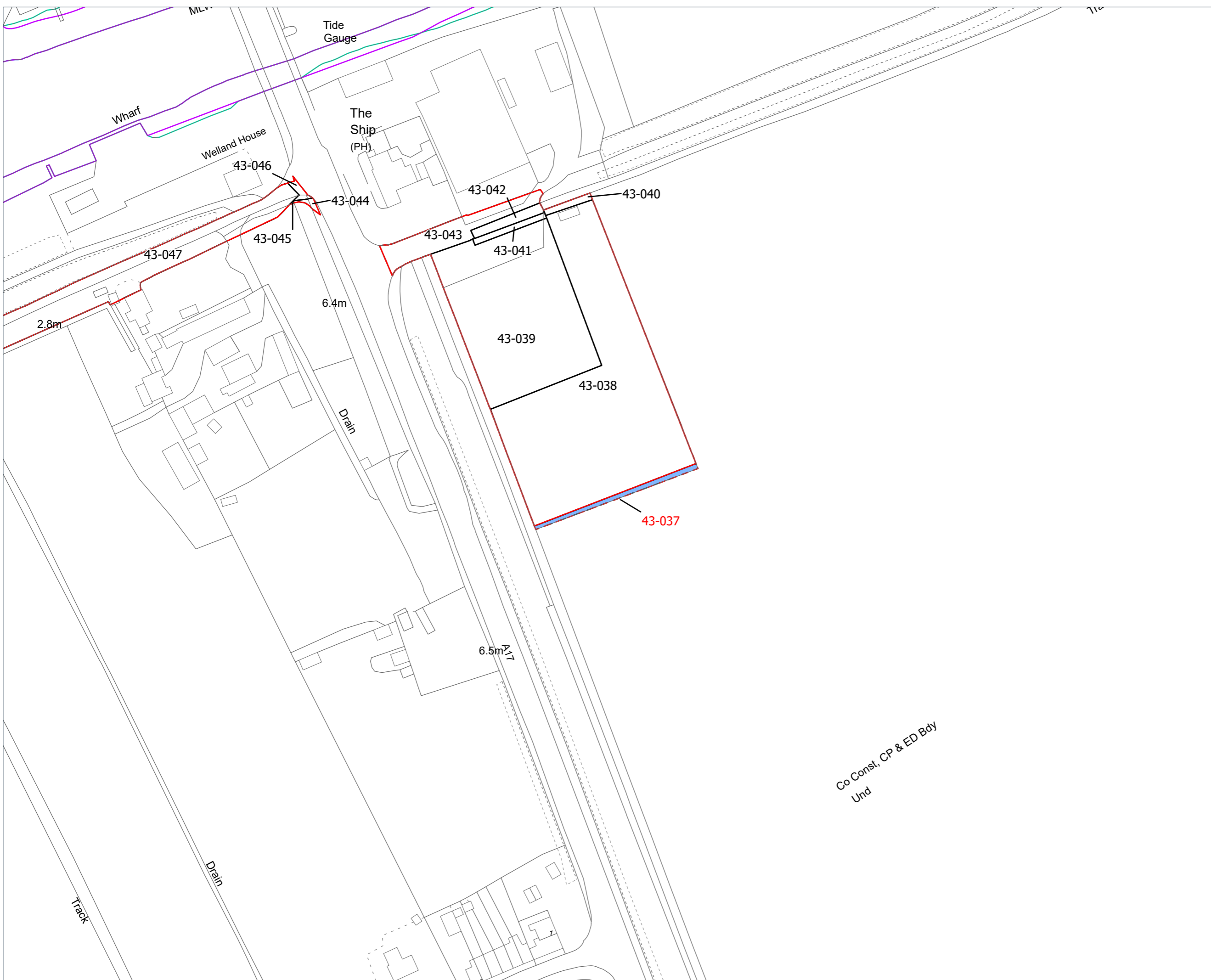

Co Const, CP & ED Bdy
Und

Site Plan 0 10 20 30 40 50 60 70 80 90 100 110 120 130 140 150 160 170 180 190 200 210 220 230 240 250 Metres

Scale: 1:1250

Drawing Location: C:\Users\William.Scott\Documents\Outer Dowsing\General\22000087 - Geomatics\01 DM Plans\2024\0722_22000087_PLN_INFO_13230.aprx