



Awel y Môr Offshore Wind Farm

Category 6: Environmental Statement

Volume 6, Annex 2.2: LVIA Figures - Figure 2.16 (Outline Landscape Mitigation Principles)

Date: April 2022

Revision: A

Application Reference: 6.6.2.2.24

Pursuant to: APFP Regulation 5(2)(a)



REVISION	DATE	STATUS/ REASON FOR ISSUE	AUTHOR:	CHECKED BY:	APPROVED BY:
A	April 2022	ES	OPEN	SLR/GoBe	RWE

www.awelymor.cymru

RWE Renewables UK
Swindon Limited

Windmill Hill Business Park
Whitehill Way
Swindon
Wiltshire SN5 6PB
T +44 (0)8456 720 090
www.rwe.com

Registered office:
RWE Renewables UK
Swindon Limited
Windmill Hill Business Park
Whitehill Way
Swindon

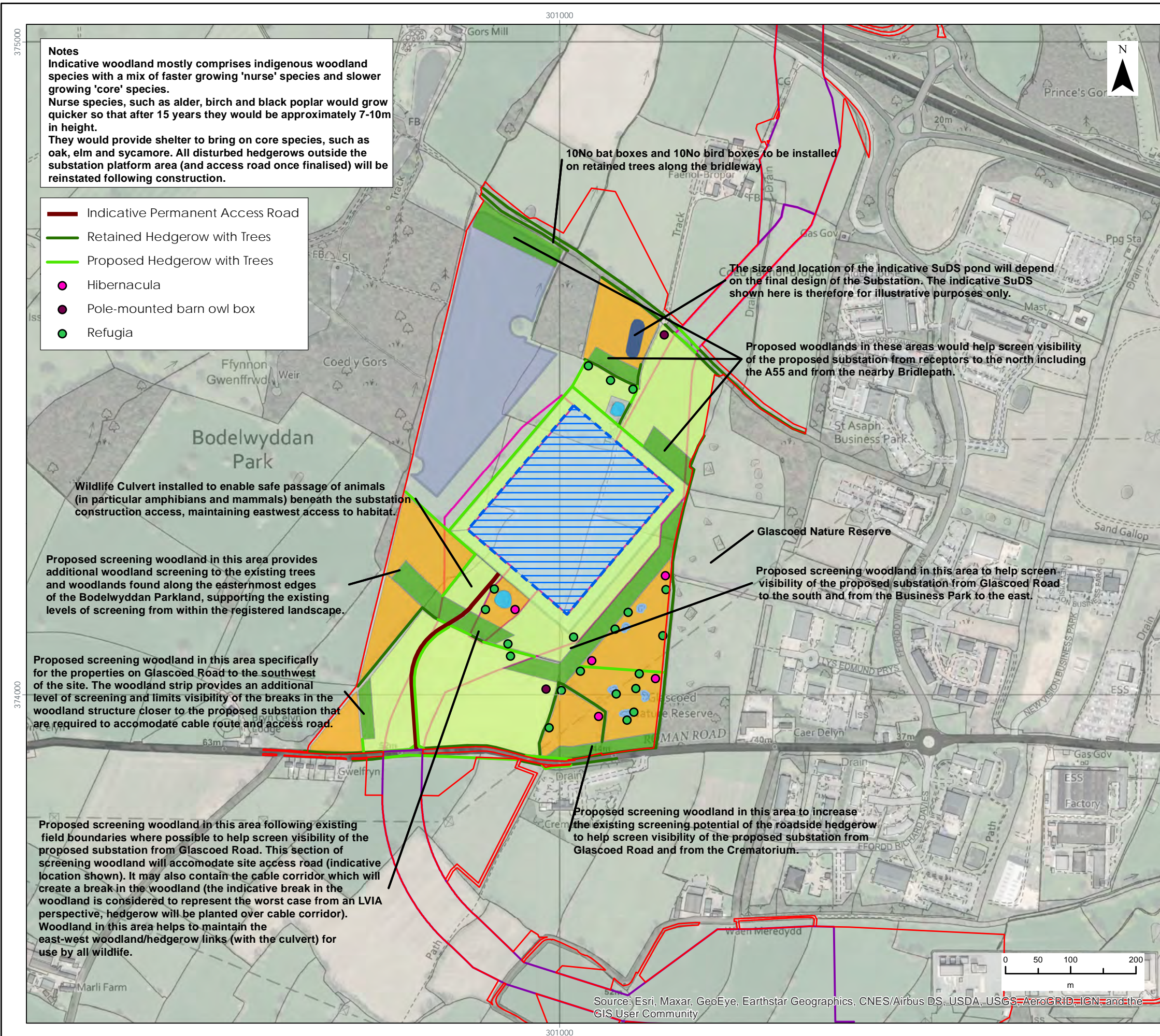

Notes
 Indicative woodland mostly comprises indigenous woodland species with a mix of faster growing 'nurse' species and slower growing 'core' species.
 Nurse species, such as alder, birch and black poplar would grow quicker so that after 15 years they would be approximately 7-10m in height.
 They would provide shelter to bring on core species, such as oak, elm and sycamore. All disturbed hedgerows outside the substation platform area (and access road once finalised) will be reinstated following construction.

- Indicative Permanent Access Road
- Retained Hedgerow with Trees
- Proposed Hedgerow with Trees
- Hibernacula
- Pole-mounted barn owl box
- Refugia

10 No bat boxes and 10 No bird boxes to be installed on retained trees along the bridleway

The size and location of the indicative SuDS pond will depend on the final design of the Substation. The indicative SuDS shown here is therefore for illustrative purposes only.

Proposed woodlands in these areas would help screen visibility of the proposed substation from receptors to the north including the A55 and from the nearby Bridlepath.

Wildlife Culvert installed to enable safe passage of animals (in particular amphibians and mammals) beneath the substation construction access, maintaining eastwest access to habitat.

Proposed screening woodland in this area provides additional woodland screening to the existing trees and woodlands found along the easternmost edges of the Bodelwyddan Parkland, supporting the existing levels of screening from within the registered landscape.

Glascoed Nature Reserve

Proposed screening woodland in this area to help screen visibility of the proposed substation from Glascoed Road to the south and from the Business Park to the east.

Proposed screening woodland in this area specifically for the properties on Glascoed Road to the southwest of the site. The woodland strip provides an additional level of screening and limits visibility of the breaks in the woodland structure closer to the proposed substation that are required to accommodate cable route and access road.

Proposed screening woodland in this area to increase the existing screening potential of the roadside hedgerow to help screen visibility of the proposed substation from Glascoed Road and from the Crematorium.

Proposed screening woodland in this area following existing field boundaries where possible to help screen visibility of the proposed substation from Glascoed Road. This section of screening woodland will accommodate site access road (indicative location shown). It may also contain the cable corridor which will create a break in the woodland (the indicative break in the woodland is considered to represent the worst case from an LVIA perspective, hedgerow will be planted over cable corridor). Woodland in this area helps to maintain the east-west woodland/hedgerow links (with the culvert) for use by all wildlife.

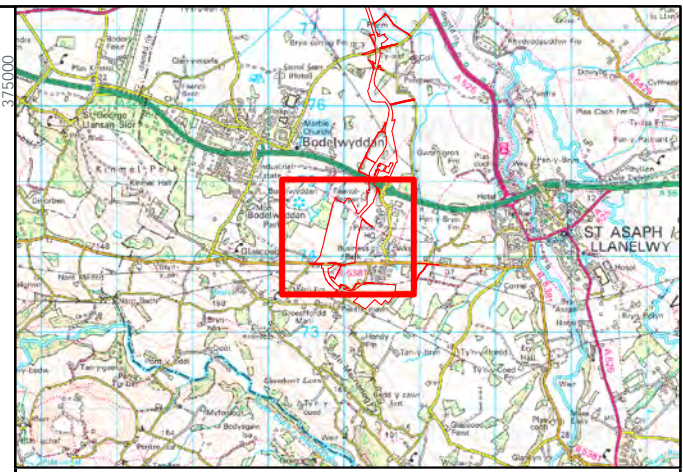

- LEGEND**
- Order Limits
 - Proposed Substation Footprint
 - Proposed Onshore Export Cable Corridor
 - Proposed Substation Cable Corridor Zone
 - Proposed Substation Construction Area
 - Proposed Substation Indicative Temporary Construction Compound Area
 - Proposed Woodland
 - Existing / Retained Ponds
 - Pond Habitat Creation
 - Grassland enhancement to structurally diverse, species rich neutral grassland
 - Proposed Lowland Meadow Habitat
 - Indicative SuDS Pond Location

Data Source: Contains OS data © Crown copyright and database right (2021), © Crown copyright, All rights reserved. (2021). Ordnance Survey Licence 0100031673. Contains public sector information licensed under the terms of the Open Government Licence v.3.0.

PROJECT TITLE:
AWEL Y MÔR OFFSHORE WINDFARM

FIGURE TITLE:
Outline Landscape Mitigation Principles

VER	DATE	REMARKS	Drawn	Checked
1	12/04/2022	For Issue	JM	SG

FIGURE NUMBER:
Figure 2.16

SCALE: 1:6,000 PLOT SIZE: A3 DATUM: OSGB 1936 PROJECTION: BNG



Source: Esri, Maxar, GeoEye, Earthstar Geographics, CNES/Airbus DS, USDA, USGS, AeroGRID, IGN, and the GIS User Community



RWE Renewables UK
Swindon Limited

Windmill Hill Business Park
Whitehill Way
Swindon
Wiltshire SN5 6PB
T +44 (0)8456 720 090
www.rwe.com

Registered office:
RWE Renewables UK
Swindon Limited
Windmill Hill Business Park
Whitehill Way
Swindon