

PLANNING ACT 2008

INFRASTRUCTURE PLANNING (EXAMINATION PROCEDURE) RULES 2010

**WRITTEN SUBMISSIONS OF NFU AND LIG REGARDING THE NORFOLK BOREAS OFFSHORE
WINDFARM PROJECT CONSENT ORDER 201 [...]**

PLANNING INSPECTORATE REFERENCE NO EN010087

**SUBMISSIONS OF NATIONAL FARMERS UNION AND THE LAND INTEREST GROUP ON THE –
ONSHORE EFFECTS INCLUDING THE DRAFT DEVELOPMENT CONSENT ORDER ON 21
JANUARY 2020**

DATE 30TH JANUARY 2020

1.0 Introduction

- 1.1 Submissions on behalf of the National Farmers Union (“NFU”) and the Land Interest Group (LIG) in respect of the application for a Development Consent Order (DCO) by Norfolk Boreas Limited for the Norfolk Boreas Offshore Wind Farm. The NFU is making a case on behalf of its members and LIG its clients, who are affected by the DCO.

2.0 Construction Effects: Cable Duct Installation

- 2.1 **Cable Duct Installation:** Further to the hearing where it was mentioned that the ‘cable duct installation’ topic would be covered under further written questions. The NFU and LIG would like to highlight that this is an area of concern and in a SOCG the NFU raised the question over the length of the time required for cable pulling. Vattenfall are stating it could take up to 4 years being 2 years per project for land to be out of production. A cable installation time of 2 years is more preferable to landowners. Vattenfall have explained that cable pulling must be conducted in line with onshore project substation construction, offshore cable installation and offshore substation installation to allow energisation of the transmission circuit within a timely manner. The 4 years of onshore cable pulling activity is required to align with the worst case phases of potential transmission circuit commissioning. The NFU and LIG would like a further explanation on this as this has never been raised before in regard to cable pulling and timings.

Vattenfall has stated that the jointing pits will not be left open for the 4 year cable pulling phase and that a jointing pit will be set up for one per circuit and the land will be reinstated within the 10 week period, per annum. It is stated that the cable pulling and jointing process would take approximately five weeks per 800m length of cable, per circuit. The NFU and LIG would like confirmation that the land between each jointing pit will be reinstated straight away after the ducts are laid.

3.0 Landscape and Visual Effects

- 3.1 **Substations at Necton:** At the hearing an issue was raised over the external appearance of the building and we understand that Vattenfall will consult on this further. We believe that this is essential and we do know that other similar buildings have had a phased shade of either blue or green to blend into the landscape. It is understood that the electrical equipment will be silver.

At the hearing it was discussed whether bunding should be used around the site to help reduce visual impact. The NFU knows from experience that bunding is not always the best solution. NFU and LIG have asked Vattenfall to explain whether the building would be constructed into the slope so that the height at the lower level of the slope remains the highest point. This information was requested in the NFU SoCG on 29.11.2019 and as yet no response has been forthcoming from Vattenfall.

NFU and LIG require further information on what landscaping design and principles will be put in place. In particular the owner losing land to this site would like to have an input in to the design and into the hedgerow and tree species to be planted.

4.0 Site Visit – 23rd January

- 4.1 **Substation Site at Necton:** The site visit to the proposed Necton substation site took place on a foggy day and therefore visibility was considerably reduced. The NFU and LIG are also aware that due to access constraints on part of the site, not all of the proposed substation could be pegged out. LIG has been made aware that the area that had been pegged out on the ground did not resemble the plans and was not pegged out to demonstrate the level of detail that we

understand was requested by PINS including red line boundary, environmental mitigation area and buildings. Please see attached the plan showing the proposed Necton substation site and the outline with an M in the middle demonstrating the area that had been pegged on the ground. It was not clear what the pegs were actually highlighting. Mr Allhusen is happy to accommodate a further site visit on his land and for the parts of the substation and landscaping to be pegged out and for this hopefully to take place on a clear day.

The NFU and LIG would be grateful for more detailed plans showing the layout of the site. Plans have now been requested on numerous occasions. Further detail is required on the position of the buildings and external electrical equipment within the site compound.

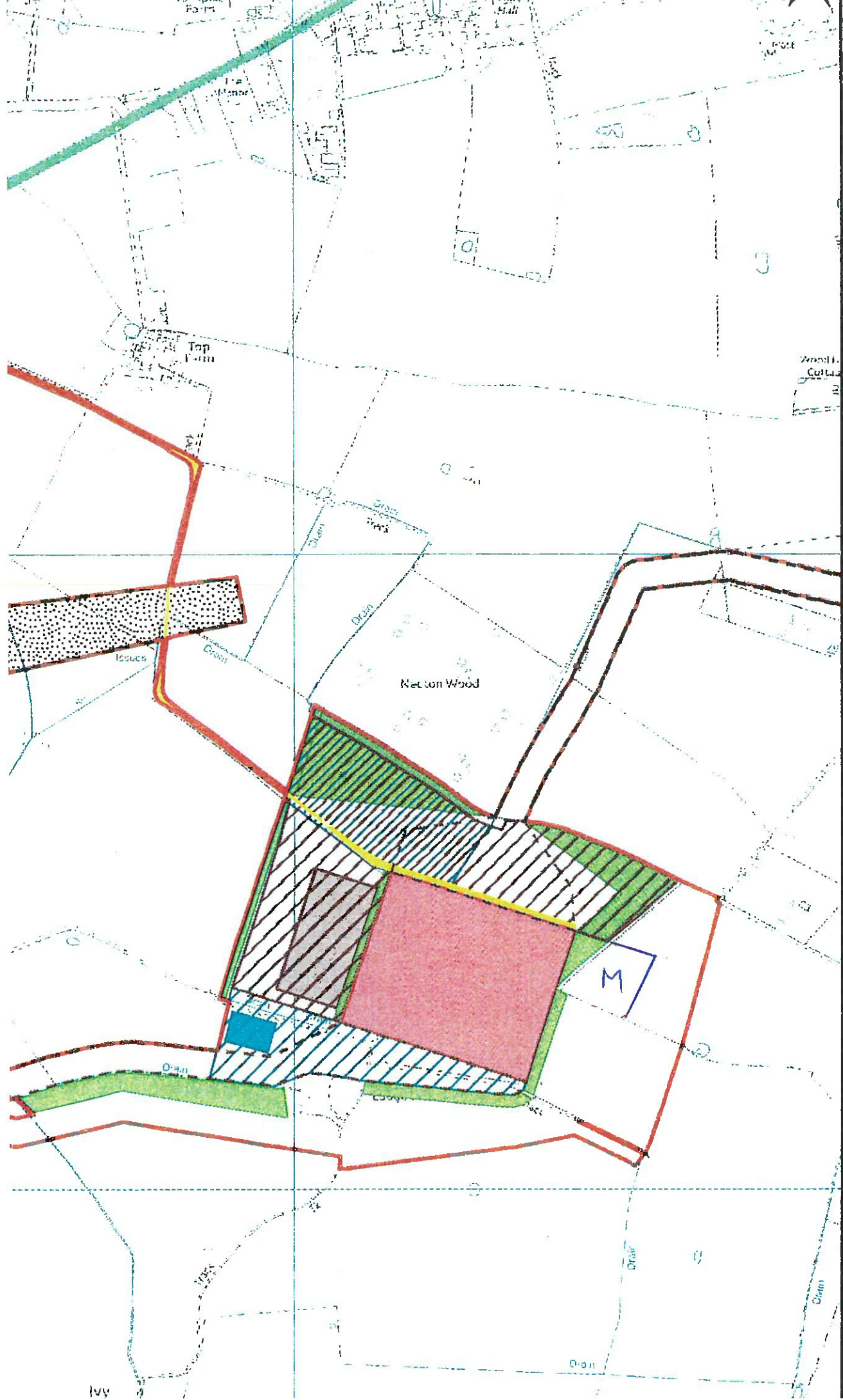

Legend:

- No bor
- Norfolk & Norwich Project I (Scenario)**
- On
- Ca
- su
- On
- rol
- On
- Mo
- Ind
- are
- Hig
- wo
- Co
- Op
- Per
- On
- su
- cor
- zor

Project:

Title:

Figure:

Revision:

02

01

311500

311000

310500

310000