

notes :

1. If this drawing has been received electronically it is the recipients responsibility to print the document to the correct scale.
2. All dimensions are in millimetres unless stated otherwise. It is recommended that information is not scaled off this drawing.
3. This drawing should be read in conjunction with all other relevant drawings and specifications.
4. Internal dimensions to be confirmed at a later stage.

Key:

- A. Horizontally laid Sinusoidal profile insulated built-up cladding with Colorcoat HPS200® Ultra coating - Colour 'Terracotta' (matt finish) / RAL 040 40 40
- B. Horizontally laid microrib profile insulated cladding panel with Colorcoat HPS200® Ultra coating - Colour 'Albatross' / RAL 240 80 05
- C. Horizontally laid microrib profile insulated cladding panel with Colorcoat HPS200® Ultra coating, 1000mm deep bands - Colours random mixture 'Terracotta' (matt finish) RAL 040 40 40/ Merlin Grey RAL 180 40 05/ Anthracite (matt finish) RAL 7016/ Hamlet RAL 9002
- D. Vertically laid Trapezoidal profile insulated cladding panel with Colorcoat HPS200® Ultra coating - Colour 'Anthracite' (matt finish) / RAL 7016
- E. Stack - Colour 'Light Grey' / RAL 7035
- F. Horizontally laid microrib profile cladding sheet with Colorcoat HPS200® Ultra coating, 1000mm deep bands - Colours random mixture 'Terracotta' (matt finish) RAL 040 40 40/ Merlin Grey RAL 180 40 05/ Anthracite (matt finish) RAL 7016/ Hamlet RAL 9002
- G. Horizontally laid microrib profile insulated cladding panel with Colorcoat HPS200® Ultra coating - Colour 'Terracotta' (matt finish) / RAL 180 40 05
- H. Aluminium Louvres to be PPC colour Merlin Grey RAL 180 40 05 / Anthracite (matt finish) RAL 7016

All Doors and Louvres- colour and dimensions to be confirmed.
 Polyester powder coated aluminium window frames - Colour 'Anthracite' (matt finish) / RAL 7016
 Metal external handrails and plant support - Galvanised finish.
 Paladin fencing and gates - Colour 'Anthracite' (matt finish) / RAL 7016

Drawing for **PLANNING** purposes only

Content of drawing based on UMC drawing number 502520020002_UMG0390 and CNIM drawing AAK-04-0202_64G0008. Reproduced with permission

K	Site Plan updated.	BC	TFH	04.09.18
J	Elevation updated.	PBR	TFH	20.06.18
H	Admin HVAC area updated. Escape stairs updated to be un-enclosed stair. Key Plan updated.	JT	CMG0	28.02.17
G	Client logos updated. Steam export rack updated as per CNIM drawing. Escape stair added. Key updated.	JT	CMG0	13.02.17
F	Dimensions added	MT	CD	20.01.17
E	Elevation and Site Plan updated.	JH	CMG0	10.01.17
D	Elevations Updated to suit latest UI design. Keyplan updated to show revised site plan. Cladding design clarified.	AJL	RS	05.07.13
C	Elevations updated.	JAT	SG	09.10.12
B	E.ON logo added.	KRy	PRP	15.02.10
A	UMA building extents confirmed. Keyplan updated. Stack colour confirmed	AJL	PRP	18.01.10

rev	amendments	by	ckd	date
-----	------------	----	-----	------



Sherwood House
 Sherwood Avenue
 Newark, Nottinghamshire
 NG24 1QQ

T +44 (0) 1636 605 700
 F +44 (0) 1636 610 696
 W www.rpsgroup.com
 E rpsnewark@rpsgroup.com



Client
 Project **Kemsley Sustainable Energy Plant**

Title **Main Building Proposed North East Elevation**

Drawing Status **Preliminary** Date Created **23.11.09** Drawing Scale **1:200**
 Project Leader **AWY** Drawn By **PRP** Initial Review **RS**

Drawing Number **16315 / A1 / P / 0126 K** Rev

FIGURE 4.9D

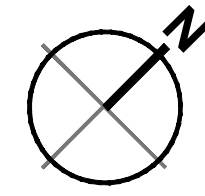

← NE Elevation

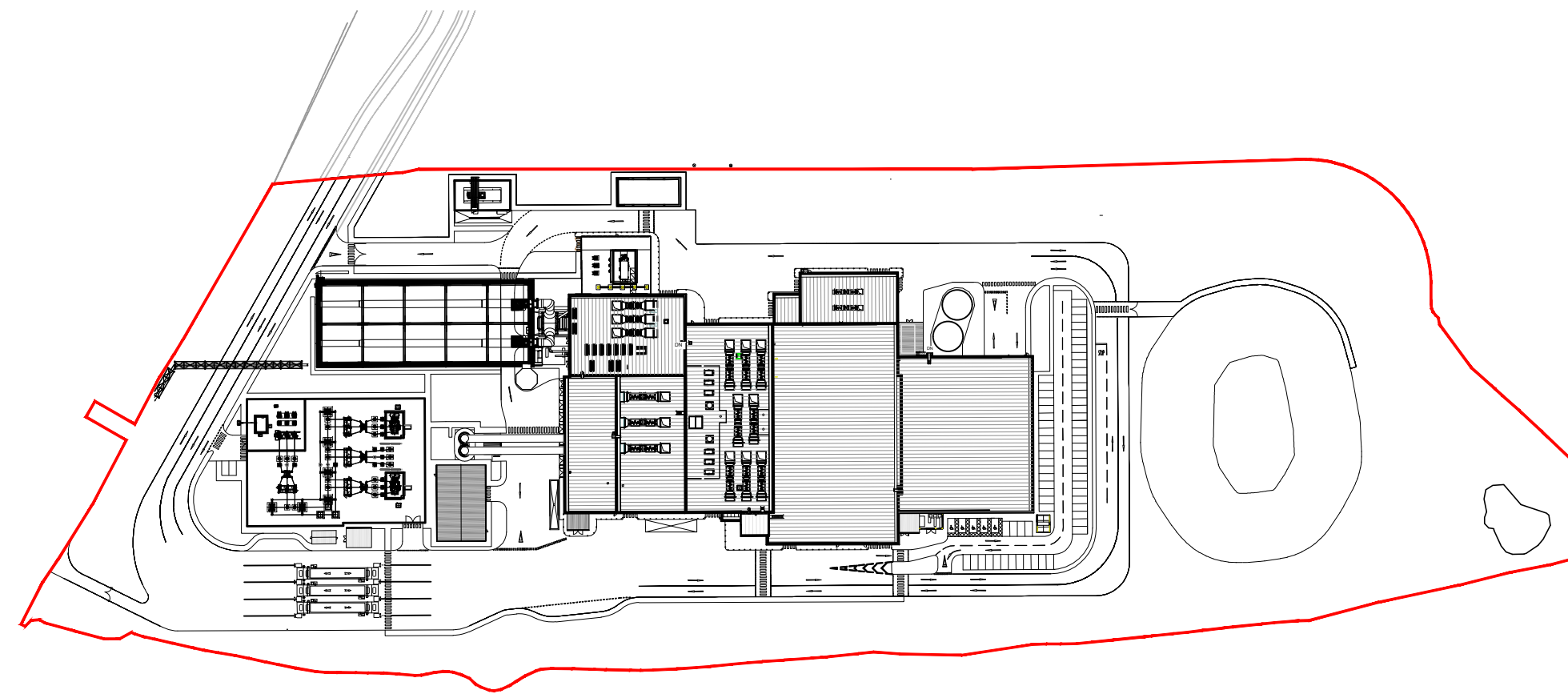

Key Plan
 Scale 1:2000

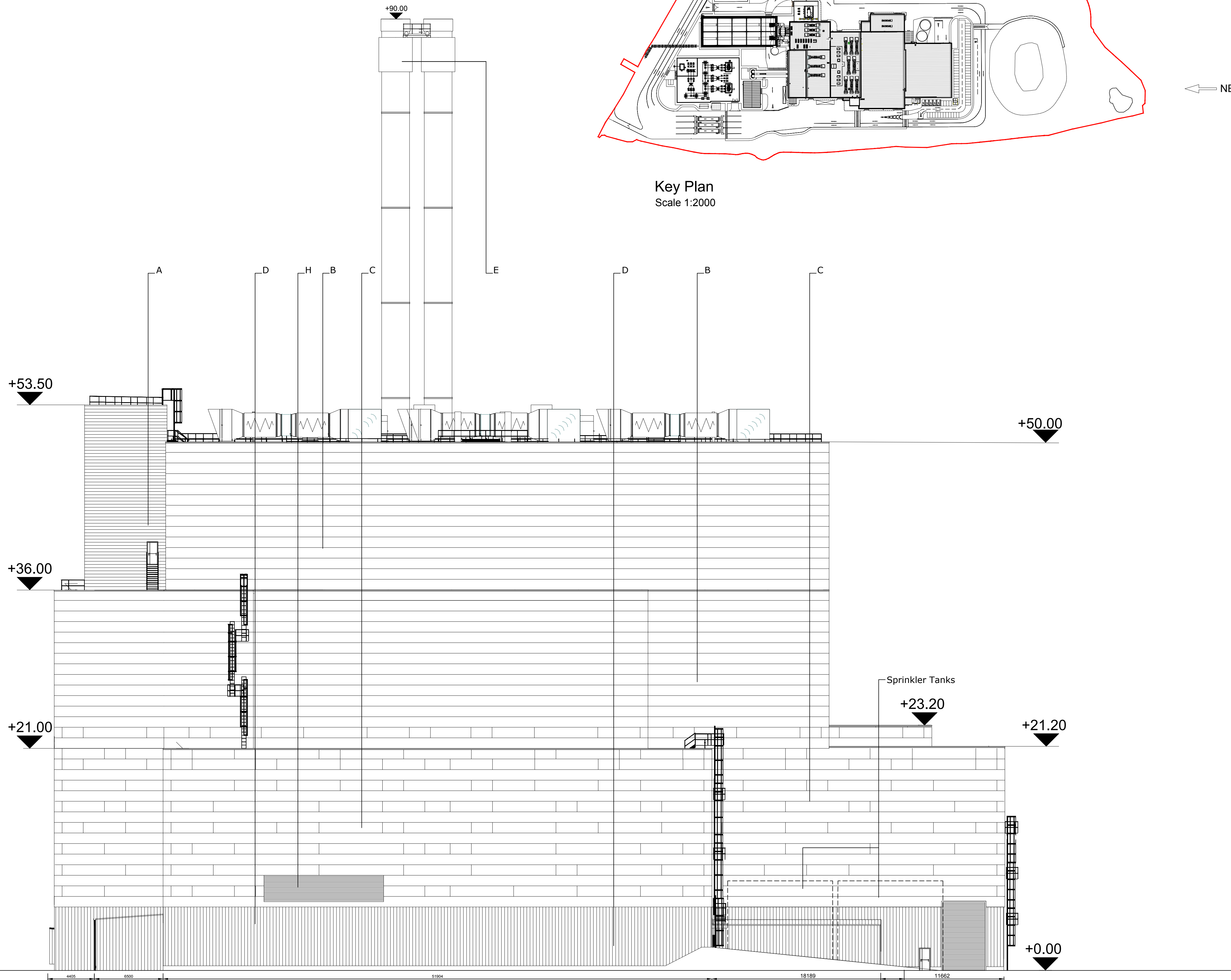

North East Elevation
 Scale 1:200

