

From: Simon fulford [REDACTED]
Sent: 15 October 2020 11:26
To: East Anglia ONE North <EastAngliaOneNorth@planninginspectorate.gov.uk>
Cc: Fulford Ning [REDACTED]
Subject: Assumed Ownership Question Mr + Mrs S Fulford

To whom it may concern on the Planning Inspectorate team, It has been brought to our attention that we have not received a letter of assumed ownership with regard to boundary marker 109 of the proposed site (area shown in pink on the west side of the boundary). The owner of the other part of the field has received a letter of assumed ownership for the continuation of the exact same strip of land adjacent to boundary marker 114.

My wife and I have not been consulted nor have we consented to the use of any of our land and, for the record we would object to a CPO.
Currently we are both separately registered as an 'interested party', not as an 'affected' person - does this matter?

We attach the relevant plan as reference.

We have applied for a site visit at Friston House but have yet to receive acknowledgement or indication of whether this may happen, is that correct?

Simon Fulford (EA1 20023661 & EA2 20023663) Nicola (Ning) Fulford (EA1 20023553 & EA2 20023554) [REDACTED]

[REDACTED]

[REDACTED]

[Coronavirus advice image with text saying Hands, Face, Space]

Please note that the contents of this email and any attachments are privileged and/or confidential and intended solely for the use of the intended recipient. If you are not the intended recipient of this email and its attachments, you must take no action based upon them, nor must you copy or show them to anyone. Please contact the sender if you believe you have received this email in error and then delete this email from your system.

Recipients should note that e-mail traffic on Planning Inspectorate systems is subject to monitoring, recording and auditing to secure the effective operation of the system and for other lawful purposes. The Planning Inspectorate has taken steps to keep this e-mail and any attachments free from viruses. It accepts no liability for any loss or damage caused as a result of any virus being passed on. It is the responsibility of the recipient to perform all necessary checks.

The statements expressed in this e-mail are personal and do not necessarily reflect the opinions or policies of the Inspectorate.

DPC:76616c646f72

[Environmental advice image with text saying please consider the environment before printing this email]

- Key:**
- Older Limits
 - Land Subject to Temporary Occupation and Use and Freshhold Acquisition
94, 99, 99, 105, 106, 107, 108, 109, 110, 111, 113, 114, 127, 128, 129, 130, 131, 133, 135
 - Land Subject to Temporary Occupation and Use and Acquisition of Permanent Rights
92, 96, 97, 100, 101, 102, 103, 104, 115
 - Land Subject to Temporary Occupation and Use
90, 91, 116, 117, 117A, 118, 119, 120, 121, 122, 122A, 123, 124, 125, 126, 127

APPP Ref: 5(2)(i)
PINS Document Reference: 2.2

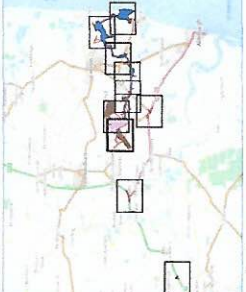

Coords: 640 639 200 991

Project Name:
East Anglia ONE North Offshore Wind Farm

Drawing Name:
Land Plans

Drawing No: 100476_PLN_DCO_1820.10

Rev	Date	Description
1	07/10/2019	First Issue

Drawn: PR
Approved: HH
Sheet No: 10 of 13
Sheet Size: A1



The information contained in this document is confidential and prepared for the use of the client only. It is not to be used for any other purpose without the written permission of, and in the manner prescribed by, Scottish Power Renewables. It is an infringement of copyright to reproduce or to disseminate this information in any form or by any means, electronic or mechanical, including photocopying, recording, or by any information storage and retrieval system, without the prior written permission of Scottish Power Renewables. This information is provided for your information only and does not constitute an offer of any financial product or service. It is not intended to be relied upon in making any investment decision. The information is provided for your information only and does not constitute an offer of any financial product or service. It is not intended to be relied upon in making any investment decision. THE CHANGE SURVEY MAP WITH THE SANCTION OF THE

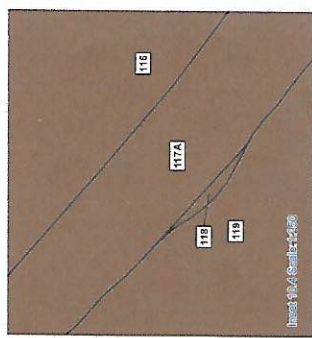
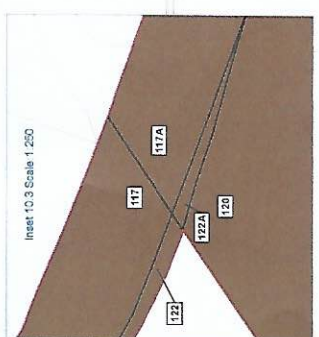
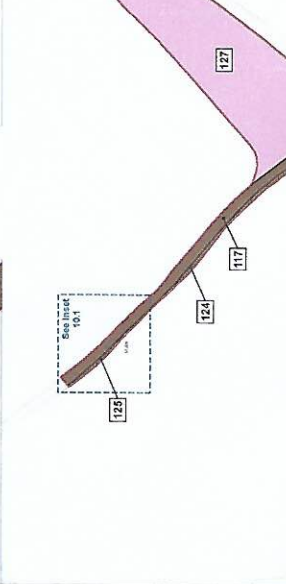
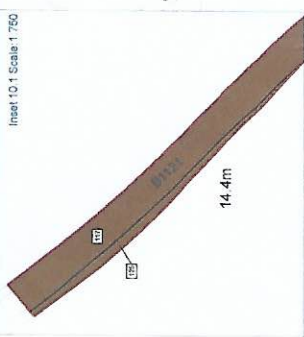
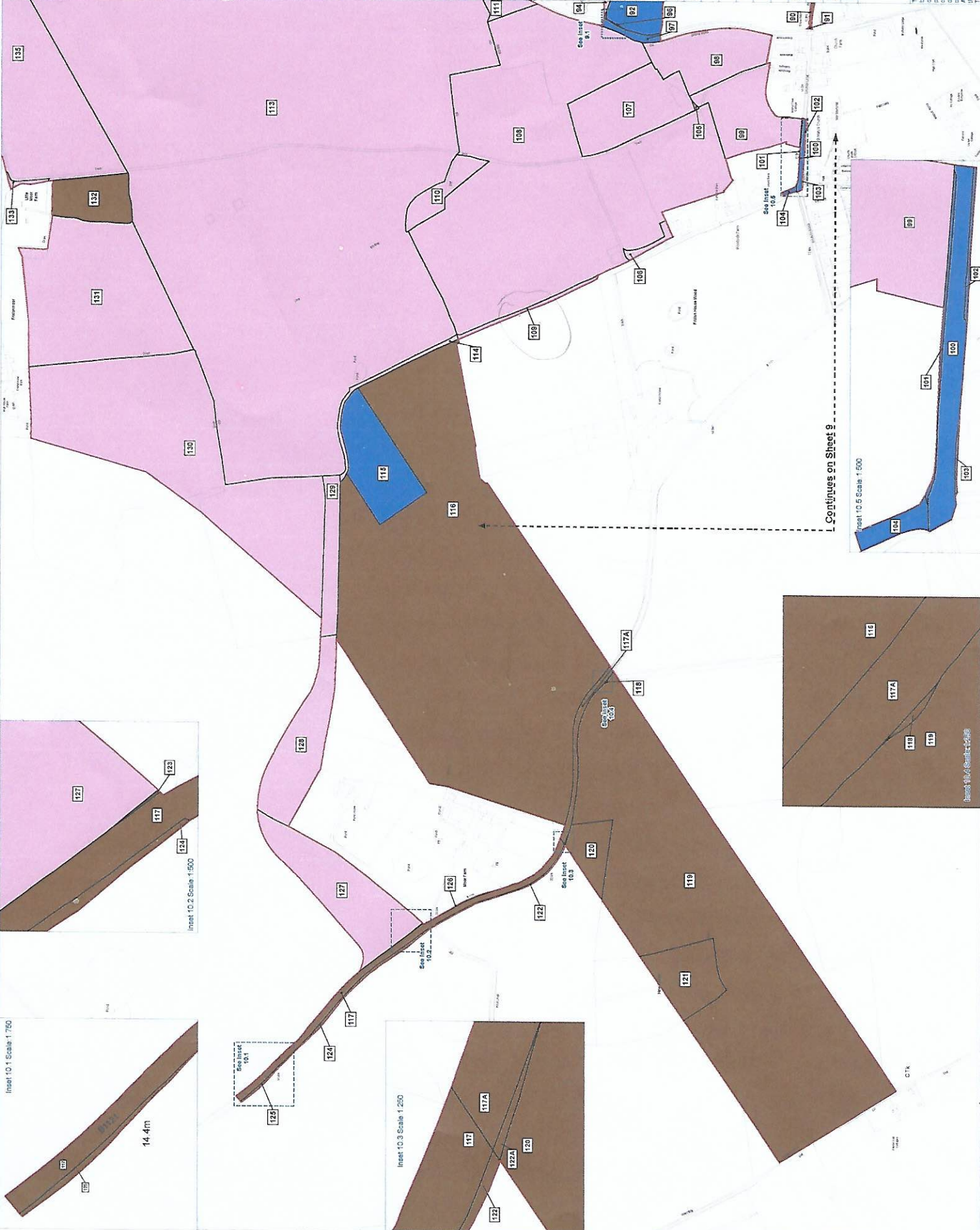

Continues on Sheet 9