



The Abergelli Power Gas Fired Generating Station Order

2.6 Indicative Site Layout Plan

Planning Act 2008
The Infrastructure Planning
(Applications: Prescribed Forms and Procedure) Regulations 2009

PINS Reference Number: EN010069
Document Reference: 2.6
Regulation Number: 5(2)(o)
Author: WSP

| Revision | Date | Description |
|----------|----------|--------------------|
| 0 | May 2018 | Submission Version |



CONTENTS

| | |
|----------|---------------------------------------------------|
| Figure 1 | INDICATIVE LAYOUT Project Site Reg5(2)(o) |
| Figure 2 | INDICATIVE LAYOUT Generating Equipment Reg5(2)(o) |
| Figure 3 | INDICATIVE LAYOUT Access Road Reg5(2)(o) |

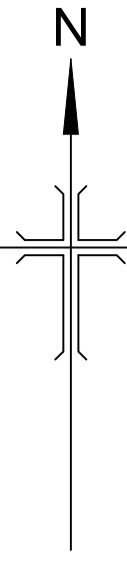

LEGEND

- ORDER LAND
- ORDER LIMITS
- ACCESS ROAD

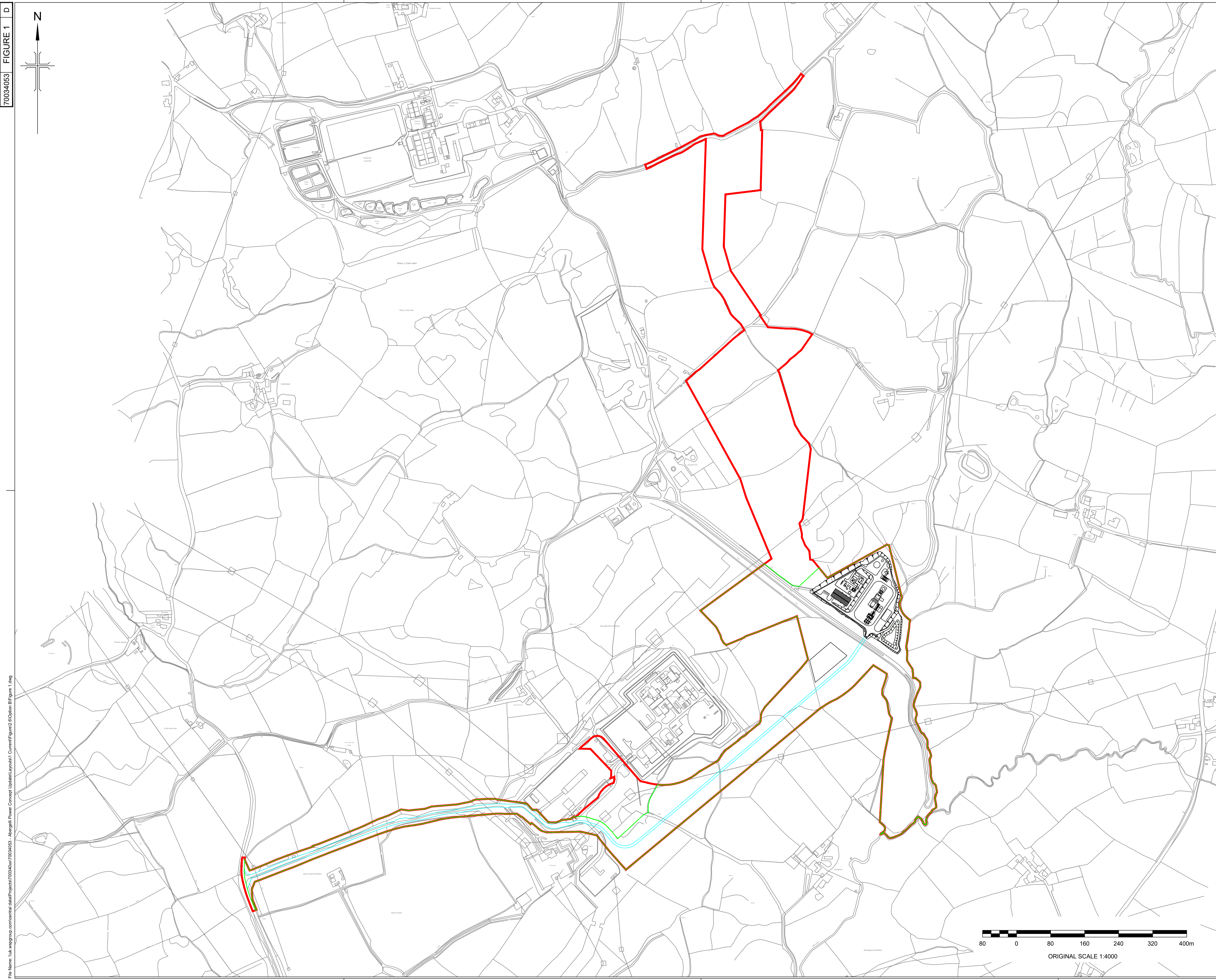

| Rev | Date | Description | By | Chk | App |
|-----|------------|-------------------------------------------------------------|-----|-----|-----|
| D | 10/05/2018 | UPDATED IN LINE WITH CLIENT COMMENTS | SPS | SJS | IMG |
| C | 03/04/2018 | LEGEND UPDATED | SPS | SJS | IMG |
| B | 22/03/2018 | ATTENUATION POND DETAILS UPDATED. WATER EASEMENT UPDATED | SPS | SJS | IMG |
| A | 16/02/2018 | FIRST ISSUE | JPW | SJS | IMG |

INDICATIVE

Westbrook Mills
Godalming
Surrey GU7 2AZ

Tel: 44-(0)1483-528400
Fax: 44-(0)1483-528989
wsp.com

Abergelli power
A Brix Group company

**ABERGELLI
POWER
PROJECT**

**INDICATIVE LAYOUT
Project Site Reg5(2)(o)
DOCUMENT REFERENCE 2.6**

| | |
|--------------------------|---------------|
| Drawn: JPW | Checked: SJS |
| Designed: IMG | Approved: IMG |
| Date: 16/02/2018 | Scale: 1:4000 |
| Project Number: 70034053 | Sheet: 1 OF 1 |
| Drawing Number: FIGURE 1 | Revision: |

70034053 FIGURE 1 D

© Copyright WSP UK Limited

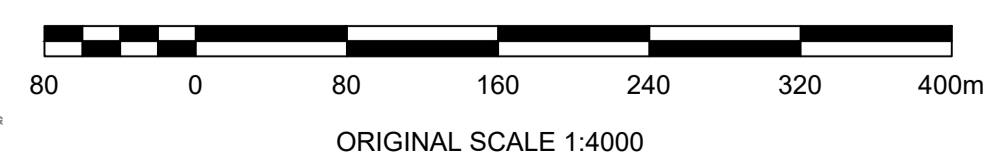

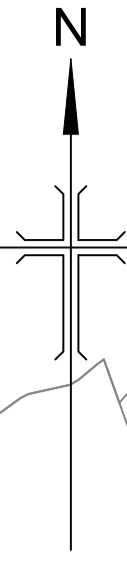

LEGEND

| | |
|--------------------------------------|--------------|
| — | ORDER LAND |
| — | ORDER LIMITS |
| — | ACCESS ROAD |

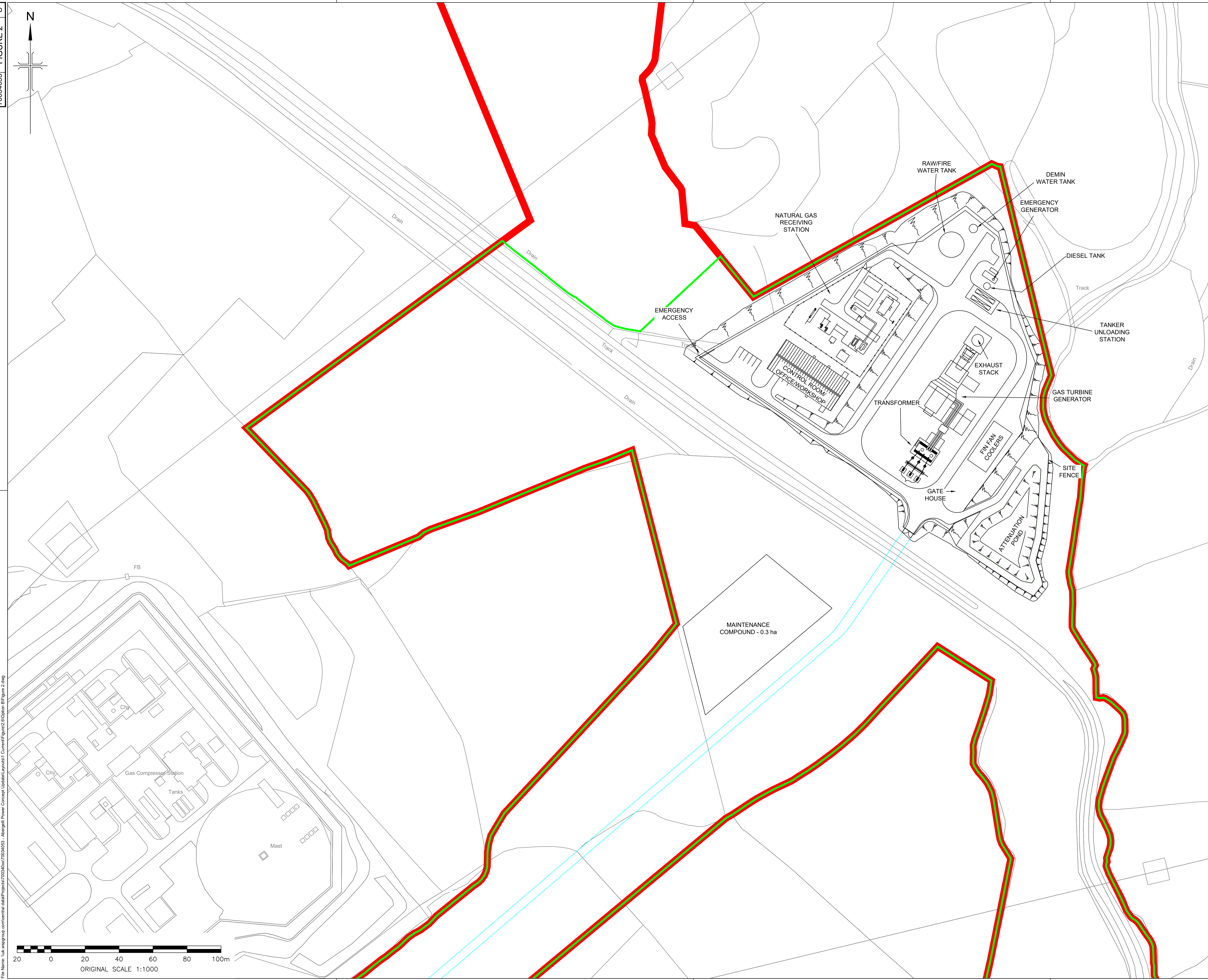

NOTES:
 * INFORMATION TAKEN FROM WEST GLAMORGAN WATER BOARD RECORD DRAWINGS No. 112/4/1/12A DATED 1969

| Rev | Date | Description | By | Chk | App |
|-----|------------|--------------------------------------|-----|-----|-----|
| C | 10/05/2018 | UPDATED IN LINE WITH CLIENT COMMENTS | SPS | SJS | IMG |
| B | 03/04/2018 | LEGEND UPDATED | SPS | SJS | IMG |
| A | 16/02/2018 | FIRST ISSUE | JPW | SJS | IMG |

| | |
|------------------------------------------------------------------------------------------------------------------------------------------------|--------------------------|
| INDICATIVE | |
| | |
| Westbrook Mills Godalming Surrey GU7 2AZ | |
| Tel: 44-(0)1483-528400 Fax: 44-(0)1483-528989 wsp.com | |
| | |
| ABERGELLI POWER PROJECT | |
| INDICATIVE LAYOUT GENERATING EQUIPMENT Reg5(2)(o) DOCUMENT REFERENCE 2.6 | |
| Drawn: JPW | Checked: SJS |
| Designed: IMG | Approved: IMG |
| Date: 16/02/2018 | Scale: 1:1000 |
| Project Number: 70034053 | Drawing Number: FIGURE 2 |
| Sheet: 1 OF 1 | Revision: C |
| © Copyright WSP UK Limited | |

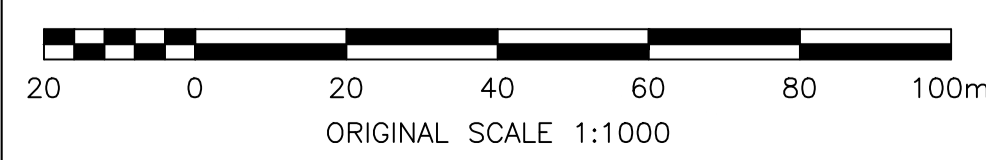

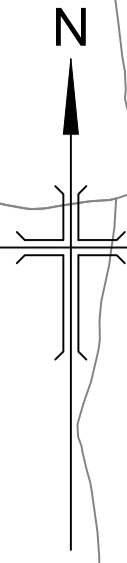

LEGEND

- ORDER LAND
- ORDER LIMITS
- ACCESS ROAD

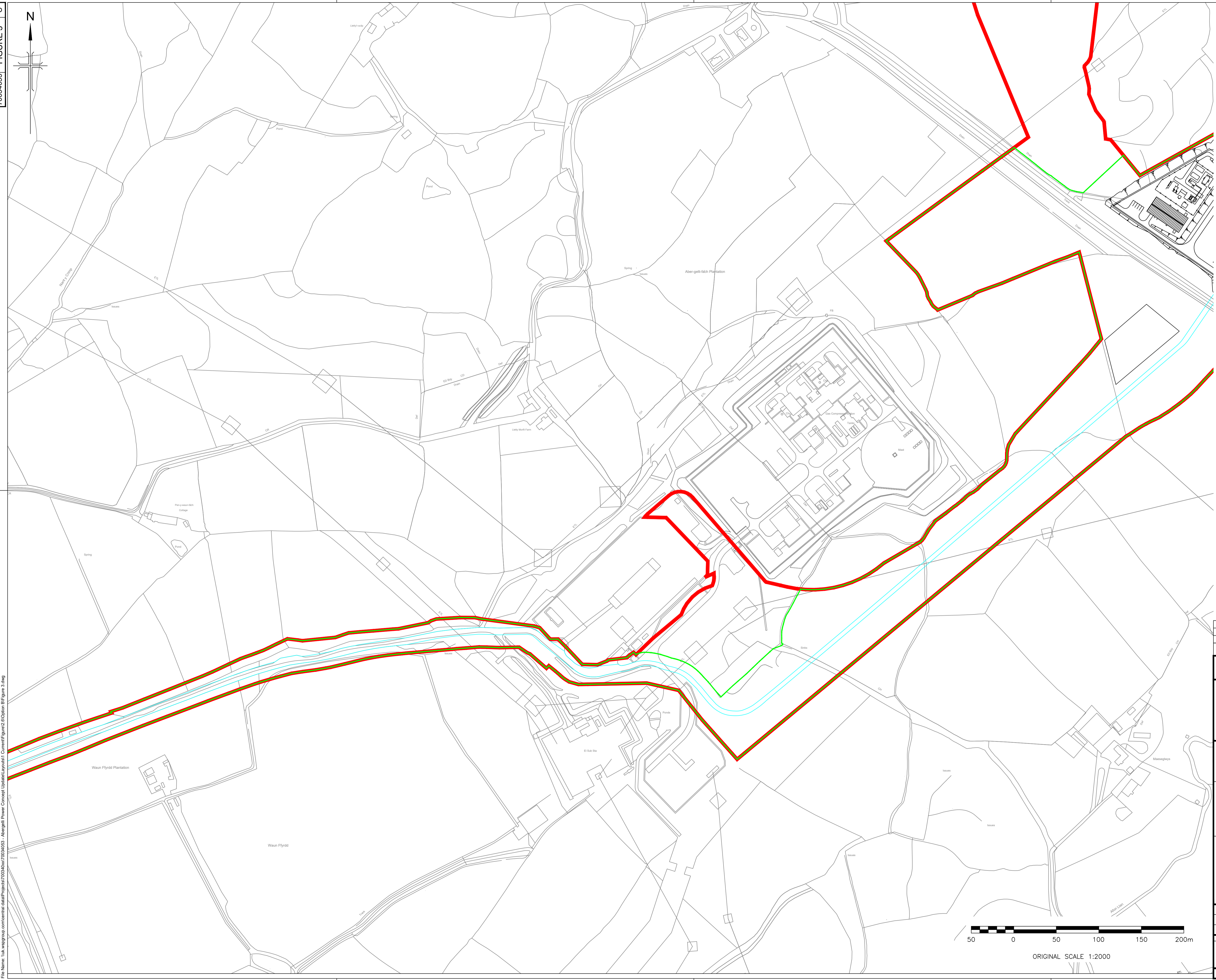

| | | | | | |
|-----|------------|--------------------------------------|-----|-----|-----|
| Rev | Date | Description | By | Chk | App |
| C | 10/05/2018 | UPDATED IN LINE WITH CLIENT COMMENTS | SPS | SJS | IMG |
| B | 03/04/2018 | LEGEND UPDATED | SPS | SJS | IMG |
| A | 16/02/2018 | FIRST ISSUE | JPW | SJS | IMG |

INDICATIVE

Westbrook Mills
Godalming
Surrey GU7 2AZ

Tel: 44-(0)1483-528400
Fax: 44-(0)1483-528989
wsp.com

Client:

Abergelli power
A Beca Group company

Site/Project:

ABERGELLI POWER PROJECT

Title:

INDICATIVE LAYOUT
ACCESS ROAD
Reg5(2)(o)
DOCUMENT REFERENCE 2.6

| | |
|--------------------------|--------------------------|
| Drawn: JPW | Checked: SJS |
| Designed: IMG | Approved: IMG |
| Date: 16/02/2018 | Scale: 1:2000 |
| Project Number: 70034053 | Drawing Number: FIGURE 3 |
| Sheet: 1 OF 1 | Revision: |

70034053 FIGURE 3 C

© Copyright WSP UK Limited

