



The Sizewell C Project

2.5 Main Development Site Construction Parameter Plans - Plans For Approval

February 2021

Planning Act 2008
Infrastructure Planning (Applications: Prescribed Forms and Procedure) Regulations 2009

Revision: 3.0
Applicable Regulation: Regulation 5(2)(o)
PINS Reference Number: EN010012



Main Development Site Construction Parameter Plans – For Approval

Drawing Number	Revision	Drawing Title	Scale	Sheet Size
SZC-SZ0100-XX-100-DRW-100046	03	Main Development Site Construction Parameter Plan - Key Plan	1:5000	A0
SZC-SZ0100-XX-100-DRW-100092	03	Main Development Site Construction Parameter Plan – Sheet 1 of 4	1:2500	A0
SZC-SZ0100-XX-100-DRW-100093	03	Main Development Site Construction Parameter Plan – Sheet 2 of 4	1:2500	A0
SZC-SZ0100-XX-100-DRW-100094	03	Main Development Site Construction Parameter Plan – Sheet 3 of 4	1:2500	A0
SZC-SZ0100-XX-100-DRW-100095	03	Main Development Site Construction Parameter Plan – Sheet 4 of 4	1:2500	A0

Main Development Site Construction Parameter Plans For Approval – Revisions Schedule

Drawing Number	Revision	Drawing Title	Amendments
SZC-SZ0100-XX-100-DRW-100046	03	Main Development Site Construction Parameter Plan - Key Plan	Minor drafting amendments to the key
SZC-SZ0100-XX-100-DRW-100092	03	Main Development Site Construction Parameter Plan – Sheet 1 of 4	Minor drafting amendments to the key
SZC-SZ0100-XX-100-DRW-100093	03	Main Development Site Construction Parameter Plan – Sheet 2 of 4	Minor drafting amendments to the key
SZC-SZ0100-XX-100-DRW-100094	03	Main Development Site Construction Parameter Plan – Sheet 3 of 4	Minor drafting amendments to the key
SZC-SZ0100-XX-100-DRW-100095	03	Main Development Site Construction Parameter Plan – Sheet 4 of 4	Minor drafting amendments to the key

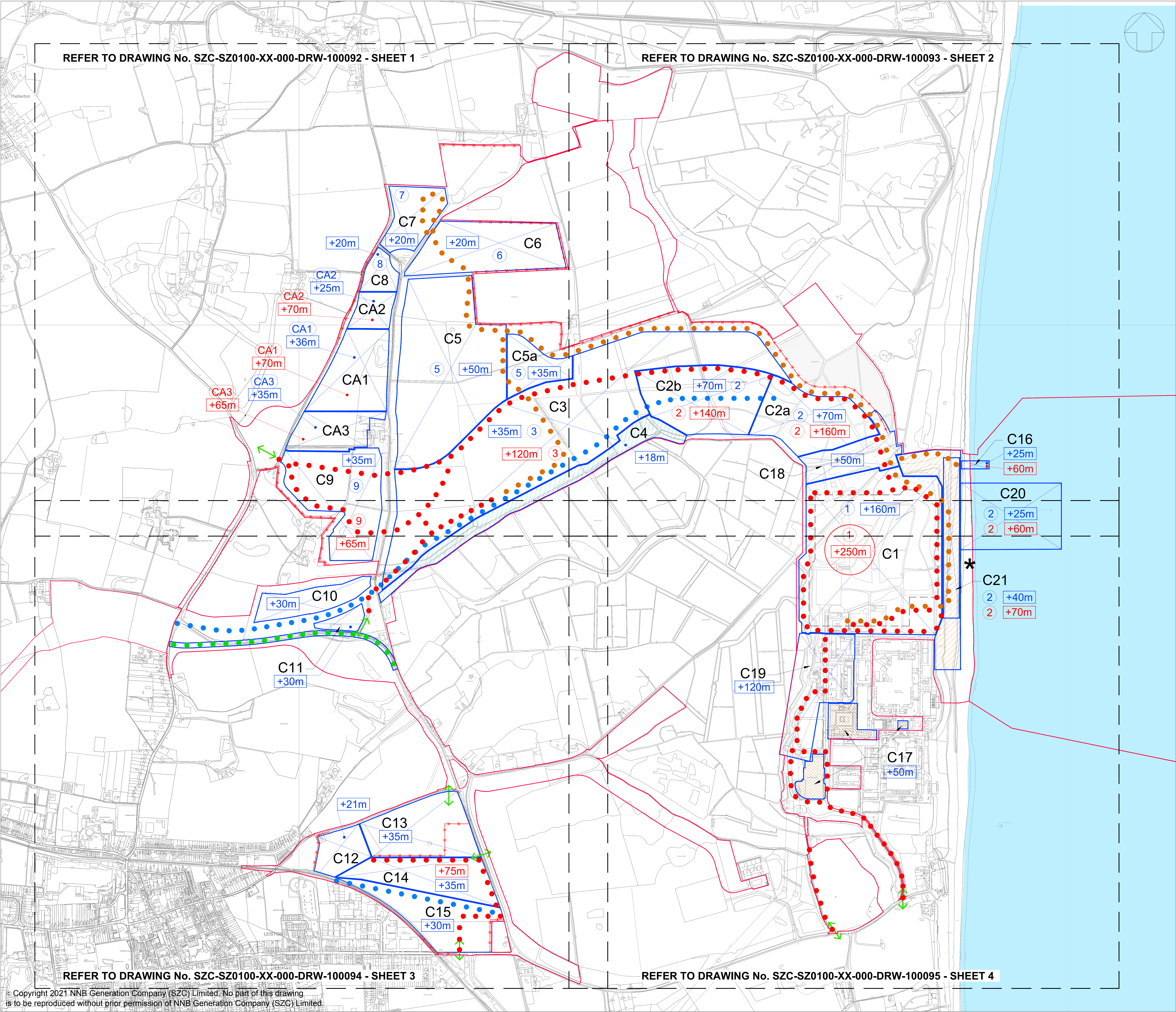

- NOTES:
1. ALL HEIGHTS ARE ABOVE ORDNANCE DATUM (AOD).
 2. PARTS OF ZONES C5, C6 & C7 THAT ARE FIRST USED AS BORROW PITS WILL NOT SUBSEQUENTLY EXCEED A STOCKPILE HEIGHT OF 5m ABOVE EXISTING GROUND LEVEL.
 3. SHORT TERM CONSTRUCTION ACTIVITIES MAY TAKE PLACE OUTSIDE OF PARAMETER ZONES WITHIN THE MAIN DEVELOPMENT SITE FOR THE SPECIFIC PURPOSES OF REALISING THE CONSTRUCTION METHODOLOGY. SUCH ACTIVITY WOULD TYPICALLY COMPRISE MINOR WORKS USING MOBILE PLANT UP TO APPROX. 5m ABOVE GROUND LEVEL.
 4. REFER TO DRAWING NUMBERS SZC-SZ0100-XX-000-DRW-100092, 100093, 100094 & 100095 FOR SHEET Nos. 1, 2, 3 & 4.

- KEY:
- CONSTRUCTION ZONE GENERAL CONDITION: POTENTIAL HEIGHT & WORKING PARAMETERS REQUIRED DURING CONSTRUCTION PHASE.
 - CONSTRUCTION ZONE EXCEPTIONAL CONDITION: POTENTIAL HEIGHT & WORKING PARAMETERS REQUIRED DURING CONSTRUCTION PHASE.
 - APPROX. LOCATION OF SITE ACCESS ROADS
 - APPROX. LOCATION OF SITE HAUL ROADS
 - APPROX. RAIL ROUTE
 - LOVER'S LANE REALIGNMENT
 - APPROX. LOCATION OF ACOUSTIC FENCE/BUND
 - INDICATIVE LOCATION OF SITE ACCESS
 - ZONE NUMBER
 - HARD COASTAL DEFENCE FEATURE
 - APPROX. LOCATION OF SOUTHERN BUND
 - RELOCATED FACILITIES
 - SITE DEVELOPMENT BOUNDARY
 - PROPOSED TEMPORARY MARINE OUTFALL

03	FEB 2021	SB	NP	RESPONSE TO PINS PROCEDURAL DECISION 5 (dated 22 Jan 2021)	SZC Co
02	JAN 2021	SB	NP	PROPOSED CHANGES TO THE DCO APPLICATION - JANUARY 2021	SZC Co
01	FEB 2020	SB	NP	DCO SUBMISSION	SZC Co
REVISION	DATE	DRAWN	CHECKED	REASONS FOR REVISION / COMMENTS	APPROVED

NOT PROTECTIVELY MARKED

COPYRIGHT:
Reproduced from Ordnance Survey map with the permission of Ordnance Survey on behalf of the controller of Her Majesty's Stationery Office © Crown copyright (2021).
All Rights reserved. NNB GenCo Licence: 0100060408



PROJECT:
SIZEWELL C

DOCUMENT:
APPLICATION DRAWING - FOR APPROVAL
REGULATION 5(2)(o)

DRAWING TITLE:
MAIN DEVELOPMENT SITE
CONSTRUCTION PARAMETER PLAN
KEY PLAN

DRAWING NO:
SZC-SZ0100-XX-000-DRW-100046

REVISION:
03

DATE:
FEB 2021

DRAWN:
SB

SCALE:
1:5000@A0

SCALE BAR:
100m 0 100 200 300m
SCALE IN METRES
1:5000

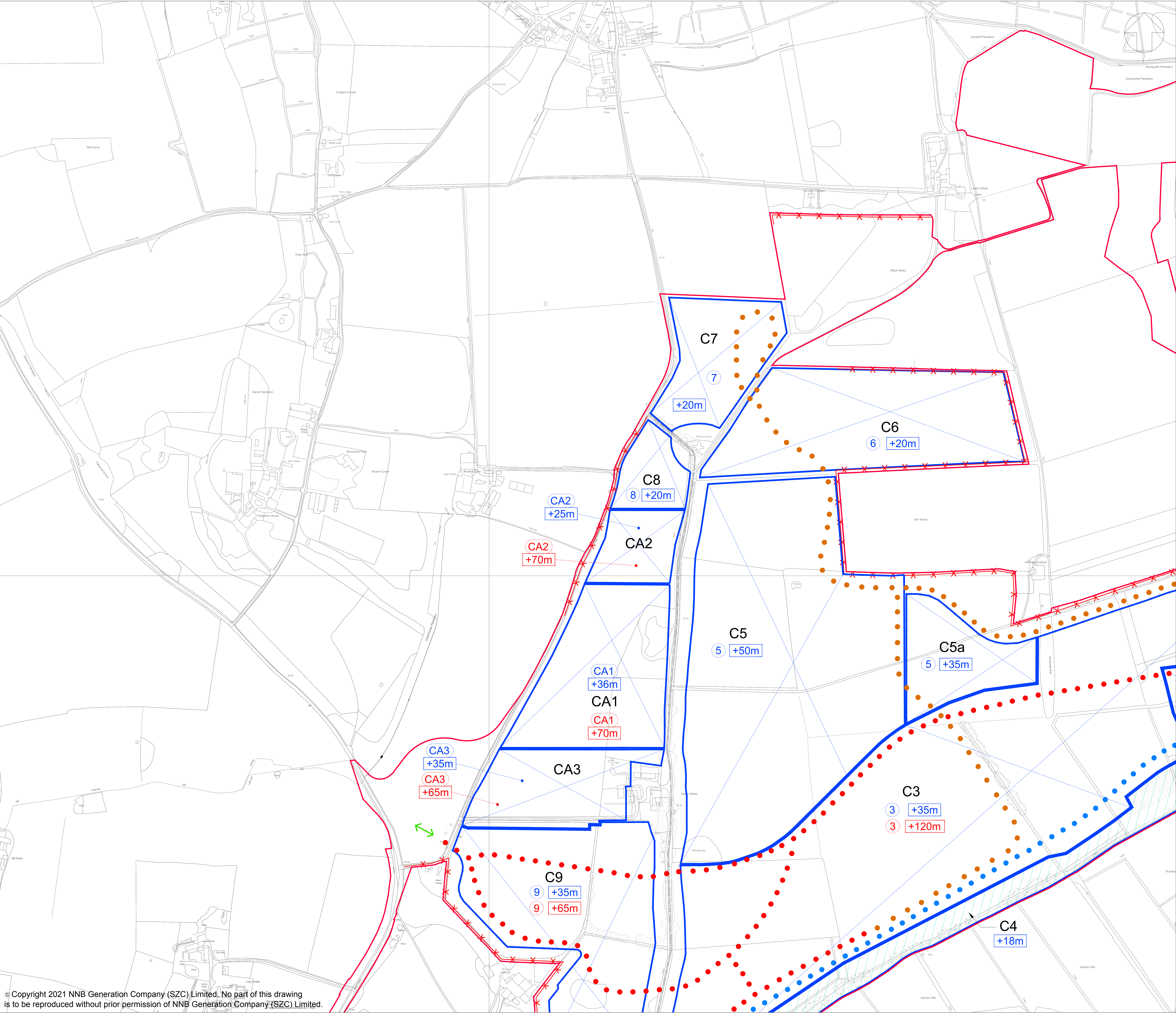

- NOTES:
1. ALL HEIGHTS ARE ABOVE ORDNANCE DATUM (AOD).
 2. PARTS OF ZONES C5, C6 & C7 THAT ARE FIRST USED AS BORROW PITS WILL NOT SUBSEQUENTLY EXCEED A STOCKPILE HEIGHT OF 5m ABOVE EXISTING GROUND LEVEL.
 3. SHORT TERM CONSTRUCTION ACTIVITIES MAY TAKE PLACE OUTSIDE OF PARAMETER ZONES WITHIN THE MAIN DEVELOPMENT SITE FOR THE SPECIFIC PURPOSES OF REALISING THE CONSTRUCTION METHODOLOGY. SUCH ACTIVITY WOULD TYPICALLY COMPRISE MINOR WORKS USING MOBILE PLANT UP TO APPROX. 5m ABOVE GROUND LEVEL.
 4. REFER TO DRAWING NUMBERS SZC-SZ0100-XX-000-DRW-100092, 100093, 100094 & 100095 FOR SHEET Nos. 1, 2, 3 & 4.

- KEY:
- CONSTRUCTION ZONE GENERAL CONDITION: POTENTIAL HEIGHT & WORKING PARAMETERS REQUIRED DURING CONSTRUCTION PHASE.
 - CONSTRUCTION ZONE EXCEPTIONAL CONDITION: POTENTIAL HEIGHT & WORKING PARAMETERS REQUIRED DURING CONSTRUCTION PHASE.
 - APPROX. LOCATION OF SITE ACCESS ROADS
 - APPROX. LOCATION OF SITE HAUL ROADS
 - APPROX. RAIL ROUTE
 - LOVER'S LANE REALIGNMENT
 - APPROX. LOCATION OF ACOUSTIC FENCE/BUND
 - INDICATIVE LOCATION OF SITE ACCESS
 - ZONE NUMBER
 - HARD COASTAL DEFENCE FEATURE
 - APPROX. LOCATION OF SOUTHERN BUND
 - RELOCATED FACILITIES
 - SITE DEVELOPMENT BOUNDARY

03	FEB 2021	SB	NP	RESPONSE TO PINS PROCEDURAL DECISION 5 (Dated 22 Jan 2021)	SZC Co
02	JAN 2021	SB	NP	PROPOSED CHANGES TO THE DCO APPLICATION - JANUARY 2021	SZC Co
01	FEB 2020	SB	NP	DCO SUBMISSION	SZC Co
REVISION	DATE	DRAWN	CHECKED	REASONS FOR REVISION / COMMENTS	APPROVED

NOT PROTECTIVELY MARKED

COPYRIGHT:
Reproduced from Ordnance Survey map with the permission of Ordnance Survey on behalf of the controller of Her Majesty's Stationery Office © Crown copyright (2021).
All Rights reserved. NNB GenCo Licence: 0100060408



PROJECT:
SIZEWELL C

DOCUMENT:
APPLICATION DRAWING - FOR APPROVAL
REGULATION 5(2)(o)

DRAWING TITLE:
MAIN DEVELOPMENT SITE
CONSTRUCTION PARAMETER PLAN
SHEET 1 OF 4

DRAWING NO:
SZC-SZ0100-XX-000-DRW-100092

REVISION:
03

DATE:
FEB 2021

DRAWN:
SB

SCALE:
1:2500@A0

SCALE BAR:
50m 0 50 100 150m
SCALE IN METRES
1:2500

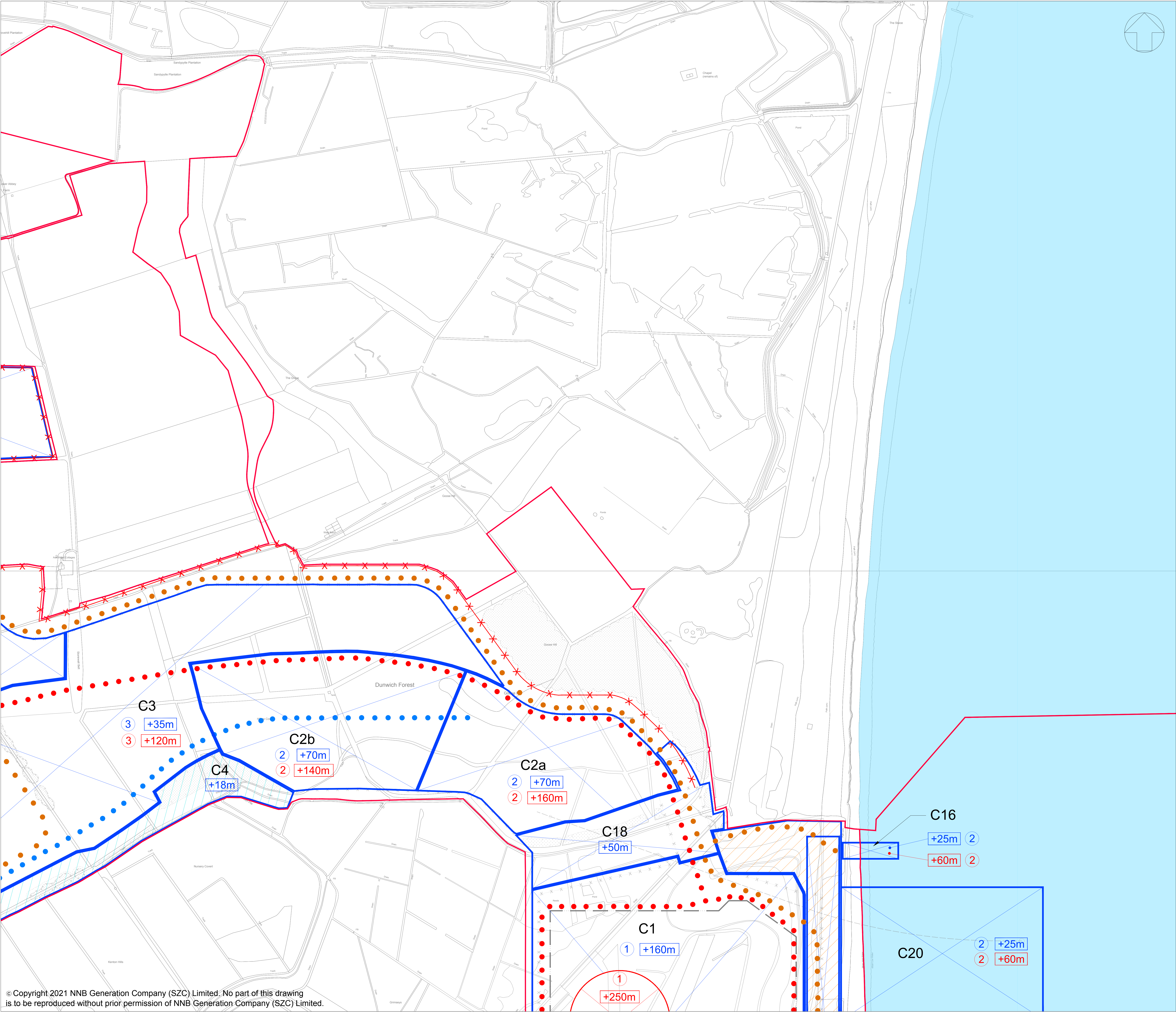

- NOTES:**
1. ALL HEIGHTS ARE ABOVE ORDNANCE DATUM (AOD).
 2. PARTS OF ZONES C5, C6 & C7 THAT ARE FIRST USED AS BORROW PITS WILL NOT SUBSEQUENTLY EXCEED A STOCKPILE HEIGHT OF 5m ABOVE EXISTING GROUND LEVEL.
 3. SHORT TERM CONSTRUCTION ACTIVITIES MAY TAKE PLACE OUTSIDE OF PARAMETER ZONES WITHIN THE MAIN DEVELOPMENT SITE FOR THE SPECIFIC PURPOSES OF REALISING THE CONSTRUCTION METHODOLOGY. SUCH ACTIVITY WOULD TYPICALLY COMPRISE MINOR WORKS USING MOBILE PLANT UP TO APPROX. 5m ABOVE GROUND LEVEL.
 4. REFER TO DRAWING NUMBERS SZC-SZ0100-XX-000-DRW-100092, 100093, 100094 & 100095 FOR SHEET Nos. 1, 2, 3 & 4.

- KEY:**
- CONSTRUCTION ZONE GENERAL CONDITION: POTENTIAL HEIGHT & WORKING PARAMETERS REQUIRED DURING CONSTRUCTION PHASE.
 - CONSTRUCTION ZONE EXCEPTIONAL CONDITION: POTENTIAL HEIGHT & WORKING PARAMETERS REQUIRED DURING CONSTRUCTION PHASE.
 - APPROX. LOCATION OF SITE ACCESS ROADS
 - APPROX. LOCATION OF SITE HAUL ROADS
 - APPROX. RAIL ROUTE
 - LOVER'S LANE REALIGNMENT
 - APPROX. LOCATION OF ACOUSTIC FENCE/BUND
 - INDICATIVE LOCATION OF SITE ACCESS
 - ZONE NUMBER
 - HARD COASTAL DEFENCE FEATURE
 - APPROX. LOCATION OF SOUTHERN BUND
 - RELOCATED FACILITIES
 - SITE DEVELOPMENT BOUNDARY

03	FEB 2021	SB	NP	RESPONSE TO PINS PROCEDURAL DECISION 5 (Dated 22 Jan 2021)	SZC Co
02	JAN 2021	SB	NP	PROPOSED CHANGES TO THE DCO APPLICATION - JANUARY 2021	SZC Co
01	FEB 2020	SB	NP	DCO SUBMISSION	SZC Co
REVISION	DATE	DRAWN	CHECKED	REASONS FOR REVISION / COMMENTS	APPROVED

NOT PROTECTIVELY MARKED

COPYRIGHT:
Reproduced from Ordnance Survey map with the permission of Ordnance Survey on behalf of the controller of Her Majesty's Stationery Office © Crown copyright (2021).
All Rights reserved. NNB GenCo Licence: 0100060408



PROJECT:
SIZEWELL C

DOCUMENT:
APPLICATION DRAWING - FOR APPROVAL
REGULATION 5(2)(o)

DRAWING TITLE:
MAIN DEVELOPMENT SITE
CONSTRUCTION PARAMETER PLAN
SHEET 2 OF 4

DRAWING NO:
SZC-SZ0100-XX-000-DRW-100093

REVISION:
03

DATE:
FEB 2021

DRAWN:
SB

SCALE:
1:2500@A0

SCALE BAR:
50m 0 50 100 150m
SCALE IN METRES
1:2500

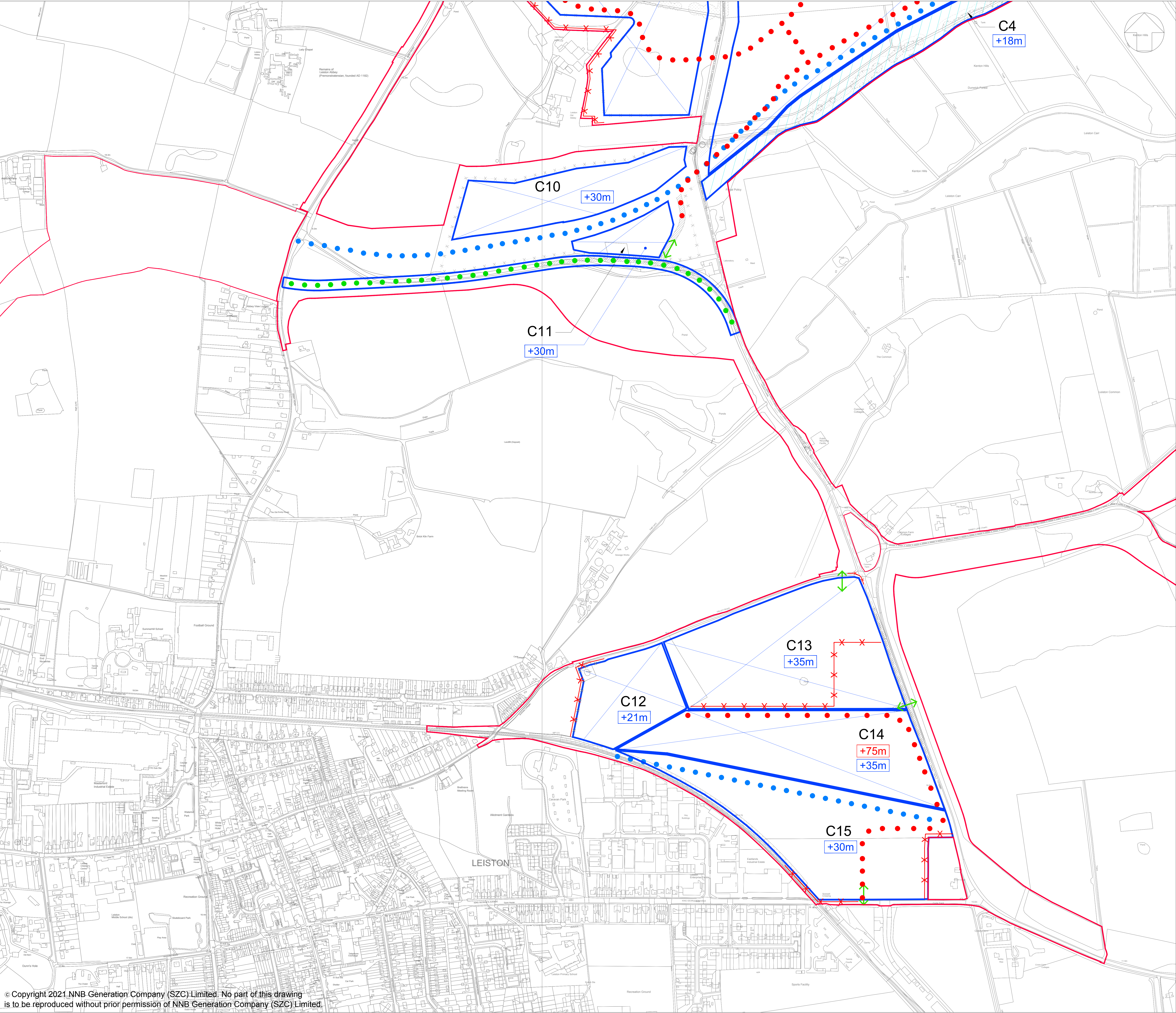

NOTES:

1. ALL HEIGHTS ARE ABOVE ORDNANCE DATUM (AOD).
2. PARTS OF ZONES C5, C6 & C7 THAT ARE FIRST USED AS BORROW PITS WILL NOT SUBSEQUENTLY EXCEED A STOCKPILE HEIGHT OF 5m ABOVE EXISTING GROUND LEVEL.
3. SHORT TERM CONSTRUCTION ACTIVITIES MAY TAKE PLACE OUTSIDE OF PARAMETER ZONES WITHIN THE MAIN DEVELOPMENT SITE FOR THE SPECIFIC PURPOSES OF REALISING THE CONSTRUCTION METHODOLOGY. SUCH ACTIVITY WOULD TYPICALLY COMPRISE MINOR WORKS USING MOBILE PLANT UP TO APPROX. 5m ABOVE GROUND LEVEL.
4. REFER TO DRAWING NUMBERS SZC-SZ0100-XX-000-DRW-100092, 100093, 100094 & 100095 FOR SHEET Nos. 1, 2, 3 & 4.

KEY:

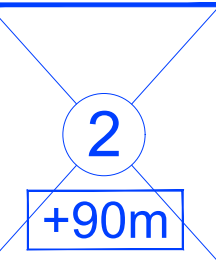

CONSTRUCTION ZONE GENERAL CONDITION:
POTENTIAL HEIGHT & WORKING
PARAMETERS REQUIRED DURING
CONSTRUCTION PHASE.

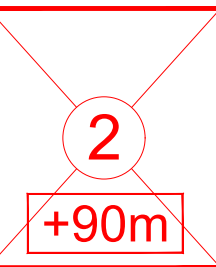

CONSTRUCTION ZONE EXCEPTIONAL
CONDITION:
POTENTIAL HEIGHT & WORKING
PARAMETERS REQUIRED DURING
CONSTRUCTION PHASE.



APPROX. LOCATION OF SITE ACCESS ROADS



APPROX. LOCATION OF SITE HAUL ROADS



APPROX. RAIL ROUTE



LOVER'S LANE REALIGNMENT



APPROX. LOCATION OF ACOUSTIC
FENCE/BUND



INDICATIVE LOCATION OF SITE ACCESS

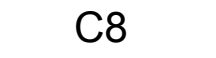

ZONE NUMBER

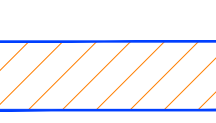

HARD COASTAL DEFENCE FEATURE
+15m +35m

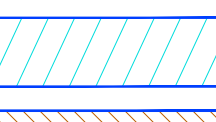

APPROX. LOCATION OF SOUTHERN BUND

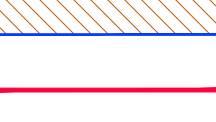

RELOCATED FACILITIES



SITE DEVELOPMENT BOUNDARY

03	FEB 2021	SB	NP	RESPONSE TO PINS PROCEDURAL DECISION 5 (Dated 22 Jan 2021)	SZC Co
02	JAN 2021	SB	NP	PROPOSED CHANGES TO THE DCO APPLICATION - JANUARY 2021	SZC Co
01	FEB 2020	SB	NP	DCO SUBMISSION	SZC Co
REVISION	DATE	DRAWN	CHECKED	REASONS FOR REVISION / COMMENTS	APPROVED

NOT PROTECTIVELY MARKED

COPYRIGHT:
Reproduced from Ordnance Survey map with the permission of
Ordnance Survey on behalf of the controller of Her Majesty's
Stationery Office © Crown copyright (2021).
All Rights reserved. NNB GenCo Licence: 0100060408



PROJECT:
SIZEWELL C

DOCUMENT:
APPLICATION DRAWING - FOR APPROVAL
REGULATION 5(2)(o)

DRAWING TITLE:
MAIN DEVELOPMENT SITE
CONSTRUCTION PARAMETER PLAN
SHEET 3 OF 4

DRAWING NO: SZC-SZ0100-XX-000-DRW-100094
REVISION: 03

DATE: FEB 2021
DRAWN: SB
SCALE: 1:2500@A0

SCALE BAR:
50m 0 50 100 150m
SCALE IN METRES
1:2500

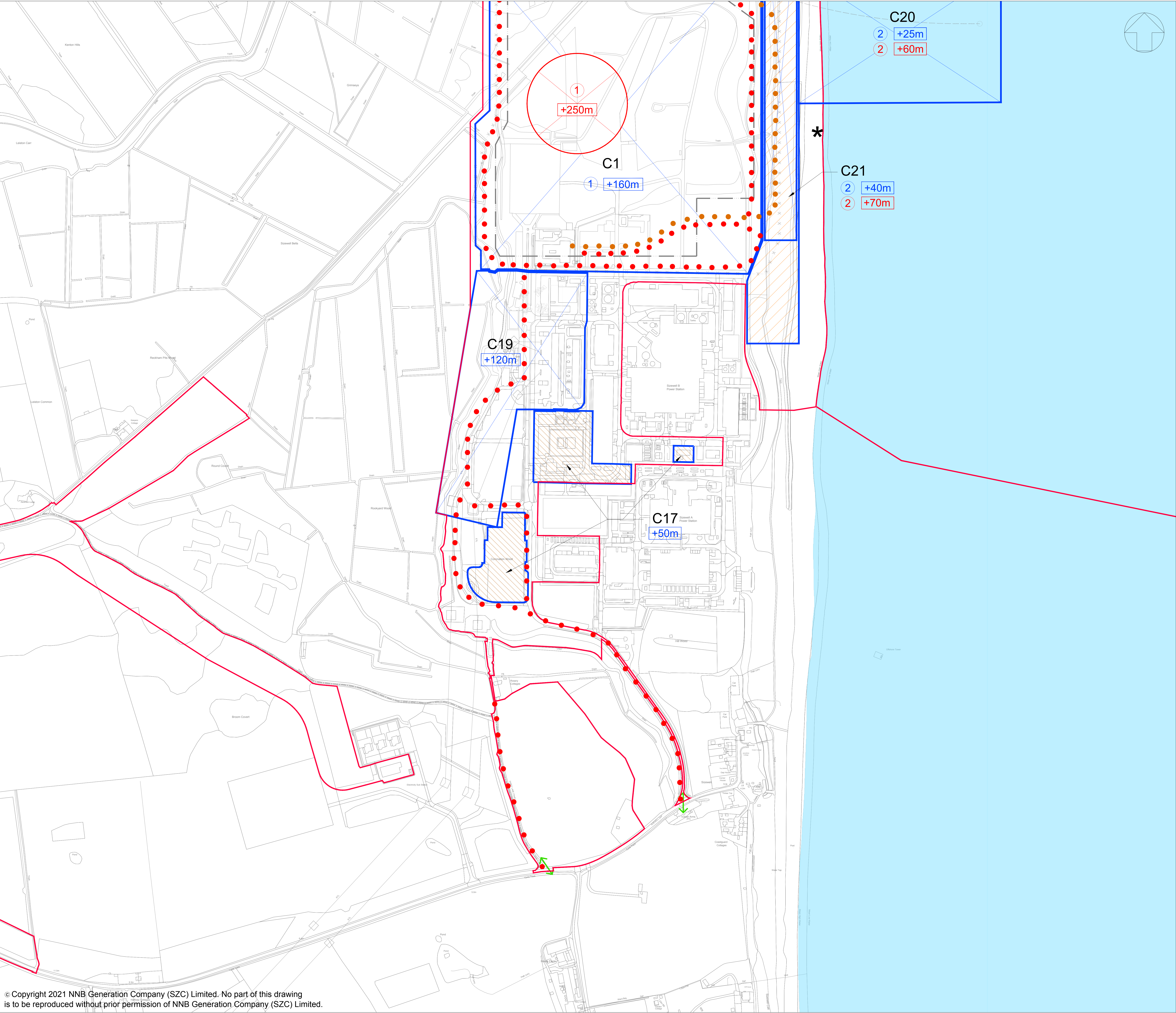

- NOTES:
1. ALL HEIGHTS ARE ABOVE ORDNANCE DATUM (AOD).
 2. PARTS OF ZONES C5, C6 & C7 THAT ARE FIRST USED AS BORROW PITS WILL NOT SUBSEQUENTLY EXCEED A STOCKPILE HEIGHT OF 5m ABOVE EXISTING GROUND LEVEL.
 3. SHORT TERM CONSTRUCTION ACTIVITIES MAY TAKE PLACE OUTSIDE OF PARAMETER ZONES WITHIN THE MAIN DEVELOPMENT SITE FOR THE SPECIFIC PURPOSES OF REALISING THE CONSTRUCTION METHODOLOGY. SUCH ACTIVITY WOULD TYPICALLY COMPRISE MINOR WORKS USING MOBILE PLANT UP TO APPROX. 5m ABOVE GROUND LEVEL.
 4. REFER TO DRAWING NUMBERS SZC-SZ0100-XX-000-DRW-100092, 100093, 100094 & 100095 FOR SHEET Nos. 1, 2, 3 & 4.

- KEY:
- CONSTRUCTION ZONE GENERAL CONDITION: POTENTIAL HEIGHT & WORKING PARAMETERS REQUIRED DURING CONSTRUCTION PHASE.
 - CONSTRUCTION ZONE EXCEPTIONAL CONDITION: POTENTIAL HEIGHT & WORKING PARAMETERS REQUIRED DURING CONSTRUCTION PHASE.
 - APPROX. LOCATION OF SITE ACCESS ROADS
 - APPROX. LOCATION OF SITE HAUL ROADS
 - APPROX. RAIL ROUTE
 - LOVER'S LANE REALIGNMENT
 - APPROX. LOCATION OF ACOUSTIC FENCE/BUND
 - INDICATIVE LOCATION OF SITE ACCESS
 - C8 ZONE NUMBER
 - HARD COASTAL DEFENCE FEATURE
 +15m +35m
 - APPROX. LOCATION OF SOUTHERN BUND
 - RELOCATED FACILITIES
 - SITE DEVELOPMENT BOUNDARY
 - PROPOSED TEMPORARY MARINE OUTFALL

03	FEB 2021	SB	NP	RESPONSE TO PINS PROCEDURAL DECISION 5 (Dated 22 Jan 2021)	SZC Co
02	JAN 2021	SB	NP	PROPOSED CHANGES TO THE DCO APPLICATION - JANUARY 2021	SZC Co
01	FEB 2020	SB	NP	DCO SUBMISSION	SZC Co
REVISION	DATE	DRAWN	CHECKED	REASONS FOR REVISION / COMMENTS	APPROVED

NOT PROTECTIVELY MARKED

COPYRIGHT:
Reproduced from Ordnance Survey map with the permission of Ordnance Survey on behalf of the controller of Her Majesty's Stationery Office © Crown copyright (2021).
All Rights reserved. NNB GenCo Licence: 0100060408



PROJECT:
SIZEWELL C

DOCUMENT:
APPLICATION DRAWING - FOR APPROVAL
REGULATION 5(2)(o)

DRAWING TITLE:
MAIN DEVELOPMENT SITE
CONSTRUCTION PARAMETER PLAN
SHEET 4 OF 4

DRAWING NO:
SZC-SZ0100-XX-000-DRW-100095

REVISION:
03

DATE:
FEB 2021

DRAWN:
SB

SCALE:
1:2500@A0

SCALE BAR:
50m 0 50 100 150m
SCALE IN METRES
1:2500