



The Sizewell C Project

6.3 Volume 2 Main Development Site Chapter 14 Terrestrial Ecology and Ornithology Appendix 14C6A Water Vole Mitigation Strategy Figures 14C6A.1 - 14C6A.8

Revision: 1.0
Applicable Regulation: Regulation 5(2)(a)
PINS Reference Number: EN010012

May 2020

Planning Act 2008
Infrastructure Planning (Applications: Prescribed
Forms and Procedure) Regulations 2009



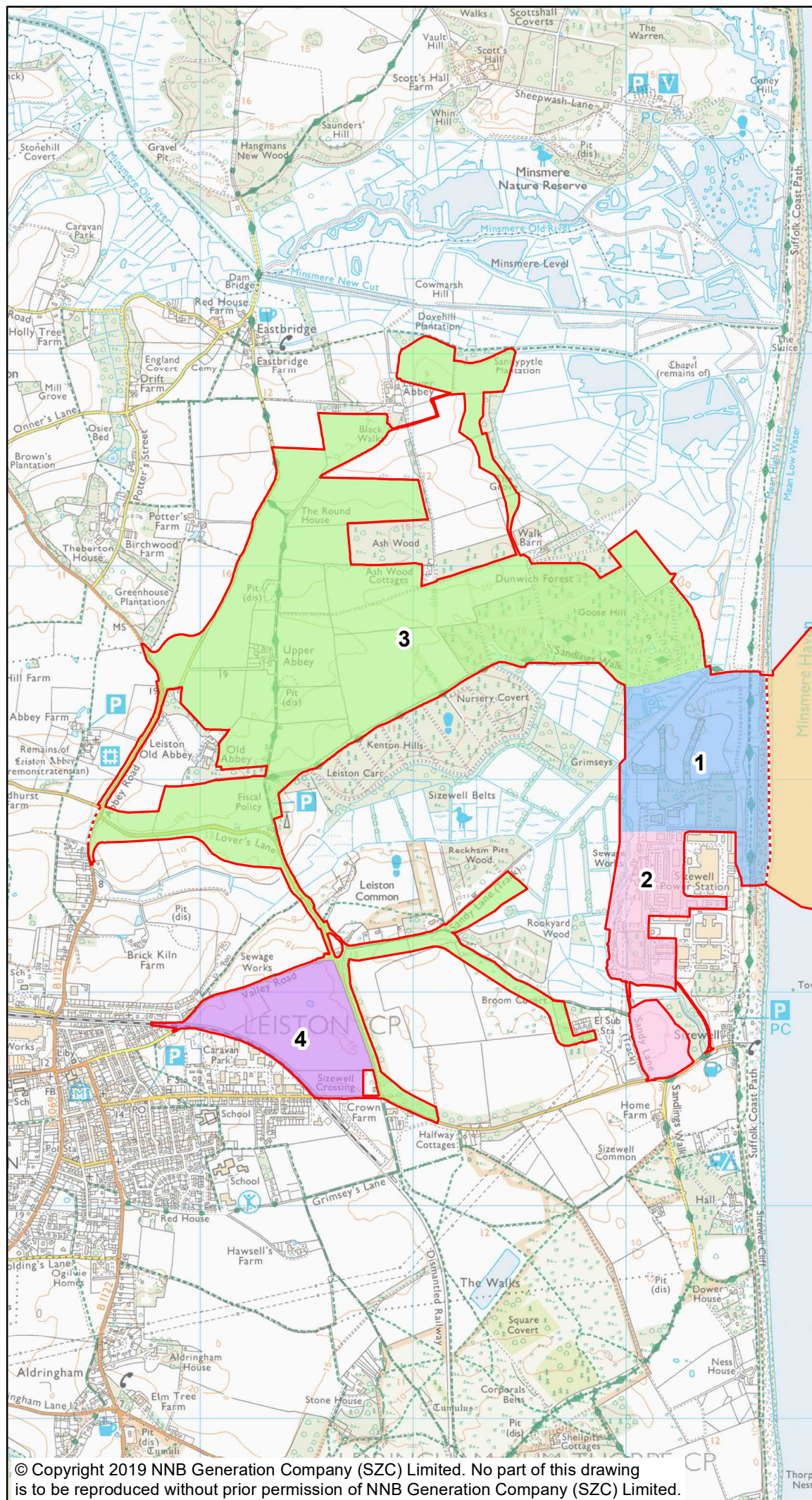

NOTES

KEY

- SIZEWELL C MAIN DEVELOPMENT SITE BOUNDARY
- - - DEMARCATION LINE
- MAIN DEVELOPMENT SITE AREAS**
- 1. MAIN PLATFORM
- 2. SIZEWELL B RELOCATED FACILITIES AND NATIONAL GRID LAND
- 3. TEMPORARY CONSTRUCTION AREA
- 4. LAND EAST OF EASTLANDS INDUSTRIAL ESTATE - LEEIE
- 5. OFFSHORE WORKS AREA

NOT PROTECTIVELY MARKED

COPYRIGHT
 Reproduced from Ordnance Survey map with the permission of Ordnance Survey on behalf of the controller of Her Majesty's Stationery Office © Crown Copyright (2019). All Rights reserved. NNB GenCo 0100060408.



DOCUMENT:
 SIZEWELL C
 ENVIRONMENTAL STATEMENT
 VOLUME 2
 APPENDIX 14C6A
 WATER VOLE MITIGATION STRATEGY

DRAWING TITLE:
 MAIN DEVELOPMENT SITE:
 SITE SUB AREAS

DRAWING NO:
 FIGURE 14C6A.1

DATE: JAN 2020 **DRAWN:** J.W. **SCALE:** 1:25,000 @A3

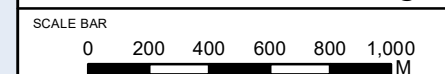

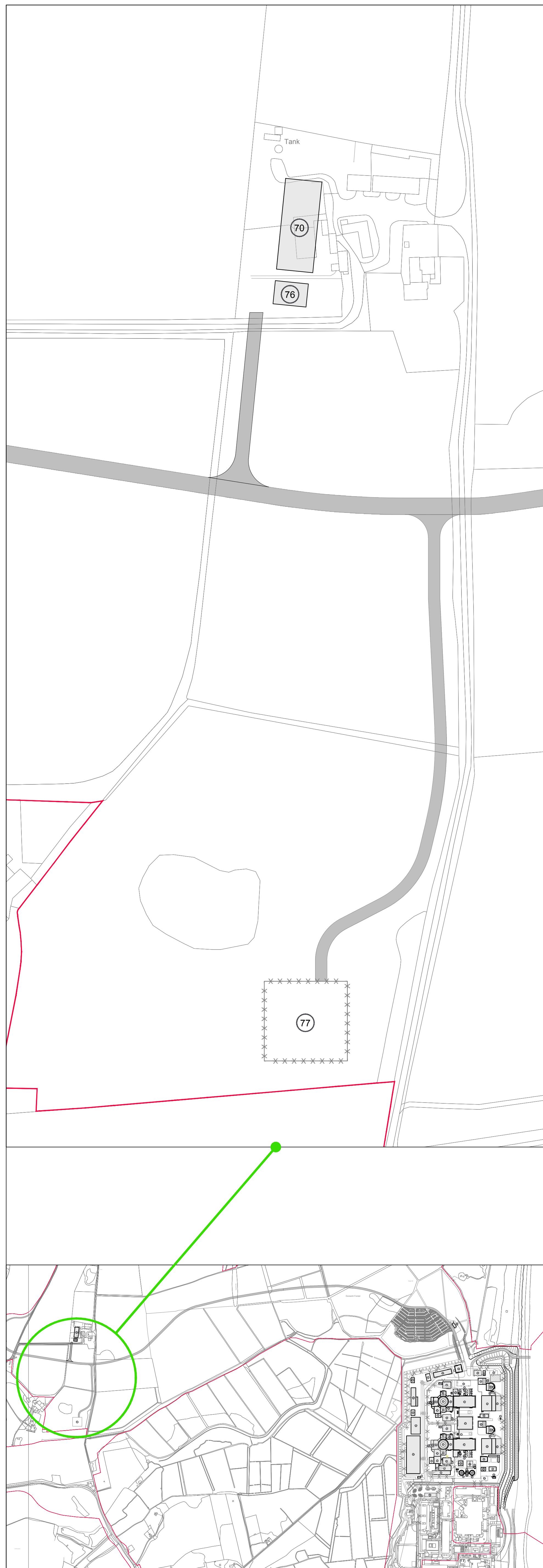

Ref:	Building	Ref:	Building
01	Nuclear Island	34	Ancillary Buildings - Plans/Office/Access/Storage/Fuel & Waste Management
02	Reactor Building	35	Demineralisation Station
03	Fuel Building	36	Valve Room for Demineralisation Station
04	Fuel Building Hall	37	Auxiliary Boilers
05	Boron Storage Building	38	Hydrogen Storage
06	Safeguard Elec Building	39	Oxygen Storage
07	Safeguard Mech Building	40	Hydrazine Storage
08	Nuclear Auxiliary Building	41	Raw & Potable Water Storage/Supply
09	Access Tower	42	Disposed Water Storage Tank
10	Radioactive Waste Storage Building	43	Marine Works Outfall Structure
11	Radioactive Waste Process Building	44	Chlorination Plant Tank
12	Radioactive Waste Treatment Building (Unit 2)	45	Intermediate Level Waste Interim Storage Facility
13	Hot Laundry Building	46	Conventional Waste Store
14	Hot Workshop, Hot Warehouse, Facilities For Decontamination	47	Transit Area for Very Low & Low Level Waste
15	Effluent Tanks & Refuelling Water Storage Tanks	50	Main Access Control Building
16	Emergency Diesel Generator Buildings	51	Secondary Access Control Building
17	Cooling Water Discharge Wer Buildings - Type 1	52	Auxiliary Administration Building
18	Cooling Water Discharge Wer Buildings - Type 2	54	Emergency Response Centre
19	Nuclear Island Demineralised Water Tank	58	Emergency Response Energy Centre
21	Turbine Hall	59	Meteorological Station
22	Conventional Island Electrical Building	65	Chemical Products Storage
23	Gas Insulated Switch Gear Building	66	Garage for Handling Facilities
24	Main Transformer Platform	67	Oil & Grease Storage
25	Unit Transformer Platform	68	Contaminated Tools Store
26	Auxiliary Transformer Platform	69	Warehouse
27	Conventional Island Demineralised Water Tank	71	Equipment Store for Interim Spent Fuel Store
28	Operational Service Centre	74	Sewage Treatment Plant
29	Operational Service Centre	75	National Grid Substation Building
31	Sky Bridge	53	Off-Site Delivery Checkpoint
32	Cooling Water Pump House & Associated Buildings	70	Emergency Equipment Store
33	Cooling Water Pump House	76	Back-Up Generator
34	Forebay	77	Ancillary Substation Compound
35	Outfall Pond Building	79	Chlorination Plant
36	Filtering Debris Recovery Pit		
37	Fire-Fighting Water Building		

DRAWING SYMBOLS & LEGEND

	NATIONAL GRID PYLONS		BUILDING STRUCTURES
	PYLONS & LINES - SZC Co STANDARD		
	FENCES		
	SIZEWELL C MAIN DEVELOPMENT SITE BOUNDARY		

THE MAXIMUM BUILDINGS HEIGHT FOR BUILDINGS / STRUCTURES COMPRISES THE ROOF HEIGHT STATED ON THIS DRAWING AND AN ADDITIONAL 3M TO TAKE ACCOUNT OF ANY ADDITIONAL ROOF PLANT OR MACHINERY THAT MAY PROTRUDE ABOVE THE STATED ROOF HEIGHT.

NOT PROTECTIVELY MARKED

COPYRIGHT:
 Reproduced from Ordnance Survey map with the permission of Ordnance Survey on behalf of the controller of Her Majesty's Stationery Office © Crown copyright (2019).
 All Rights reserved. NNB GenCo Licence: 0100060408



DOCUMENT:
**ENVIRONMENTAL STATEMENT
 VOLUME 2
 APPENDIX 14C6A
 WATER VOLE MITIGATION
 STRATEGY**

DRAWING TITLE:
**MAIN DEVELOPMENT SITE
 GENERAL ARRANGEMENT
 ILLUSTRATIVE - FOR INFORMATION**

DRAWING NO:
FIGURE 14C6A.2





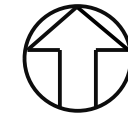





DATE: **JAN 2020** DRAWN: **SB** SCALE: **NTS**

SCALE BAR:

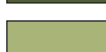

NOTES

KEY

-  Sizewell C Main Development Site Boundary
-  Demarcation Line
-  Hedgerows
-  Mixed Woodland/Trees
-  Dry Sandlings Grassland
-  Semi-Improved Grassland
-  Arable Land
-  Amenity Landscape
-  Marsh, Fen and Reedbed
-  Vegetated Dunes and Shingle Beach

NOT PROTECTIVELY MARKED

COPYRIGHT
 Reproduced from Ordnance Survey map with the permission of Ordnance Survey on behalf of the controller of Her Majesty's Stationery Office © Crown Copyright (2019). All Rights reserved. NNB GenCo 0100060408.



DOCUMENT:
 SIZEWELL C
 ENVIRONMENTAL STATEMENT
 VOLUME 2
 APPENDIX 14C6A
 WATER VOLE MITIGATION STRATEGY

DRAWING TITLE:
 LANDSCAPE MASTERPLAN (OPERATIONAL)
 ILLUSTRATIVE - FOR INFORMATION

DRAWING NO:
 FIGURE 14C6A.3

DATE: JAN 2020 **DRAWN:** S.G **SCALE:** NTS



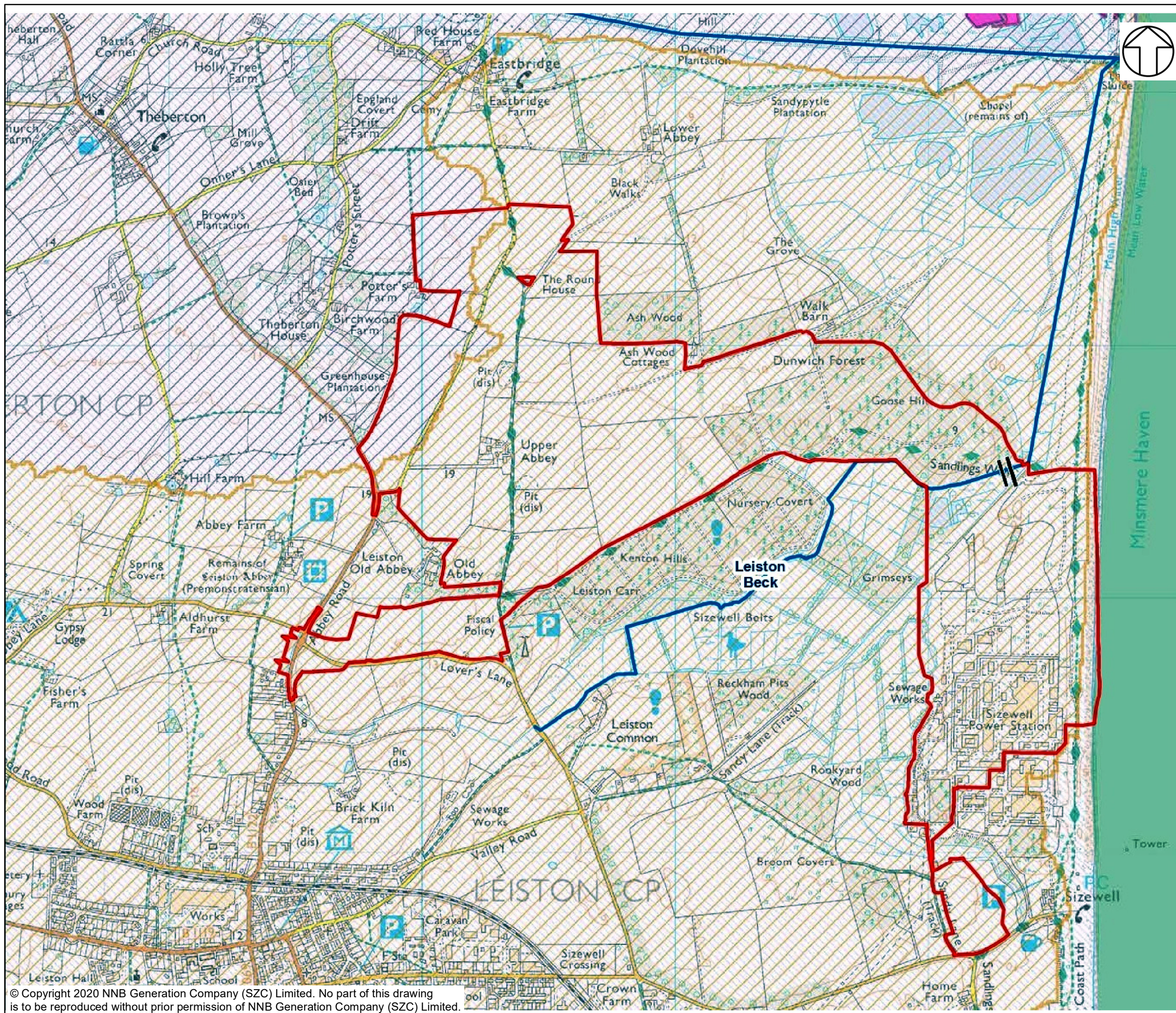

NOTES

KEY

-  WFD Fluvial water body
-  SSSI Crossing
-  Indicative Development Site Boundary
- WFD Coastal Water body**
-  Suffolk (GB650503520002)
-  Walberswick Marshes (GB610050078000)
- WFD Fluvial Catchment areas**
-  Leiston Beck (GB105035046271)
-  Minsmere Old River (GB105035046270)
- WFD Groundwater body**
-  Waveney and East Suffolk Chalk & Crag (GB40501G400600)

NOT PROTECTIVELY MARKED

COPYRIGHT
 Reproduced from Ordnance Survey map with the permission of Ordnance Survey on behalf of the controller of Her Majesty's Stationery Office © Crown Copyright (2019). All Rights reserved. NNB GenCo 0100060408.



DOCUMENT:
 SIZEWELL C
 ENVIRONMENTAL STATEMENT
 VOLUME 2
 APPENDIX 14C6A
 WATER VOLE MITIGATION STRATEGY

DRAWING TITLE:
 LOCATION PLAN OF THE SSSI CROSSING

DRAWING NO.:
 FIGURE 14C6A.4

DATE: JAN 2020 **DRAWN:** R.G. **SCALE:** NTS



NOTES

KEY

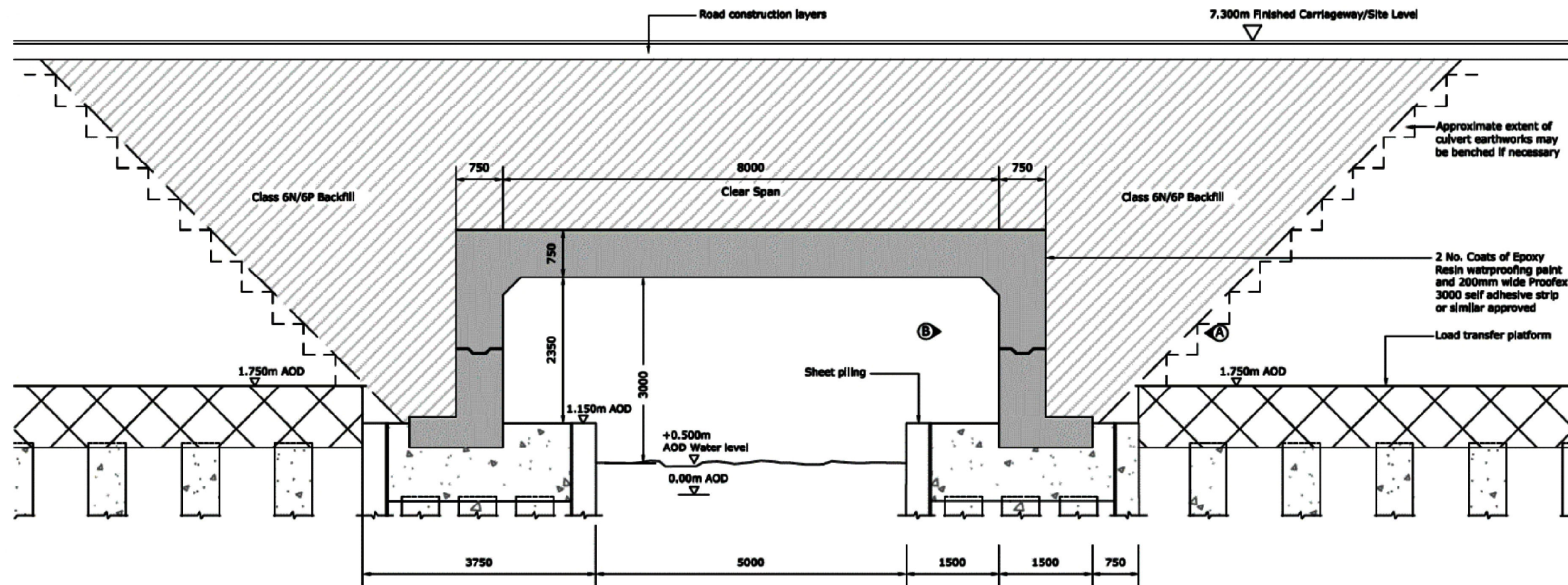

NOT PROTECTIVELY MARKED

COPYRIGHT
 Reproduced from Ordnance Survey map with the permission of
 Ordnance Survey on behalf of the controller of Her Majesty's
 Stationery Office © Crown Copyright (2019). All Rights
 reserved. NNB GenCo 0100060408.



DOCUMENT:
 SIZEWELL C
 ENVIRONMENTAL STATEMENT
 VOLUME 2
 APPENDIX 14C6A
 WATER VOLE MITIGATION STRATEGY

DRAWING TITLE:
 CROSS SECTION THROUGH THE SSSI
 CROSSING CULVERT

DRAWING NO:
 FIGURE 14C6A.5

DATE: JAN 2020 DRAWN: R.G. SCALE: NTS

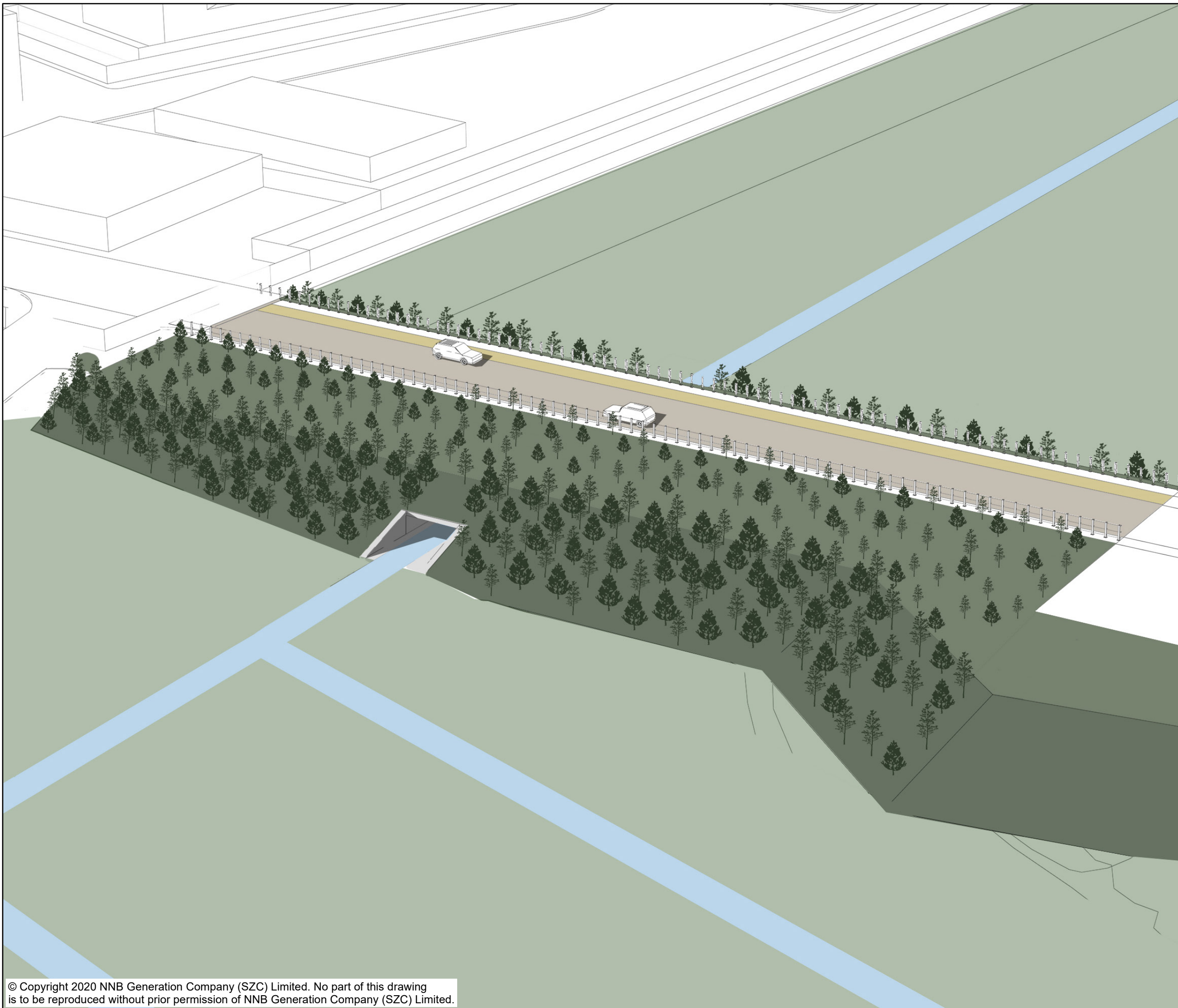

NOTES

KEY

NOT PROTECTIVELY MARKED

COPYRIGHT
 Reproduced from Ordnance Survey map with the permission of Ordnance Survey on behalf of the controller of Her Majesty's Stationery Office © Crown Copyright (2019). All Rights reserved. NNB GenCo 0100060408.



DOCUMENT:
 SIZEWELL C
 ENVIRONMENTAL STATEMENT
 VOLUME 2
 APPENDIX 14C6A
 WATER VOLE MITIGATION STRATEGY

DRAWING TITLE:
 SSSI CROSSING INDICATIVE VIEW

DRAWING NO.:
 FIGURE 14C6A.6

DATE: JAN 2020	DRAWN: S.G	SCALE: NTS
--------------------------	----------------------	----------------------



NOTES

KEY



NOT PROTECTIVELY MARKED

COPYRIGHT
 Reproduced from Ordnance Survey map with the permission of Ordnance Survey on behalf of the controller of Her Majesty's Stationery Office © Crown Copyright (2019). All Rights reserved. NNB GenCo 0100060408.



DOCUMENT:
 SIZEWELL C
 ENVIRONMENTAL STATEMENT
 VOLUME 2
 APPENDIX 14C6A
 WATER VOLE MITIGATION STRATEGY

DRAWING TITLE:
 ALDHURST FARM HABITAT CREATION

DRAWING NO:
 FIGURE 14C6A.7

DATE: JAN 2020 DRAWN: R.G. SCALE: NTS

X:\JOBS\6827_SIZEWELL_DCO\2019\7\CADD\DRAWINGS\OPERATIONAL\6827_WET_WOODLAND_SKETCH.DWG

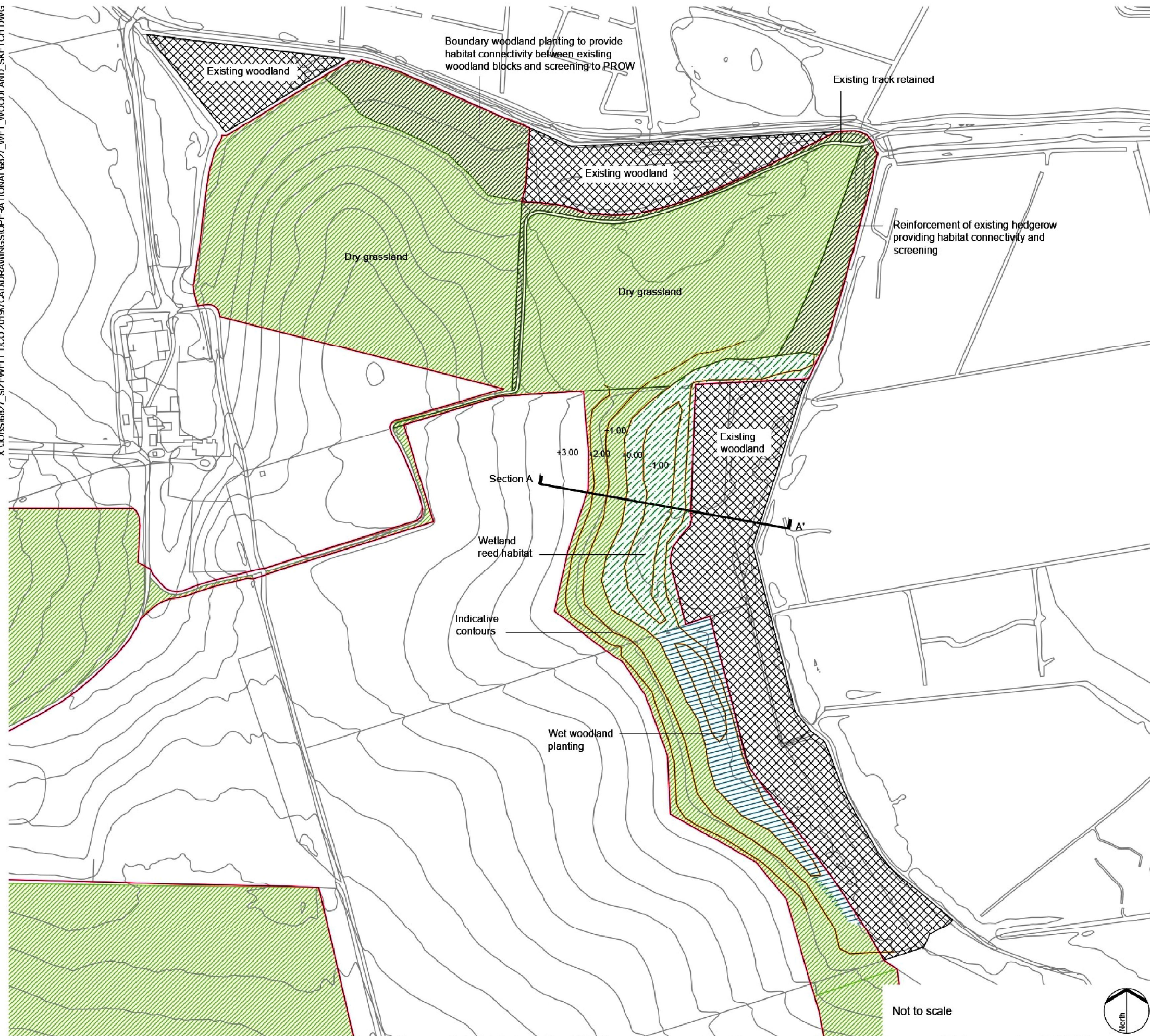

NOTES

KEY

- Existing woodland
- Proposed woodland
- Proposed wet woodland (0.7ha)
- Proposed reed bed (1.2ha)
- Proposed dry grassland

NOT PROTECTIVELY MARKED

COPYRIGHT
 Reproduced from Ordnance Survey map with the permission of Ordnance Survey on behalf of the controller of Her Majesty's Stationery Office © Crown Copyright (2019). All Rights reserved. NNB GenCo 0100060408.



DOCUMENT:
 SSIZEWELL C
 ENVIRONMENTAL STATEMENT
 VOLUME 2
 APPENDIX 14C6A
 WATER VOLE MITIGATION STRATEGY

DRAWING TITLE:
 REEDBED AND WET WOODLAND
 HABITATS TO BE CREATED IN THE NORTH
 EASTERN EXTENT OF THE SITE

DRAWING NO:
 FIGURE 14C6A.8

DATE: JAN 2020 **DRAWN:** R.G. **SCALE:** NTS

Not to scale



This drawing may contain: Ordnance Survey material by permission of Ordnance Survey on behalf of the Controller of Her Majesty's Stationery Office © Crown Copyright 2019. All rights reserved. Reference number 0100031673.
 OS Open data / © Natural England / © DEFRA / © DECC / © English Heritage. Aerial Photography - ESRI, DigitalGlobe, GEOEye, i-cubed, USDA FSA, USGD, AEX, Getmapping, Aerogrid, IGN, IGP, swisstopo, the GIS User Community

© Copyright 2020 NNB Generation Company (SZC) Limited. No part of this drawing is to be reproduced without prior permission of NNB Generation Company (SZC) Limited.